

- KEY: PLAN**
- Proposed Green Route Option
  - Proposed Maintenance Strip (3m min)
  - Stage 2 Fenceline
  - Proposed Indicative Structure Location
  - Proposed Culvert
  - Designated Watercourse
  - Undesignated Watercourse
  - Existing Ground Contours

- KEY: SECTION**
- Existing Ground Level - Mainline Green
  - Proposed Ground Level - Mainline Green
  - Proposed Ground Level - Mainline Green

**NOTES**

- Contours are provided for illustration purposes only.

**PLAN: PROPOSED GREEN ALIGNMENT**  
SCALE 1:1250 @ A1; 1:2500 @ A3

File name: I:\UK\WSPGROUP\COMP\CENTRAL DATA\PROJECTS\A29\_CIS02\WIP\HW HIGHWAYS01\_MODEL02\CAD DRAWINGS\02 PHASE 01781314-WSP-B-D-0800-0191-V2.0 STG 2 GRO P&P DWG, printed on 22 September 2020 15:41:08, by Scott, Jack

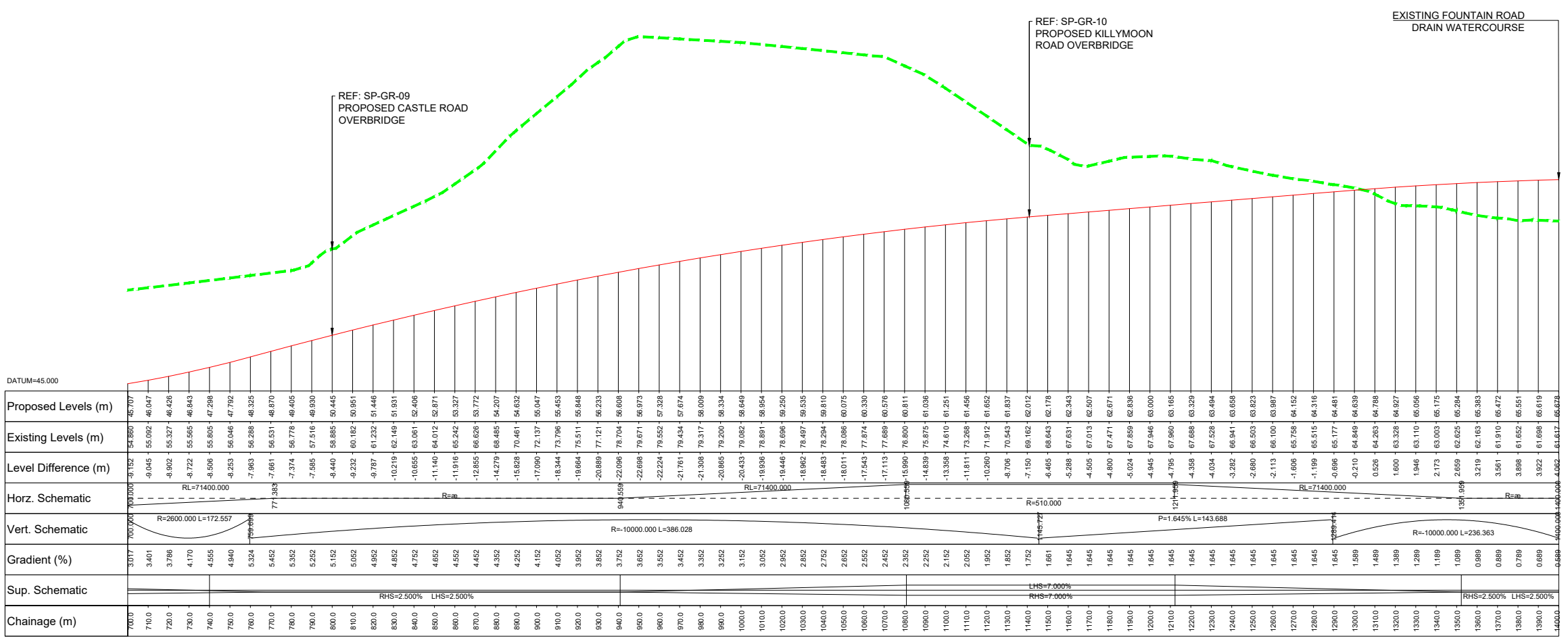

**PROFILE: PROPOSED GREEN ALIGNMENT**  
SCALE H 1:1250, V 1:250 @ A1; H 1:2500, V 1:500 @ A3

2.0	STG 2 FENCELINE ADDED	JS	LE	LE	22/09/20
Ver	Amendment	By	Checked	Approved	Date

DRAWING STATUS: **PRELIMINARY**

Shorefield House, 30 Kinnegar Drive, Holywood, County Down, BT18 9JQ, UK  
T+ 44 (0) 28 95953020  
wsp.com

CLIENT:

SITE PROJECT: **A29 COOKSTOWN BYPASS**

TITLE: **STAGE 2 - GREEN ROUTE MAINLINE PLAN AND PROFILE SHEET 2 OF 6**

SCALE @ A1: AS SHOWN	SCALE @ A3:	CHECKED: LE	30/07/2020	APPROVED: 30/07/2020
PROJECT NO: 718314	DESIGNED: WSP	DRAWN: JS	DATE: 11/05/2020	

DRAWING NO: 718314-WSP-C-D-0800-0192	REV: 2.0
--------------------------------------	----------

© WSP UK Ltd

File name: I:\UK\WSP\GROUP\COMP\CENTRAL DATA\PROJECTS\A29 - A29 - C18202 WIP\HW HIGHWAYS01 MODEL02 CAD DRAWINGS\02 PHASE 017814-WSP-B-D-0800-0191-0196 V2.0 STG2 GRO P&P DWG, printed on 22 September 2020 15:41:28, by Scott, Jack

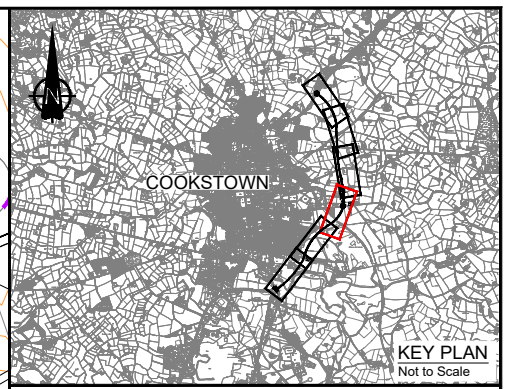
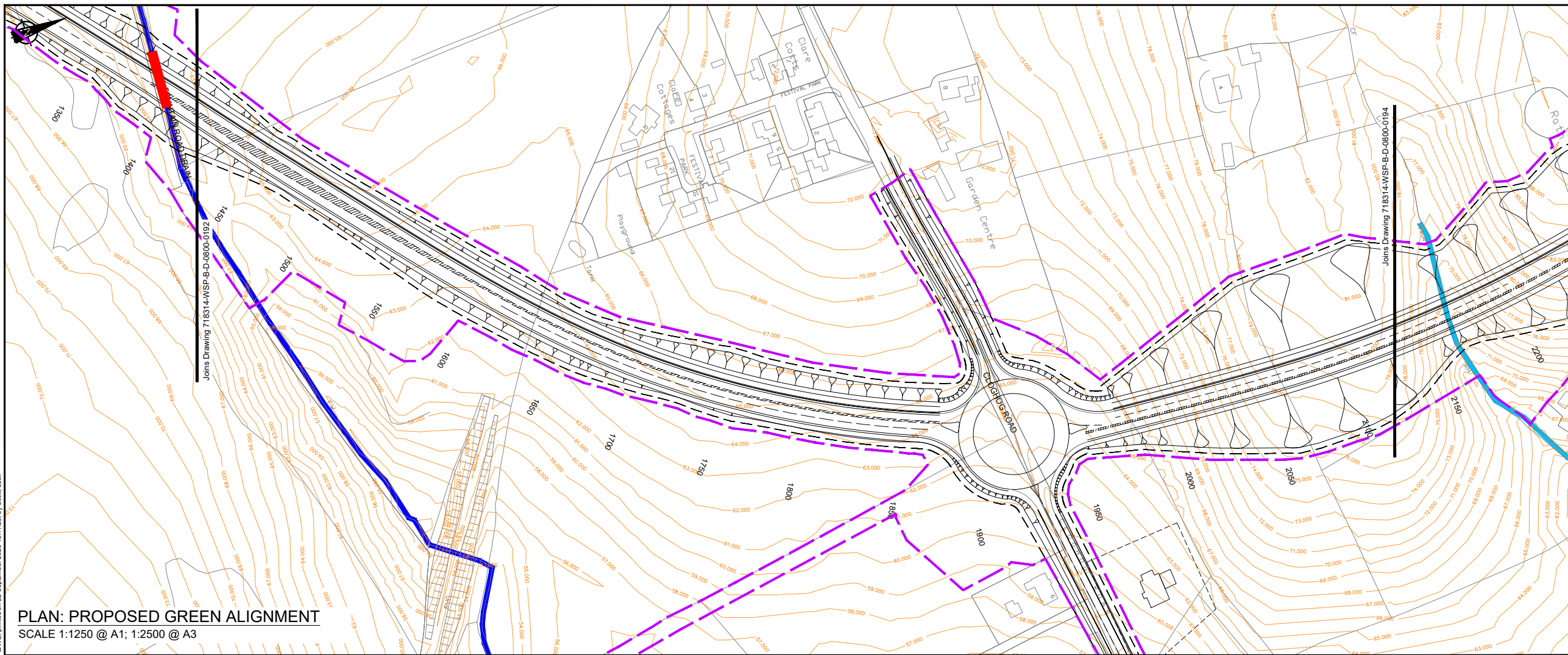

- KEY: PLAN**
- Proposed Green Route Option
  - Proposed Maintenance Strip (3m min)
  - Stage 2 Fence Line
  - Proposed Indicative Structure Location
  - Proposed Culvert
  - Designated Watercourse
  - Undesignated Watercourse
  - Existing Ground Contours

- KEY: SECTION**
- Existing Ground Level - Mainline Green
  - Proposed Ground Level - Mainline Green
  - Proposed Ground Level - Mainline Green

- NOTES**
- Contours are provided for illustration purposes only.

**PLAN: PROPOSED GREEN ALIGNMENT**  
SCALE 1:1250 @ A1; 1:2500 @ A3

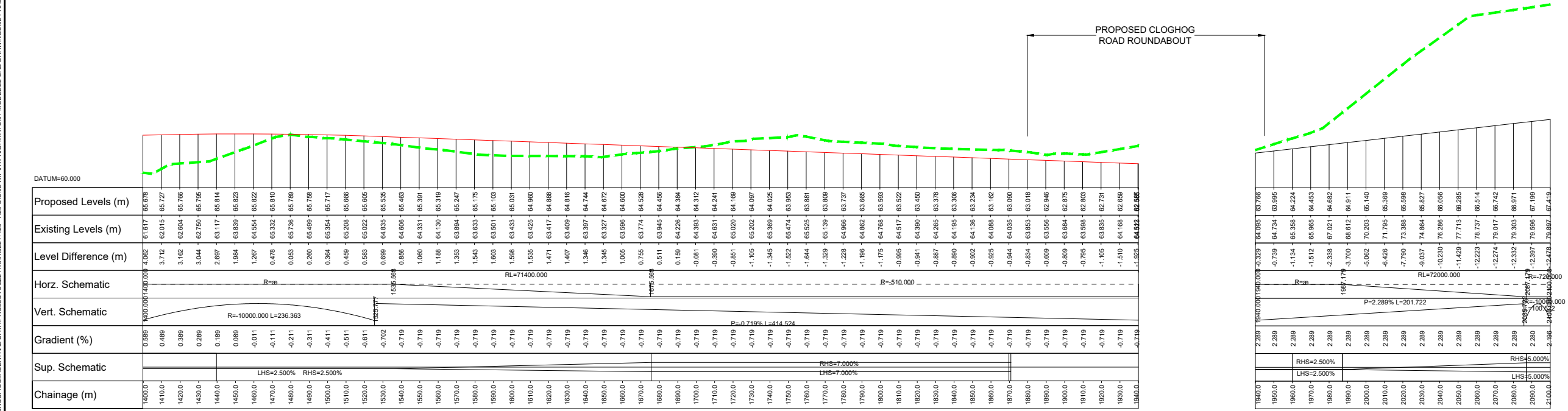

**PROFILE: PROPOSED GREEN ALIGNMENT**  
SCALE H 1:1250, V 1:250 @ A1; H 1:2500, V 1:500 @ A3

2.0	STG2 FENCELINE ADDED	JS	LE	LE	22/09/20
Ver	Amendment	By	Checked	Approved	Date

DRAWING STATUS: **PRELIMINARY**

Shorefield House, 30 Kinnegar Drive, Holywood, County Down, BT18 9JQ, UK  
T+ 44 (0) 28 95953020  
wsp.com

CLIENT:

SITE PROJECT: **A29 COOKSTOWN BYPASS**

TITLE: **STAGE 2 - GREEN ROUTE MAINLINE PLAN AND PROFILE SHEET 3 OF 6**

SCALE @ A1: AS SHOWN	SCALE @ A3:	CHECKED: LE	30/07/2020	APPROVED: 30/07/2020
PROJECT NO: 718314	DESIGNED: WSP	DRAWN: JS	DATE: 11/05/2020	

DRAWING NO: 718314-WSP-C-D-0800-0193	REV: 2.0
--------------------------------------	----------

© WSP UK Ltd

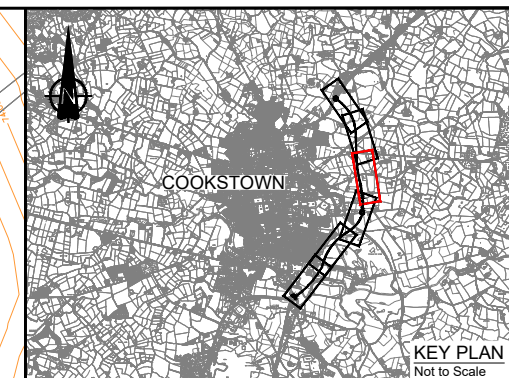
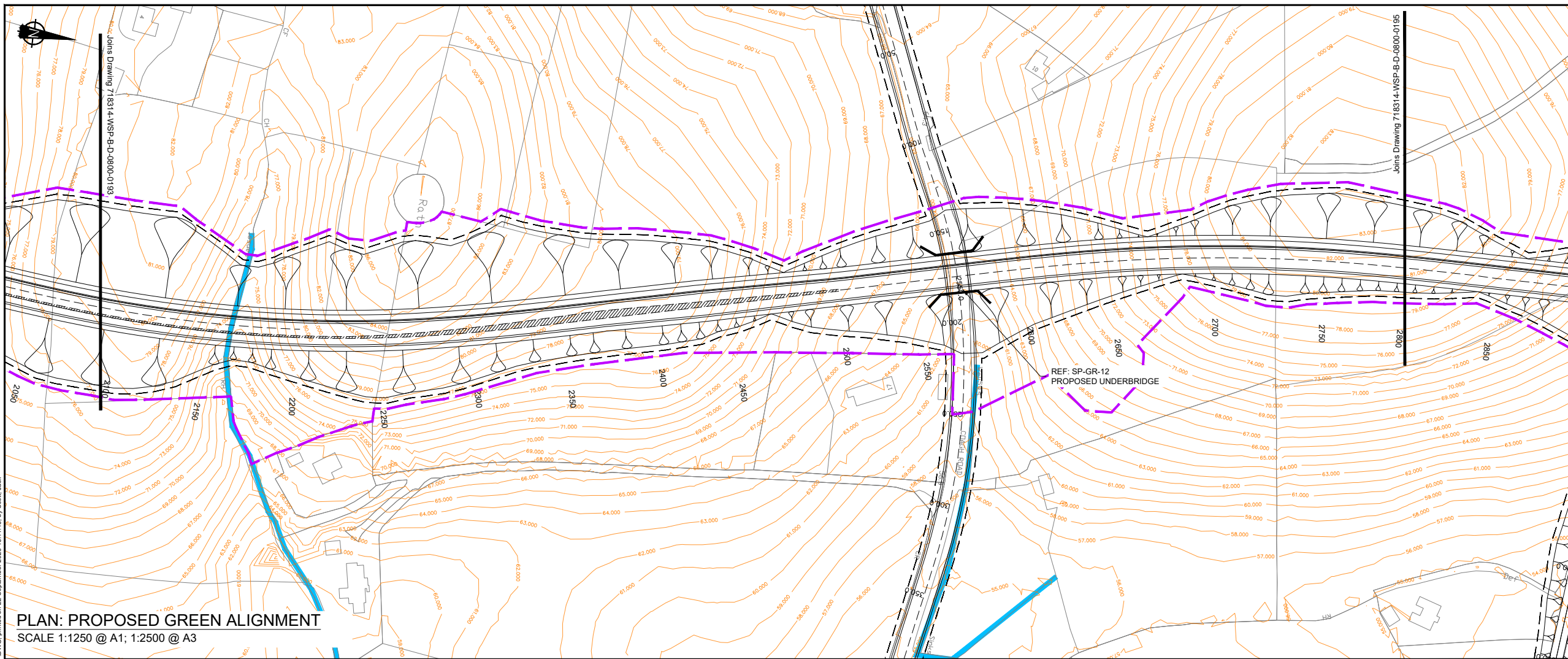

- KEY: PLAN**
- Proposed Green Route Option
  - Proposed Maintenance Strip (3m min)
  - Stage 2 Fenceline
  - Proposed Indicative Structure Location
  - Designated Watercourse
  - Undesignated Watercourse
  - Existing Ground Contours
- KEY: SECTION**
- Existing Ground Level - Mainline Green
  - Proposed Ground Level - Mainline Green
  - Proposed Ground Level - Mainline Green
- NOTES**
- Contours are provided for illustration purposes only.

File name: I:\UK\WSPGROUP\COMP\CENTRAL DATA\PROJECTS\A29 COOKSTOWN\WIPHW HIGHWAYS\01 MODEL\02 CAD DRAWINGS\02 PHASE 01\1814\WSP-B-D-0800-0194-V2.0 STG2 GRO P&P DWG, printed on 22 September 2020 15:41:48, by Scott, Jack

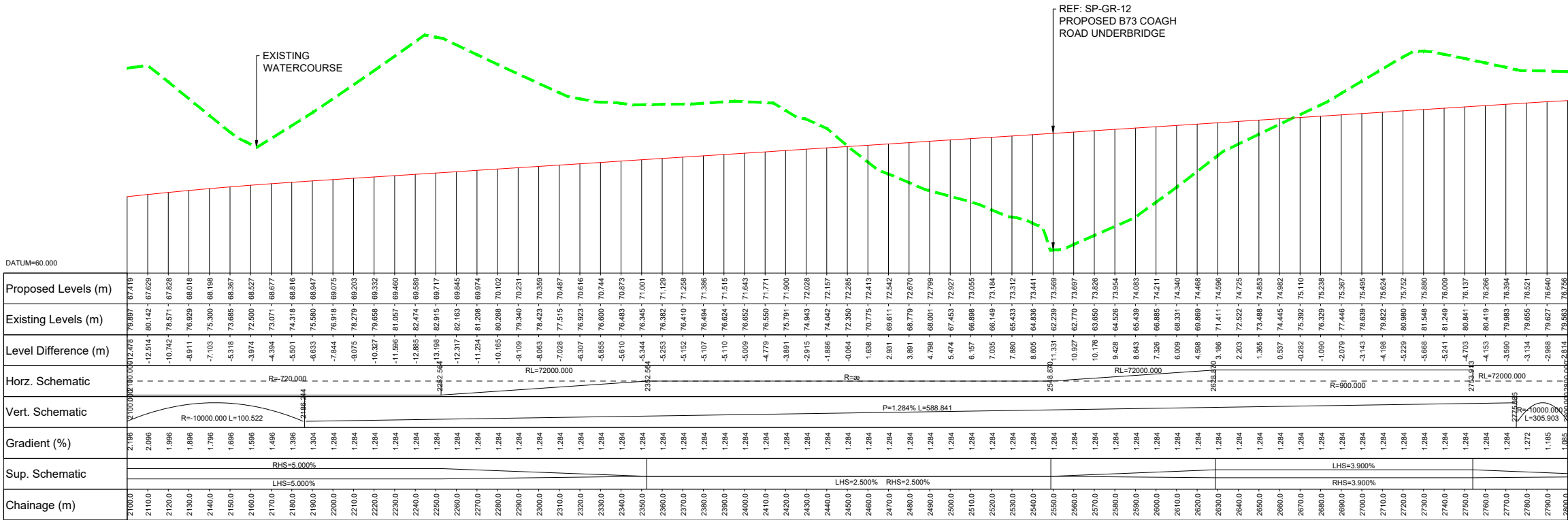

2.0	STG2 FENCELINE ADDED	JS	LE	LE	22/09/20
Ver	Amendment	By	Checked	Approved	Date

DRAWING STATUS: **PRELIMINARY**

Shorefield House, 30 Kinnegar Drive, Holywood, County Down, BT18 9JQ, UK  
T+ 44 (0) 28 95953020  
wsp.com

CLIENT:

SITE PROJECT: **A29 COOKSTOWN BYPASS**

TITLE: **STAGE 2 - GREEN ROUTE MAINLINE PLAN AND PROFILE SHEET 4 OF 6**

SCALE @ A1: AS SHOWN	SCALE @ A3: AS SHOWN	CHECKED: LE	30/07/2020	APPROVED: 30/07/2020
PROJECT NO: 718314	DESIGNED: WSP	DRAWN: JS	DATE: 11/05/2020	REV: 2.0

DRAWING NO: 718314-WSP-C-D-0800-0194

© WSP UK Ltd

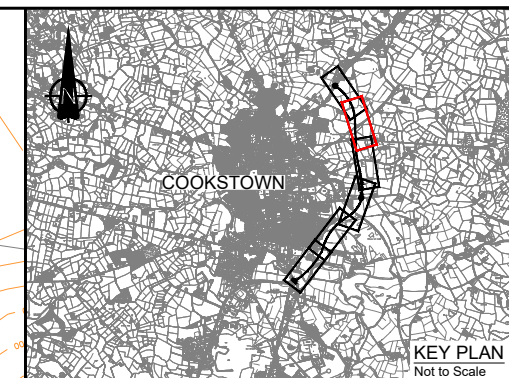
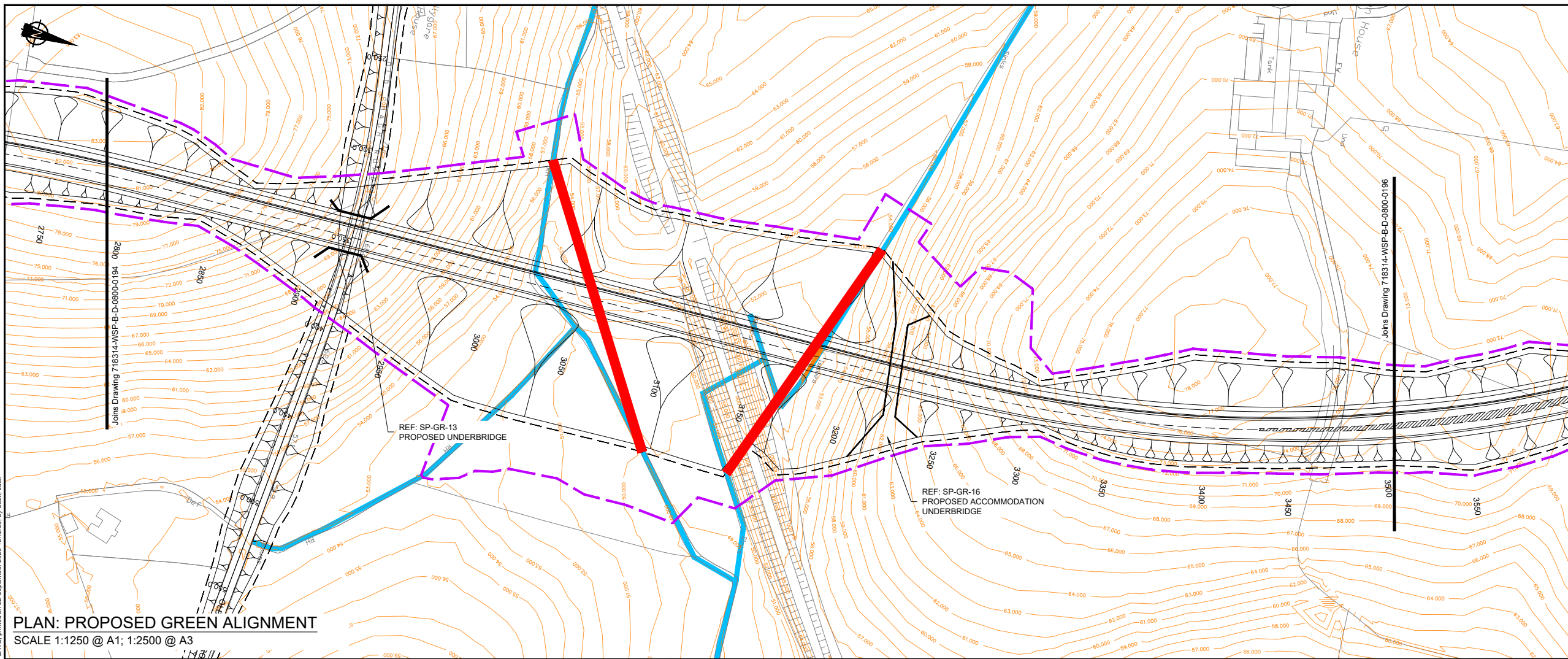

- KEY: PLAN
- Proposed Green Route Option
  - Proposed Maintenance Strip (3m min)
  - Stage 2 Fenceline
  - Proposed Indicative Structure Location
  - Proposed Culvert
  - Designated Watercourse
  - Undesignated Watercourse
  - Existing Ground Contours

- KEY: SECTION
- Existing Ground Level - Mainline Green
  - Proposed Ground Level - Mainline Green
  - Proposed Ground Level - Mainline Green

NOTES

- Contours are provided for illustration purposes only.

File name: I:\UK\WSPGROUP\COMP\CENTRAL DATA\PROJECTS\A29 - A29 - C1502 WIP\HW HIGHWAYS01 MODEL02 CAD DRAWINGS02 PHASE 01\718314-WSP-B-D-0800-0194-0194c.dwg, printed on 22 September 2020 15:42:09, by Scott, Jack

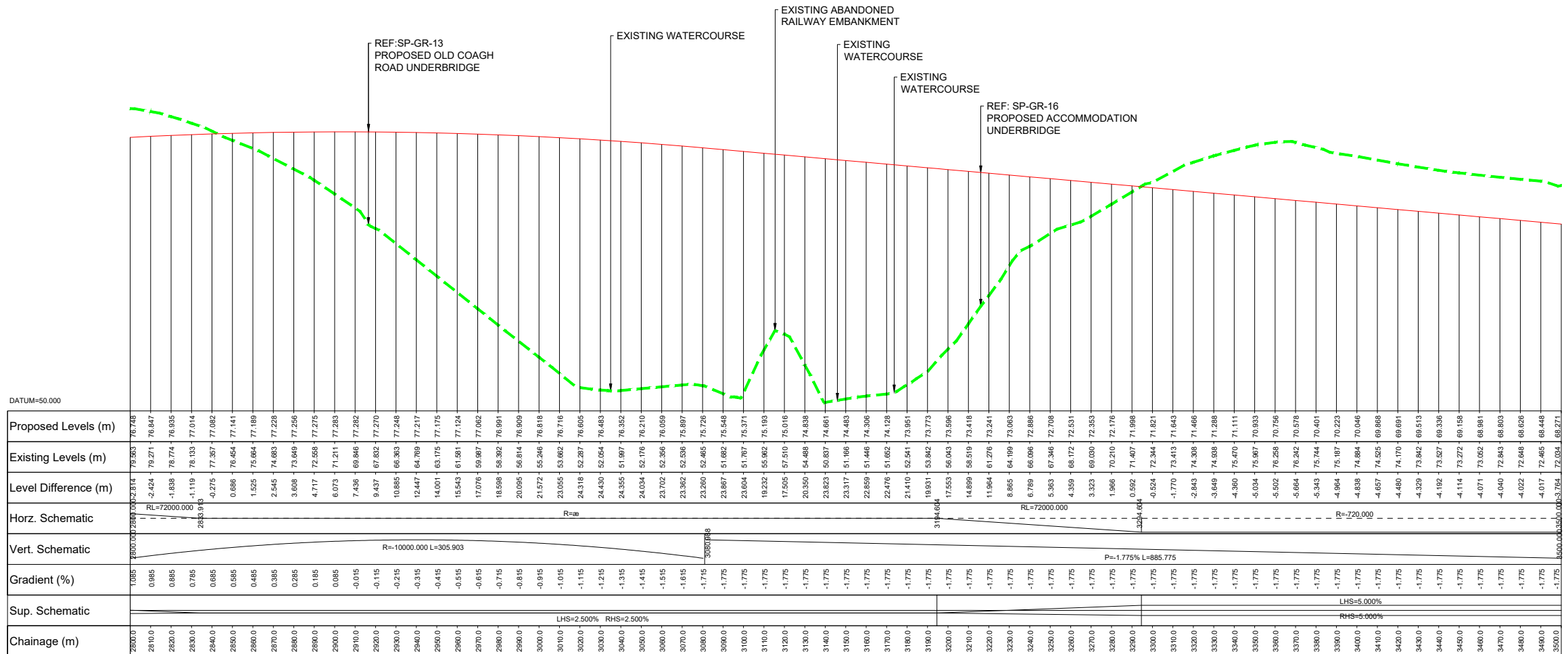

2.0	STG2 FENCELINE ADDED	JS	LE	LE	22/09/20
Ver	Amendment	By	Checked	Approved	Date

DRAWING STATUS: PRELIMINARY

Shorefield House, 30 Kinnegar Drive, Holywood, County Down, BT18 9JQ, UK  
T+ 44 (0) 28 95953020  
wsp.com

CLIENT: Department for Infrastructure An Roinn Bonnagair

SITE PROJECT: A29 COOKSTOWN BYPASS

TITLE: STAGE 2 - GREEN ROUTE MAINLINE PLAN AND PROFILE SHEET 5 OF 6

SCALE @ A1: AS SHOWN	SCALE @ A3:	CHECKED: LE	30/07/2020	APPROVED: 30/07/2020
PROJECT NO: 718314	DESIGNED: WSP	DRAWN: JS	DATE: 11/05/2020	
DRAWING NO: 718314-WSP-C-D-0800-0195				REV: 2.0

© WSP UK Ltd

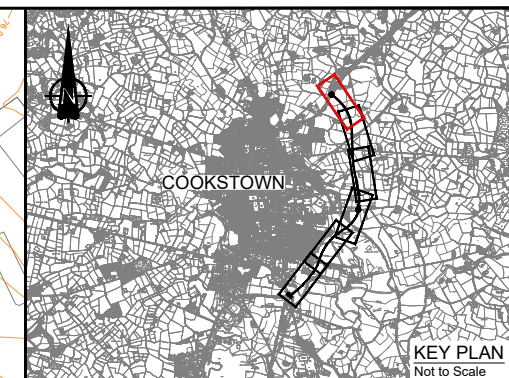
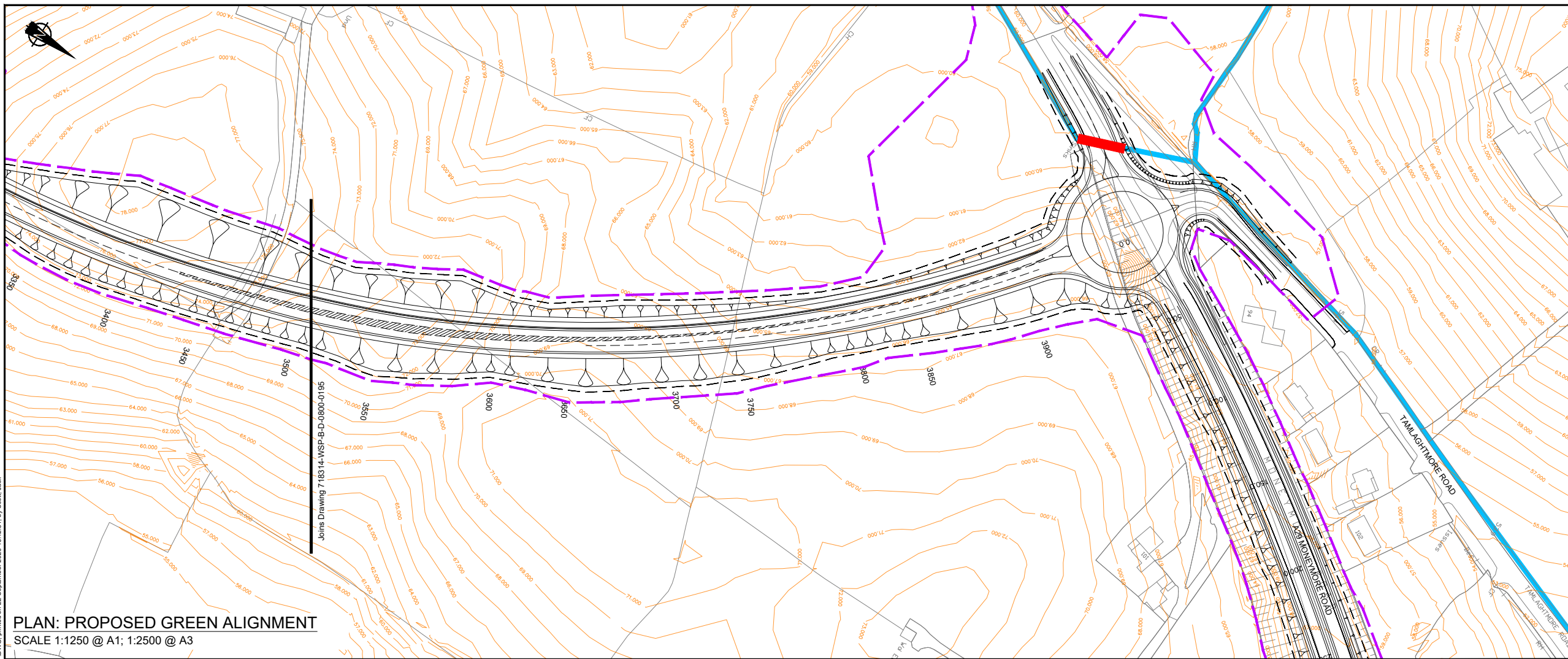

- KEY: PLAN**
- Proposed Green Route Option
  - Proposed Maintenance Strip (3m min)
  - Stage 2 Fenceline
  - Proposed Indicative Structure Location
  - Proposed Culvert
  - Designated Watercourse
  - Undesignated Watercourse
  - Existing Ground Contours

- KEY: SECTION**
- Existing Ground Level - Mainline Green
  - Proposed Ground Level - Mainline Green
  - Proposed Ground Level - Mainline Green

**NOTES**

- Contours are provided for illustration purposes only.

**PLAN: PROPOSED GREEN ALIGNMENT**  
SCALE 1:1250 @ A1; 1:2500 @ A3

File name: I:\UK\WSP\GROUP\COMP\CENTRAL DATA\PROJECTS\A29 COOKSTOWN BYPASS\HIGHWAYS\01 MODEL\02 CAD DRAWINGS\02 PHASE 01\0181-0196 V2.0 STG2 GRO P&P DWG, printed on 22 September 2020 15:42:31, by Scott, Jack

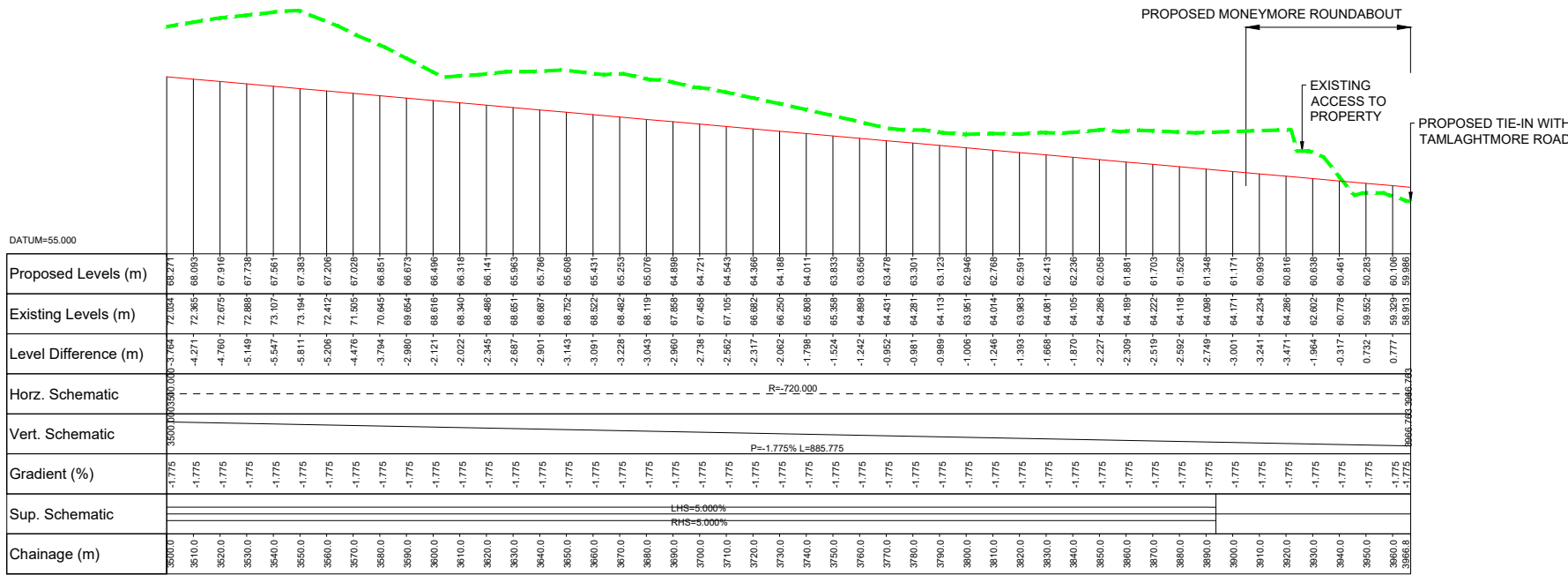

**PROFILE: PROPOSED GREEN ALIGNMENT**  
SCALE H 1:1250, V 1:250 @ A1; H 1:2500, V 1:500 @ A3

2.0	STG2 FENCELINE ADDED	JS	LE	LE	22/09/20
Ver	Amendment	By	Checked	Approved	Date

DRAWING STATUS: **PRELIMINARY**

Shorefield House, 30 Kinnegar Drive, Holywood, County Down, BT18 9JQ, UK  
T+ 44 (0) 28 95953020  
wsp.com

CLIENT:

SITE PROJECT: **A29 COOKSTOWN BYPASS**

TITLE: **STAGE 2 - GREEN ROUTE MAINLINE PLAN AND PROFILE SHEET 6 OF 6**

SCALE @ A1: AS SHOWN	SCALE @ A3:	CHECKED: LE	30/07/2020	APPROVED: 30/07/2020
PROJECT NO: 718314	DESIGNED: WSP	DRAWN: JS	DATE: 11/05/2020	REV: 2.0
DRAWING No: 718314-WSP-C-D-0800-0196				REV: 2.0

© WSP UK Ltd