

**KEY: PLAN**

- Proposed Red Route Option
- Proposed Maintenance Strip (3m min)
- Stage 2 Fenceline
- Proposed Indicative Structure Location
- Proposed Culvert
- Designated Watercourse
- Undesignated Watercourse
- Existing Ground Contours (m)

**KEY: SECTION**

- Existing Ground Level - Mainline Red
- Proposed Ground Level - Mainline Red

**NOTES**

- Contours are provided for illustration purposes only.
- For information on drainage structures refer to preliminary design drawings.

**PLAN: PROPOSED RED ALIGNMENT**  
SCALE 1:1250 @ A1; 1:2500 @ A3

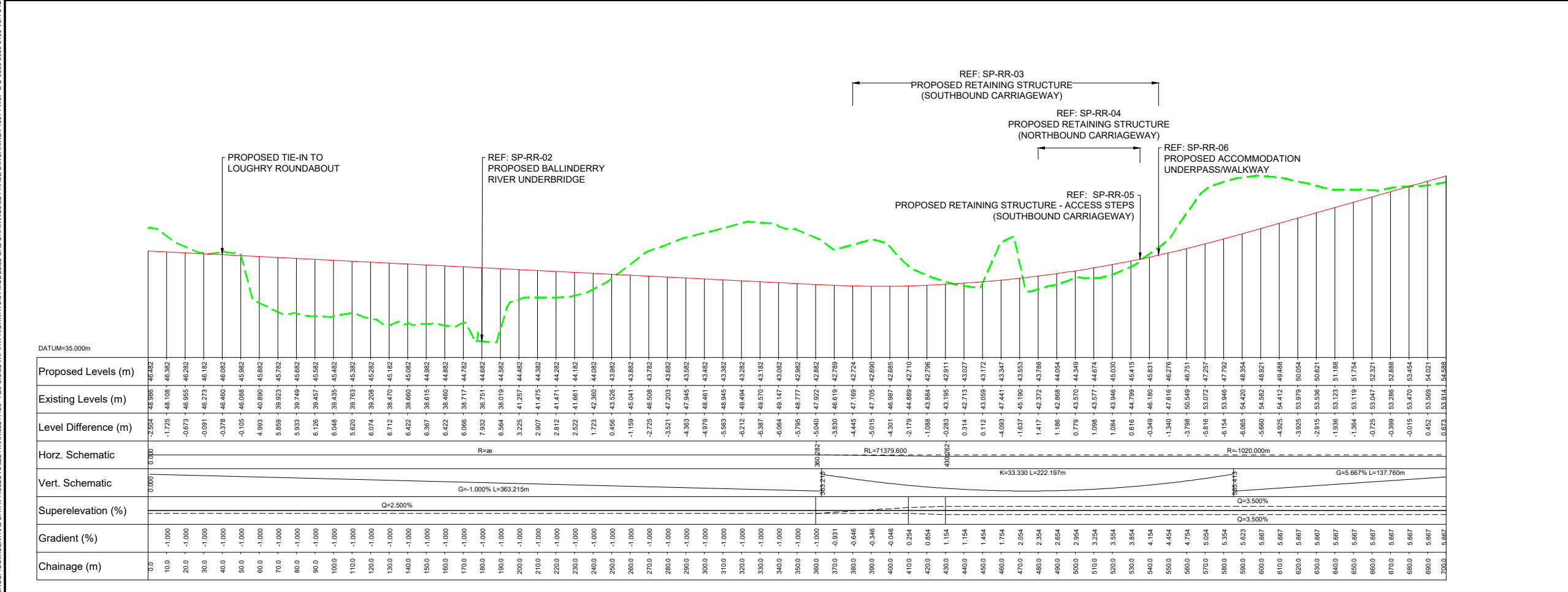

**PROFILE: PROPOSED RED ALIGNMENT**  
SCALE H 1:1250, V 1:250 @ A1; H 1:2500, V 1:500 @ A3

4.0	STG 2 FENCELINE & PROPOSED STRUCTURE LABELS ADDED	JS	LE	LE	26/08/20
3.0	CONTOURS UPDATED	RPW	LE	EL	14/10/19
Ver	Amendment	By	Checked	Approved	Date

DRAWING STATUS: **PRELIMINARY**

Shorefield House, 30 Kinnegar Drive, Holywood, County Down, BT18 9JQ, UK  
T+ 44 (0) 28 95953020  
wsp.com

CLIENT:

SITE PROJECT: **A29 COOKSTOWN BYPASS**

TITLE: **STAGE 2 - RED ROUTE MAINLINE PLAN AND PROFILE SHEET 1 OF 5**

SCALE @ A1: AS SHOWN	SCALE @ A3: AS SHOWN	CHECKED: RPW 01/07/2019	APPROVED: LE 01/07/2019
PROJECT NO: 718314	DESIGNED: WSP	DRAWN: NA	DATE: 01/07/2019

DRAWING NO: 718314-WSP-B-D-0800-0099 REV: 4.0

© WSP UK Ltd

File name: \\UK.WSPGROUP.COM\CENTRAL\_DATA\PROJECTS\6224\A29\_C18\02\WIP\HW\_Highways\01\_MODEL\02\_CAD DRAWINGS\02\_PHASE\_EWORKING\718314-WSP-B-D-0800-0099-01\03\_V3\_4\_5\72\_RR\_PAF\_SMG.DWG, printed on 09 September 2020 13:06:38, by Graham, Stephen

OSNI LICENCE  
REPRODUCTION FROM ORDNANCE SURVEY OF NORTHERN IRELAND'S DATA WITH THE PERMISSION OF THE CONTROLLER OF HER MAJESTY'S STATIONERY OFFICE. © CROWN COPYRIGHT AND DATABASE RIGHTS NIMA ES&LA214. UNAUTHORISED REPRODUCTION INFRINGES © CROWN COPYRIGHT AND MAY LEAD TO PROSECUTION OR CIVIL PROCEEDINGS



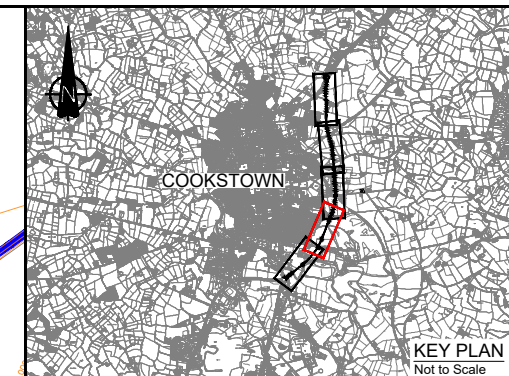
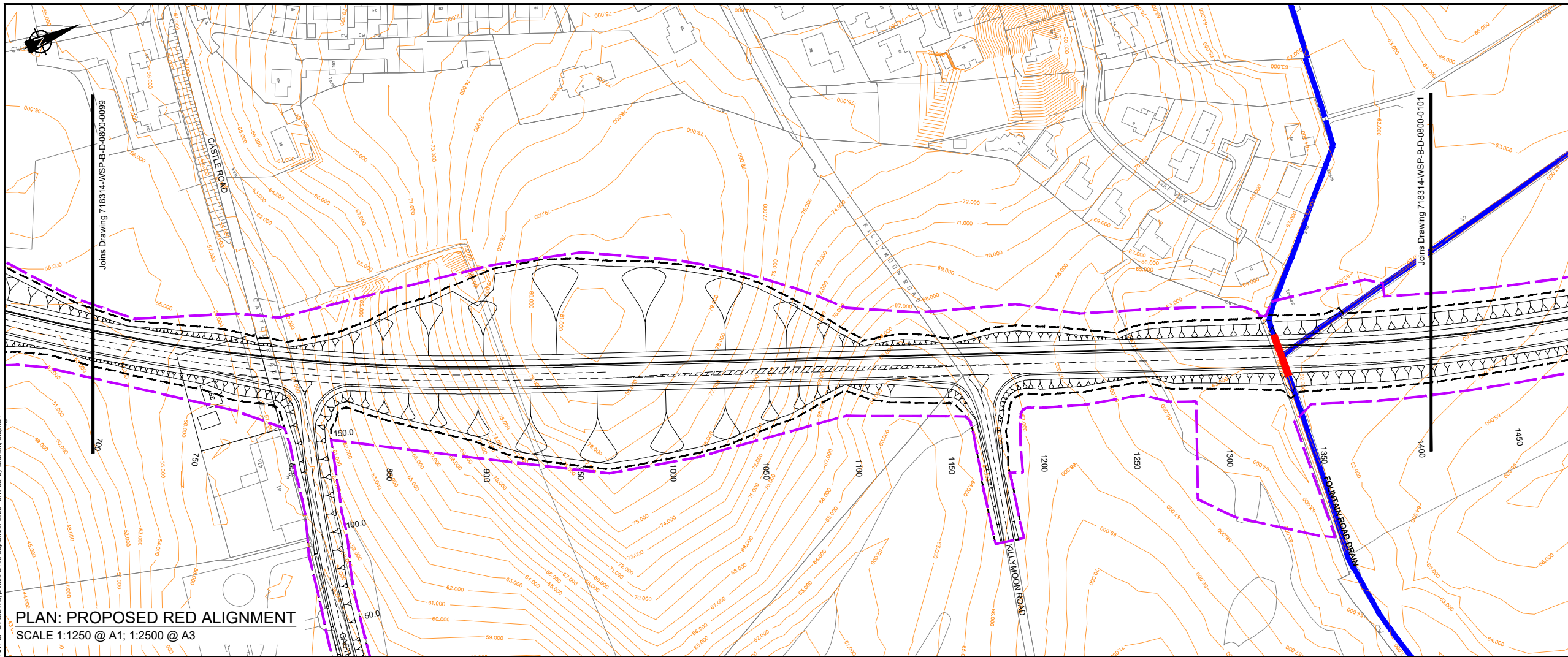

- KEY: PLAN**
- Proposed Red Route Option
  - Proposed Maintenance Strip (3m min)
  - Stage 2 Fenceline
  - Proposed Indicative Structure Location
  - Proposed Culvert
  - Designated Watercourse
  - Undesignated Watercourse
  - Existing Ground Contours (m)
- KEY: SECTION**
- Existing Ground Level - Mainline Red
  - Proposed Ground Level - Mainline Red
- NOTES**
- Contours are provided for illustration purposes only.
  - For information on drainage structures refer to preliminary design drawings.

**PLAN: PROPOSED RED ALIGNMENT**  
SCALE 1:1250 @ A1; 1:2500 @ A3

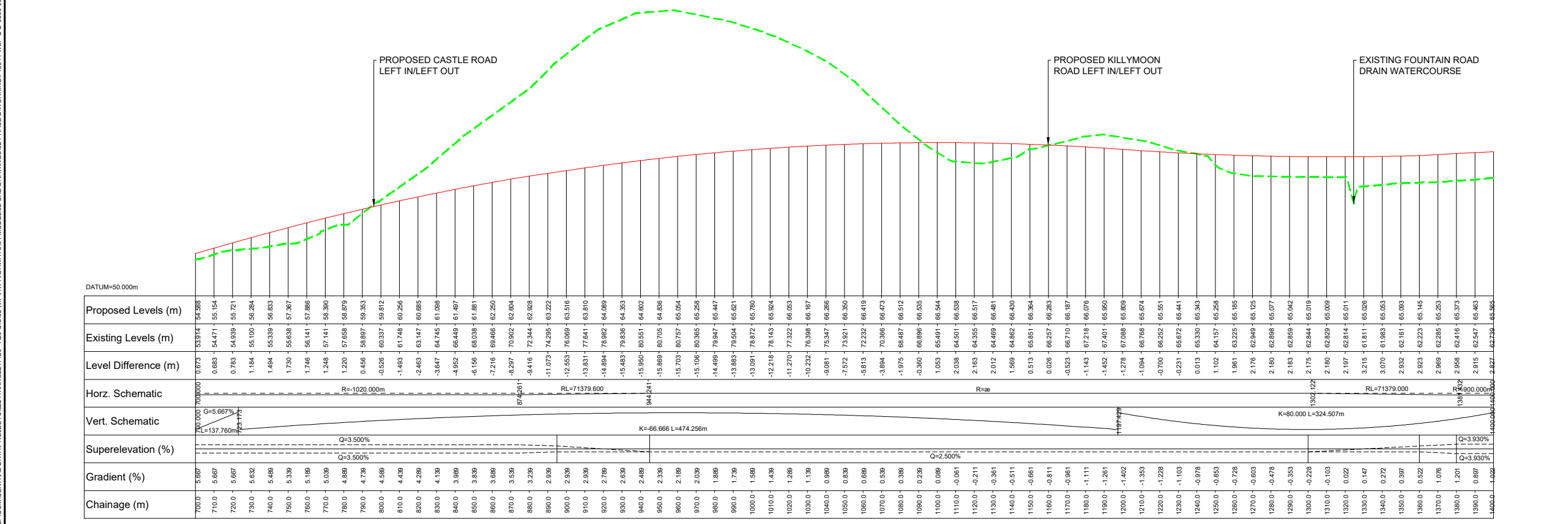

**PROFILE: PROPOSED RED ALIGNMENT**  
SCALE H 1:1250, V 1:250 @ A1; H 1:2500, V 1:500 @ A3

4.0	STG 2 FENCELINE & PROPOSED STRUCTURE LABELS ADDED	JS	LE	LE	26/08/20
3.0	CONTOURS UPDATED	RPW	LE	EL	14/10/19
Ver	Amendment	By	Checked	Approved	Date

DRAWING STATUS: **PRELIMINARY**

Shorefield House, 30 Kinnegar Drive, Holywood, County Down, BT18 9JQ, UK  
T+ 44 (0) 28 95953020  
wsp.com

CLIENT:

**A29 COOKSTOWN BYPASS**

**STAGE 2 - RED ROUTE MAINLINE PLAN AND PROFILE SHEET 2 OF 5**

SCALE @ A1	SCALE @ A3	CHECKED: RPW	01/07/2019	APPROVED: LE	01/07/2019
PROJECT NO: 718314	DESIGNED: WSP	DRAWN: NA	DATE: 01/07/2019		
DRAWING NO: 718314-WSP-B-D-0800-0100					REV: 4.0

OSNI LICENCE  
REPRODUCED FROM ORDNANCE SURVEY OF NORTHERN IRELAND'S DATA WITH THE PERMISSION OF THE CONTROLLER OF HER MAJESTY'S STATIONERY OFFICE. © CROWN COPYRIGHT AND DATABASE RIGHTS NIMA ES&LA214. UNAUTHORISED REPRODUCTION INFRINGES © CROWN COPYRIGHT AND MAY LEAD TO PROSECUTION OR CIVIL PROCEEDINGS



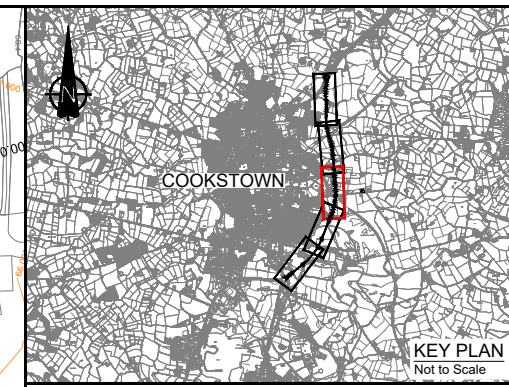
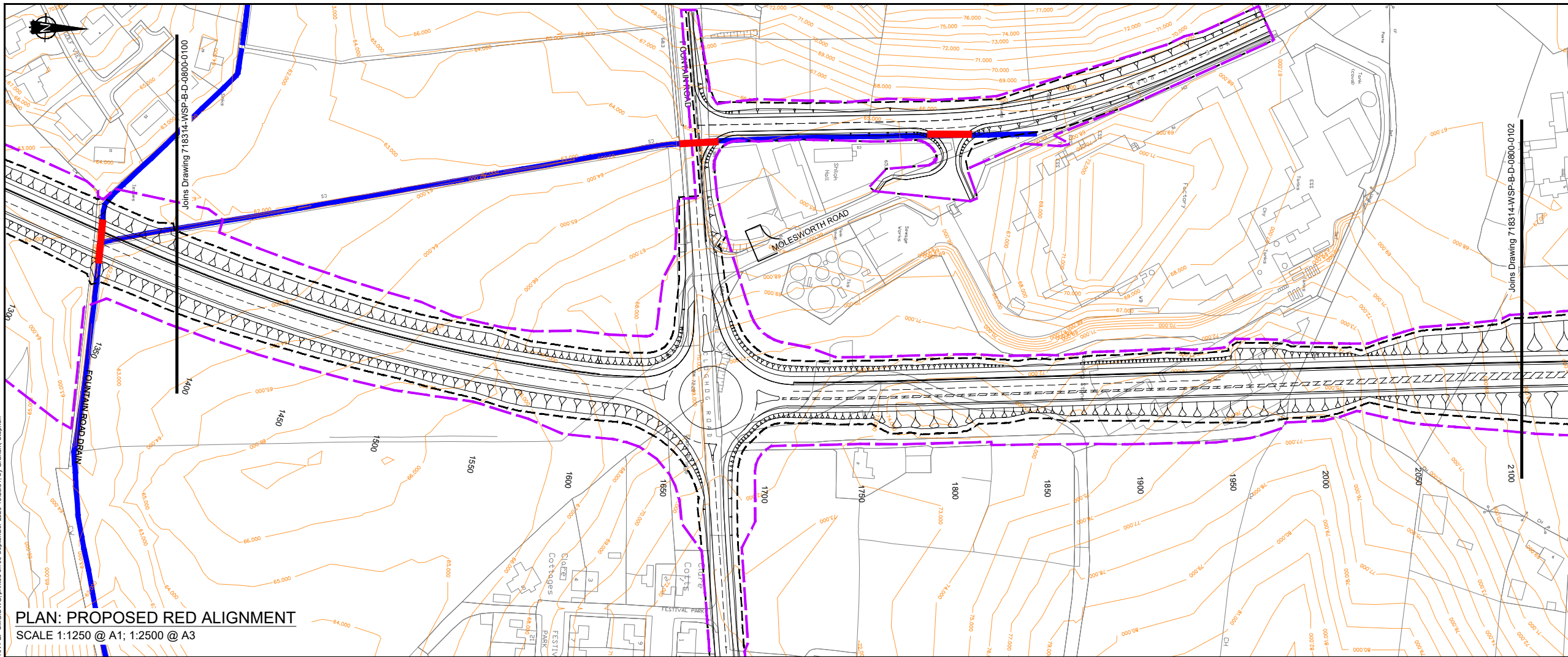

- KEY: PLAN**
- Proposed Red Route Option
  - Proposed Maintenance Strip (3m min)
  - Stage 2 Fenceline
  - Proposed Indicative Structure Location
  - Proposed Culvert
  - Designated Watercourse
  - Undesignated Watercourse
  - Existing Ground Contours (m)

- KEY: SECTION**
- Existing Ground Level - Mainline Red
  - Proposed Ground Level - Mainline Red

- NOTES**
- Contours are provided for illustration purposes only.
  - For information on drainage structures refer to preliminary design drawings.

**PLAN: PROPOSED RED ALIGNMENT**  
SCALE 1:1250 @ A1; 1:2500 @ A3

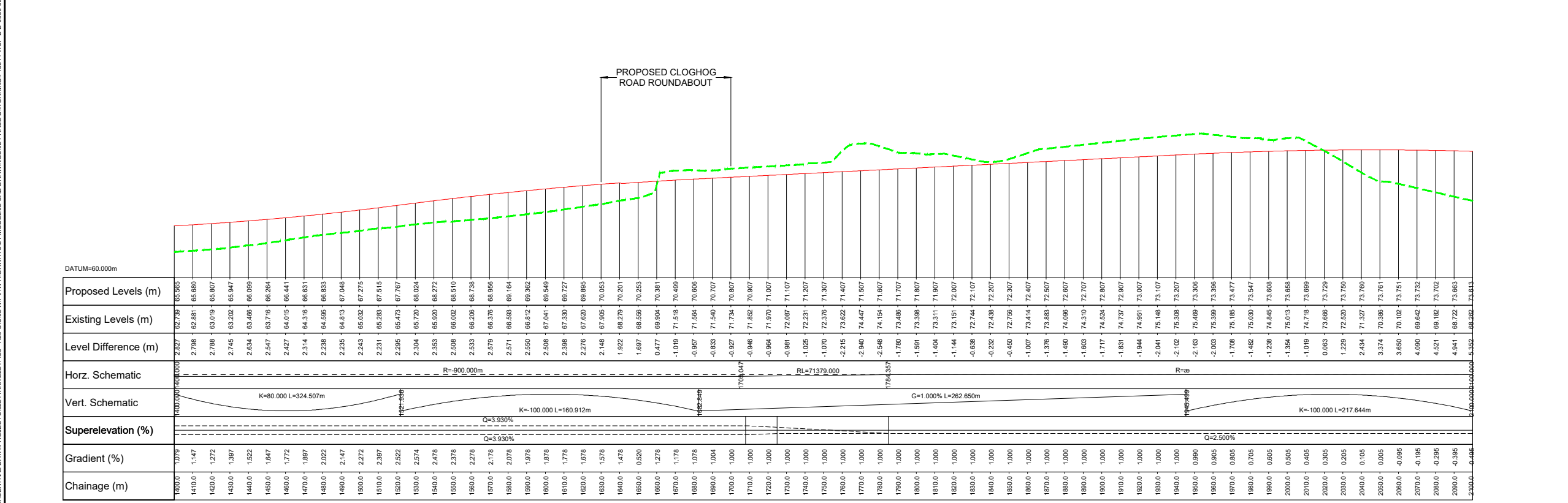

**PROFILE: PROPOSED RED ALIGNMENT**  
SCALE H 1:1250, V 1:250 @ A1; H 1:2500, V 1:500 @ A3

4.0	STG 2 FENCELINE & PROPOSED STRUCTURE LABELS ADDED	JS	LE	LE	26/08/20
3.0	VERTICAL ALIGN. (CH1690-3050m App.) AND CONTOURS UPDATED	RPW	LE	EL	14/10/19
Ver	Amendment	By	Checked	Approved	Date

DRAWING STATUS: **PRELIMINARY**

Shorefield House, 30 Kinnegar Drive, Holywood, County Down, BT18 9JQ, UK  
T+ 44 (0) 28 95953020  
wsp.com

CLIENT:

SITE PROJECT: **A29 COOKSTOWN BYPASS**

TITLE: **STAGE 2 - RED ROUTE MAINLINE PLAN AND PROFILE SHEET 3 OF 5**

SCALE @ A1	SCALE @ A3	CHECKED: RPW	01/07/2019	APPROVED: LE	01/07/2019
PROJECT NO: 718314	DESIGNED: WSP	DRAWN: NA	DATE: 01/07/2019		
DRAWING NO: 718314-WSP-B-D-0800-0101					REV: 4.0

OSNI LICENCE  
REPRODUCED FROM ORDNANCE SURVEY OF NORTHERN IRELAND'S DATA WITH THE PERMISSION OF THE CONTROLLER OF HER MAJESTY'S STATIONERY OFFICE. © CROWN COPYRIGHT AND DATABASE RIGHTS NIMA ES&LA214. UNAUTHORISED REPRODUCTION INFRINGES © CROWN COPYRIGHT AND MAY LEAD TO PROSECUTION OR CIVIL PROCEEDINGS



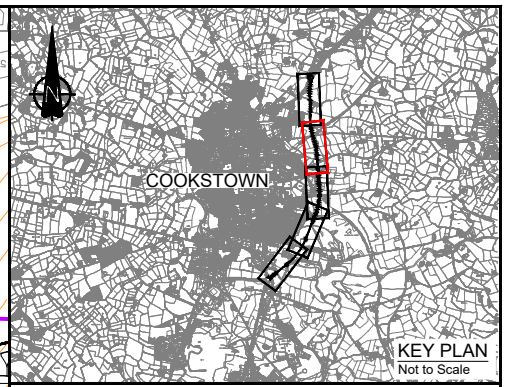
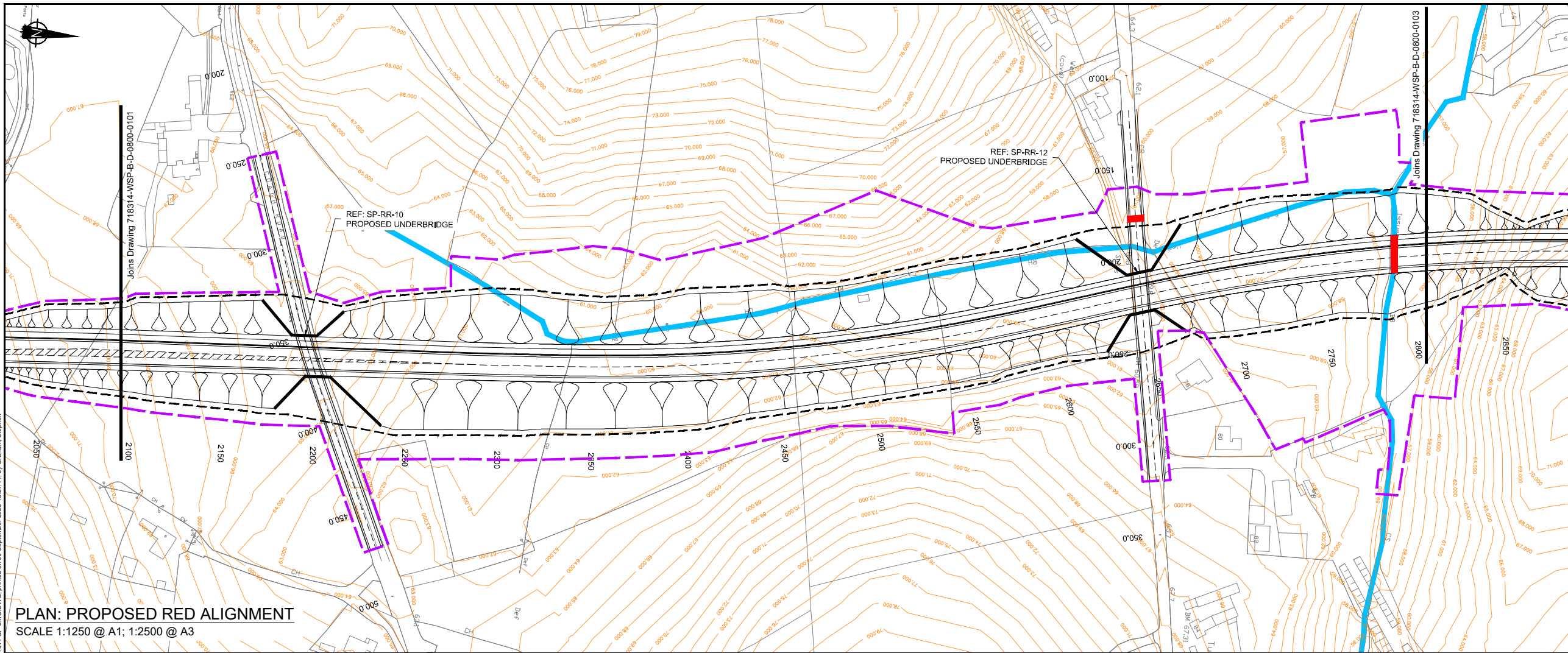

- KEY: PLAN**
- Proposed Red Route Option
  - Proposed Maintenance Strip (3m min)
  - Stage 2 Fenceline
  - Proposed Indicative Structure Location
  - Proposed Culvert
  - Designated Watercourse
  - Undesignated Watercourse
  - Existing Ground Contours (m)
- KEY: SECTION**
- Existing Ground Level - Mainline Red
  - Proposed Ground Level - Mainline Red
- NOTES**
- Contours are provided for illustration purposes only.
  - For information on drainage structures refer to preliminary design drawings.

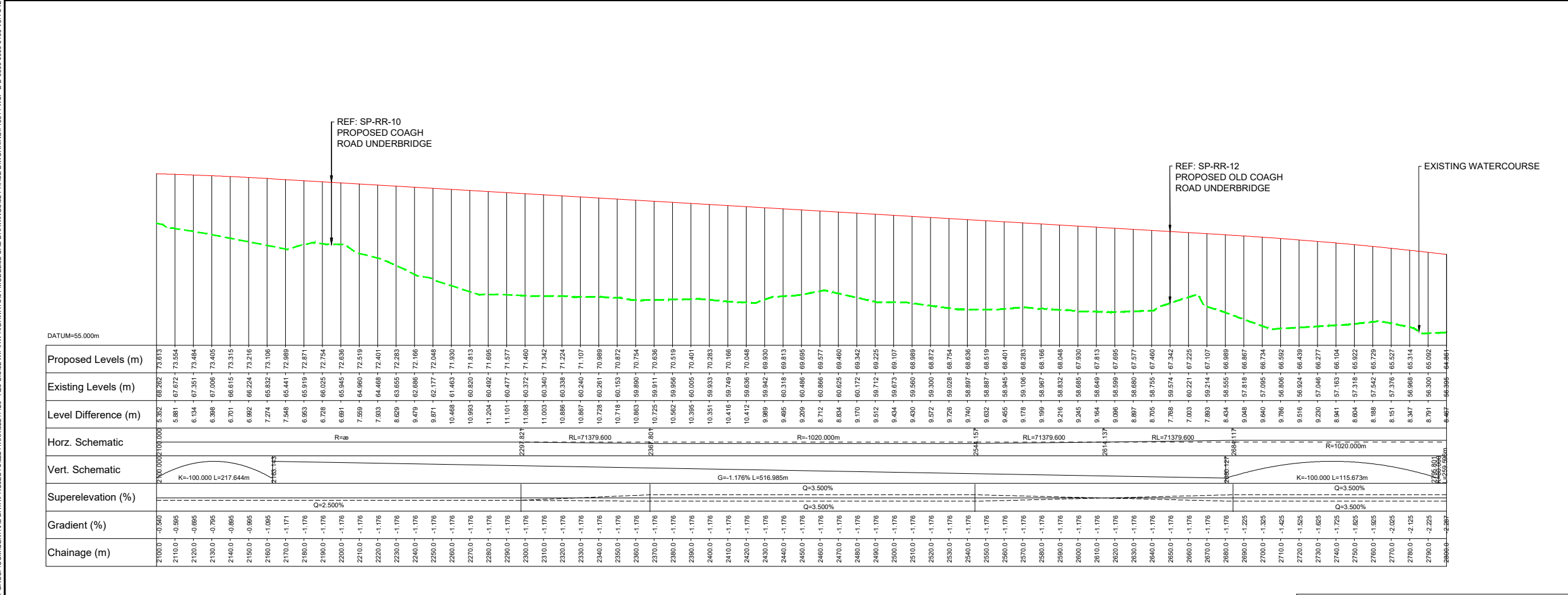

Ver	Amendment	By	Checked	Approved	Date
4.0	STG 2 FENCELINE & PROPOSED STRUCTURE LABELS ADDED	JS	LE	LE	26/08/20
3.0	VERTICAL ALIGN. (CH1690-3050m App.) AND CONTOURS UPDATED	RPW	LE	EL	14/10/19

DRAWING STATUS: **PRELIMINARY**

Shorefield House, 30 Kinnegar Drive, Holywood, County Down, BT18 9JQ, UK  
T+ 44 (0) 28 95953020  
wsp.com

CLIENT:

PROJECT: **A29 COOKSTOWN BYPASS**

TITLE: **STAGE 2 - RED ROUTE MAINLINE PLAN AND PROFILE SHEET 4 OF 5**

SCALE @ A1	SCALE @ A3	CHECKED:	APPROVED:
AS SHOWN		RPW 01/07/2019	LE 01/07/2019
PROJECT NO:	DESIGNED:	DRAWN:	DATE:
718314	WSP	NA	01/07/2019

DRAWING NO:	REV:
718314-WSP-B-D-0800-0102	4.0

OSNI LICENCE  
REPRODUCED FROM ORDNANCE SURVEY OF NORTHERN IRELAND'S DATA WITH THE PERMISSION OF THE CONTROLLER OF HER MAJESTY'S STATIONERY OFFICE. © CROWN COPYRIGHT AND DATABASE RIGHTS NIMA ES&LA214. UNAUTHORISED REPRODUCTION INFRINGES © CROWN COPYRIGHT AND MAY LEAD TO PROSECUTION OR CIVIL PROCEEDINGS

© WSP UK Ltd

File name: \\UK.WSPGROUP.COM\CENTRAL\_DATA\PROJECTS\6241XX\6241420 - A29 C1802 WIP\HW HIGHWAYS\01 MODEL\02 CAD DRAWINGS\02 PHASE B\WORKING\718314-WSP-B-D-0800-0099-0103\_V4\_4 ST2 RR PAF SMG.DWG, printed on 09 September 2020 13:27:44, by Graham, Stephen



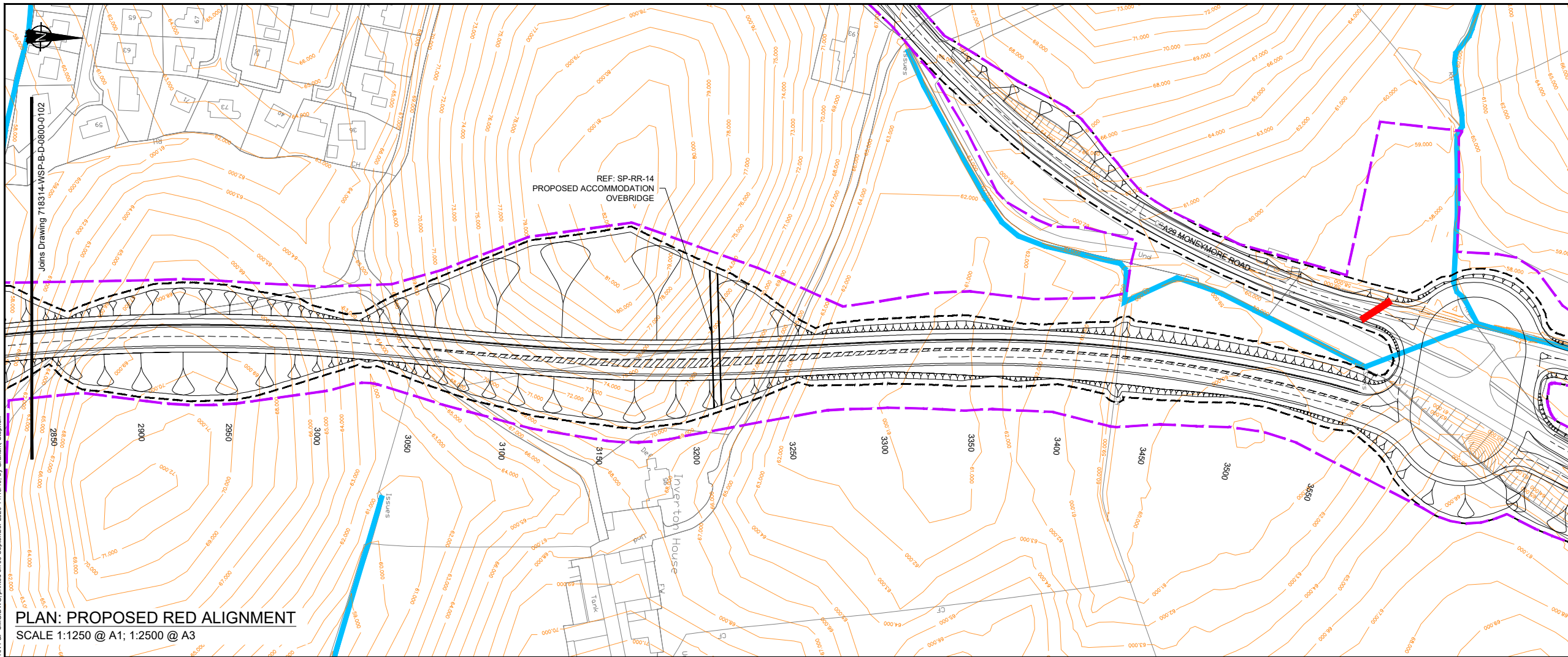

**PLAN: PROPOSED RED ALIGNMENT**  
SCALE 1:1250 @ A1; 1:2500 @ A3



- KEY: PLAN**
- Proposed Red Route Option
  - Stage 2 Fenceline
  - Proposed Maintenance Strip (3m min)
  - Proposed Indicative Structure Location
  - Proposed Culvert
  - Designated Watercourse
  - Undesignated Watercourse
  - Existing Ground Contours (m)

- KEY: SECTION**
- Existing Ground Level - Mainline Red
  - Proposed Ground Level - Mainline Red

- NOTES**
1. Contours are provided for illustration purposes only.
  2. For information on drainage structures refer to preliminary design drawings.

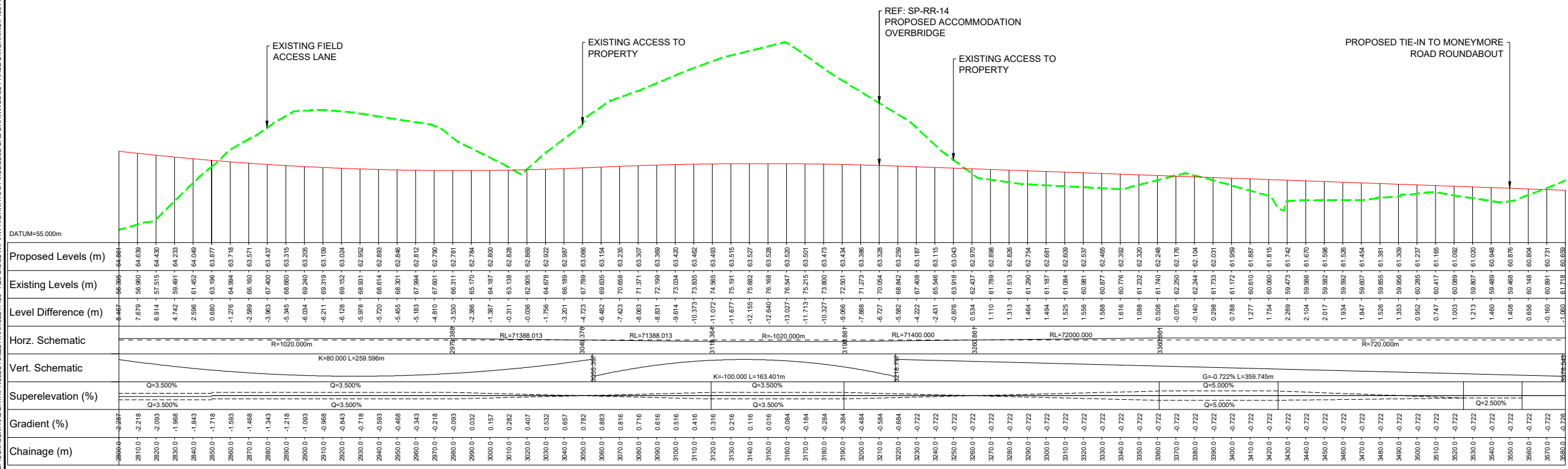

**PROFILE: PROPOSED RED ALIGNMENT**  
SCALE H 1:1250, V 1:250 @ A1; H 1:2500, V 1:500 @ A3

Ver	Amendment	By	Checked	Approved	Date
4.0	STG 2 FENCELINE & PROPOSED STRUCTURE LABELS ADDED	JS	LE	LE	26/08/20
3.0	VERTICAL ALIGN. (CH1690-3050m App.) AND CONTOURS UPDATED	RPW	LE	EL	14/10/19

DRAWING STATUS: **PRELIMINARY**

Shorefield House, 30 Kinnegar Drive, Holywood, County Down, BT18 9JQ, UK  
T+ 44 (0) 28 95953020  
wsp.com

CLIENT:

PROJECT: **A29 COOKSTOWN BYPASS**

TITLE: **STAGE 2 - RED ROUTE MAINLINE PLAN AND PROFILE SHEET 5 OF 5**

SCALE @ A1	SCALE @ A3	CHECKED: RPW	01/07/2019	APPROVED: LE	01/07/2019
PROJECT NO: 718314	DESIGNED: WSP	DRAWN: NA	DATE: 01/07/2019		

DRAWING NO: 718314-WSP-B-D-0800-0103 REV: 4.0

© WSP UK Ltd

File name: I:\UK\WSP\GROUP\COMP\CENTRAL DATA\PROJECTS\A29 COOKSTOWN BYPASS\HIGHWAYS\01 MODEL\02 CAD DRAWINGS\02 PHASE B\WORKING\718314-WSP-B-D-0800-0103\_V3\_4\_372\_RP\_PAF\_SMG.DWG, printed on 09 September 2020 14:18:49, by Graham, Stephen

OSNI LICENCE  
REPRODUCED FROM ORDNANCE SURVEY OF NORTHERN IRELAND'S DATA WITH THE PERMISSION OF THE CONTROLLER OF HER MAJESTY'S STATIONERY OFFICE. © CROWN COPYRIGHT AND DATABASE RIGHTS NIMA ES&LA214. UNAUTHORISED REPRODUCTION INFRINGES © CROWN COPYRIGHT AND MAY LEAD TO PROSECUTION OR CIVIL PROCEEDINGS