

- KEY: PLAN**
- Proposed Red Route Option
 - Proposed Maintenance Strip (3m min)
 - Stage 2 Fenceline
 - Proposed Indicative Structure Location
 - Proposed Culvert
 - Designated Watercourse
 - Undesignated Watercourse
 - Existing Ground Contours (m)

- KEY: SECTION**
- Existing Ground Level - Mainline Red
 - Proposed Ground Level - Mainline Red

- NOTES**
- Contours are provided for illustration purposes only.
 - For information on drainage structures refer to preliminary design drawings.

PLAN: PROPOSED RED ALIGNMENT
SCALE 1:1250 @ A1; 1:2500 @ A3

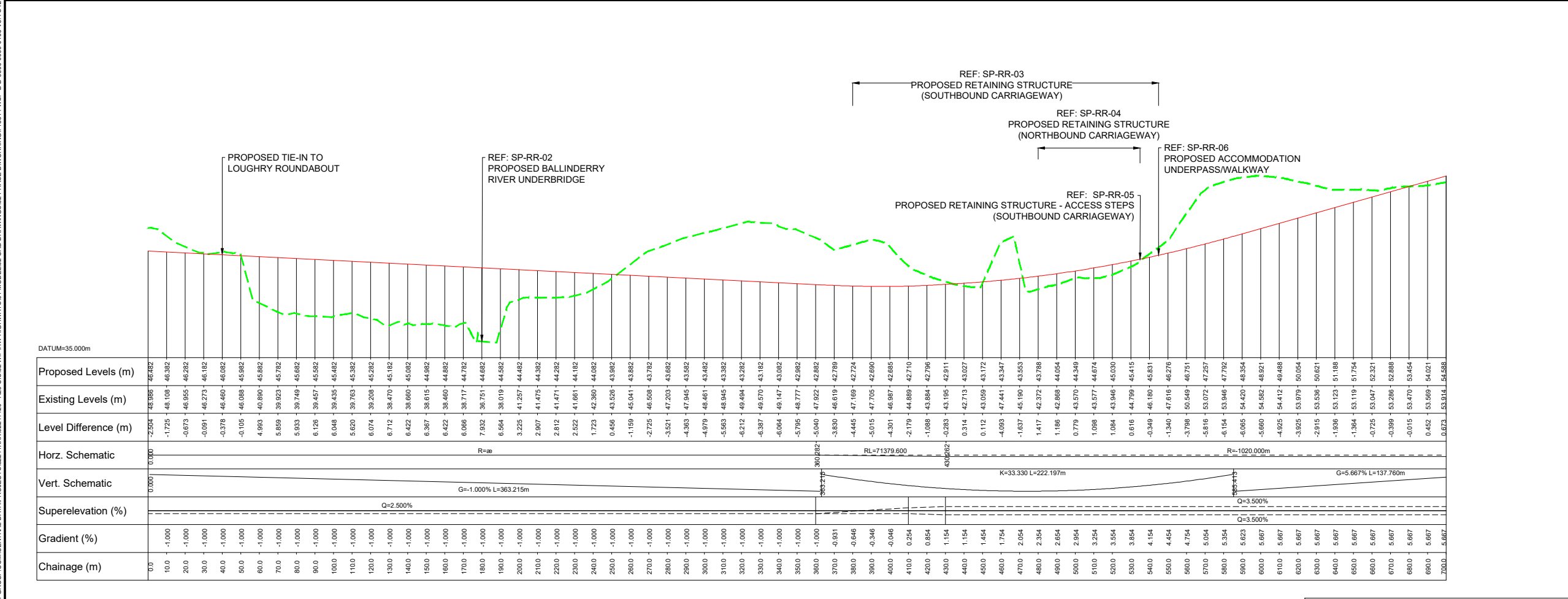

PROFILE: PROPOSED RED ALIGNMENT
SCALE H 1:1250, V 1:250 @ A1; H 1:2500, V 1:500 @ A3

4.0	STG 2 FENCELINE & PROPOSED STRUCTURE LABELS ADDED	JS	LE	LE	26/08/20
3.0	CONTOURS UPDATED	RPW	LE	EL	14/10/19
Ver	Amendment	By	Checked	Approved	Date

DRAWING STATUS: **PRELIMINARY**

Shorefield House, 30 Kinnegar Drive, Holywood, County Down, BT18 9JQ, UK
T+ 44 (0) 28 95953020
wsp.com

CLIENT:

SITE PROJECT: **A29 COOKSTOWN BYPASS**

TITLE: **STAGE 2 - RED ROUTE MAINLINE PLAN AND PROFILE SHEET 1 OF 5**

SCALE @ A1: AS SHOWN	SCALE @ A3: AS SHOWN	CHECKED: RPW 01/07/2019	APPROVED: LE 01/07/2019
PROJECT NO: 718314	DESIGNED: WSP	DRAWN: NA	DATE: 01/07/2019

DRAWING NO: 718314-WSP-B-D-0800-0099	REV: 4.0
--------------------------------------	----------

OSNI LICENCE
REPRODUCTION FROM ORDNANCE SURVEY OF NORTHERN IRELAND'S DATA WITH THE PERMISSION OF THE CONTROLLER OF HER MAJESTY'S STATIONERY OFFICE. © CROWN COPYRIGHT AND DATABASE RIGHTS NIMA ES&LA214. UNAUTHORISED REPRODUCTION INFRINGES © CROWN COPYRIGHT AND MAY LEAD TO PROSECUTION OR CIVIL PROCEEDINGS

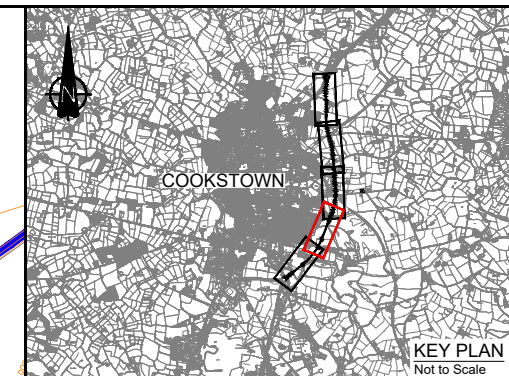
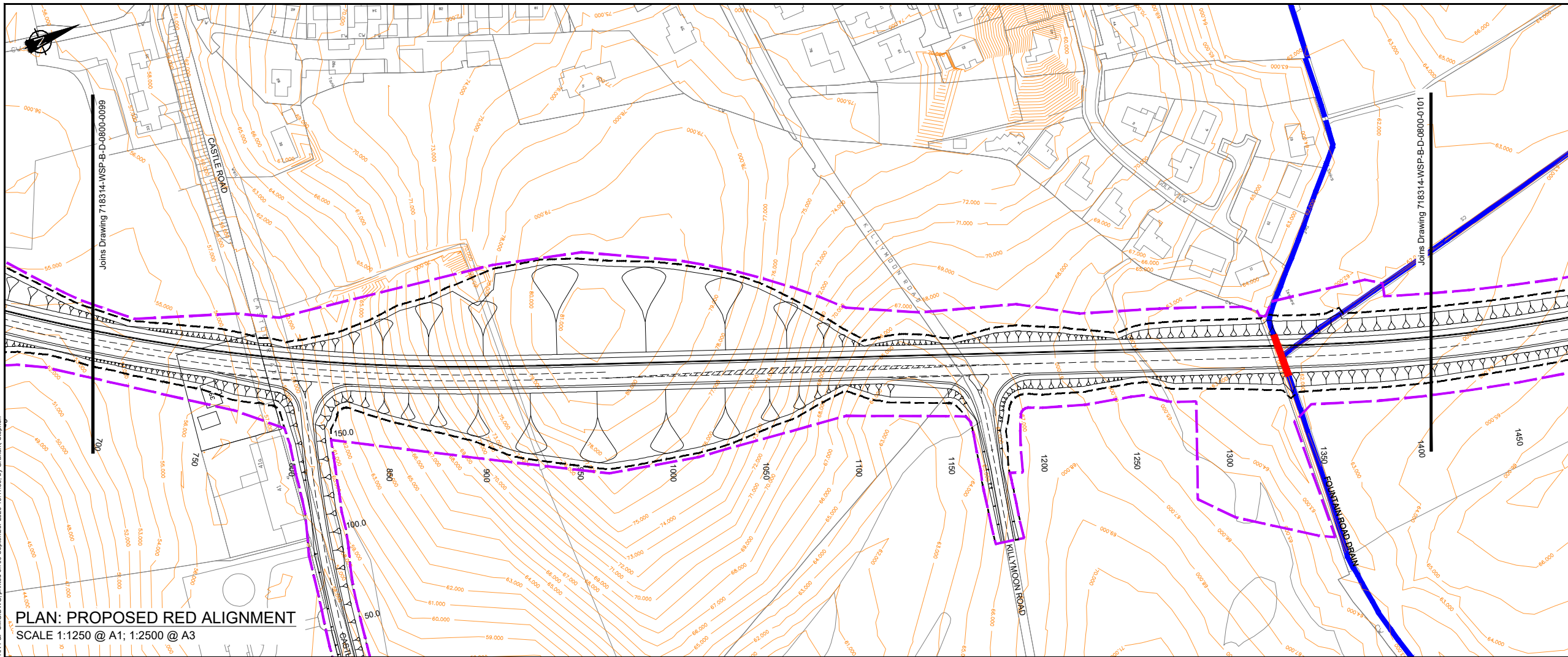

- KEY: PLAN
- Proposed Red Route Option
 - Proposed Maintenance Strip (3m min)
 - Stage 2 Fenceline
 - Proposed Indicative Structure Location
 - Proposed Culvert
 - Designated Watercourse
 - Undesignated Watercourse
 - Existing Ground Contours (m)

- KEY: SECTION
- Existing Ground Level - Mainline Red
 - Proposed Ground Level - Mainline Red

- NOTES
- Contours are provided for illustration purposes only.
 - For information on drainage structures refer to preliminary design drawings.

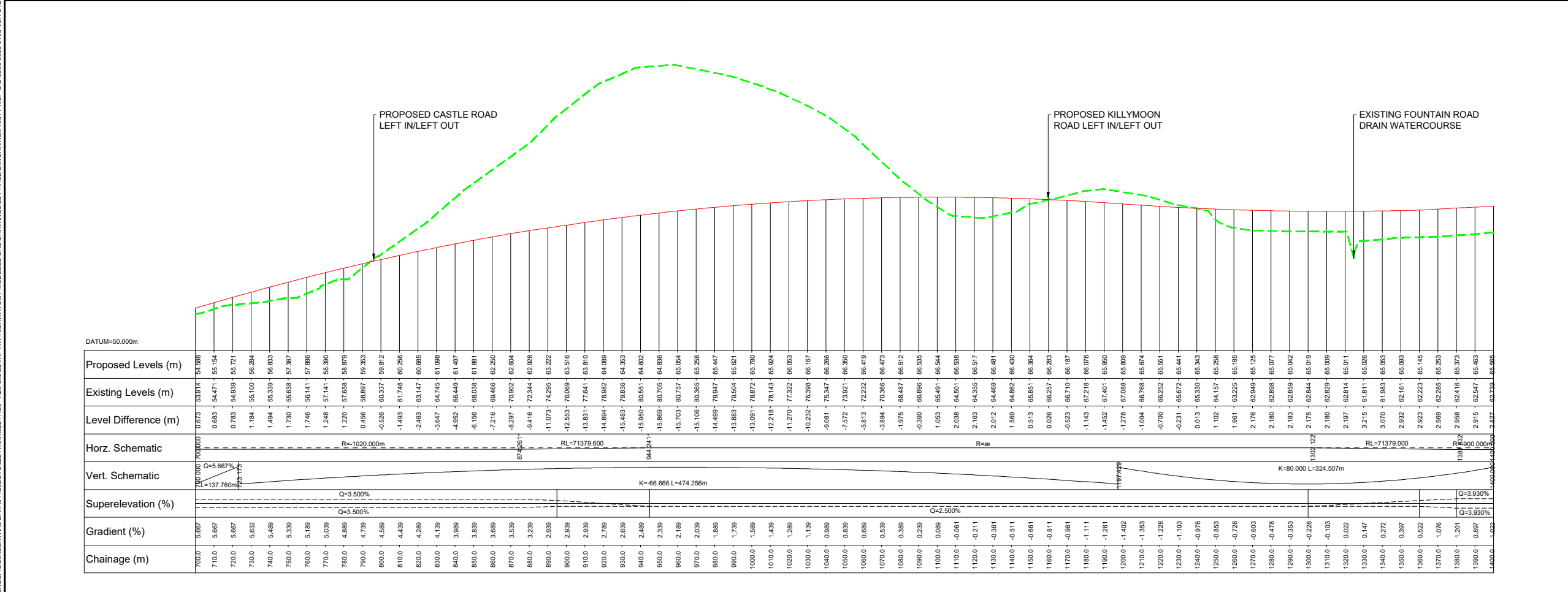

Ver	Amendment	By	Checked	Approved	Date
4.0	STG 2 FENCELINE & PROPOSED STRUCTURE LABELS ADDED	JS	LE	LE	26/08/20
3.0	CONTOURS UPDATED	RPW	LE	EL	14/10/19

DRAWING STATUS: **PRELIMINARY**

Shorefield House, 30 Kinnegar Drive, Holywood, County Down, BT18 9JQ, UK
T+ 44 (0) 28 95953020
wsp.com

CLIENT:

A29 COOKSTOWN BYPASS

STAGE 2 - RED ROUTE MAINLINE PLAN AND PROFILE SHEET 2 OF 5

SCALE @ A1	SCALE @ A3	CHECKED	APPROVED
AS SHOWN		RPW 01/07/2019	LE 01/07/2019

PROJECT NO.	DESIGNED	DRAWN	DATE
718314	WSP	NA	01/07/2019

DRAWING NO.	REV.
718314-WSP-B-D-0800-0100	4.0

PROFILE: PROPOSED RED ALIGNMENT
SCALE H 1:1250, V 1:250 @ A1; H 1:2500, V 1:500 @ A3

OSNI LICENCE
REPRODUCED FROM ORDNANCE SURVEY OF NORTHERN IRELAND'S DATA WITH THE PERMISSION OF THE CONTROLLER OF HER MAJESTY'S STATIONERY OFFICE. © CROWN COPYRIGHT AND DATABASE RIGHTS NIMA ES&LA214. UNAUTHORISED REPRODUCTION INFRINGES © CROWN COPYRIGHT AND MAY LEAD TO PROSECUTION OR CIVIL PROCEEDINGS

© WSP UK Ltd

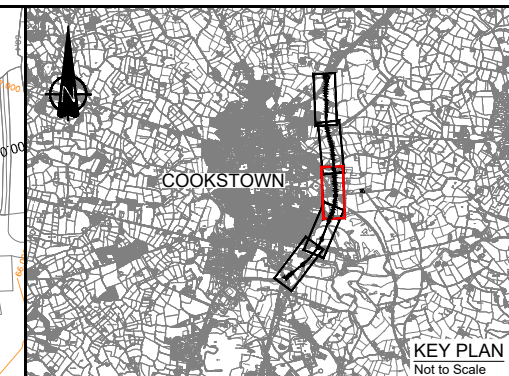
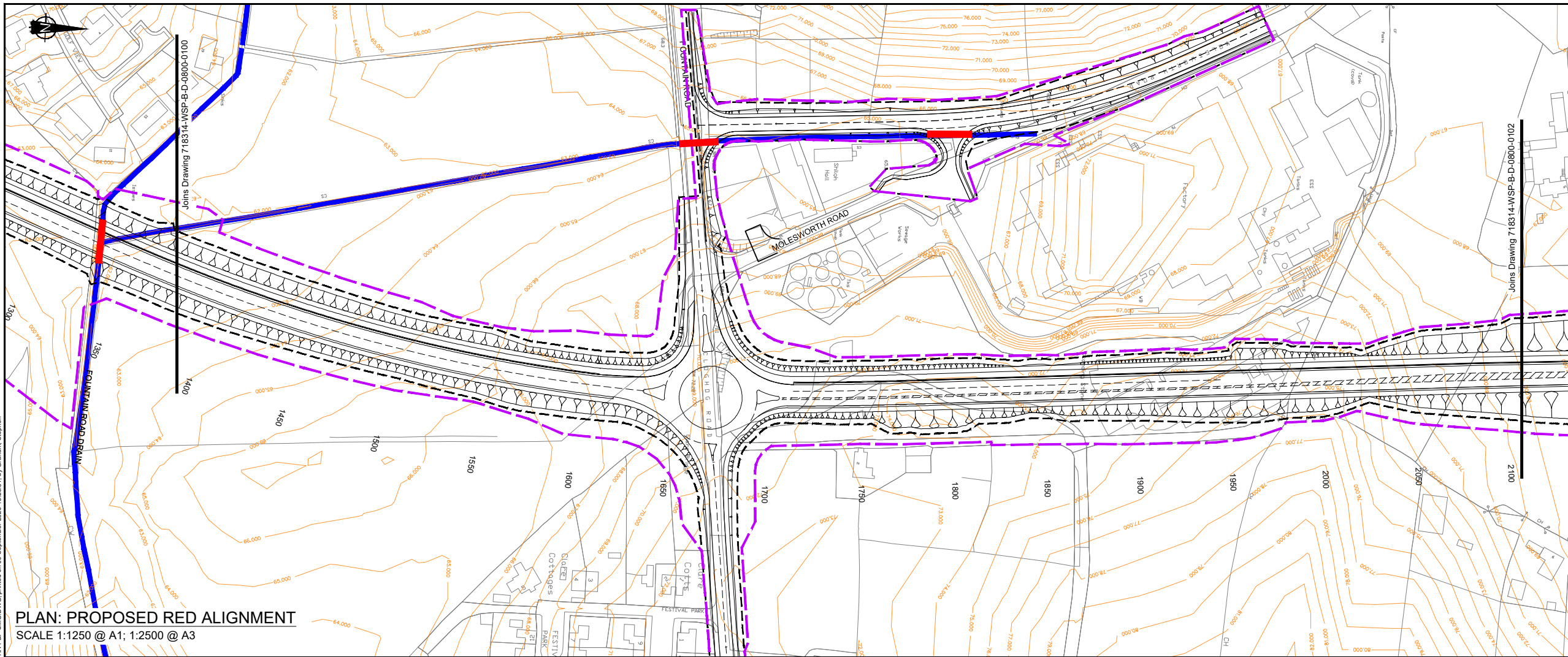

- KEY: PLAN**
- Proposed Red Route Option
 - Proposed Maintenance Strip (3m min)
 - Stage 2 Fenceline
 - Proposed Indicative Structure Location
 - Proposed Culvert
 - Designated Watercourse
 - Undesignated Watercourse
 - Existing Ground Contours (m)

- KEY: SECTION**
- Existing Ground Level - Mainline Red
 - Proposed Ground Level - Mainline Red

- NOTES**
- Contours are provided for illustration purposes only.
 - For information on drainage structures refer to preliminary design drawings.

PLAN: PROPOSED RED ALIGNMENT
SCALE 1:1250 @ A1; 1:2500 @ A3

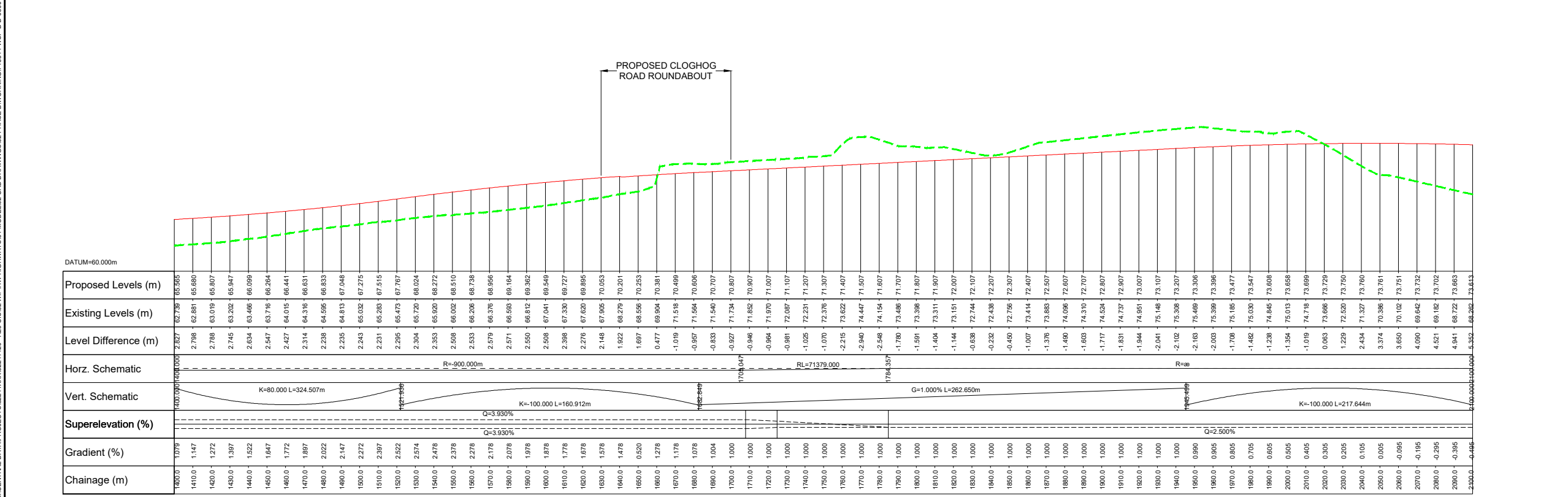

PROFILE: PROPOSED RED ALIGNMENT
SCALE H 1:1250, V 1:250 @ A1; H 1:2500, V 1:500 @ A3

4.0	STG 2 FENCELINE & PROPOSED STRUCTURE LABELS ADDED	JS	LE	LE	26/08/20
3.0	VERTICAL ALIGN. (CH1690-3050m App.) AND CONTOURS UPDATED	RPW	LE	EL	14/10/19
Ver	Amendment	By	Checked	Approved	Date

DRAWING STATUS: **PRELIMINARY**

Shorefield House, 30 Kinnegar Drive, Holywood, County Down, BT18 9JQ, UK
T+ 44 (0) 28 95953020
wsp.com

CLIENT:

SITE PROJECT: **A29 COOKSTOWN BYPASS**

TITLE: **STAGE 2 - RED ROUTE MAINLINE PLAN AND PROFILE SHEET 3 OF 5**

SCALE @ A1	SCALE @ A3	CHECKED: RPW	01/07/2019	APPROVED: LE	01/07/2019
PROJECT NO: 718314	DESIGNED: WSP	DRAWN: NA	DATE: 01/07/2019		
DRAWING NO: 718314-WSP-B-D-0800-0101					REV: 4.0

OSNI LICENCE
REPRODUCED FROM ORDNANCE SURVEY OF NORTHERN IRELAND'S DATA WITH THE PERMISSION OF THE CONTROLLER OF HER MAJESTY'S STATIONERY OFFICE. © CROWN COPYRIGHT AND DATABASE RIGHTS NIMA ES&LA214. UNAUTHORISED REPRODUCTION INFRINGES © CROWN COPYRIGHT AND MAY LEAD TO PROSECUTION OR CIVIL PROCEEDINGS

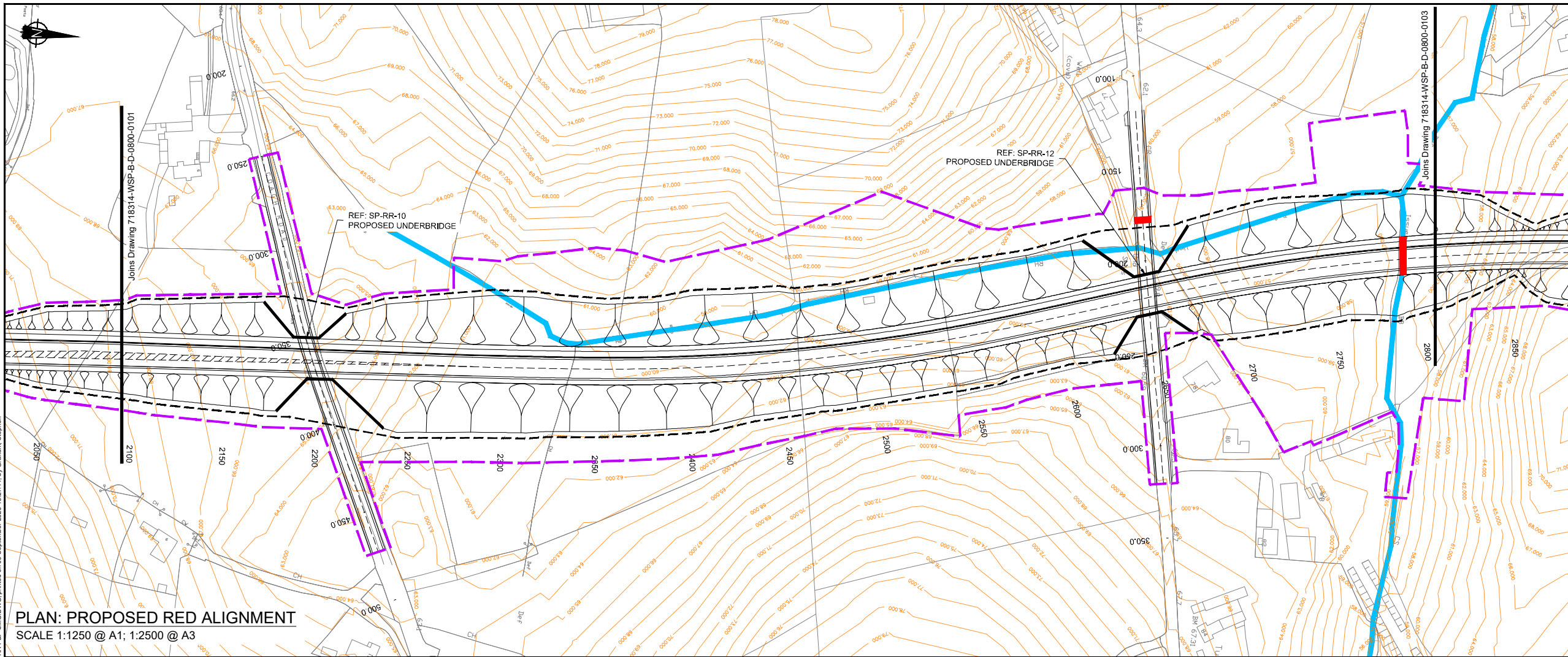

- KEY: PLAN**
- Proposed Red Route Option
 - Proposed Maintenance Strip (3m min)
 - Stage 2 Fenceline
 - Proposed Indicative Structure Location
 - Proposed Culvert
 - Designated Watercourse
 - Undesignated Watercourse
 - Existing Ground Contours (m)
- KEY: SECTION**
- Existing Ground Level - Mainline Red
 - Proposed Ground Level - Mainline Red
- NOTES**
- Contours are provided for illustration purposes only.
 - For information on drainage structures refer to preliminary design drawings.

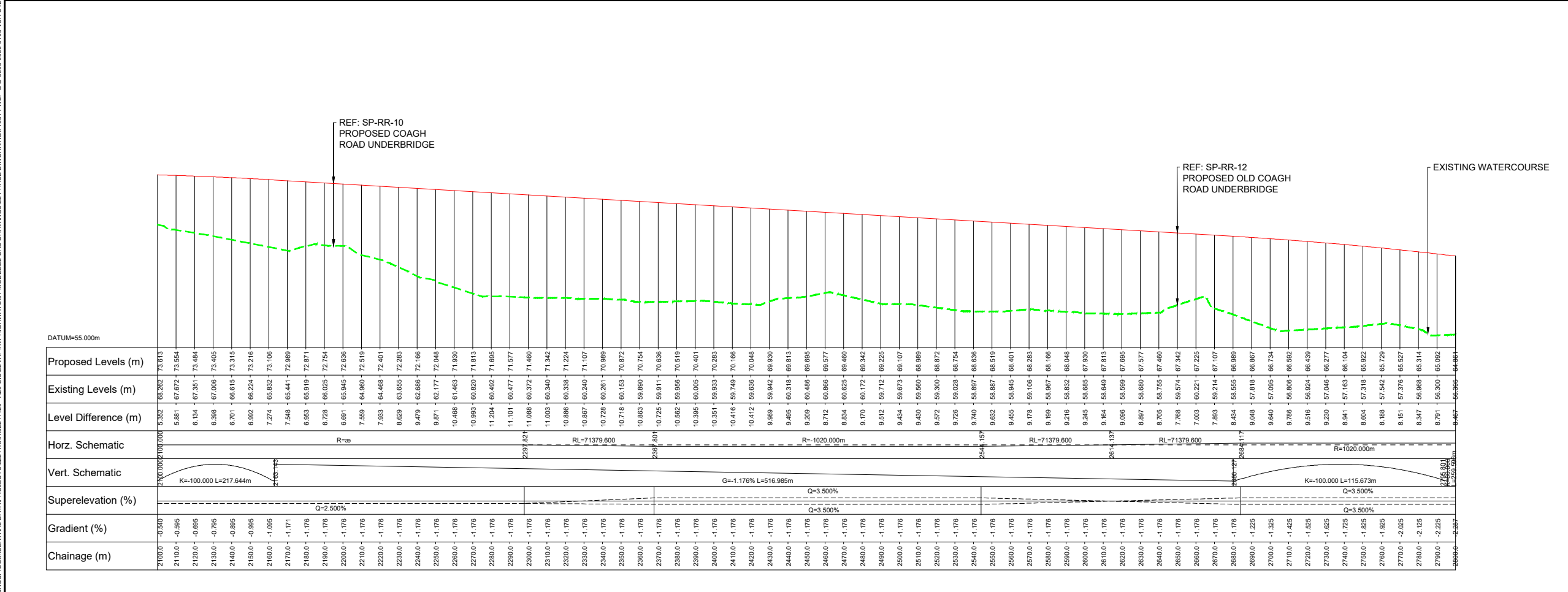

4.0	STG 2 FENCELINE & PROPOSED STRUCTURE LABELS ADDED	JS	LE	LE	26/08/20
3.0	VERTICAL ALIGN. (CH1690-3050m App.) AND CONTOURS UPDATED	RPW	LE	EL	14/10/19
Ver	Amendment	By	Checked	Approved	Date

DRAWING STATUS: **PRELIMINARY**

Shorefield House, 30 Kinnegar Drive, Holywood, County Down, BT18 9JQ, UK
T+ 44 (0) 28 95953020
wsp.com

CLIENT:

PROJECT: **A29 COOKSTOWN BYPASS**

TITLE: **STAGE 2 - RED ROUTE MAINLINE PLAN AND PROFILE SHEET 4 OF 5**

SCALE @ A1 AS SHOWN	SCALE @ A3	CHECKED: RPW	01/07/2019	APPROVED: LE	01/07/2019
PROJECT NO: 718314	DESIGNED: WSP	DRAWN: NA	DATE: 01/07/2019		

DRAWING NO: 718314-WSP-B-D-0800-0102	REV: 4.0
---	-------------

OSNI LICENCE
REPRODUCED FROM ORDNANCE SURVEY OF NORTHERN IRELAND'S DATA WITH THE PERMISSION OF THE CONTROLLER OF HER MAJESTY'S STATIONERY OFFICE. © CROWN COPYRIGHT AND DATABASE RIGHTS NIMA ES&LA214. UNAUTHORISED REPRODUCTION INFRINGES © CROWN COPYRIGHT AND MAY LEAD TO PROSECUTION OR CIVIL PROCEEDINGS

© WSP UK Ltd

File name: \\UK.WSPGROUP.COM\CENTRAL_DATA\PROJECTS\6241XX\6241420 - A29 C1802 WIP\HW HIGHWAYS01 MODEL02 CAD DRAWINGS\02 PHASE B\WORKING\718314-WSP-B-D-0800-099-0103_V4_4 ST2 RR PAF SMG.DWG, printed on 09 September 2020 13:27:44, by Graham, Stephen

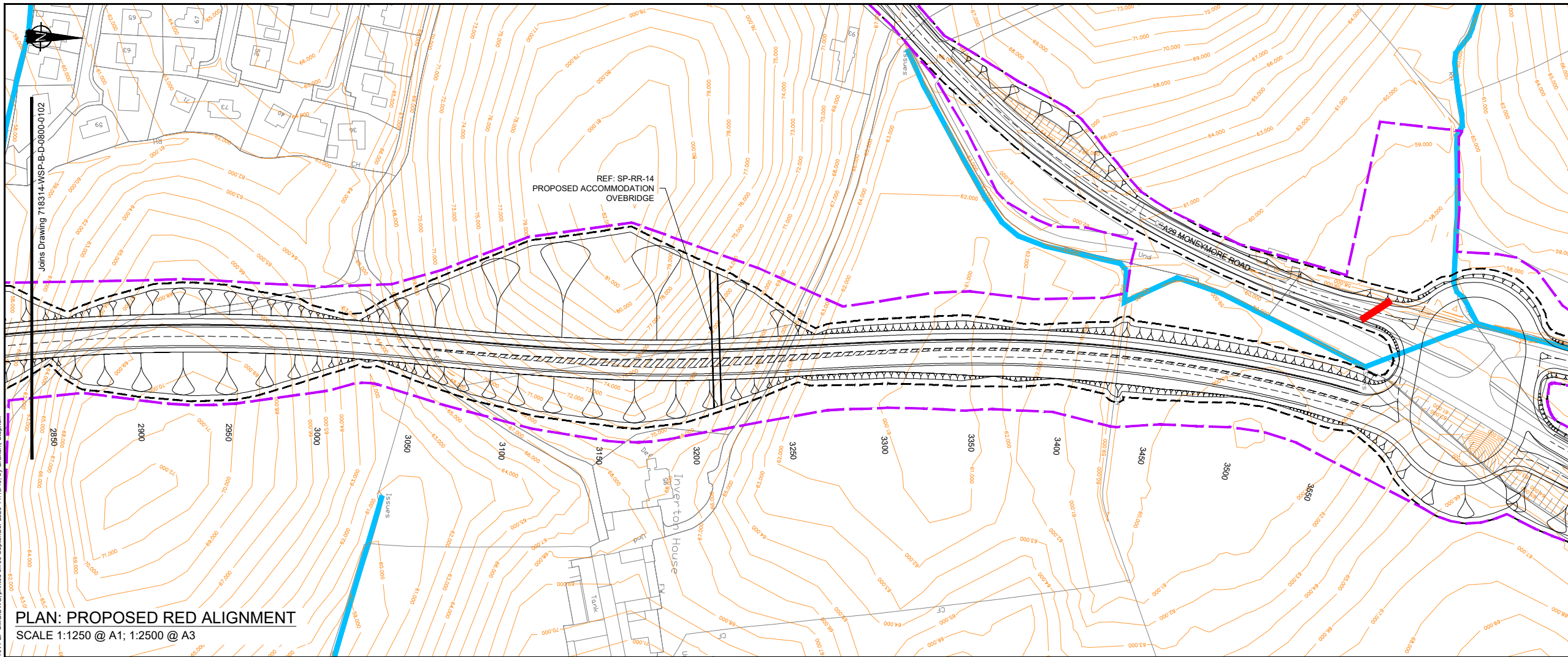

PLAN: PROPOSED RED ALIGNMENT
SCALE 1:1250 @ A1; 1:2500 @ A3



- KEY: PLAN**
- Proposed Red Route Option
 - Stage 2 Fenceline
 - Proposed Maintenance Strip (3m min)
 - Proposed Indicative Structure Location
 - Proposed Culvert
 - Designated Watercourse
 - Undesignated Watercourse
 - Existing Ground Contours (m)

- KEY: SECTION**
- Existing Ground Level - Mainline Red
 - Proposed Ground Level - Mainline Red

- NOTES**
1. Contours are provided for illustration purposes only.
 2. For information on drainage structures refer to preliminary design drawings.

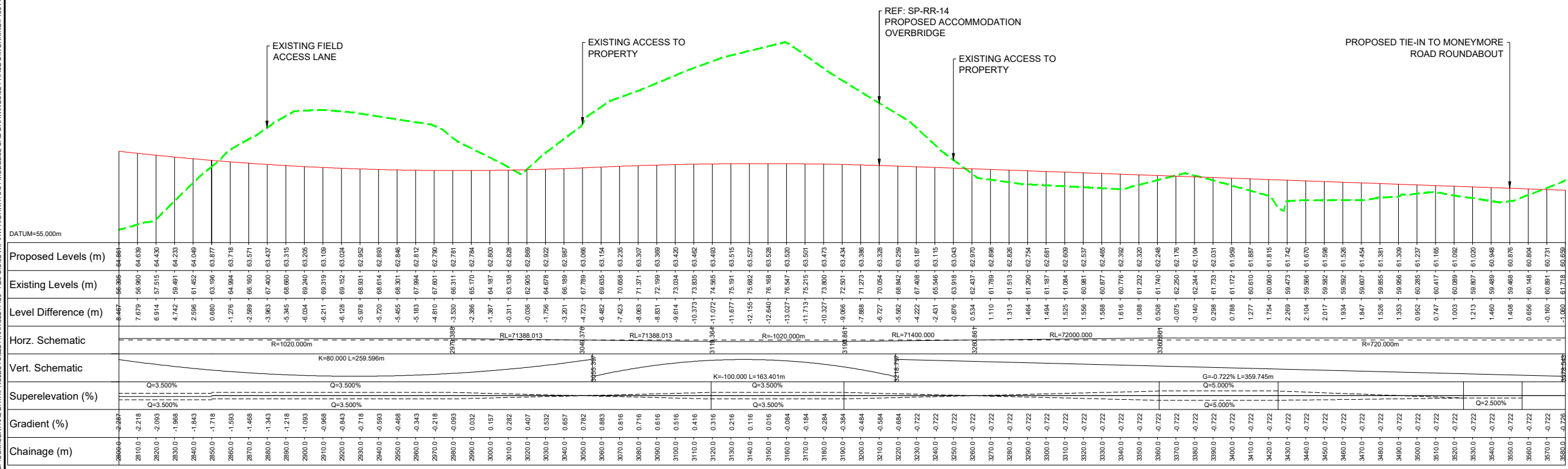

PROFILE: PROPOSED RED ALIGNMENT
SCALE H 1:1250, V 1:250 @ A1; H 1:2500, V 1:500 @ A3

4.0	STG 2 FENCELINE & PROPOSED STRUCTURE LABELS ADDED	JS	LE	LE	26/08/20
3.0	VERTICAL ALIGN. (CH1690-3050m App.) AND CONTOURS UPDATED	RPW	LE	EL	14/10/19
Ver	Amendment	By	Checked	Approved	Date

DRAWING STATUS: **PRELIMINARY**

Shorefield House, 30 Kinnegar Drive, Holywood, County Down, BT18 9JQ, UK
T+ 44 (0) 28 95953020
wsp.com

CLIENT:

PROJECT: **A29 COOKSTOWN BYPASS**

TITLE: **STAGE 2 - RED ROUTE MAINLINE PLAN AND PROFILE SHEET 5 OF 5**

SCALE @ A1	SCALE @ A3	CHECKED: RPW	01/07/2019	APPROVED: LE	01/07/2019
PROJECT NO: 718314	DESIGNED: WSP	DRAWN: NA	DATE: 01/07/2019		
DRAWING NO: 718314-WSP-B-D-0800-0103					REV: 4.0

OSNI LICENCE
REPRODUCED FROM ORDNANCE SURVEY OF NORTHERN IRELAND'S DATA WITH THE PERMISSION OF THE CONTROLLER OF HER MAJESTY'S STATIONERY OFFICE. © CROWN COPYRIGHT AND DATABASE RIGHTS NIMA ES&LA214. UNAUTHORISED REPRODUCTION INFRINGES © CROWN COPYRIGHT AND MAY LEAD TO PROSECUTION OR CIVIL PROCEEDINGS