

Appendix B - Stage 1 (Preliminary Option Assessment) Option Layouts

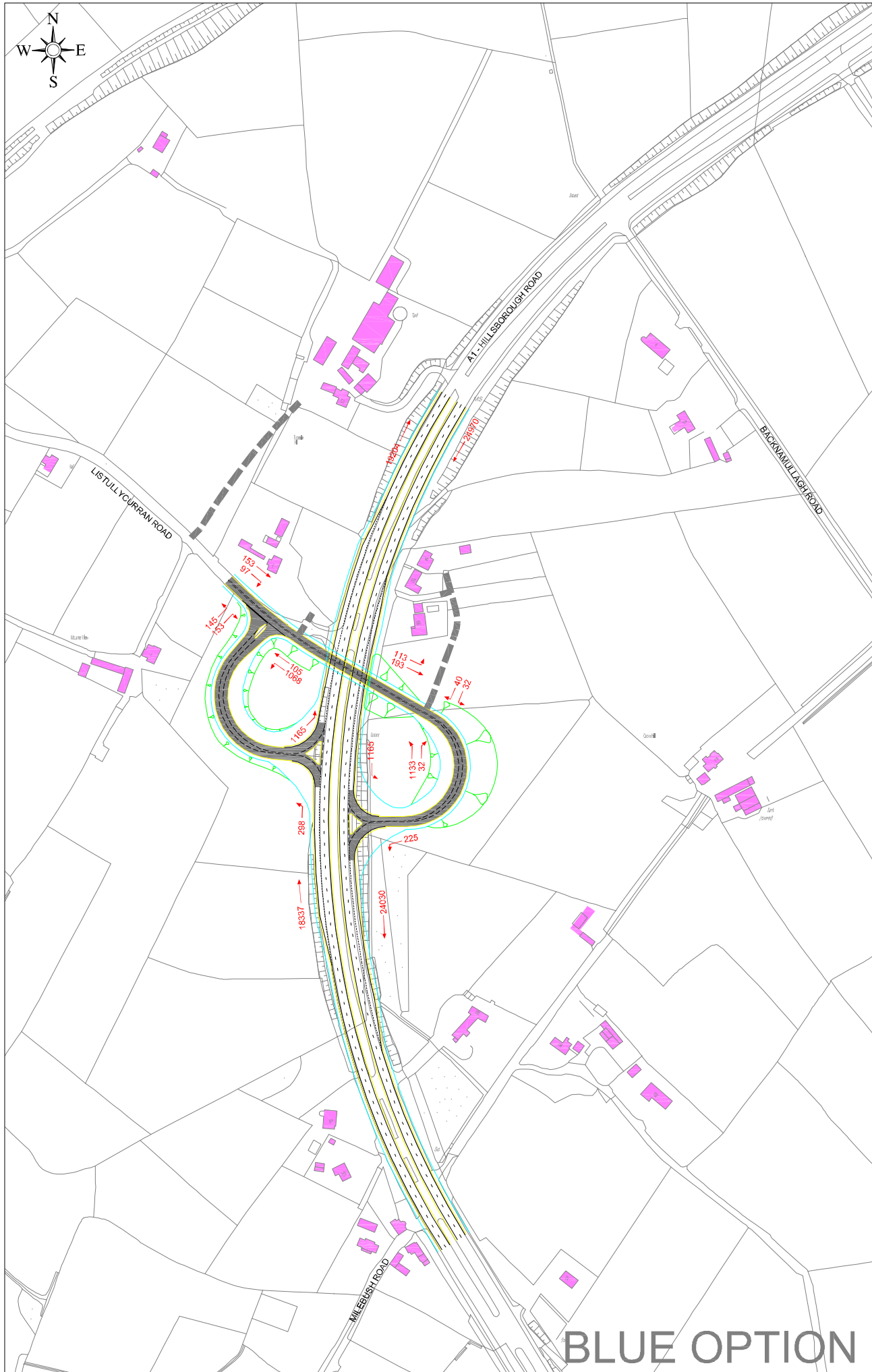

**BLUE OPTION**

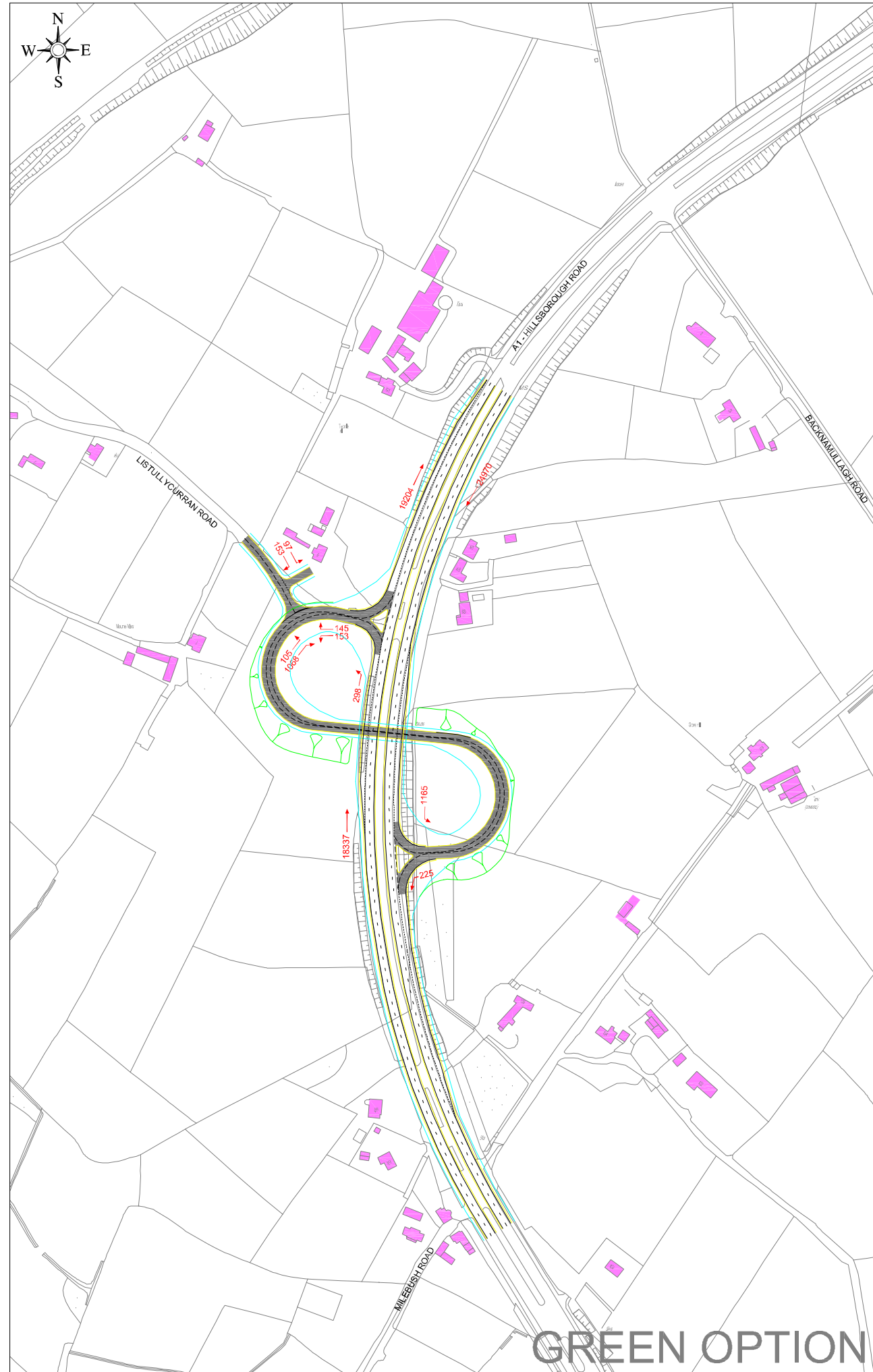

**GREEN OPTION**

**NOTES**  
 1. TRAFFIC FLOWS SHOWN ARE BASED ON A LIMITED RANGE OF SURVEY DATA, MADE UP OF A COMBINATION OF TURNING COUNTS AND SELECT AUTOMATIC TRAFFIC COUNTS ON THE A1. FLOWS ARE 24 HOUR 7 DAY AVERAGE FOR OPENING YEAR (2018) WITH THE CENTRAL RESERVATION CLOSED AT ALL LOCATIONS.

- LEGEND**
- STRUCTURE
  - WATERCOURSE (OSNI)
  - 193  24 HOUR 7 DAY AVERAGE TRAFFIC FLOW
  - POSSIBLE LINK

Rev	Date	Detail	Made	Chk'd	App'd

Status: **DRAFT**



Project: **A1 Junctions Phase 2**

Title: **Listullycurran Road Preliminary Junction Overpass Options Sheet 1 of 3**

Design: TJD	CAD: RPW
Chk'd: TJD	App'd: CA
Date: August 2010	Scale: 1:2000



24 Linenhall Street  
 BELFAST  
 BT2 8BQ  
 Tel: +44 (0) 28 9060 7200  
 Fax: +44 (0) 28 9060 7360  
 www.aecom.com

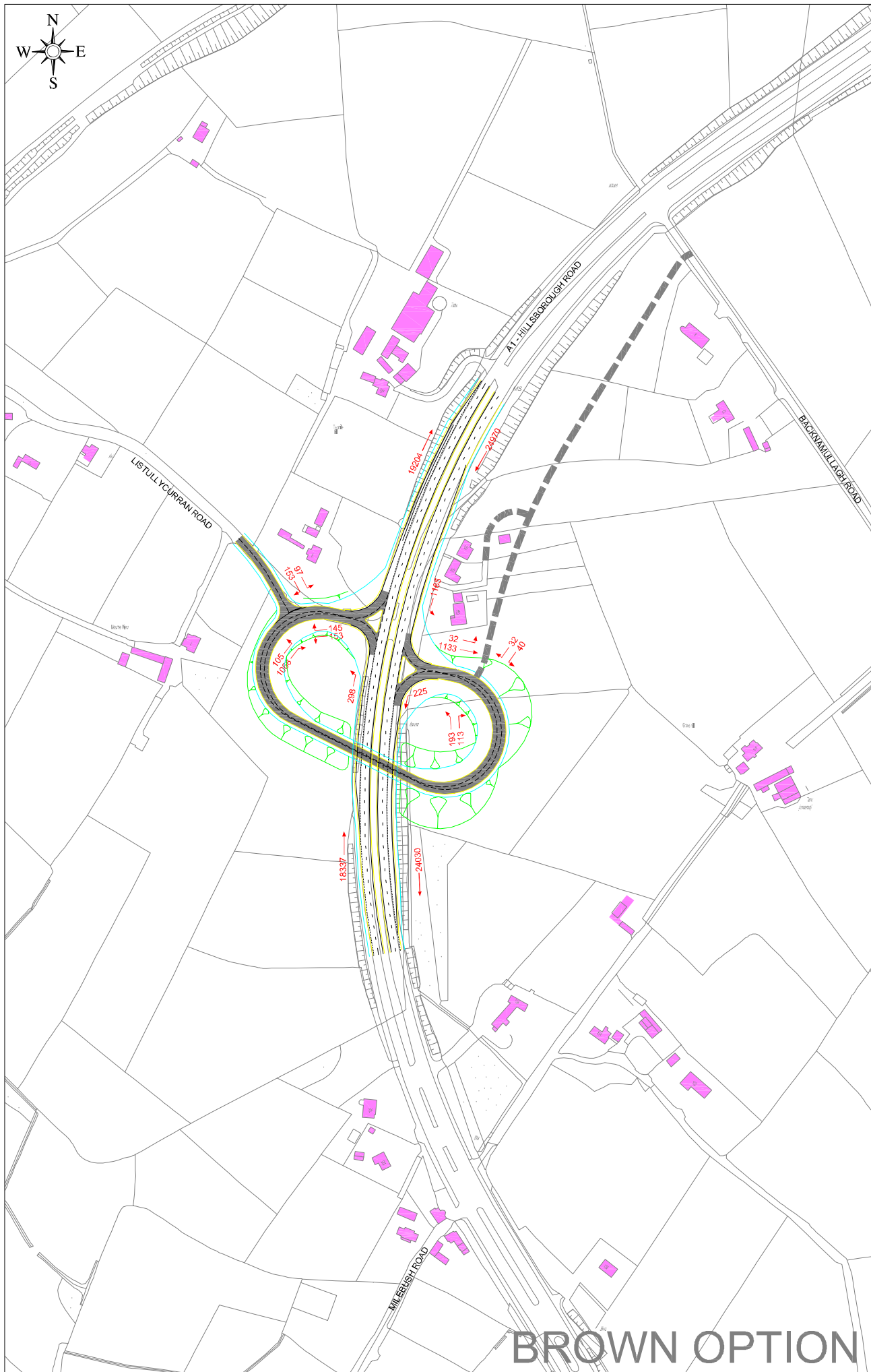

**BROWN OPTION**

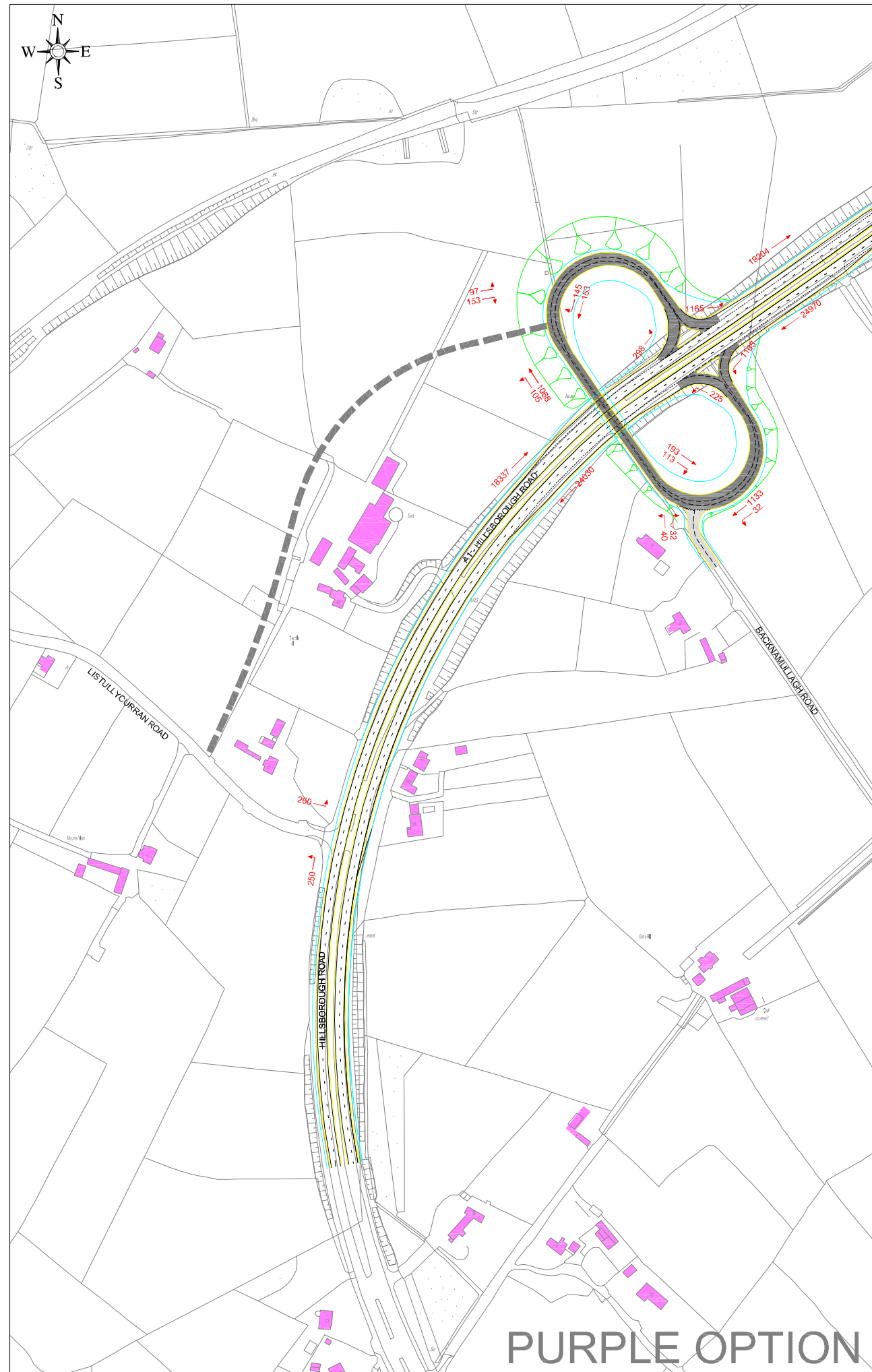

**PURPLE OPTION**

**NOTES**  
 1. TRAFFIC FLOWS SHOWN ARE BASED ON A LIMITED RANGE OF SURVEY DATA, MADE UP OF A COMBINATION OF TURNING COUNTS AND SELECT AUTOMATIC TRAFFIC COUNTS ON THE A1. FLOWS ARE 24 HOUR 7 DAY AVERAGE FOR OPENING YEAR (2018) WITH THE CENTRAL RESERVATION CLOSED AT ALL LOCATIONS.

- LEGEND**
- STRUCTURE
  - WATERCOURSE (OSNI)
  - 193  24 HOUR 7 DAY AVERAGE TRAFFIC FLOW
  - POSSIBLE LINK

Rev	Date	Detail	Made	Chk'd	App'd

Status: **DRAFT**



Project: **A1 Junctions Phase 2**

Title: **Listullycurran Road Preliminary Junction Overpass Option Sheet 2 of 3**

Design: TJD	CAD: RPW
Chk'd: TJD	App'd: CA
Date: August 2010	Scale: 1:2000

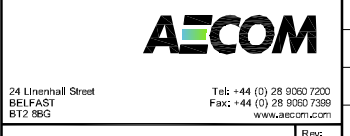

24 Linenhall Street BELFAST BT2 8BQ  
 Tel: +44 (0) 28 9060 7200 Fax: +44 (0) 28 9060 7389 www.aecom.com

No. 60050899/C(94)L152  
 cm A1

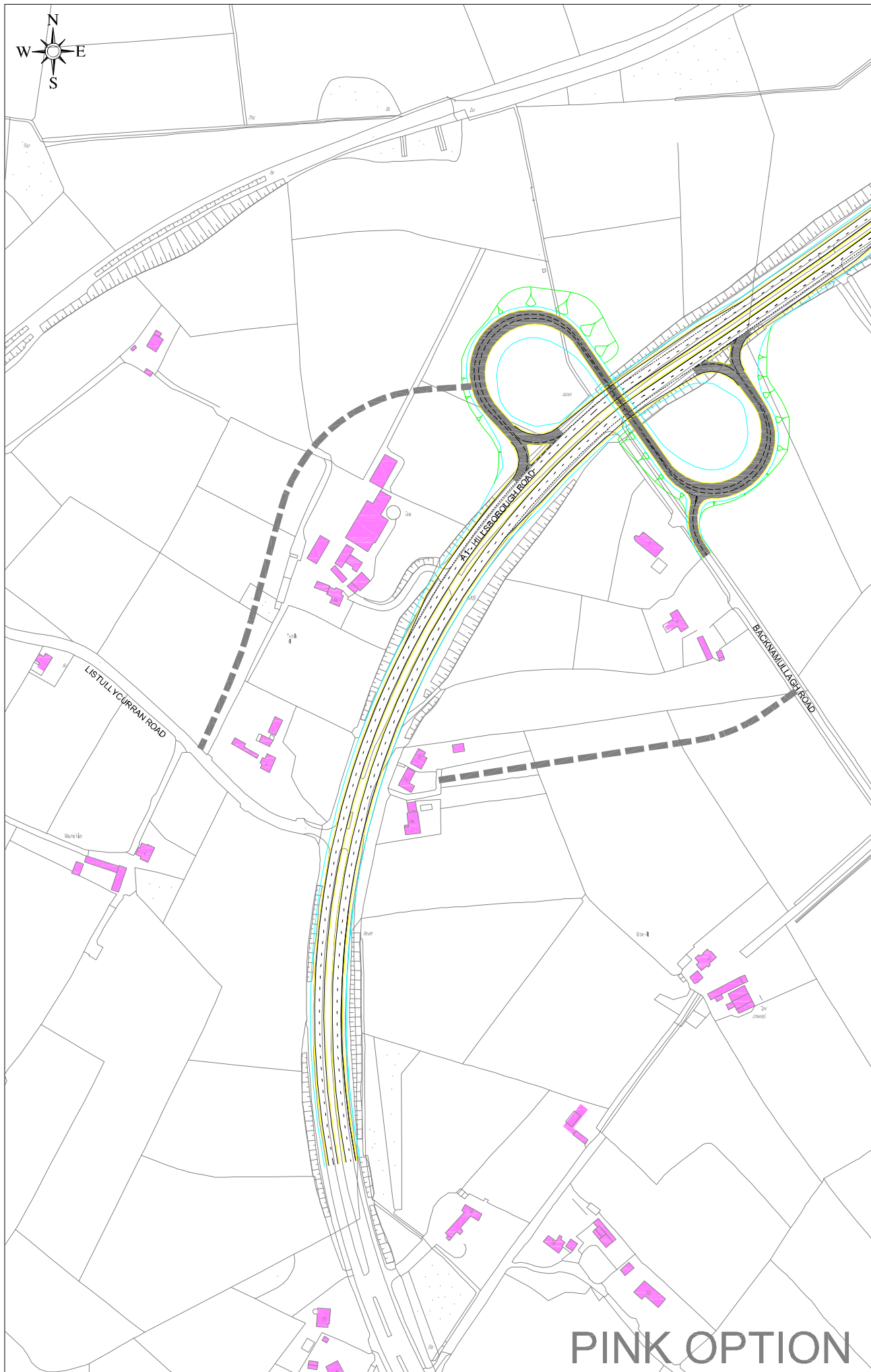

**NOTES**

1. TRAFFIC FLOWS SHOWN ARE BASED ON A LIMITED RANGE OF SURVEY DATA, MADE UP OF A COMBINATION OF TURNING COUNTS AND SELECT AUTOMATIC TRAFFIC COUNTS ON THE A1. FLOWS ARE 24 HOUR 7 DAY AVERAGE FOR OPENING YEAR (2018) WITH THE CENTRAL RESERVATION CLOSED AT ALL LOCATIONS.

**LEGEND**

- STRUCTURE
- WATERCOURSE (OSNI)
- 193  24 HOUR 7 DAY AVERAGE TRAFFIC FLOW
- POSSIBLE LINK

Rev	Date	Detail	Made	Chk'd	App'd

Status: **DRAFT**



Project: **A1 Junctions Phase 2**

Title: **Listullycurran Road Preliminary Junction Overpass Options Sheet 3 of 3**

Design: TJD	CAD: RPW
Chk'd: TJD	App'd: CA
Date: August 2010	Scale: 1:2000



No. 60050899/C(94)L153

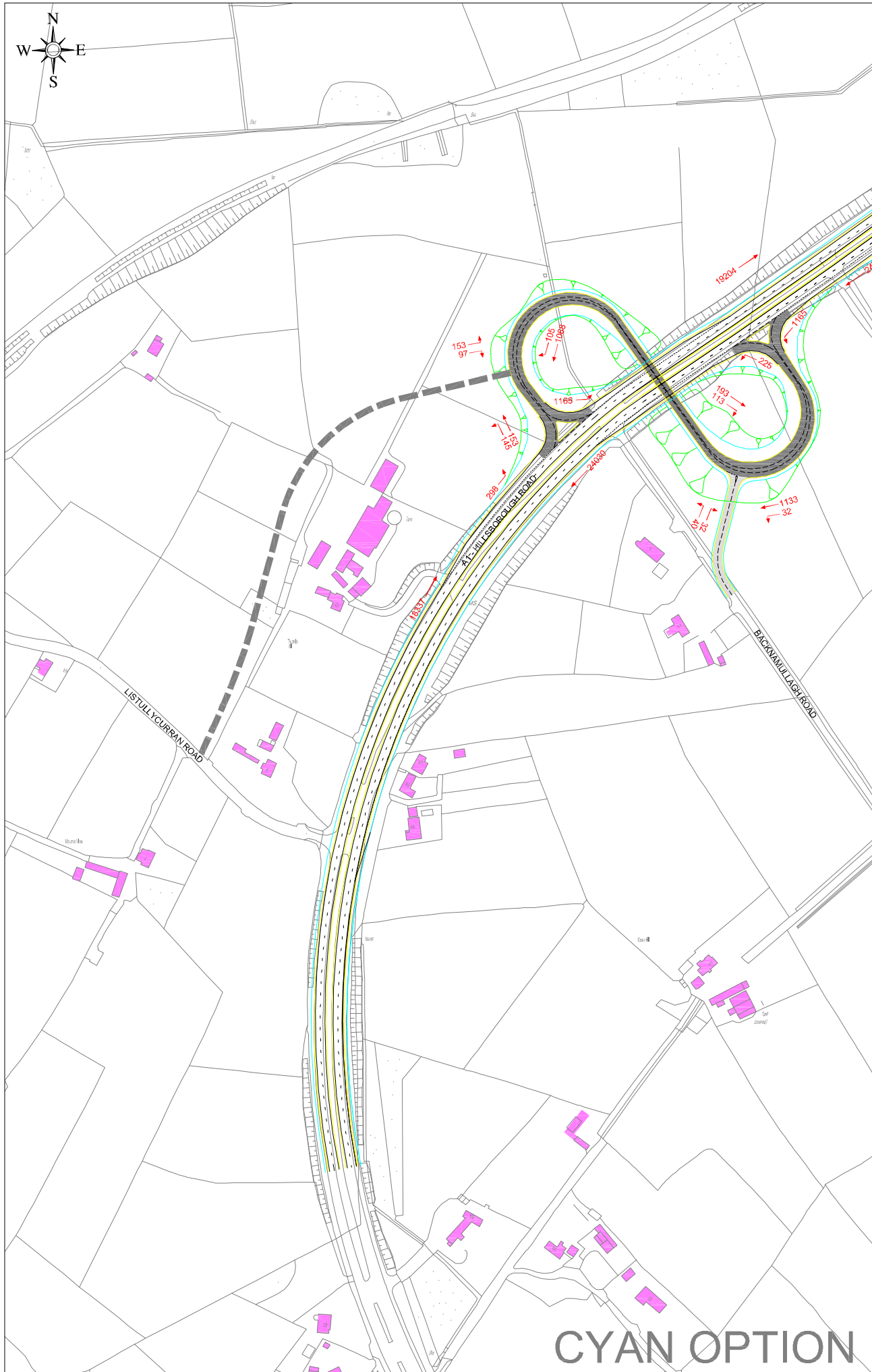

CYAN OPTION

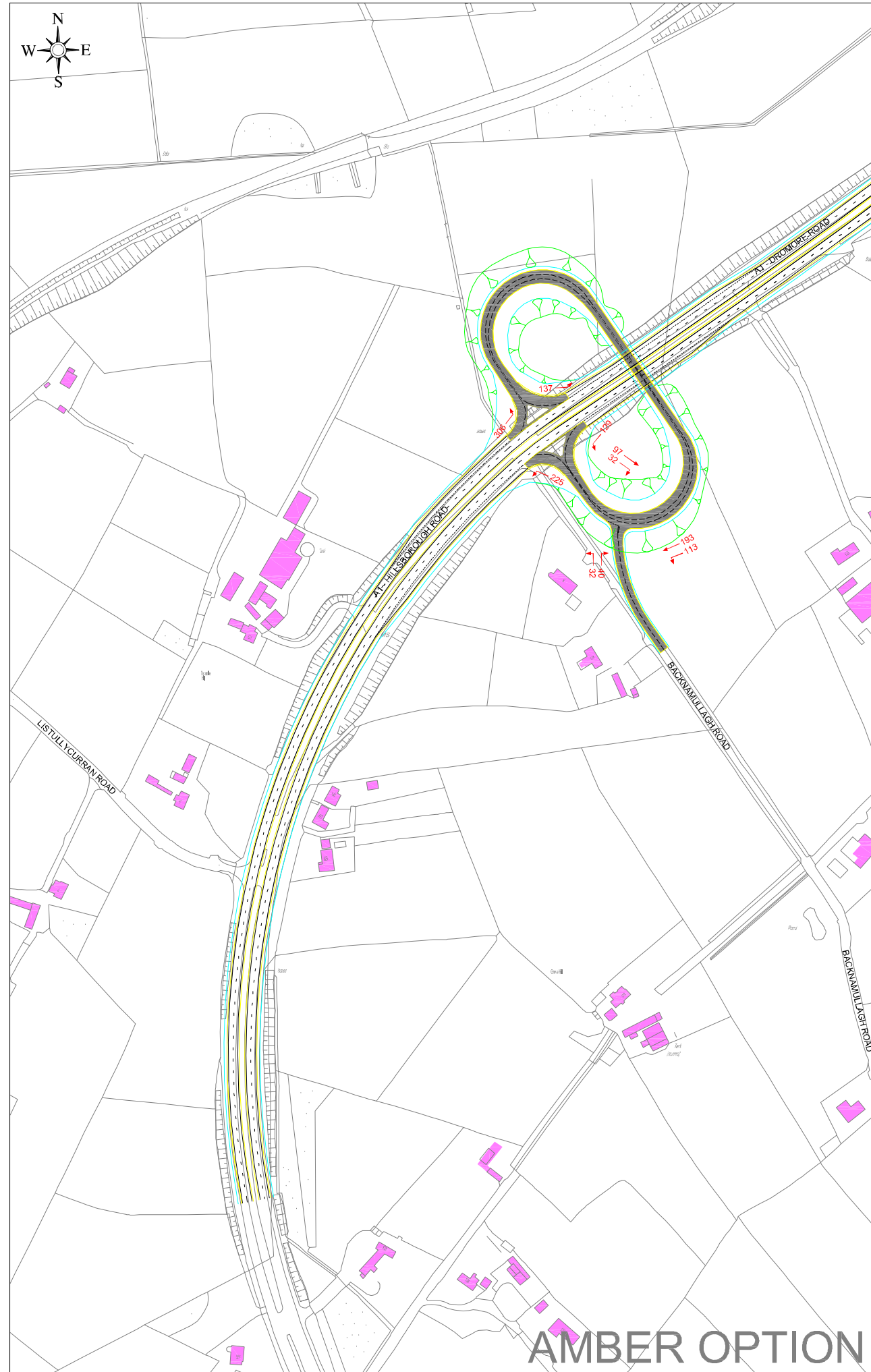

AMBER OPTION

NOTES

1. TRAFFIC FLOWS SHOWN ARE BASED ON A LIMITED RANGE OF SURVEY DATA, MADE UP OF A COMBINATION OF TURNING COUNTS AND SELECT AUTOMATIC TRAFFIC COUNTS ON THE A1. FLOWS ARE 24 HOUR 7 DAY AVERAGE FOR OPENING YEAR (2018) WITH THE CENTRAL RESERVATION CLOSED AT ALL LOCATIONS.

LEGEND

- STRUCTURE
- WATERCOURSE (OSNI)
- 193  24 HOUR 7 DAY AVERAGE TRAFFIC FLOW
- POSSIBLE LINK

Rev	Date	Detail	Made	Chk'd	App'd

Status: **DRAFT**



Project: **A1 Junctions Phase 2**

Title: **Listullycurran Road Preliminary Junction Underpass Options**

Design: TJD	CAD: RPW
Chk'd: TJD	App'd: CA
Date: August 2010	Scale: 1:2000



24 Linenhall Street BELFAST BT2 8BQ  
 Tel: +44 (0) 28 9060 7200 Fax: +44 (0) 28 9060 7369 www.aecom.com

No. 60050899/C(94)L154

CM

A1

# BLUE OPTION

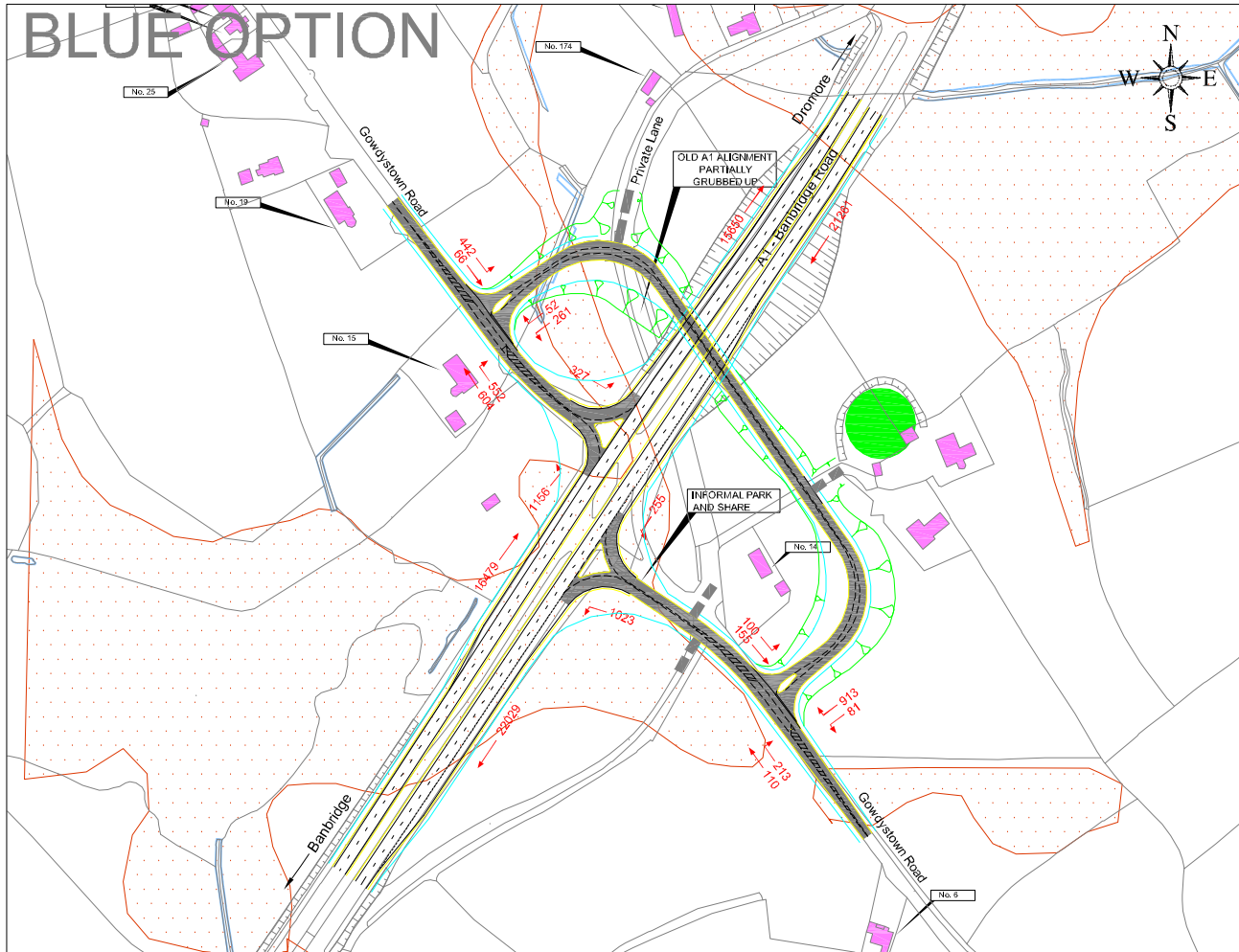

# GREEN OPTION

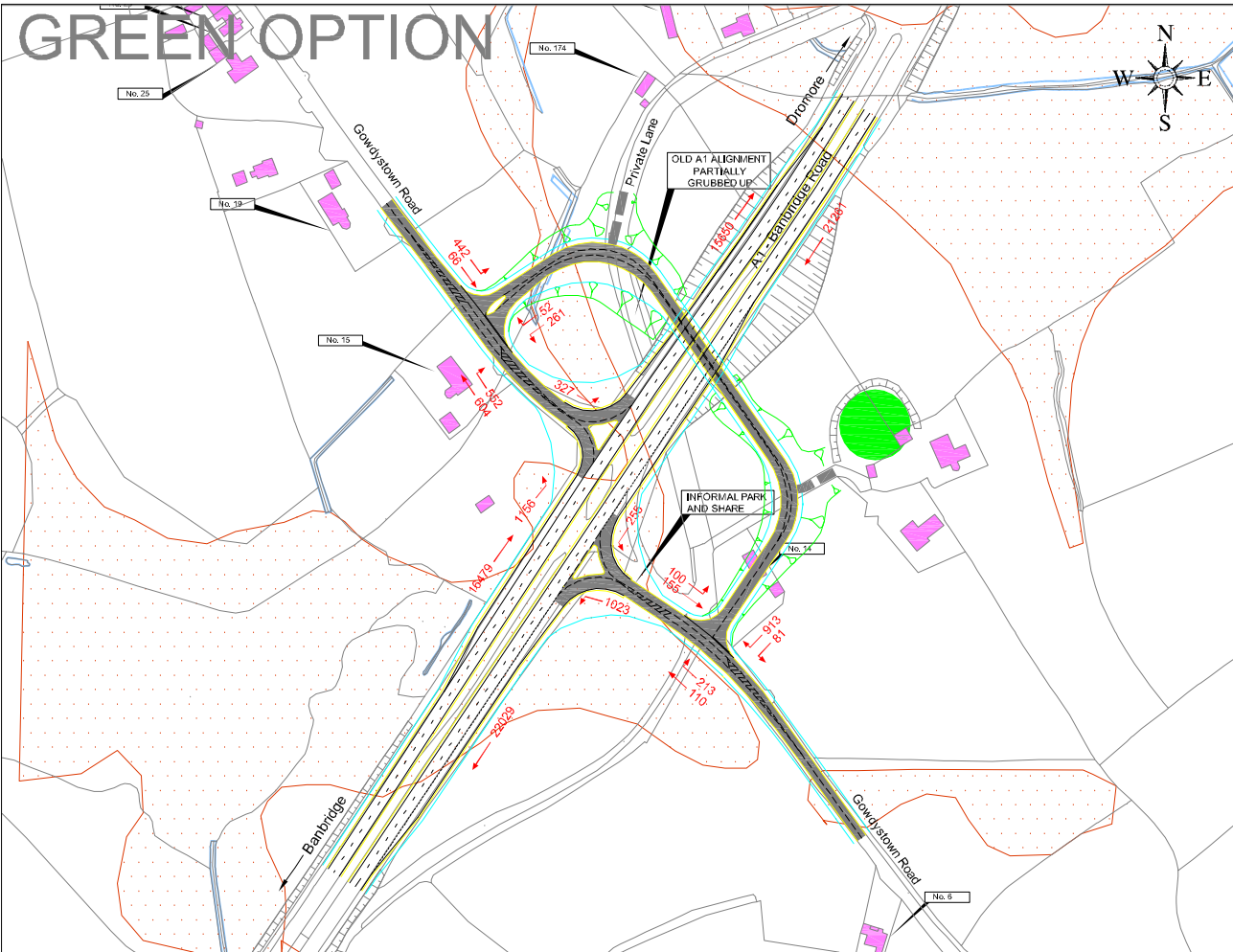

# BROWN OPTION

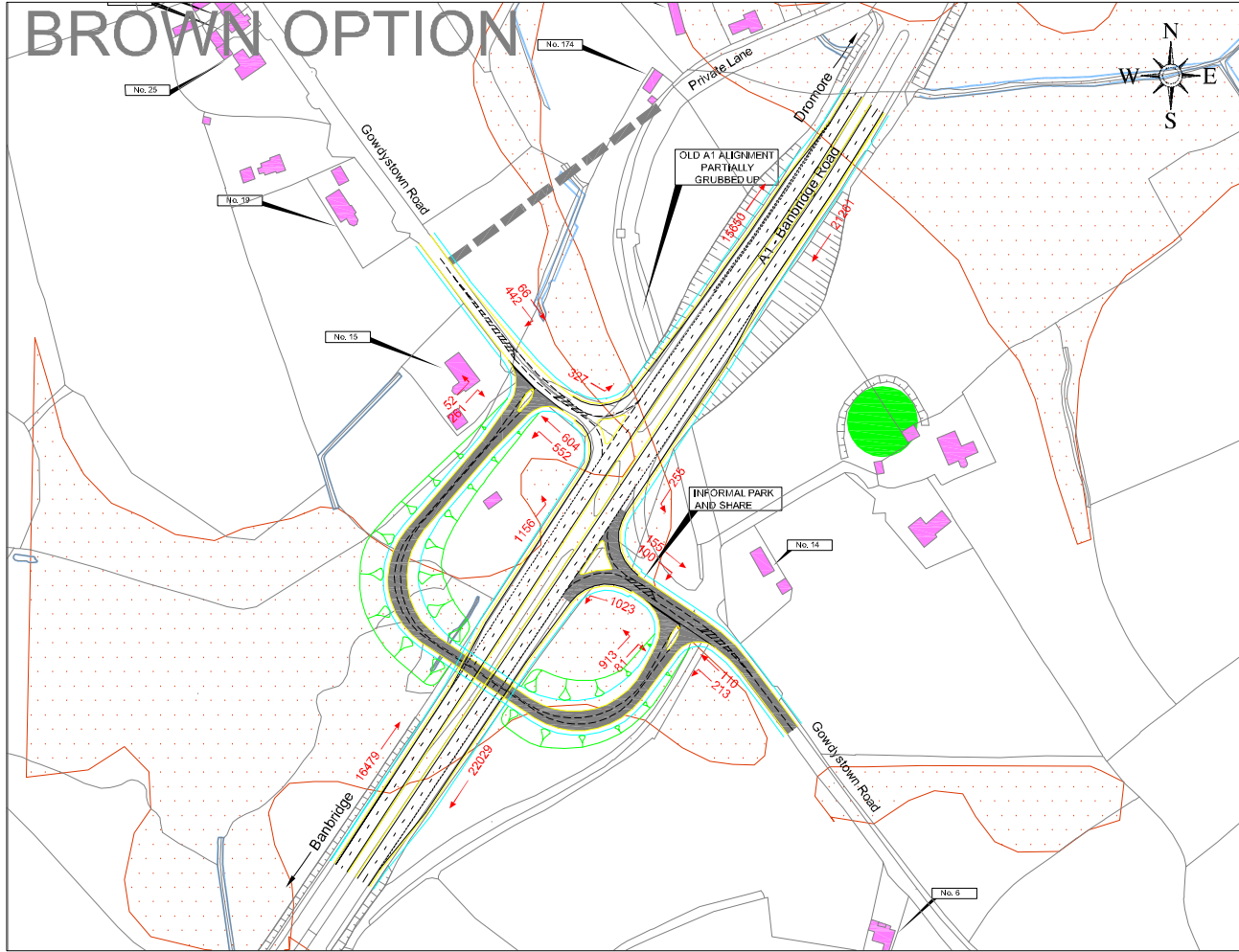

# PURPLE OPTION

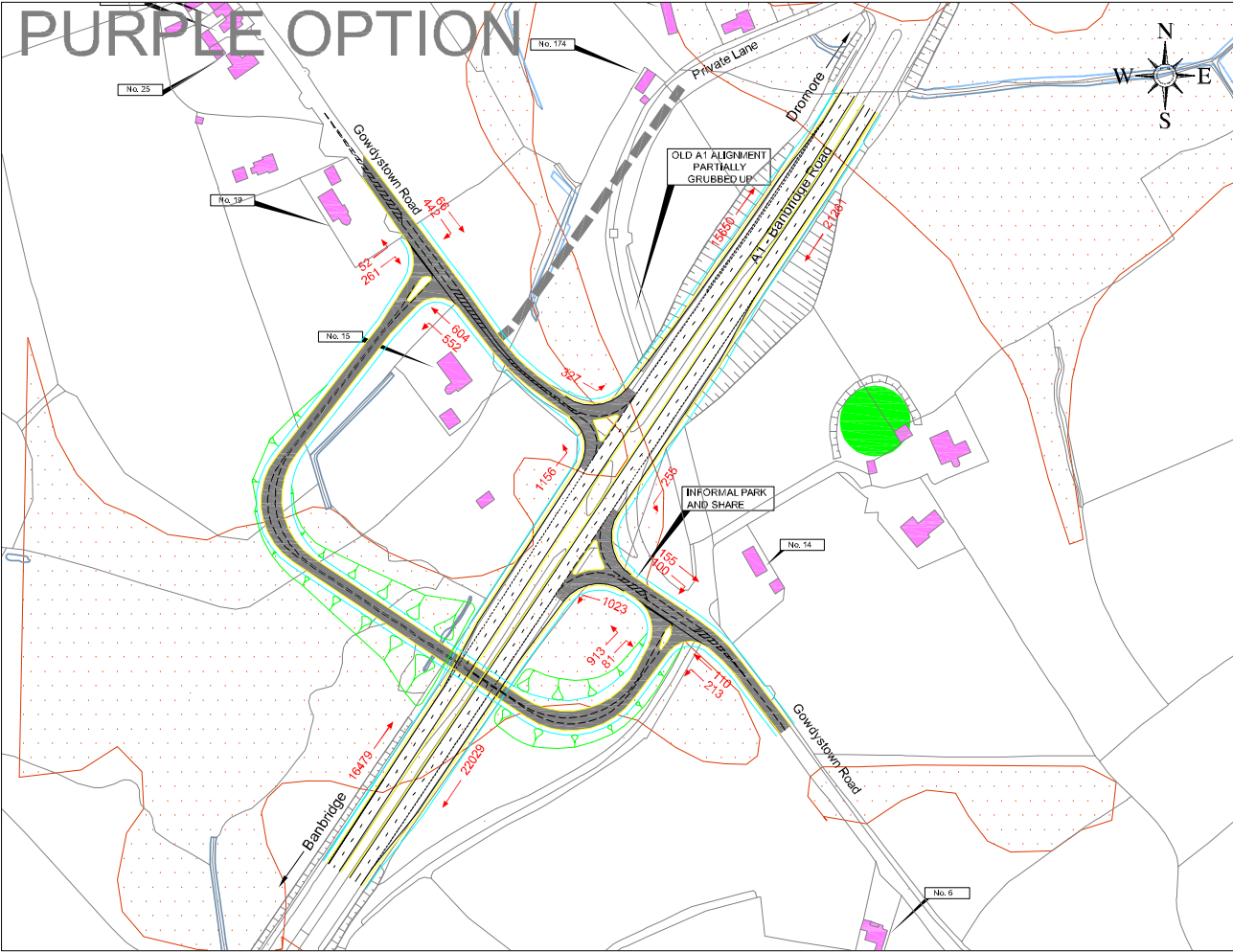

### NOTES

1. TRAFFIC FLOWS SHOWN ARE BASED ON A LIMITED RANGE OF SURVEY DATA, MADE UP OF A COMBINATION OF TURNING COUNTS AND SELECT AUTOMATIC TRAFFIC COUNTS ON THE A1. FLOWS ARE 24 HOUR 7 DAY AVERAGE FOR OPENING YEAR (2018) WITH THE CENTRAL RESERVATION CLOSED AT ALL LOCATIONS.

### LEGEND

- PEAT BOG (GSNI Geological Map - 1870)
- RATH
- STRUCTURE
- WATERCOURSE (OSNI)
- 24 HOUR 7 DAY AVERAGE TRAFFIC FLOW
- POSSIBLE LINK

Rev.	Date	Detail	Made	Chk'd	App'd
<b>DRAFT</b>					



Project: **A1 Junctions Phase 2**

Title: **Gowdstown Road Preliminary Overpass Junction Options Sheet 1 of 2**

Design: TJD	CAD: RPW
Chk'd: TJD	App'd: CA
Date: August 2010	Scale: 1:2000



24 Linenhall Street BELFAST BT2 8BQ  
 Tel: +44 (0) 28 9060 7200 Fax: +44 (0) 28 9060 7389 www.aecom.com

No. 60050899/C(94)L221



# BLUE OPTION

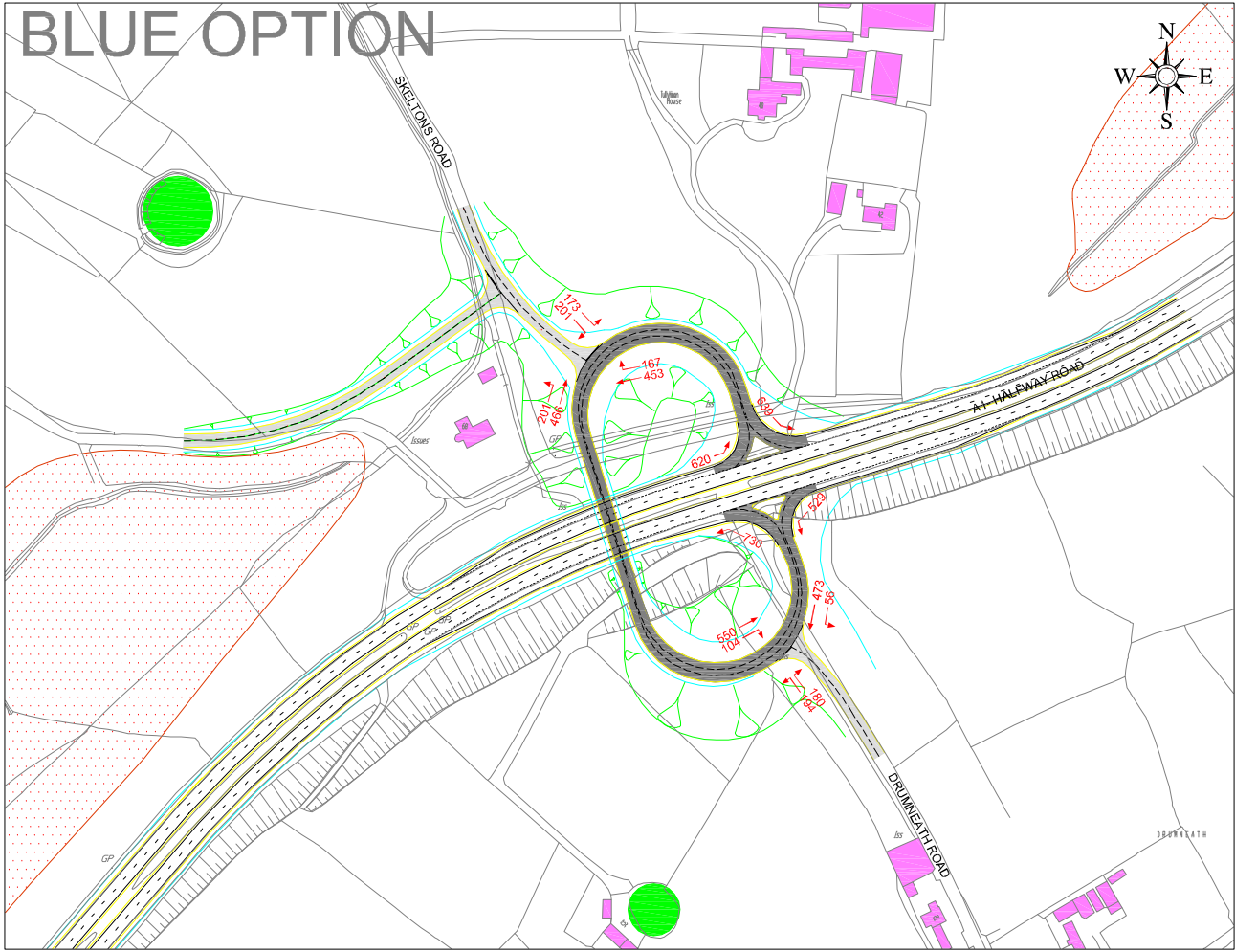

# GREEN OPTION

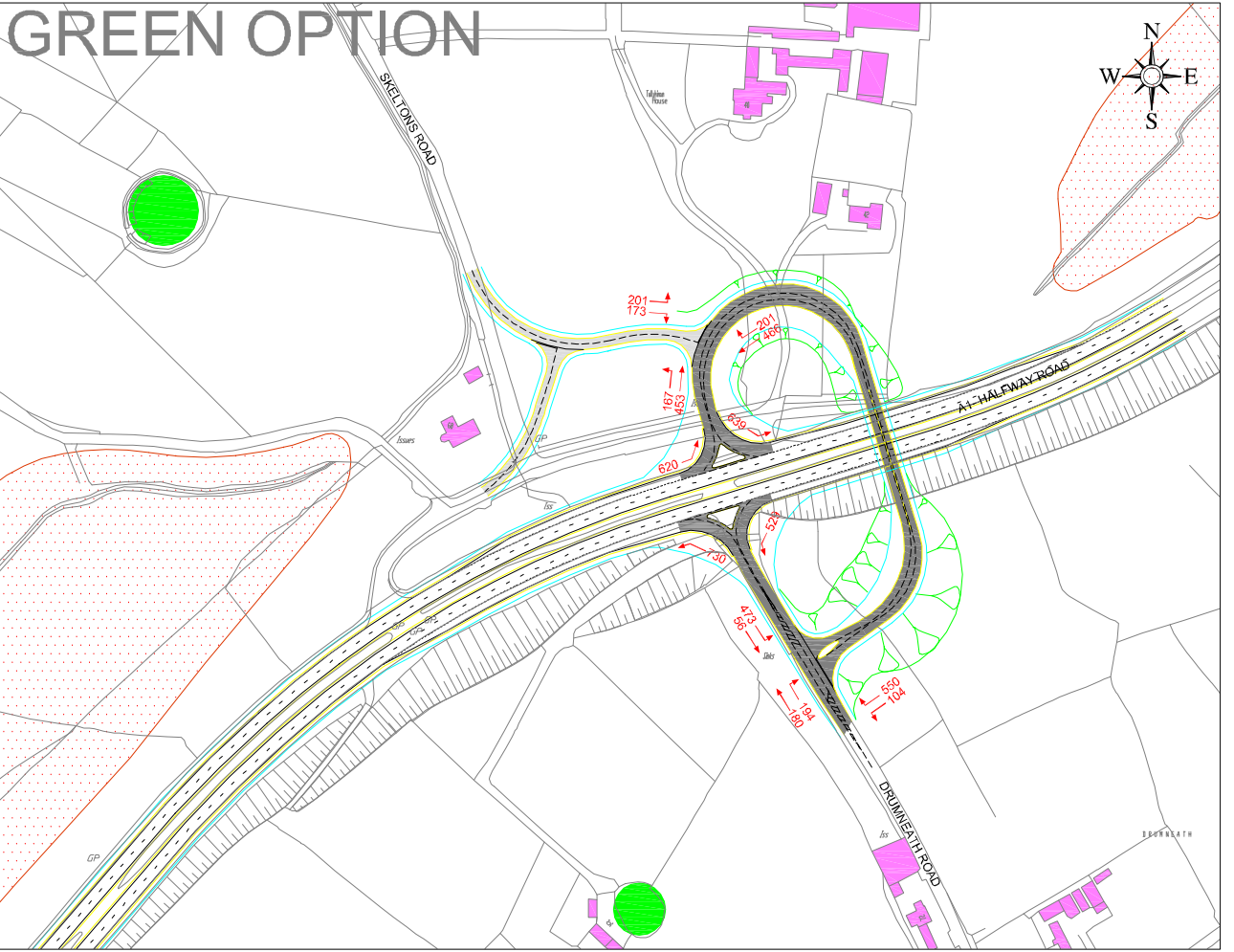

# BROWN OPTION

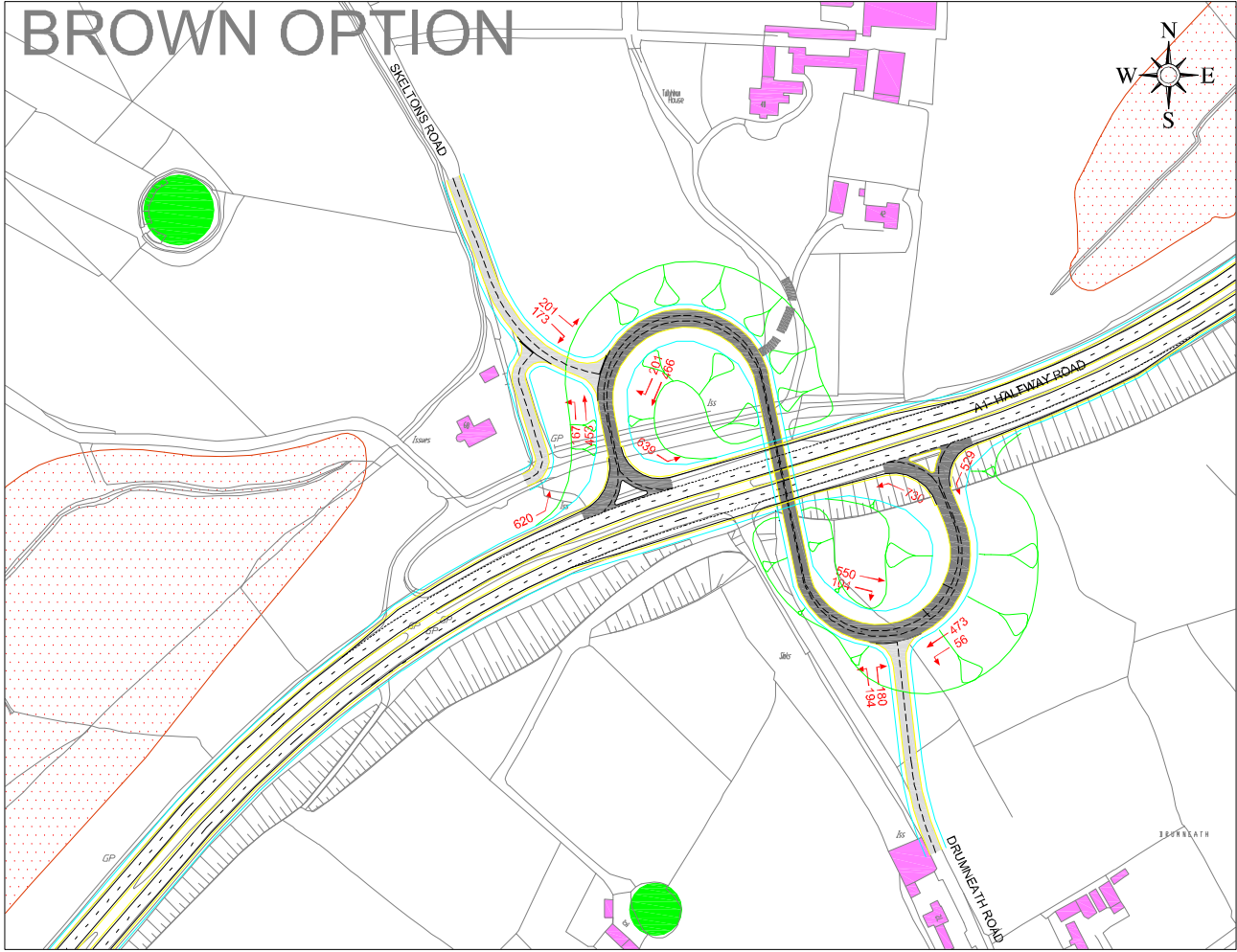

# PURPLE OPTION

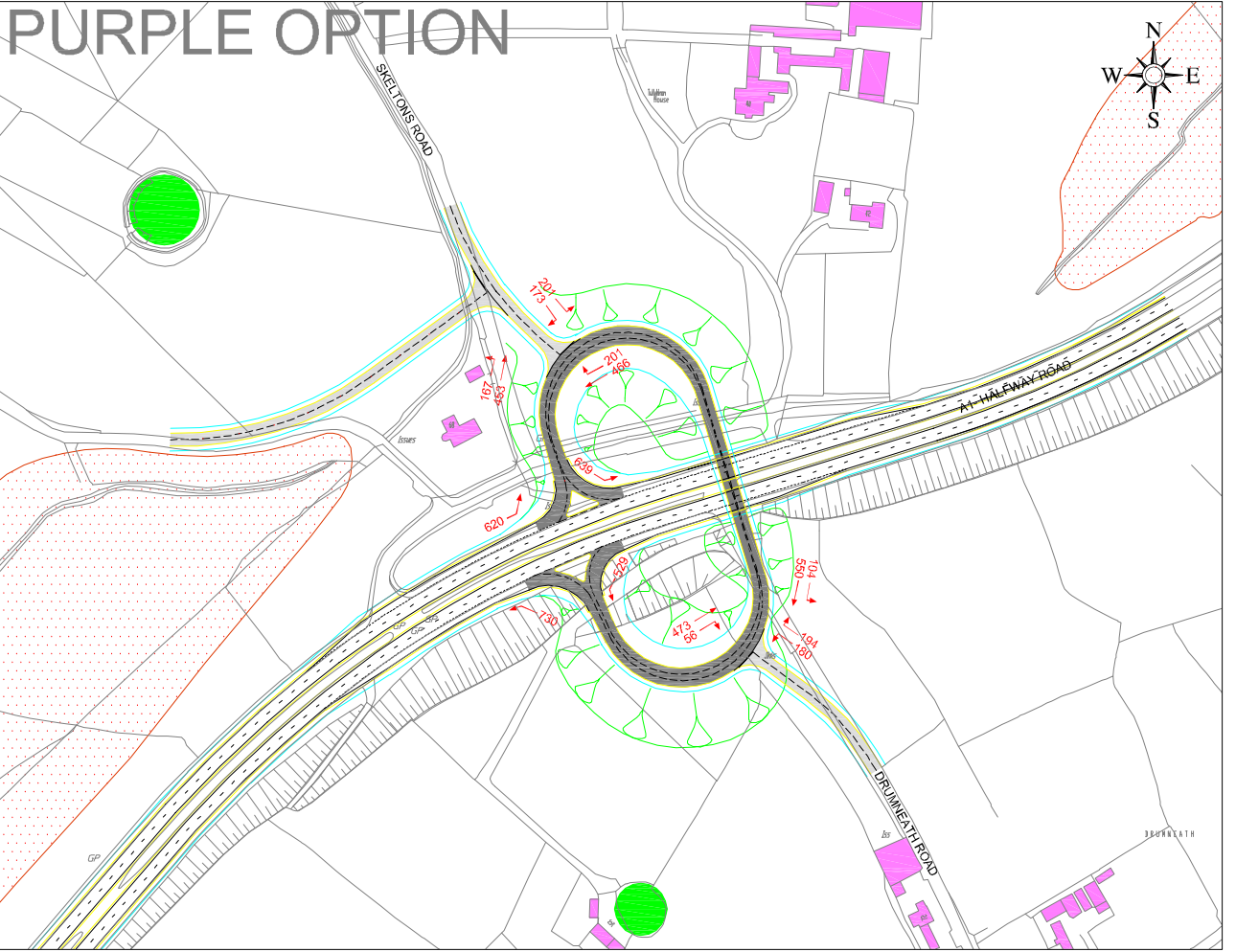

**NOTES**  
 1. TRAFFIC FLOWS SHOWN ARE BASED ON A LIMITED RANGE OF SURVEY DATA, MADE UP OF A COMBINATION OF TURNING COUNTS AND SELECT AUTOMATIC TRAFFIC COUNTS ON THE A1. FLOWS ARE 24 HOUR 7 DAY AVERAGE FOR OPENING YEAR (2018) WITH THE CENTRAL RESERVATION CLOSED AT ALL LOCATIONS.

- LEGEND**
- PEAT BOG (GSNI Geological Map - 1870)
  - RATH
  - STRUCTURE
  - WATERCOURSE (OSNI)
  - 24 HOUR 7 DAY AVERAGE TRAFFIC FLOW
  - POSSIBLE LINK

Rev	Date	Detail	Made	CHK'd	App'd

Status: **DRAFT**



Project: **A1 Junctions Phase 2**

Title: **Skeltons Road Preliminary Overpass Option Sheets Sheet 1 of 2**

Design: TJD	CAE: RPW
CHK'd: TJD	App'd: CA
Date: August 2010	Scale: 1:2000



No. 60050899/C(94)L318



# PINK OPTION

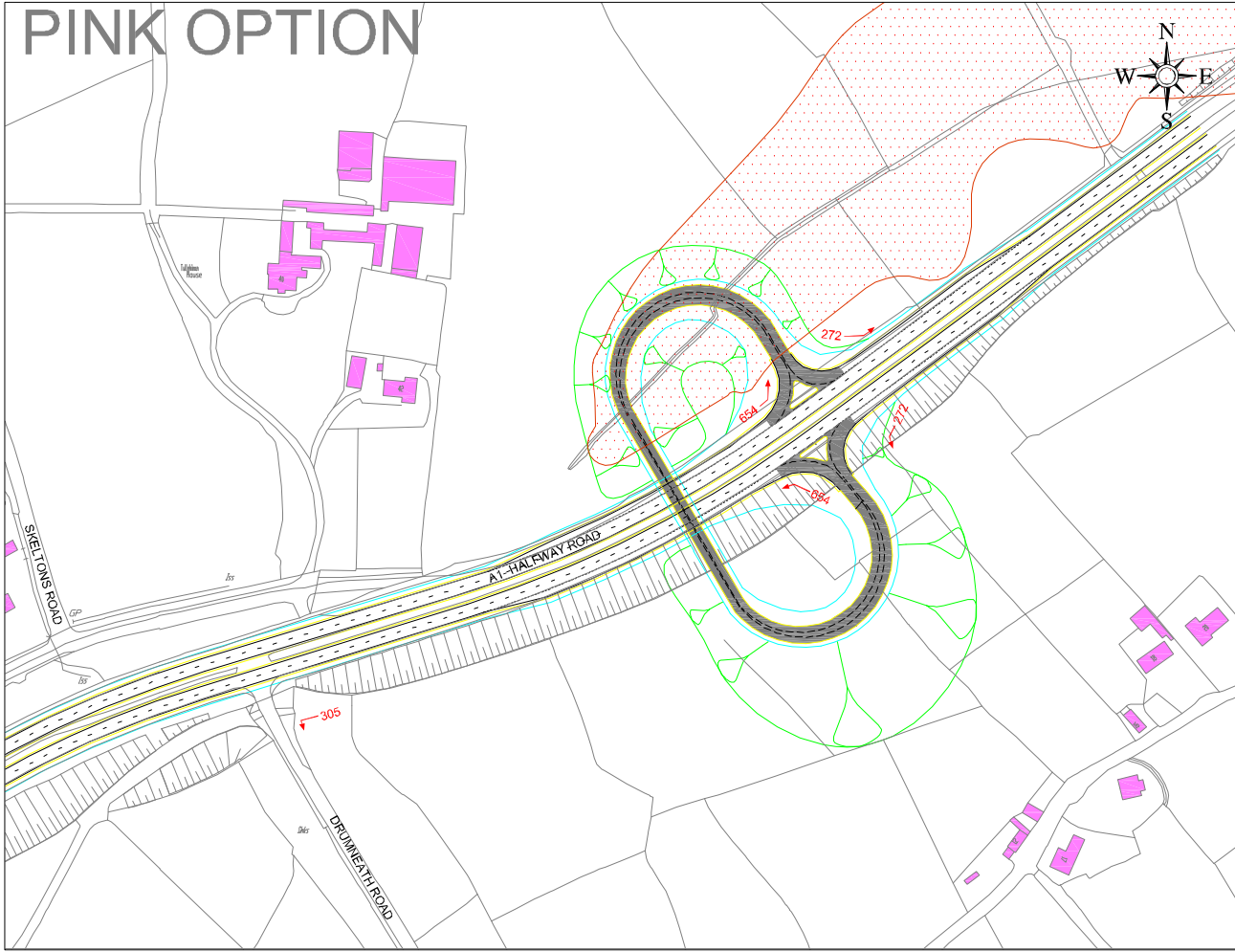

# CYAN OPTION

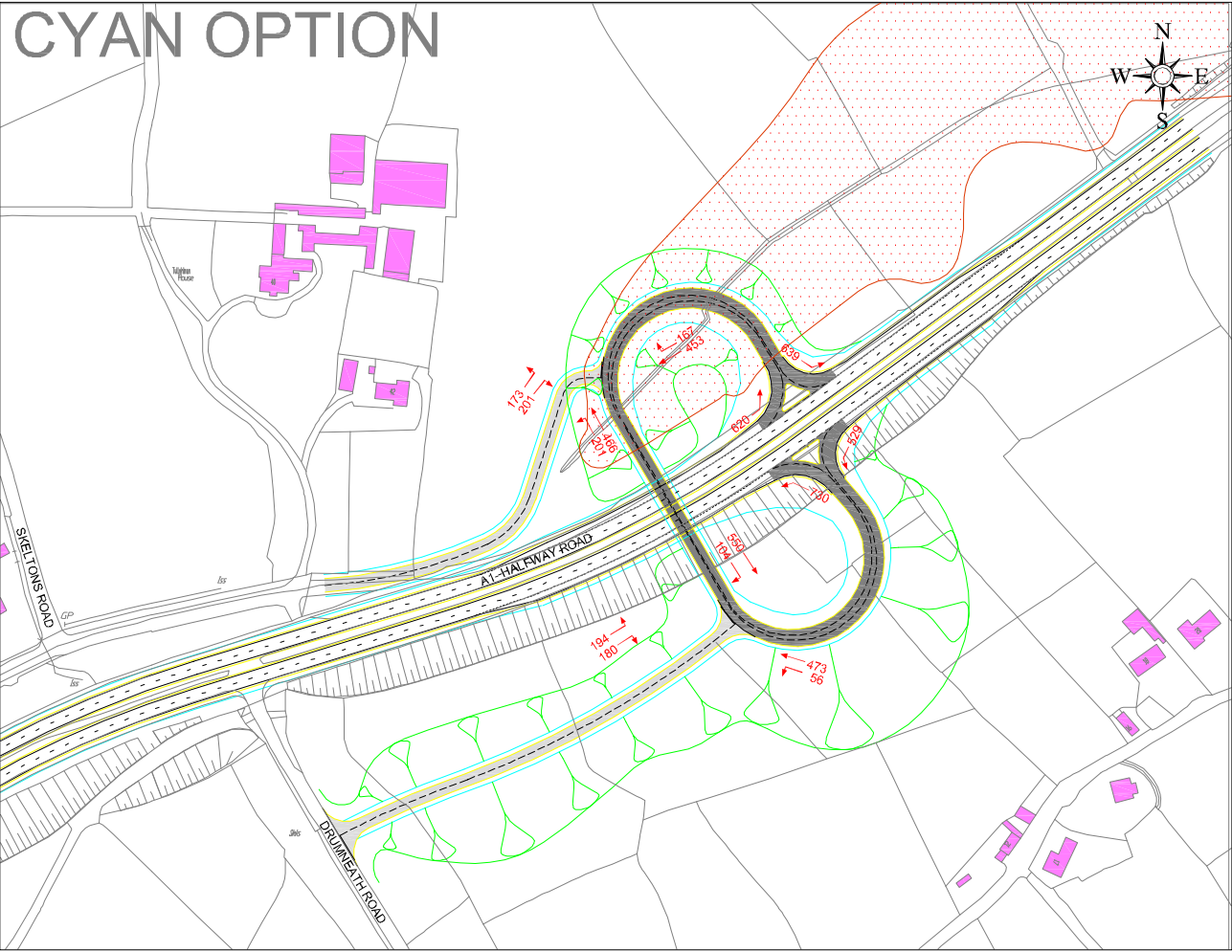

**NOTES**  
 1. TRAFFIC FLOWS SHOWN ARE BASED ON A LIMITED RANGE OF SURVEY DATA, MADE UP OF A COMBINATION OF TURNING COUNTS AND SELECT AUTOMATIC TRAFFIC COUNTS ON THE A1. FLOWS ARE 24 HOUR 7 DAY AVERAGE FOR OPENING YEAR (2018) WITH THE CENTRAL RESERVATION CLOSED AT ALL LOCATIONS.

- LEGEND**
- PEAT BOG (GSNI Geological Map - 1870)
  - RATH
  - STRUCTURE
  - WATERCOURSE (OSNI)

Rev	Date	Detail	Made	Chk'd	App'd

Status: **DRAFT**



Client: **ROADS Service**

Project: **A1 Junctions Phase 2**

Title: **Skeltons Road Preliminary Overpass Junction Options Sheet 2 of 2**

Design: TJD	CAD: RPW
Chk'd: TJD	App'd: CA
Date: August 2010	Scale: 1:2000

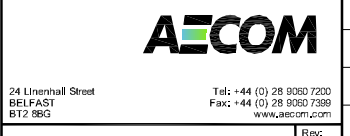

No. 60050899/C(94)L319

Rev: -

# BLUE OPTION

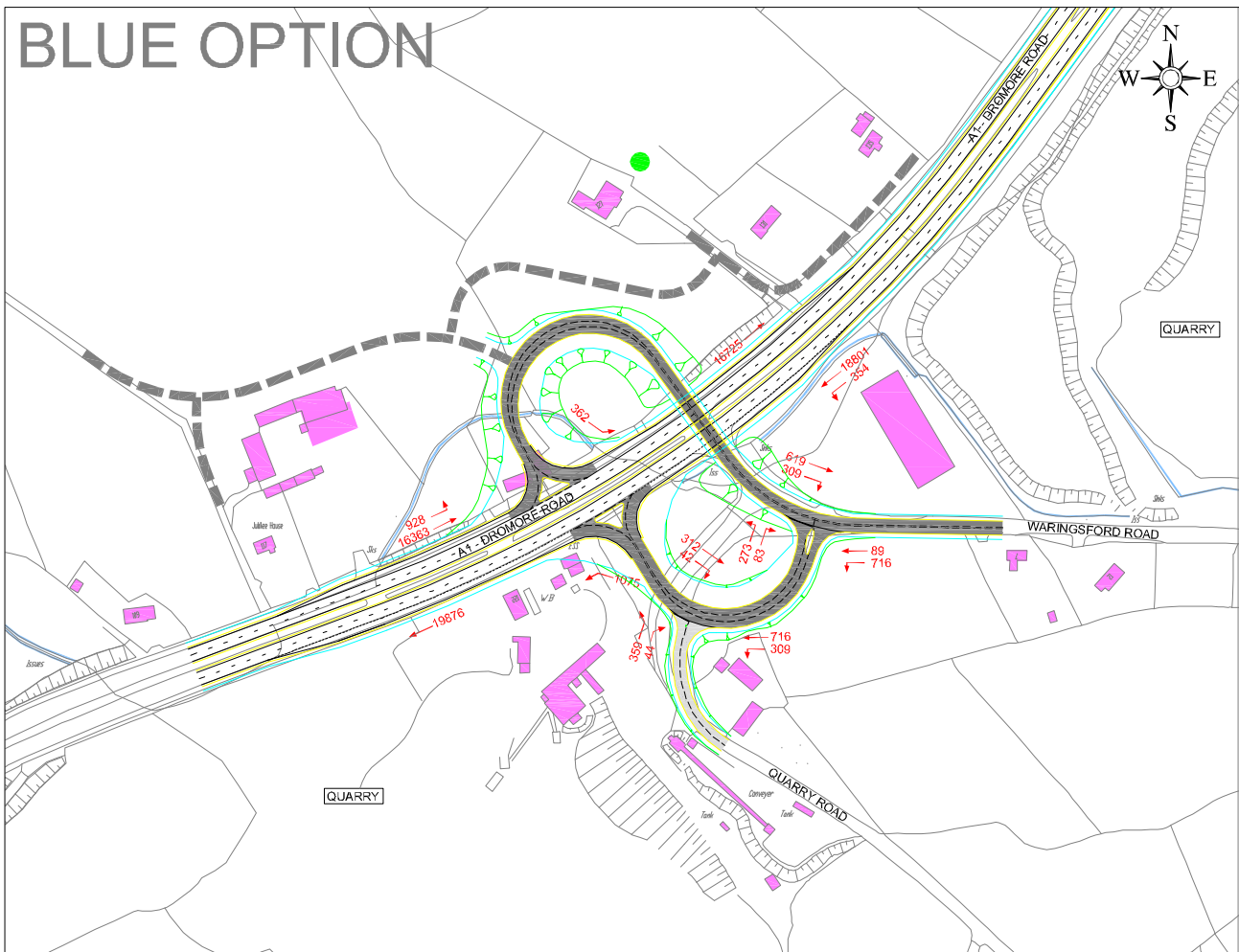

# GREEN OPTION

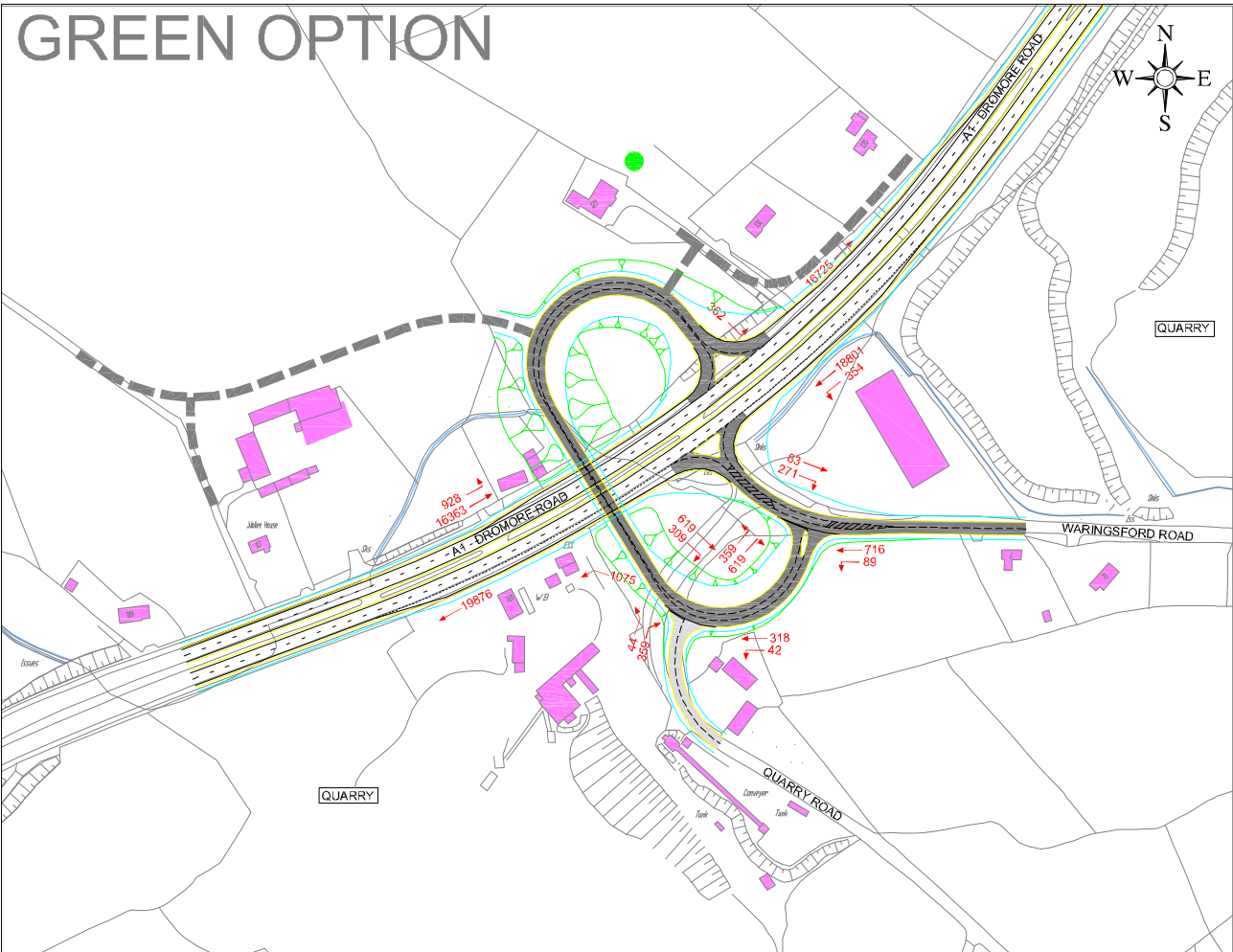

# BROWN OPTION

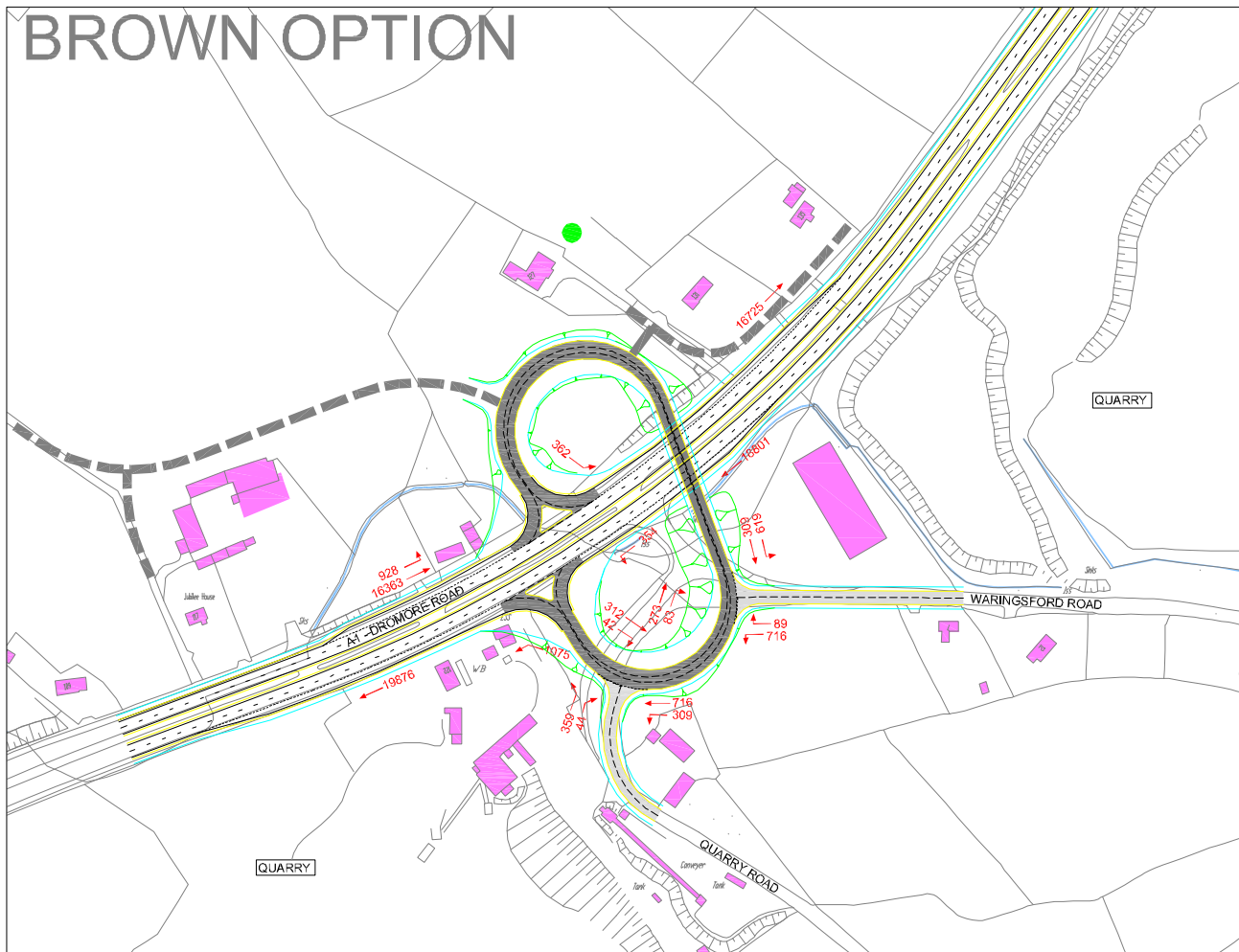

# PURPLE OPTION

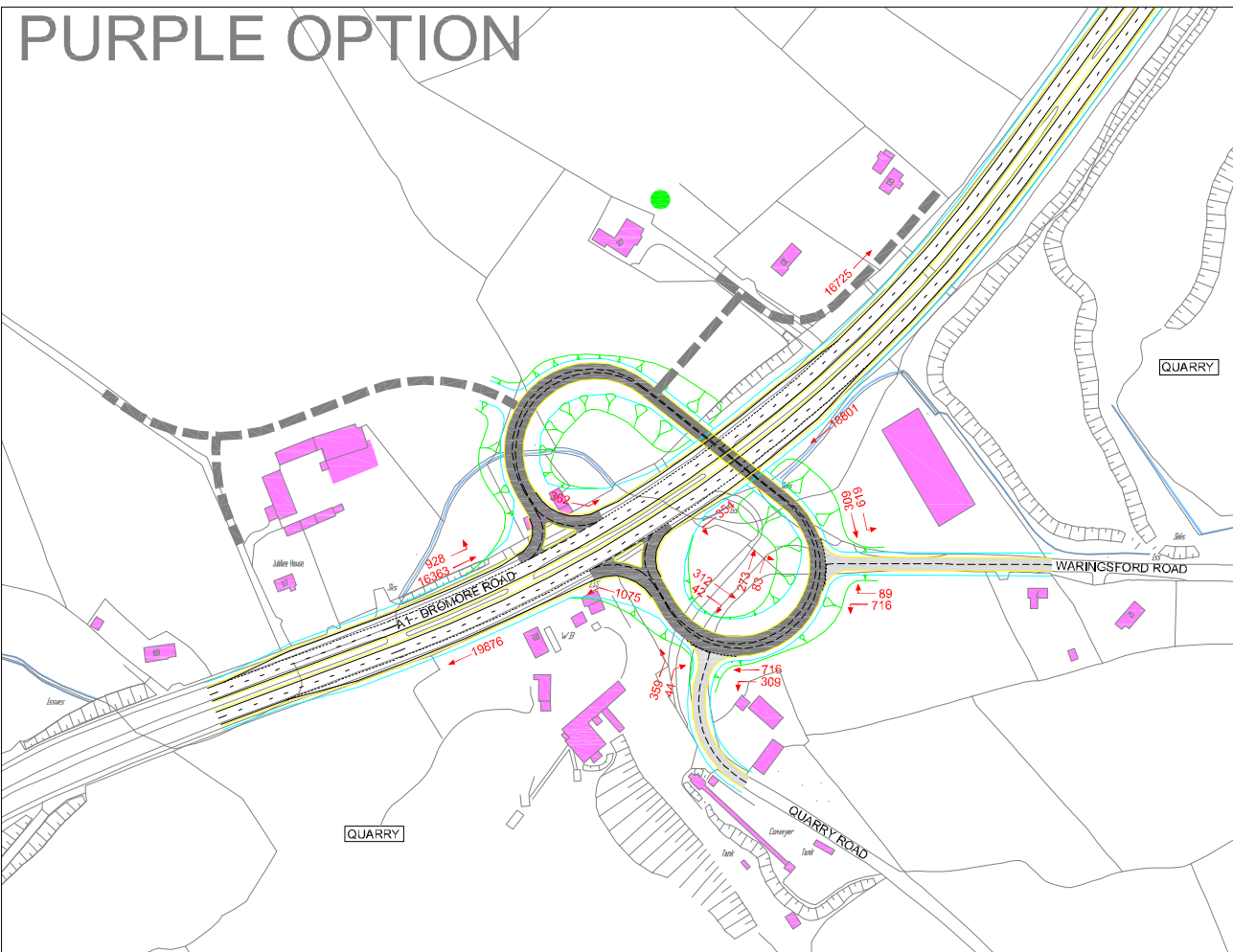

### NOTES

1. TRAFFIC FLOWS SHOWN ARE BASED ON A LIMITED RANGE OF SURVEY DATA, MADE UP OF A COMBINATION OF TURNING COUNTS AND SELECT AUTOMATIC TRAFFIC COUNTS ON THE A1. FLOWS ARE 24 HOUR 7 DAY AVERAGE FOR OPENING YEAR (2018) WITH THE CENTRAL RESERVATION CLOSED AT ALL LOCATIONS.

### LEGEND

- STRUCTURE
- WATERCOURSE (OSNI)
- ENCLOSURE
- 193  24 HOUR 7 DAY AVERAGE TRAFFIC FLOW
- POSSIBLE LINK

Rev	Date	Detail	Made	Chk'd	App'd
<b>DRAFT</b>					

Client:



Project: **A1 Junctions Phase 2**

Title: **Warningsford Road Preliminary Overpass Junction Options Sheet 1 of 2**

Design: TJD	CAE: RPW
Chk'd: TJD	App'd: CA
Date: August 2010	Scale: 1:2000



24 Linenhall Street  
BELFAST  
BT2 8BQ

Tel: +44 (0) 28 9060 7200  
Fax: +44 (0) 28 9060 7389  
www.aecom.com

No. 60050899/C(94)L420



# BLUE OPTION

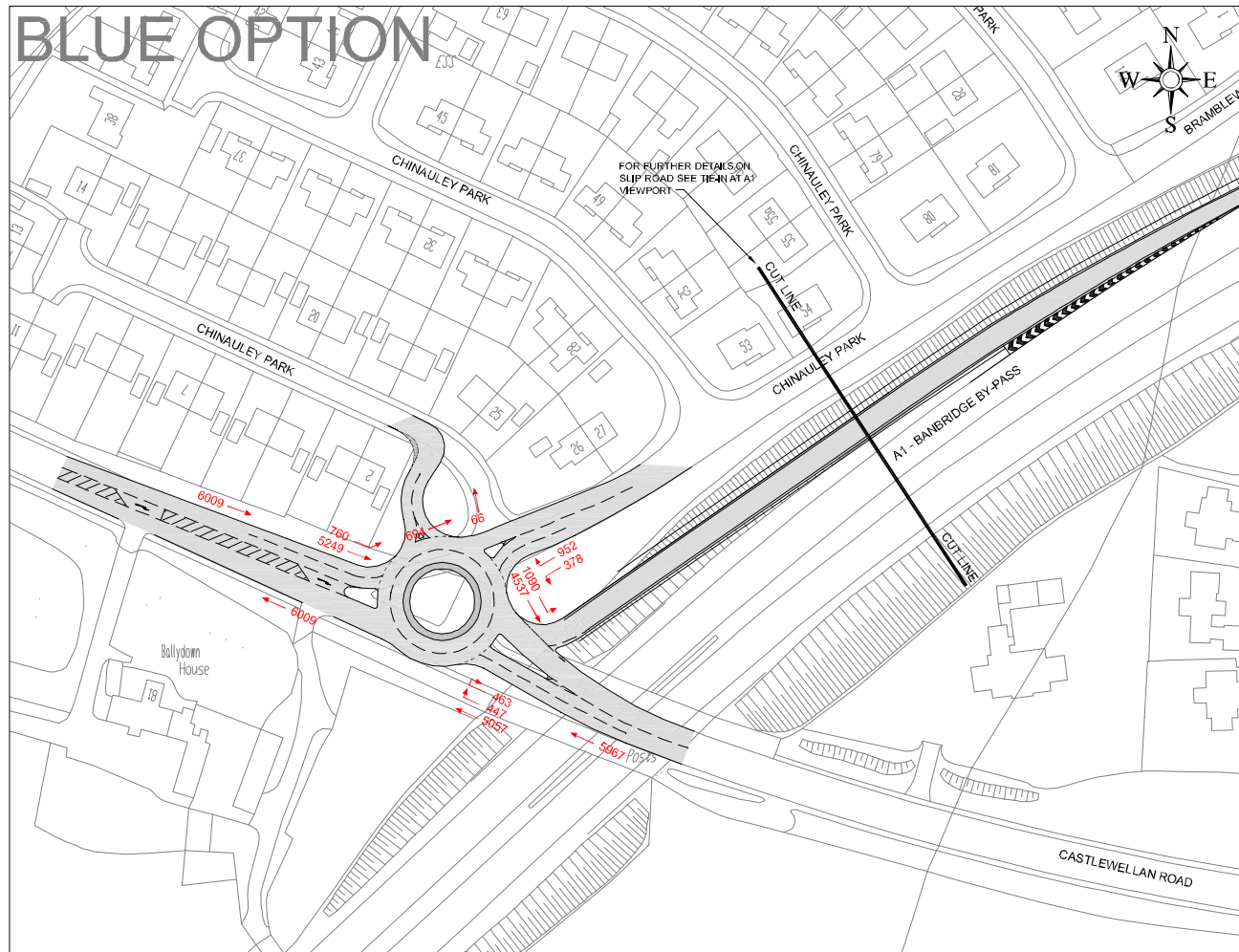

# GREEN OPTION

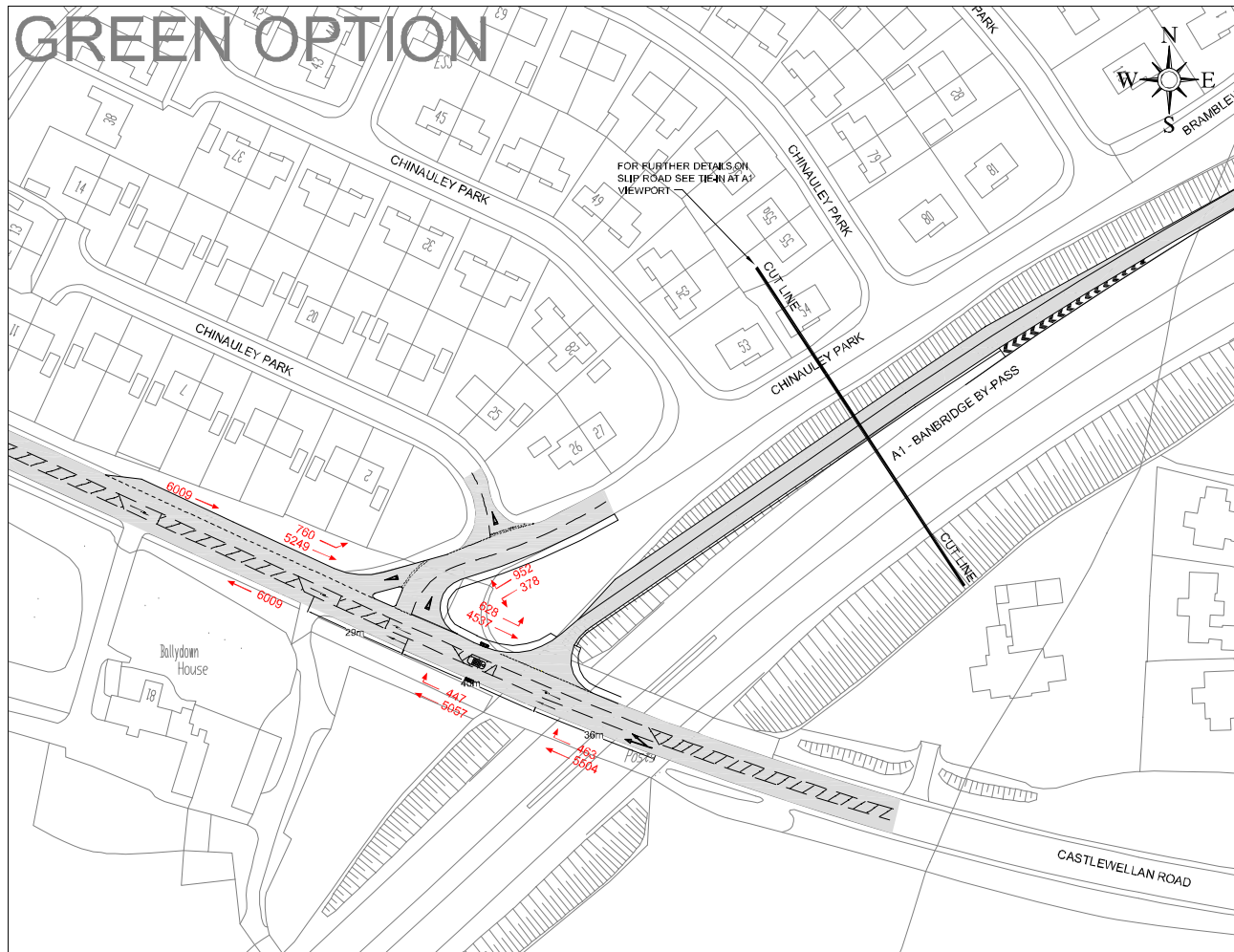

# BROWN OPTION

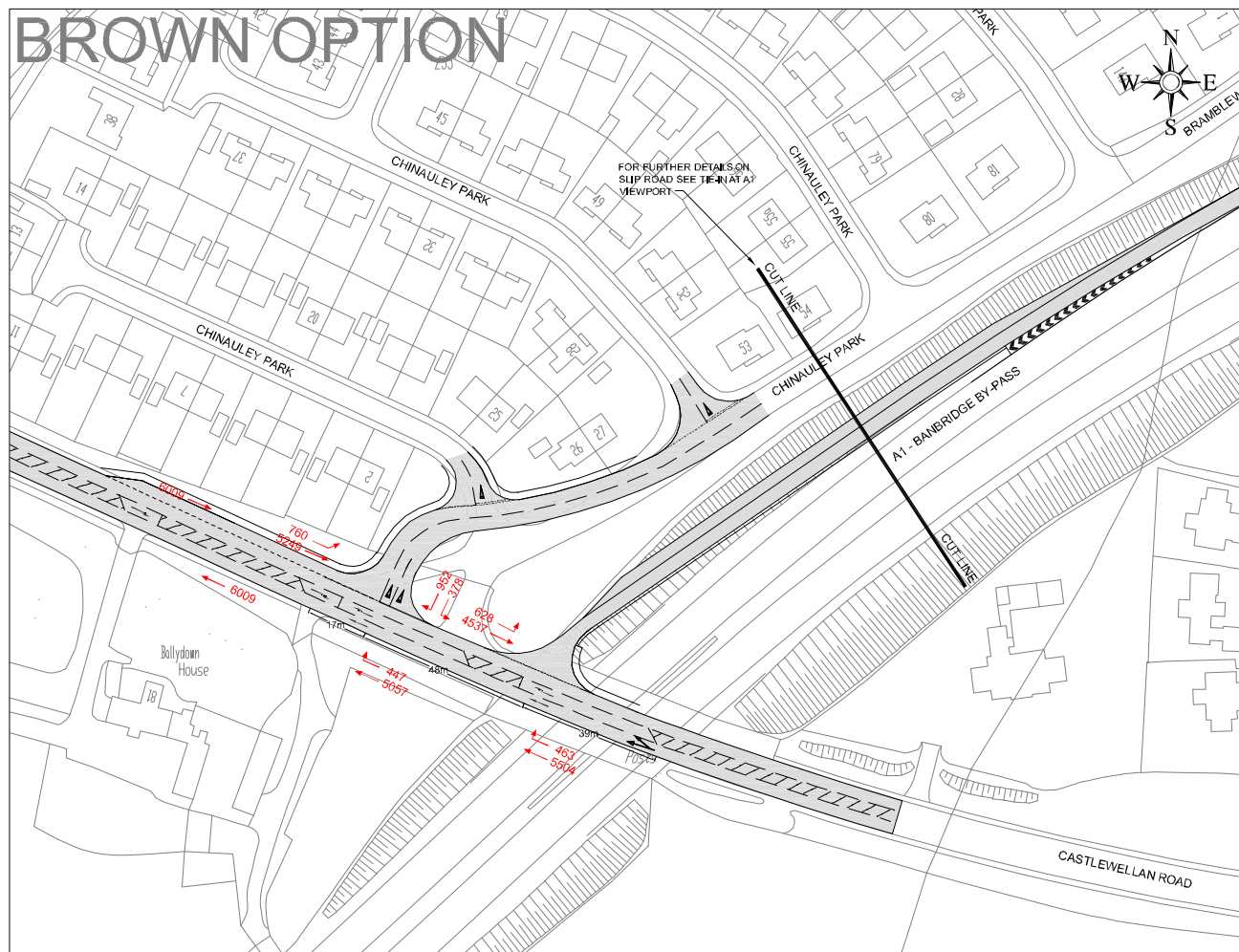

# TIE-IN AT A1

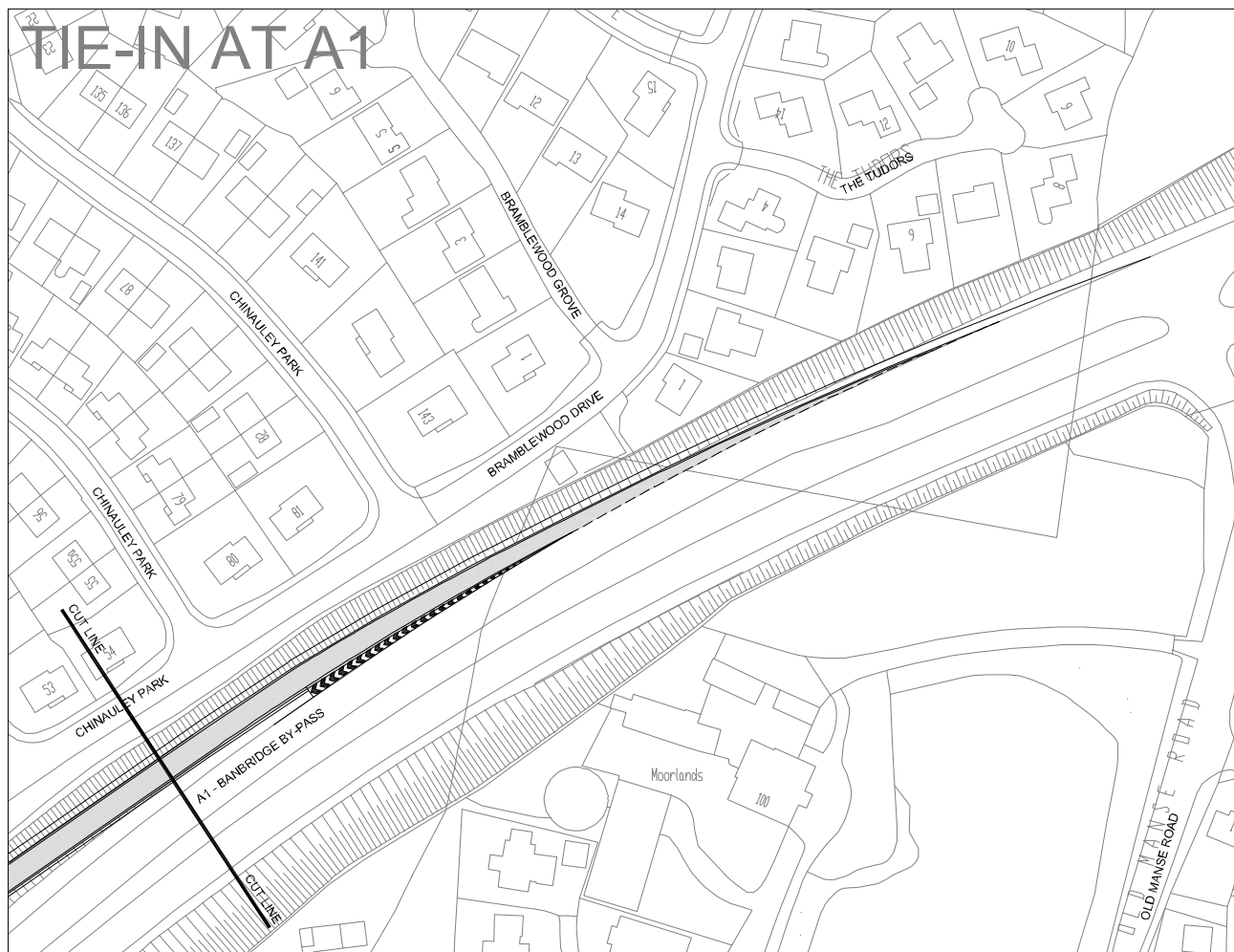

- NOTES**
1. TRAFFIC FLOWS SHOWN ARE BASED ON A LIMITED RANGE OF SURVEY DATA, MADE UP OF A COMBINATION OF TURNING COUNTS AND SELECT AUTOMATIC TRAFFIC COUNTS ON THE A1. FLOWS ARE 24 HOUR 7 DAY AVERAGE FOR OPENING YEAR (2018) WITH THE CENTRAL RESERVATION CLOSED AT ALL LOCATIONS.
  2. ALL DIMENSIONS IN METRES UNLESS OTHERWISE STATED.

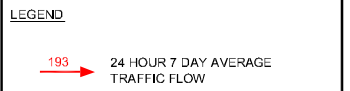

Rev	Date	Detail	Made	Chk'd	App'd
<b>DRAFT</b>					
Client: <b>ROADS Service</b>					
Project: <b>A1 Junctions Phase 2</b>					
Title: <b>Castlewellan Road Preliminary Junction Options Sheet 1 of 1</b>					
Design:	TJD	CAD:	RPW		
Chk'd:	TJD	App'd:	CA		
Date:	September 2010	Scale:	1:1000		
<b>AECOM</b>					
24 Linenhall Street BELFAST BT7 8BQ			Tel: +44 (0) 28 9060 7200 Fax: +44 (0) 28 9060 7389 www.aecom.com		
No. 60050899/C(94)L517					Rev:
cm					A1