

Department for
Infrastructure

An Roinn

Bonneagair

www.infrastructure-ni.gov.uk



Co-financed by the European Union
Connecting Europe Facility

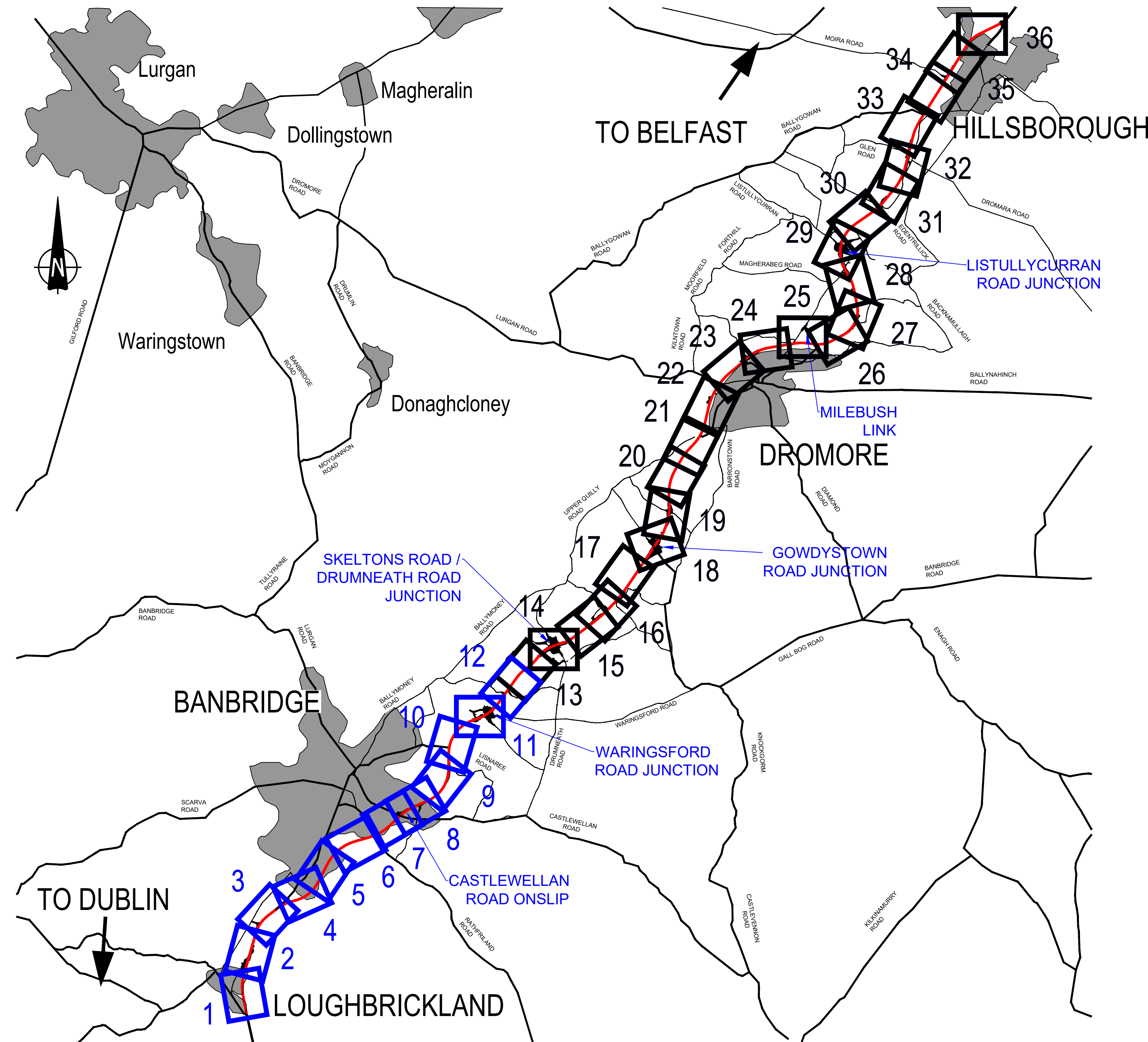

NIMVO Maps 1 to 12
Please click on map windows to
view plans



A1 Junctions
Phase 2

NOTICE OF INTENTION TO MAKE A VESTING ORDER (NIMVO) - MAPS
Published 25 March 2019

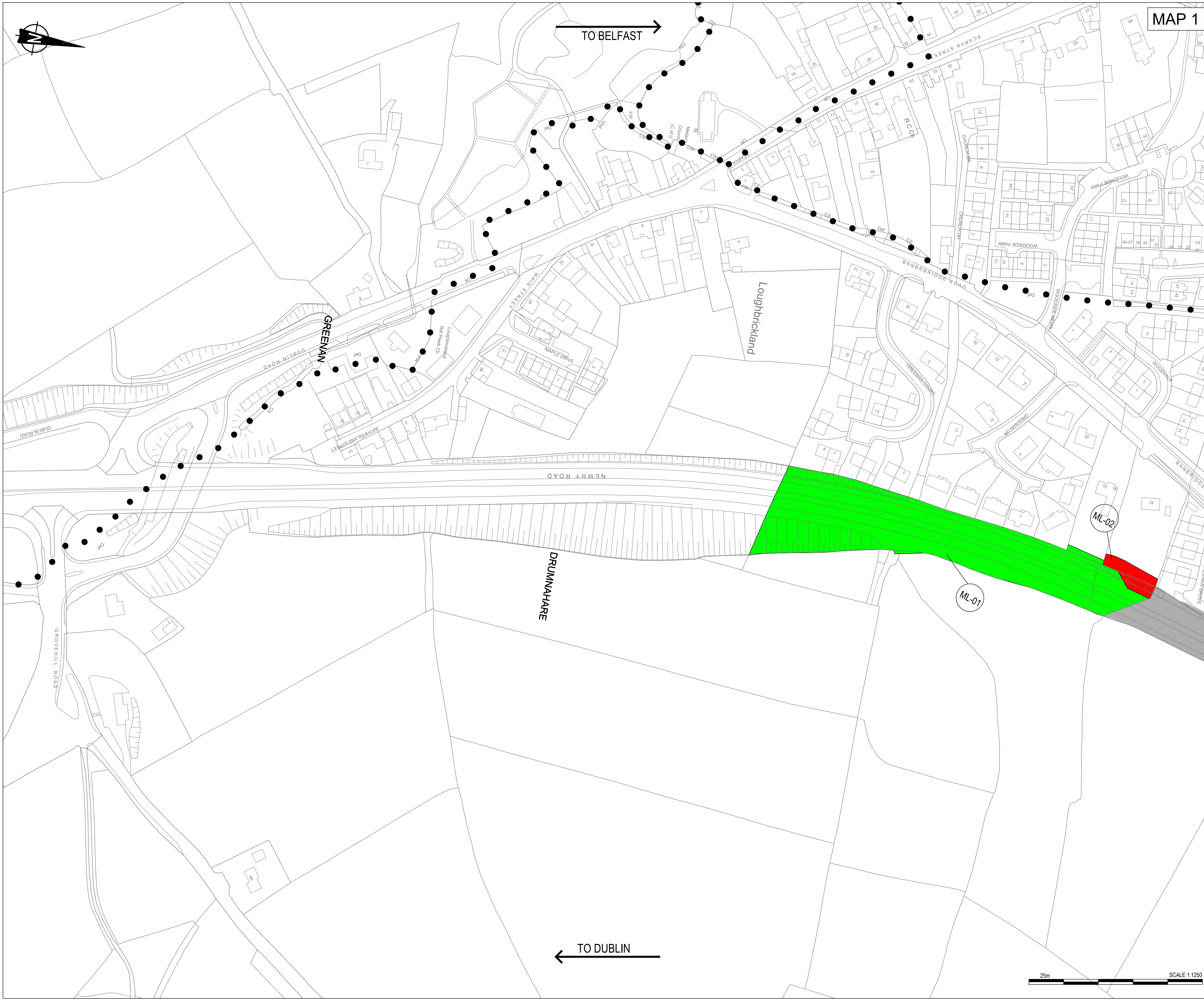

MAP 1

NOTES

1. Verifying Dimensions.
The contractor shall verify dimensions against such other drawings or site conditions as pertain to this part of the work.
2. Existing Services.
Any information concerning the location of existing services indicated on this drawing is intended for general guidance only. It shall be the responsibility of the contractor to determine and verify the exact horizontal and vertical alignment of all cables, pipes, etc. (both underground and overhead) before work commences.
3. Issue of Drawings.
Hard copies, dwf and pdf will form a controlled issue of the drawing. All other formats (dwg, dxf etc.) are deemed to be an uncontrolled issue and any work carried out based on these files is at the recipient's own risk. RPS will not accept any responsibility for any errors arising from the use of these files, either by human error by the recipient, listing of un-dimensioned measurements, compatibility issues with the recipient's software, and any errors arising when these files are used to aid the recipient's drawing production, or setting out on site.
4. OS Sheets:
165-13, 165-14, 183-08, 183-12, 183-16, 184-01, 184-02, 184-05, 184-06, 184-09, 184-13, 202-03, 202-04, 202-07, 202-08, 202-10, 202-11, 202-13, 202-14, 202-15, 203-01, 220-08, 220-11, 220-12, 220-15, 220-16, 221-01, 221-02, 221-05, 221-09, 237-03, 237-04
5. This is based upon Crown Copyright and is reproduced with the permission of Land & Property Services under delegated authority from the Controller of Her Majesty's Stationery Office. © Crown copyright and database right [2018] EMOU [206.2]
6. DATUM: IRISH GRID

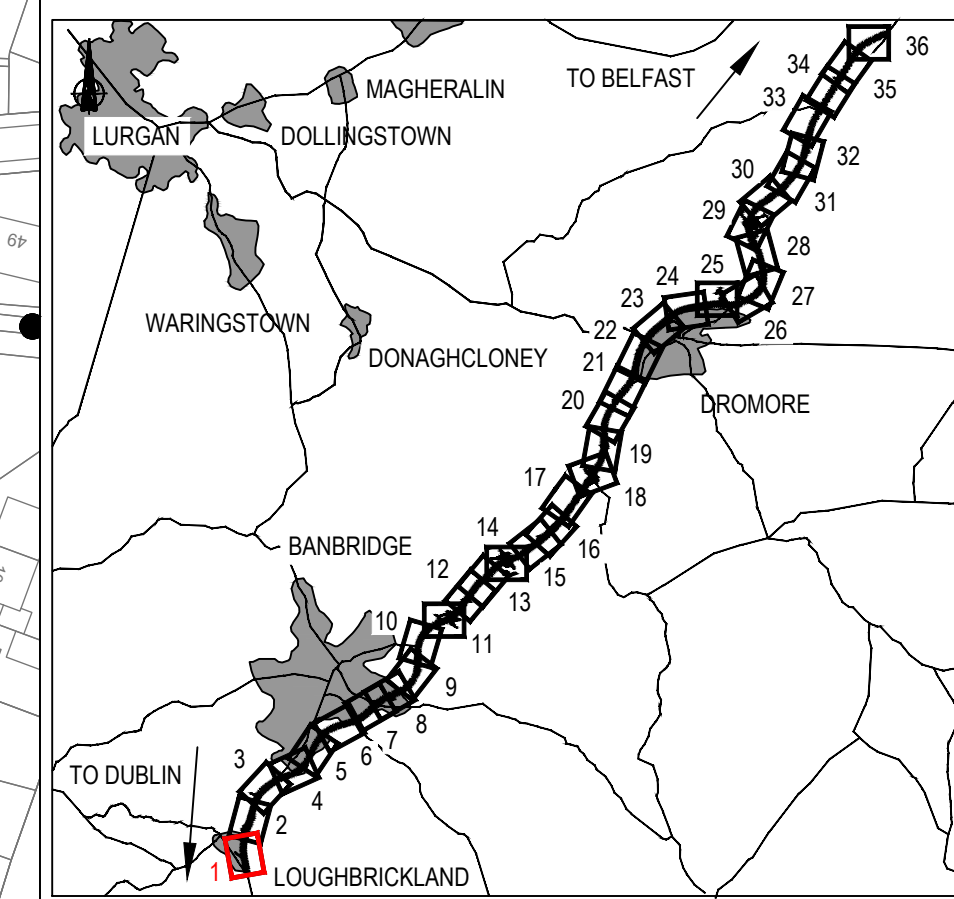

KEY

- Existing OS/ Survey Mapping
- Townland Boundary
- RSC Folio Reference No (X-XX)

Proposed Land Areas Required

- Red, Green, Blue, Yellow

Proposed Land Areas Required - Leasehold

- Diagonal hatching patterns

Easements being affected

- Grid patterns

P3	Drawings updated following comments from DfI	JF	PN	CD	11-Feb-2019
P2	Folios updated in relation to Land Registry review	DM	PN	CD	19-Oct-2018
REV	COMMENT	DRAWN	CH	AP	DATE

RPS **SWECO**

Elmwood House T +44 (0) 28 90 667914
 74 Boucher Road F +44 (0) 28 90 668286
 Belfast W www.rpsgroup.com/ireland
 BT12 6RZ E ireland@rpsgroup.com

Client
Department for Infrastructure
Bonneagair
 www.infrastructure-ri.gov.uk

Project
A1 Junctions Phase 2

Title
 Notice of Intention to Make a Vesting Order (NIMVO) Plan - MAP 1

Drawing Status	Suitability	Project Ref No.		
S2	For Information	IBH0488		
Scale	Designed	Drawn By	Checked	Authorised
1:1250	JF	JF	PN	CD
Original Size	Date	Date	Date	Date
A1	07-06-18	07-06-18	23-08-18	23-08-18
Drawing Number	Rev			P3.0
TNI Ref Originator Volume Location Type Discipline Classification Number				
168014-RPSB-LOV-XX-DR-HE-2600-00001				



1. Verifying Dimensions.
The contractor shall verify dimensions against such other drawings or site conditions as pertain to this part of the work.
2. Existing Services.
Any information concerning the location of existing services indicated on this drawing is intended for general guidance only. It shall be the responsibility of the contractor to determine and verify the exact horizontal and vertical alignment of all cables, pipes, etc. (both underground and overhead) before work commences.
3. Issue of Drawings.
Hard copies, dwf and pdf will form a controlled issue of the drawing. All other formats (dwg, dxf etc.) are deemed to be an uncontrolled issue and any work carried out based on these files is at the recipient's own risk. RPS will not accept any responsibility for any errors arising from the use of these files, either by human error by the recipient, listing of un-dimensioned measurements, compatibility issues with the recipient's software, and any errors arising when these files are used to aid the recipient's drawing production, or setting out on site.
4. OS Sheets:
165-13, 165-14, 183-08, 183-12, 183-16, 184-01, 184-02, 184-05, 184-06, 184-09, 184-13, 202-03, 202-04, 202-07, 202-08, 202-10, 202-11, 202-13, 202-14, 202-15, 203-01, 220-08, 220-11, 220-12, 220-15, 220-16, 221-01, 221-02, 221-05, 221-09, 237-03, 237-04
5. This is based upon Crown Copyright and is reproduced with the permission of Land & Property Services under delegated authority from the Controller of Her Majesty's Stationery Office. © Crown copyright and database right [2018] EMOU [206.2]
6. DATUM: IRISH GRID

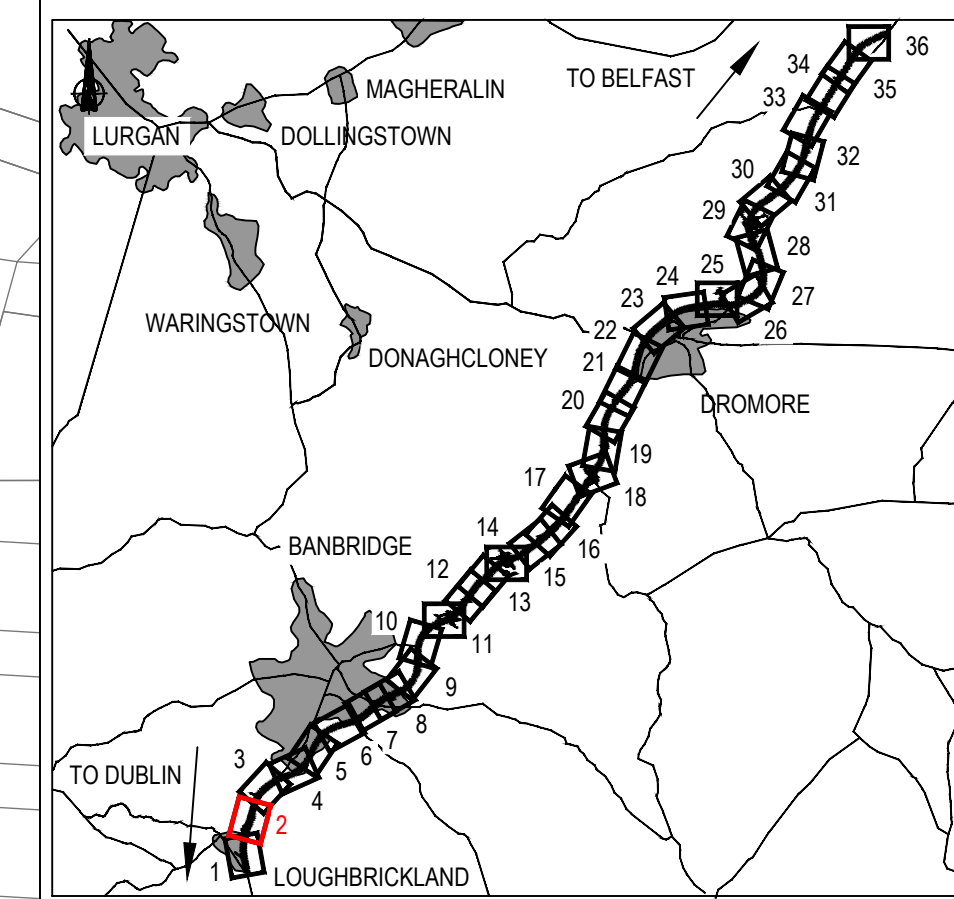

KEY

- Existing OS/ Survey Mapping
- Townland Boundary
- X-XX RSC Folio Reference No

Proposed Land Areas Required

- Red, Green, Blue, Yellow, Purple, Brown

Proposed Land Areas Required - Leasehold

- Diagonal hatching patterns

Easements being affected

- Blue dashed lines

P3	Cut lines removed	JF	PN	CD	07-Feb-2019
P2	Folios updated in relation to Land Registry review	DM	PN	CD	19-Oct-2018
REV	COMMENT	DRAWN	CH	AP	DATE

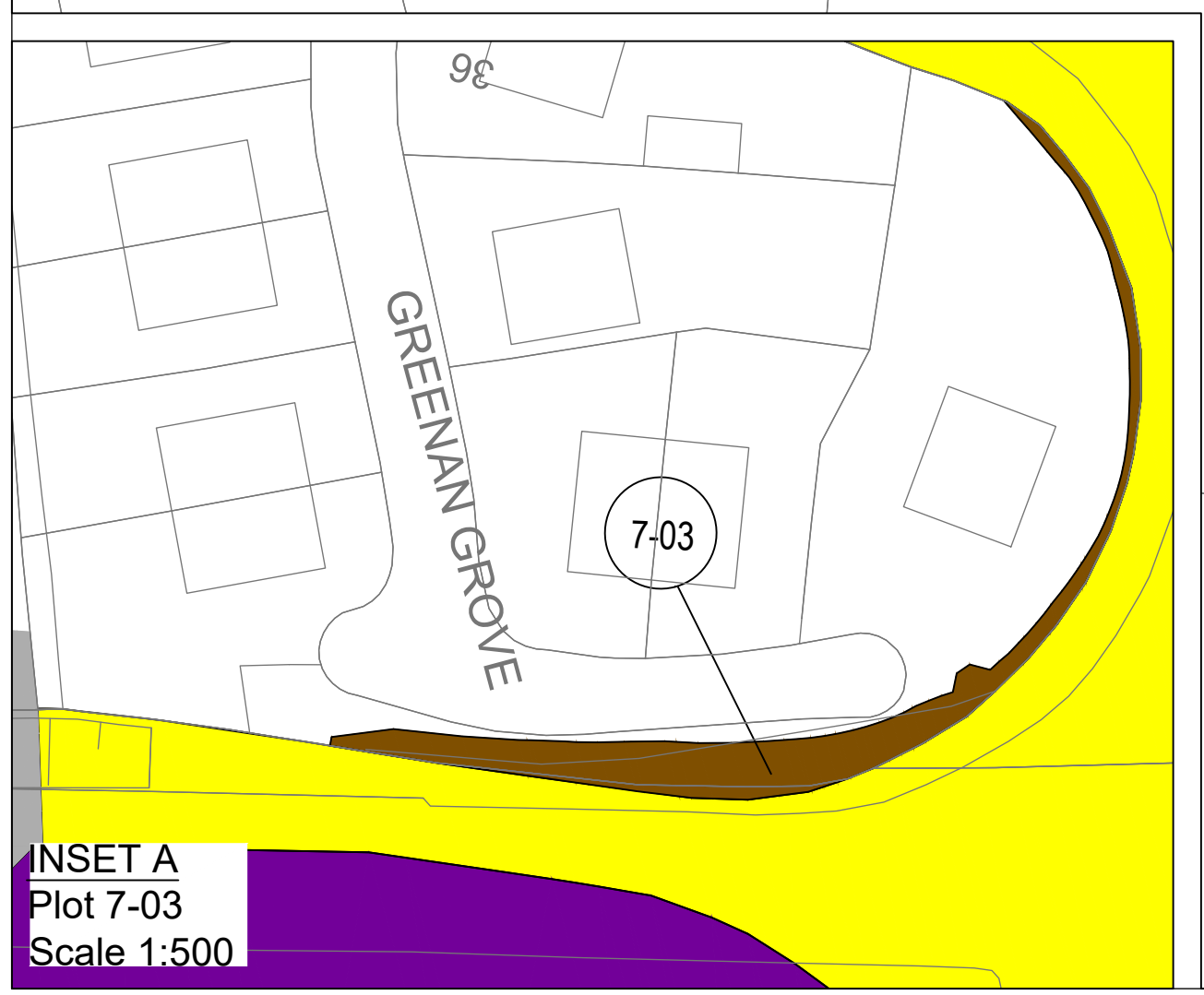
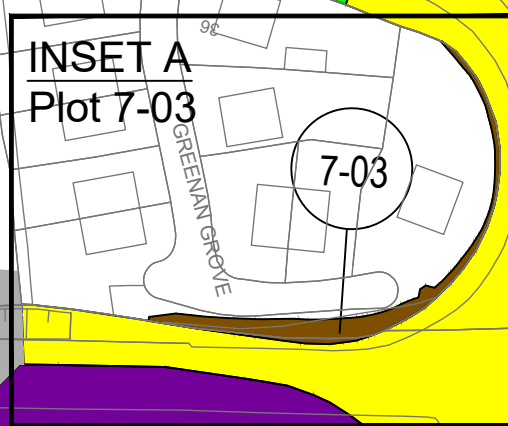
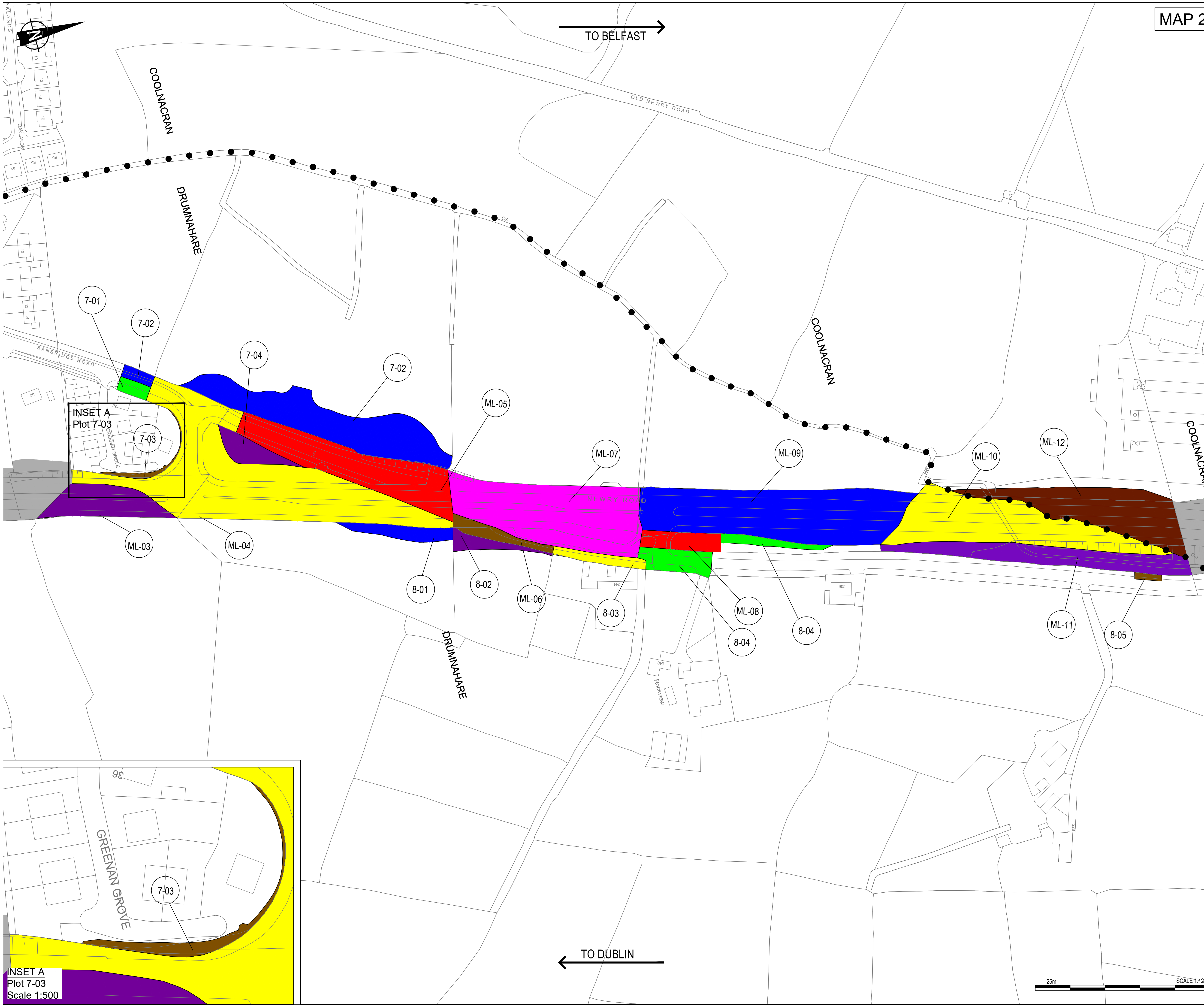

RPS **SWECO**

Elmwood House T +44 (0) 28 90 667914
 74 Boucher Road F +44 (0) 28 90 668286
 Belfast W www.rpsgroup.com/ireland
 BT12 6RZ E ireland@rpsgroup.com

Client
Department for Infrastructure
 An Roinn
Bonneagair
 www.infrastructure-ni.gov.uk

Project
A1 Junctions Phase 2

Title
 Notice of Intention to Make a Vesting Order (NIMVO) Plan - MAP 2

Drawing Status	Suitability	Project Ref No.		
S2	For Information	IBH0488		
Scale	Designed	Drawn By	Checked	Authorised
1:1250	JF	JF	PN	CD
Original Size	Date	Date	Date	Date
A1	07-06-18	07-06-18	23-08-18	23-08-18
Drawing Number	Rev P3.0			
TNI Ref Originator Volume Location Type Discipline Classification Number				
168014-RPSB-LOV-XX-DR-HE-2600-00002				



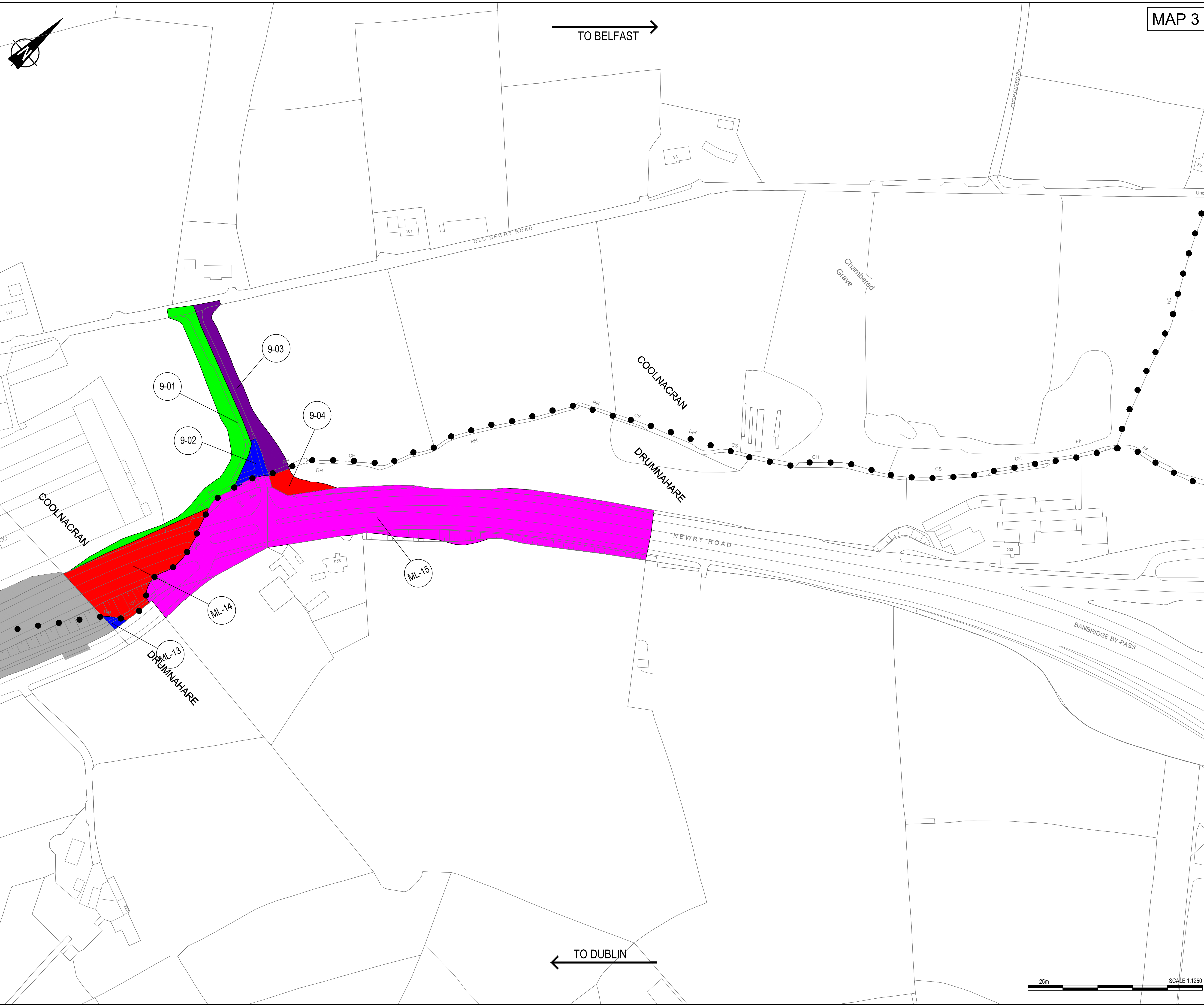

MAP 3

- NOTES**
1. Verifying Dimensions.
The contractor shall verify dimensions against such other drawings or site conditions as pertain to this part of the work.
 2. Existing Services.
Any information concerning the location of existing services indicated on this drawing is intended for general guidance only. It shall be the responsibility of the contractor to determine and verify the exact horizontal and vertical alignment of all cables, pipes, etc. (both underground and overhead) before work commences.
 3. Issue of Drawings.
Hard copies, dwf and pdf will form a controlled issue of the drawing. All other formats (dwg, dxf etc.) are deemed to be an uncontrolled issue and any work carried out based on these files is at the recipients own risk. RPS will not accept any responsibility for any errors arising from the use of these files, either by human error by the recipient, listing of un-dimensioned measurements, compatibility issues with the recipient's software, and any errors arising when these files are used to aid the recipients drawing production, or setting out on site.
 4. OS Sheets:
165-13, 165-14, 183-08, 183-12, 183-16, 184-01, 184-02, 184-05, 184-06, 184-09, 184-13, 202-03, 202-04, 202-07, 202-08, 202-10, 202-11, 202-13, 202-14, 202-15, 203-01, 220-08, 220-11, 220-12, 220-15, 220-16, 221-01, 221-02, 221-05, 221-09, 237-03, 237-04
 5. This is based upon Crown Copyright and is reproduced with the permission of Land & Property Services under delegated authority from the Controller of Her Majesty's Stationery Office, © Crown copyright and database right [2018] EMOU [206.2]
 6. DATUM: IRISH GRID

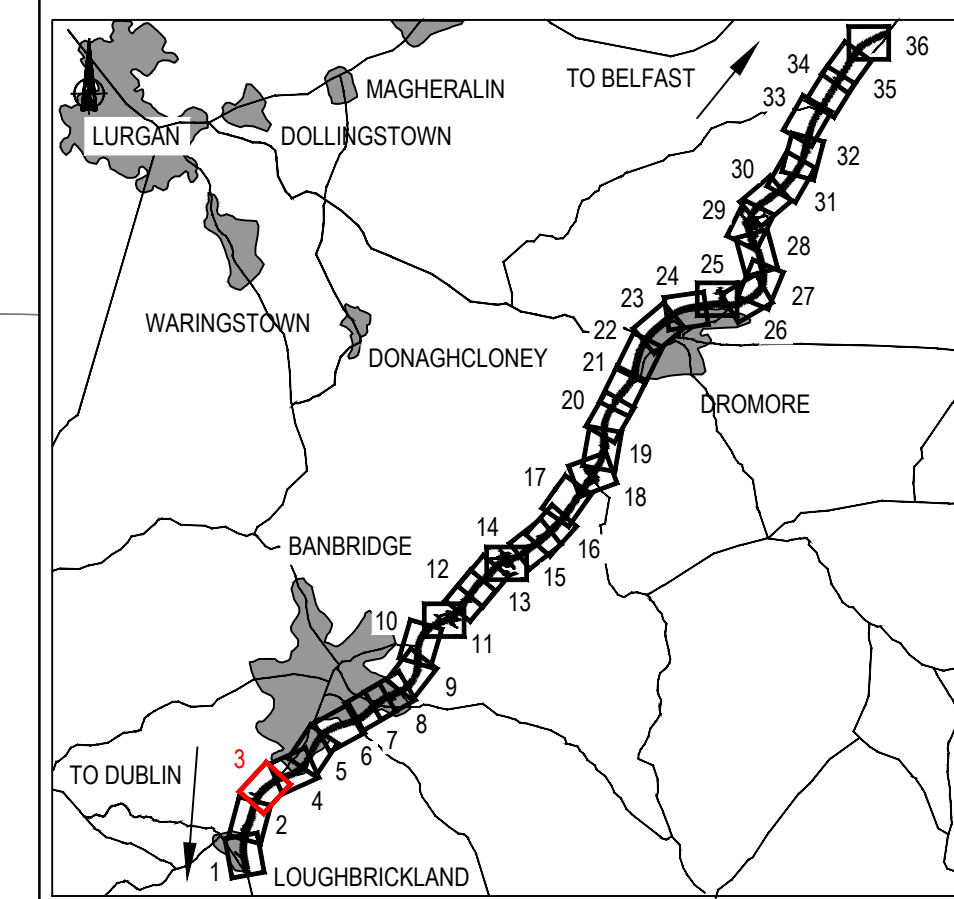

KEY

- Existing OS/ Survey Mapping
- Townland Boundary
- X-XX RSC Folio Reference No

Proposed Land Areas Required

- Red
- Green
- Blue
- Yellow
- Magenta
- Brown
- Purple

Proposed Land Areas Required - Leasehold

- Diagonal lines (top-left to bottom-right)
- Diagonal lines (top-right to bottom-left)

Easements being affected

- Red grid pattern
- Blue grid pattern
- Green dashed line

P3	Cut lines removed	JF	PN	CD	11-Feb-2019
P2	Folios updated in relation to Land Registry review	DM	PN	CD	19-Oct-2018
REV	COMMENT	DRAWN	CH	AP	DATE

RPS **SWECO**

Elmwood House T +44 (0) 28 90 687914
 74 Boucher Road F +44 (0) 28 90 688286
 Belfast W www.rpsgroup.com/ireland
 BT12 6RZ E ireland@rpsgroup.com

Client

Department for Infrastructure
 An Roinn
Bonneagair
 www.infrastructure-ri.gov.uk

Project

A1 Junctions Phase 2

Title

Notice of Intention to Make a Vesting Order (NIMVO) Plan - MAP 3

Drawing Status	Suitability	Project Ref No.		
S2	For Information	IBH0488		
Scale	Designed	Drawn By	Checked	Authorised
1:1250	JF	JF	PN	CD
Original Size	Date	Date	Date	Date
A1	07-06-18	07-06-18	23-08-18	23-08-18
Drawing Number	Rev P3.0			
TNI Ref	Originator	Volume	Location	Type Discipline Classification Number
168014-RPSB-LOV-XX-DR-HE-2600-00003				



- NOTES**
1. Verifying Dimensions.
The contractor shall verify dimensions against such other drawings or site conditions as pertain to this part of the work.
 2. Existing Services.
Any information concerning the location of existing services indicated on this drawing is intended for general guidance only. It shall be the responsibility of the contractor to determine and verify the exact horizontal and vertical alignment of all cables, pipes, etc. (both underground and overhead) before work commences.
 3. Issue of Drawings.
Hard copies, dwf and pdf will form a controlled issue of the drawing. All other formats (dwg, dxf etc.) are deemed to be an uncontrolled issue and any work carried out based on these files is at the recipient's own risk. RPS will not accept any responsibility for any errors arising from the use of these files, either by human error by the recipient, listing of un-dimensioned measurements, compatibility issues with the recipient's software, and any errors arising when these files are used to aid the recipient's drawing production, or setting out on site.
 4. OS Sheets:
165-13, 165-14, 183-08, 183-12, 183-16, 184-01, 184-02, 184-05, 184-06, 184-09, 184-13, 202-03, 202-04, 202-07, 202-08, 202-10, 202-11, 202-13, 202-14, 202-15, 203-01, 220-08, 220-11, 220-12, 220-15, 220-16, 221-01, 221-02, 221-05, 221-09, 237-03, 237-04
 5. This is based upon Crown Copyright and is reproduced with the permission of Land & Property Services under delegated authority from the Controller of Her Majesty's Stationery Office. © Crown copyright and database right [2018] EMOU [206.2]
 6. DATUM: IRISH GRID

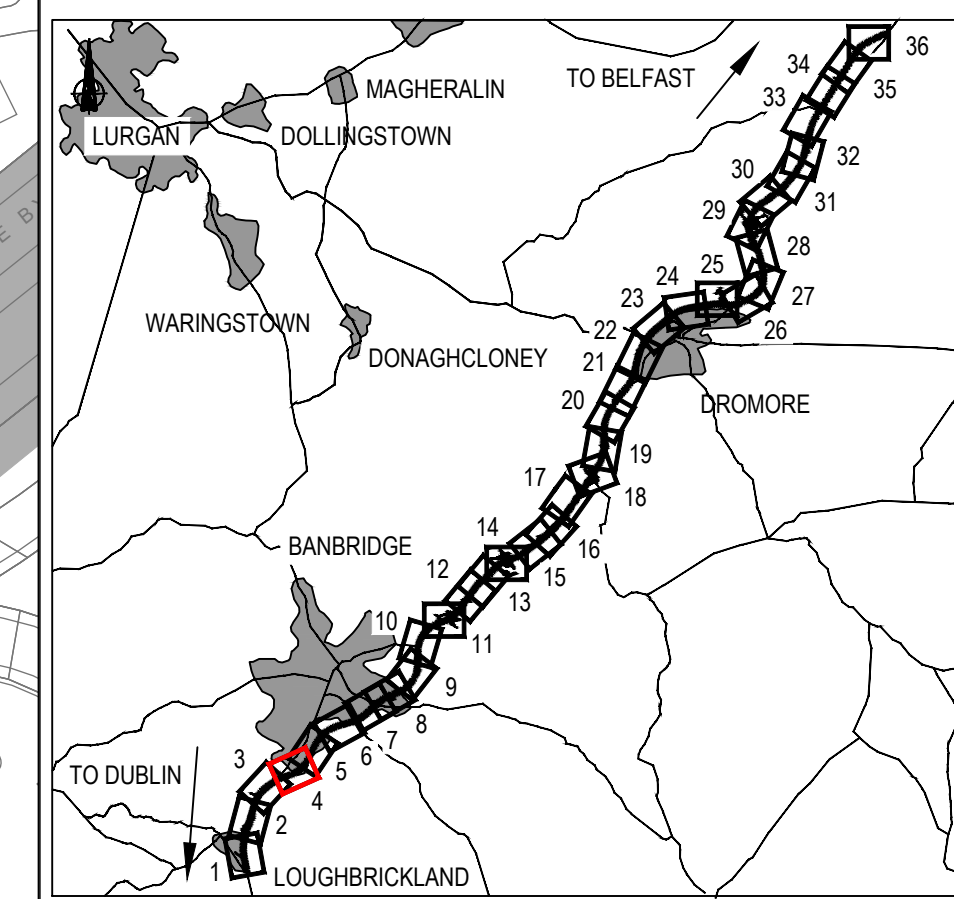
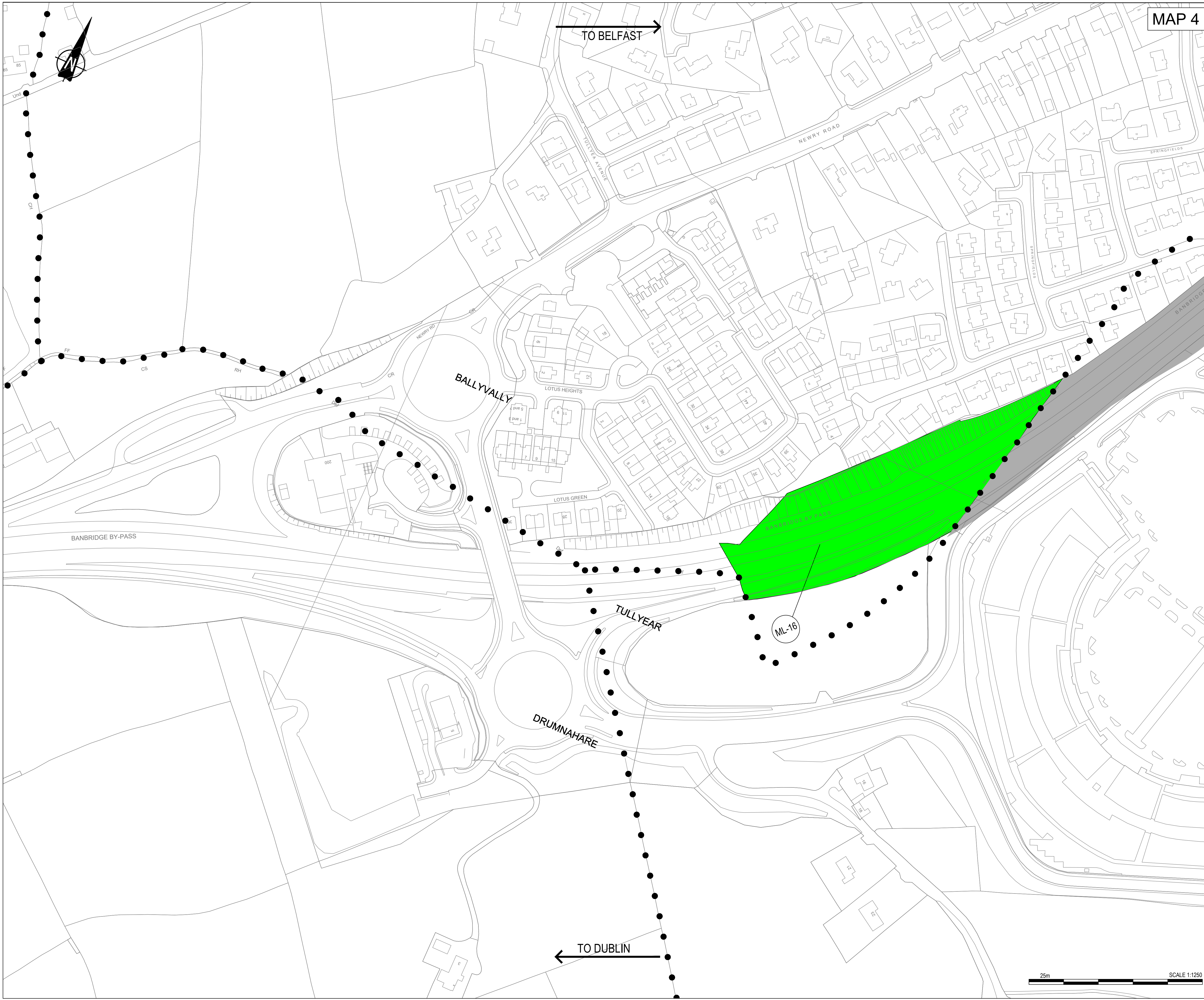

KEY

- Existing OS/ Survey Mapping
- Townland Boundary
- RSC Folio Reference No (X-XX)

Proposed Land Areas Required

- Red
- Green
- Blue
- Yellow
- Magenta
- Brown
- Purple

Proposed Land Areas Required - Leasehold

- Diagonal lines (top-left to bottom-right)
- Diagonal lines (top-right to bottom-left)

Easements being affected

- Red grid pattern
- Blue grid pattern
- Green dashed line

REV	COMMENT	DRAWN	CH	AP	DATE
P2	Cut lines removed	JF	PN	CD	11-Feb-2019

RPS **SWECO**

Elmwood House
74 Boucher Road
Belfast
BT12 6RZ

T +44 (0) 28 90 667914
F +44 (0) 28 90 668286
W www.rpsgroup.com/ireland
E ireland@rpsgroup.com

Client

Department for Infrastructure
An Roinn
Bonneagair
www.infrastructure-ni.gov.uk

Project

A1 Junctions Phase 2

Title

Notice of Intention to Make a Vesting Order (NIMVO) Plan - MAP 4

Drawing Status	Suitability	Project Ref No.
S2	For Information	IBH0488

Scale	Designed	Drawn By	Checked	Authorised
1:1250	JF	JF	PN	CD

Original Size	Date	Date	Date	Date
A1	07-06-18	07-06-18	23-08-18	23-08-18

Drawing Number

Rev P2.0

TNI Ref | Originator | Volume | Location | Type | Discipline | Classification | Number
168014-RPSB-LOV-XX-DR-HE-2600-00004

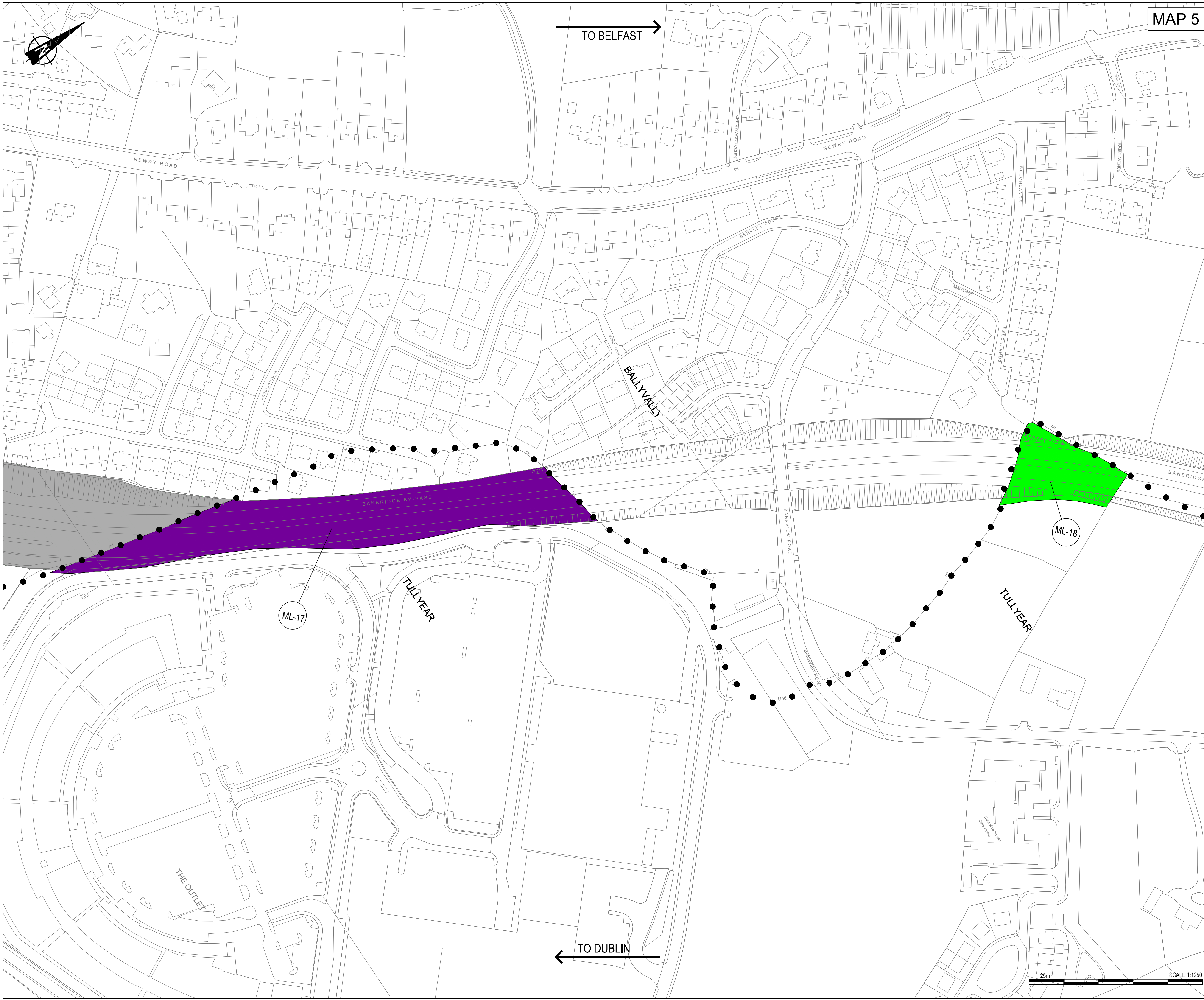

MAP 5

- NOTES**
1. Verifying Dimensions. The contractor shall verify dimensions against such other drawings or site conditions as pertain to this part of the work.
 2. Existing Services. Any information concerning the location of existing services indicated on this drawing is intended for general guidance only. It shall be the responsibility of the contractor to determine and verify the exact horizontal and vertical alignment of all cables, pipes, etc. (both underground and overhead) before work commences.
 3. Issue of Drawings. Hard copies, dwf and pdf will form a controlled issue of the drawing. All other formats (dwg, dxf etc.) are deemed to be an uncontrolled issue and any work carried out based on these files is at the recipients own risk. RPS will not accept any responsibility for any errors arising from the use of these files, either by human error by the recipient, listing of un-dimensioned measurements, compatibility issues with the recipient's software, and any errors arising when these files are used to aid the recipients drawing production, or setting out on site.
 4. OS Sheets: 165-13, 165-14, 183-08, 183-12, 183-16, 184-01, 184-02, 184-05, 184-06, 184-09, 184-13, 202-03, 202-04, 202-07, 202-08, 202-10, 202-11, 202-13, 202-14, 202-15, 203-01, 220-08, 220-11, 220-12, 220-15, 220-16, 221-01, 221-02, 221-05, 221-09, 237-03, 237-04
 5. This is based upon Crown Copyright and is reproduced with the permission of Land & Property Services under delegated authority from the Controller of Her Majesty's Stationery Office. © Crown copyright and database right [2018] EMOU [206.2]
 6. DATUM: IRISH GRID

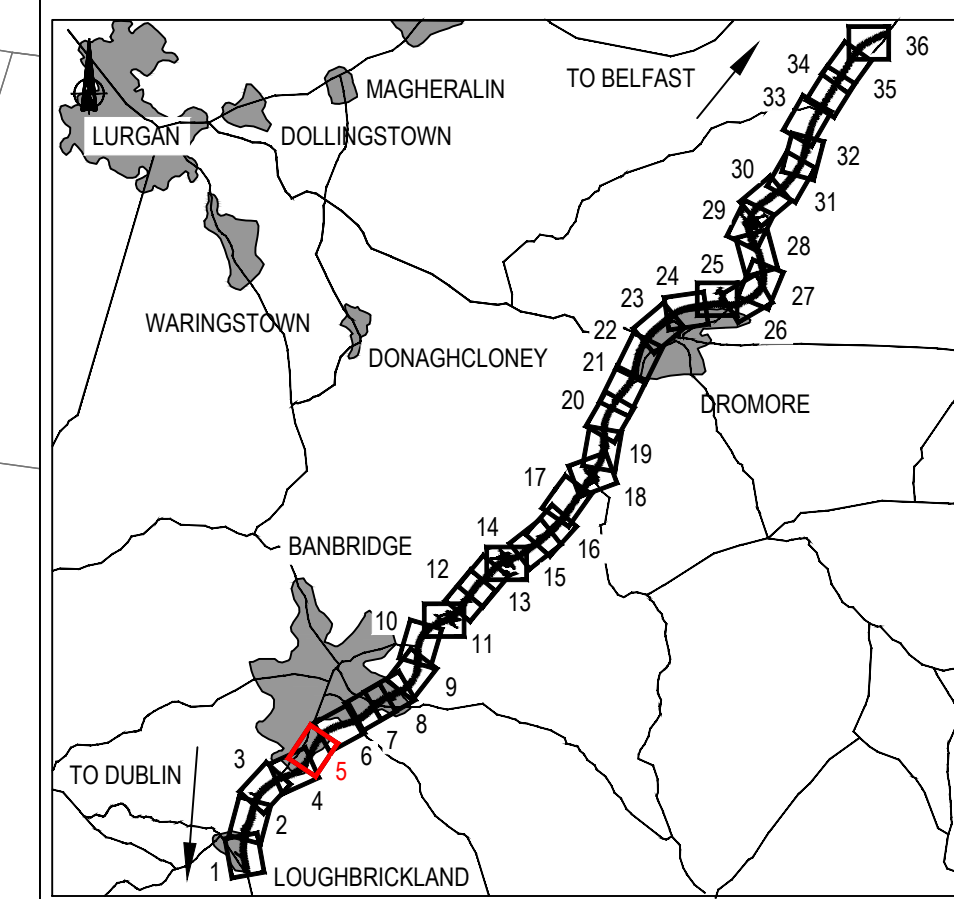

KEY

- Existing OS / Survey Mapping
- Townland Boundary
- RSC Folio Reference No (X-XX)

Proposed Land Areas Required

- Red, Green, Blue, Yellow

Proposed Land Areas Required - Leasehold

- Diagonal hatching patterns

Easements being affected

- Grid patterns and dashed lines

P2	Cut lines removed	JF	PN	CD	11-Feb-2019
REV	COMMENT	DRAWN	CH	AP	DATE

RPS **SWECO**

Elmwood House T +44 (0) 28 90 687914
 74 Boucher Road F +44 (0) 28 90 688286
 Belfast W www.rpsgroup.com/ireland
 BT12 6RZ E ireland@rpsgroup.com

Client: **Department for Infrastructure**
Bonneagair
 www.infrastructure-ri.gov.uk

Project: **A1 Junctions Phase 2**

Title: **Notice of Intention to Make a Vesting Order (NIMVO) Plan - MAP 5**

Drawing Status	Suitability	Project Ref No.			
S2	For Information	IBH0488			
Scale	Designed	Drawn By	Checked	Authorised	
1:1250	JF	JF	PN	CD	
Original Size	Date	Date	Date	Date	
A1	07-06-18	07-06-18	23-08-18	23-08-18	
Drawing Number	Rev				P2.0
TNI Ref Originator Volume Location Type Discipline Classification Number					
168014-RPSB-LOV-XX-DR-HE-2600-00005					



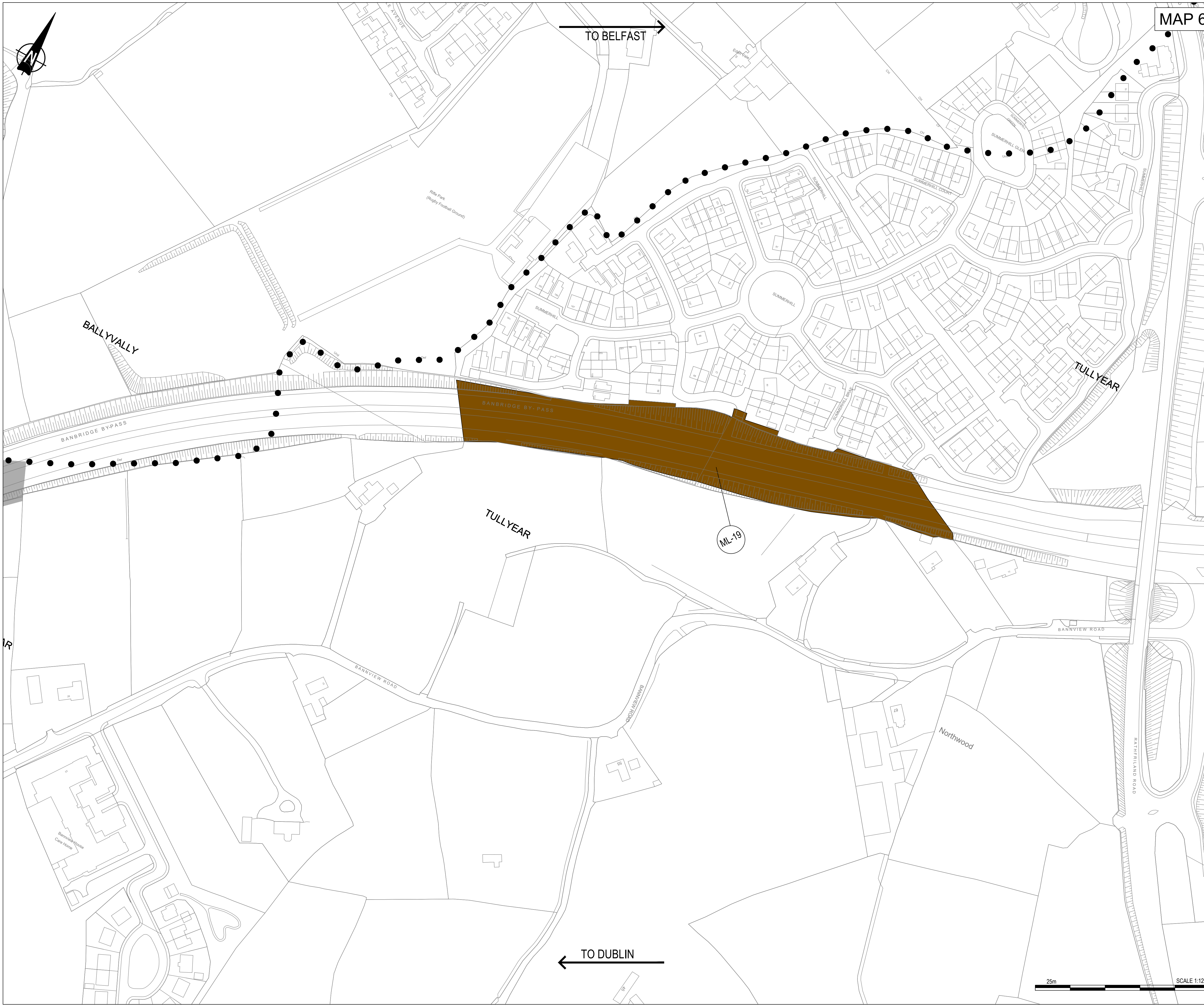

MAP 6

- NOTES**
1. Verifying Dimensions.
The contractor shall verify dimensions against such other drawings or site conditions as pertain to this part of the work.
 2. Existing Services.
Any information concerning the location of existing services indicated on this drawing is intended for general guidance only. It shall be the responsibility of the contractor to determine and verify the exact horizontal and vertical alignment of all cables, pipes, etc. (both underground and overhead) before work commences.
 3. Issue of Drawings.
Hard copies, dwf and pdf will form a controlled issue of the drawing. All other formats (dwg, dxf etc.) are deemed to be an uncontrolled issue and any work carried out based on these files is at the recipient's own risk. RPS will not accept any responsibility for any errors arising from the use of these files, either by human error by the recipient, listing of un-dimensioned measurements, compatibility issues with the recipient's software, and any errors arising when these files are used to aid the recipient's drawing production, or setting out on site.
 4. OS Sheets:
165-13, 165-14, 183-08, 183-12, 183-16, 184-01, 184-02, 184-05, 184-06, 184-09, 184-13, 202-03, 202-04, 202-07, 202-08, 202-10, 202-11, 202-13, 202-14, 202-15, 203-01, 220-08, 220-11, 220-12, 220-15, 220-16, 221-01, 221-02, 221-05, 221-09, 237-03, 237-04
 5. This is based upon Crown Copyright and is reproduced with the permission of Land & Property Services under delegated authority from the Controller of Her Majesty's Stationery Office. © Crown copyright and database right [2018] EMOU [206 2]
 6. DATUM: IRISH GRID

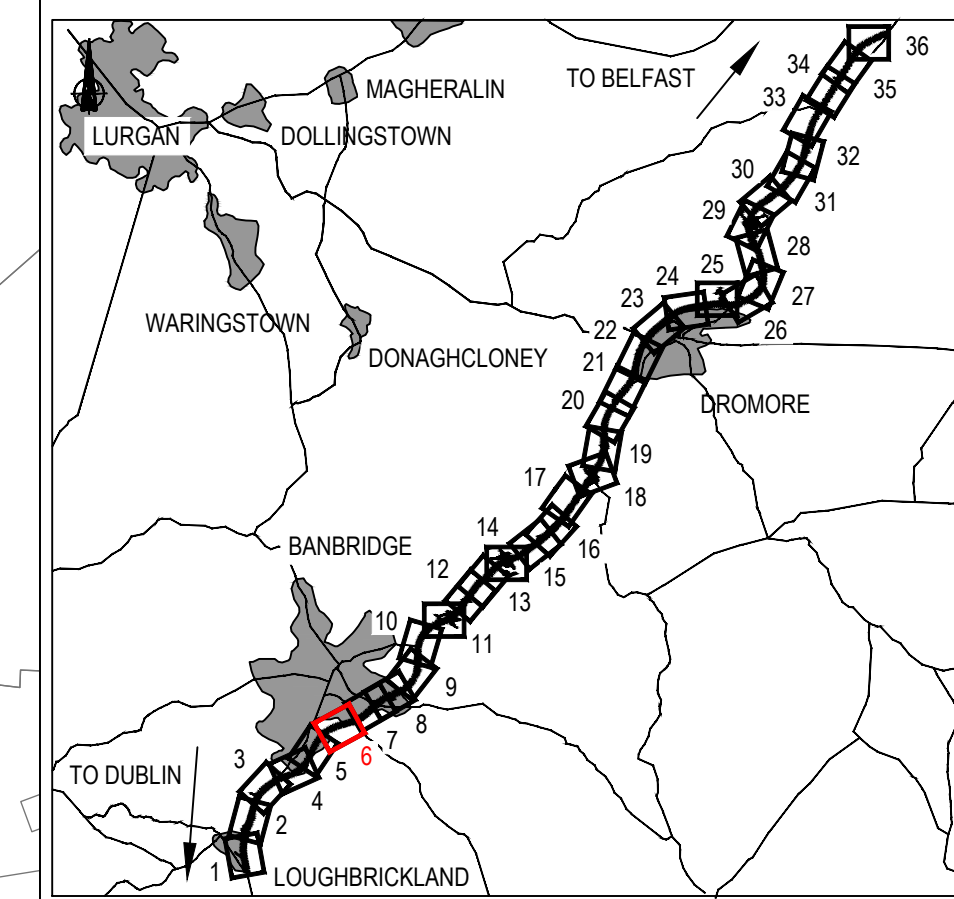

KEY

- Existing OS / Survey Mapping
- Townland Boundary
- RSC Folio Reference No (X-XX)

Proposed Land Areas Required

- Red, Green, Blue, Yellow, Purple, Brown, Magenta

Proposed Land Areas Required - Leasehold

- Hatched patterns

Easements being affected

- Blue grid, Green dashed line

P3	Cut lines removed	JF	PN	CD	11-Feb-2019
P2	Folios updated in relation to Land Registry review	DM	PN	CD	19-Oct-2018
REV	COMMENT	DRAWN	CH	AP	DATE

RPS **SWECO**

Elmwood House T +44 (0) 28 90 667914
 74 Boucher Road F +44 (0) 28 90 668286
 Belfast W www.rpsgroup.com/ireland
 BT12 6RZ E ireland@rpsgroup.com

Client: **Department for Infrastructure**
An Roinn
Bonneagair
 www.infrastructure-ri.gov.uk

Project: **A1 Junctions Phase 2**

Title: **Notice of Intention to Make a Vesting Order (NIMVO) Plan - MAP 6**

Drawing Status	Suitability	Project Ref No.		
S2	For Information	IBH0488		
Scale	Designed	Drawn By	Checked	Authorised
1:1250	JF	JF	PN	CD
Original Size	Date	Date	Date	Date
A1	07-06-18	07-06-18	23-08-18	23-08-18
Drawing Number	Rev P3.0			
TNI Ref Originator Volume Location Type Discipline Classification Number				
168014-RPSB-LOV-XX-DR-HE-2600-00006				



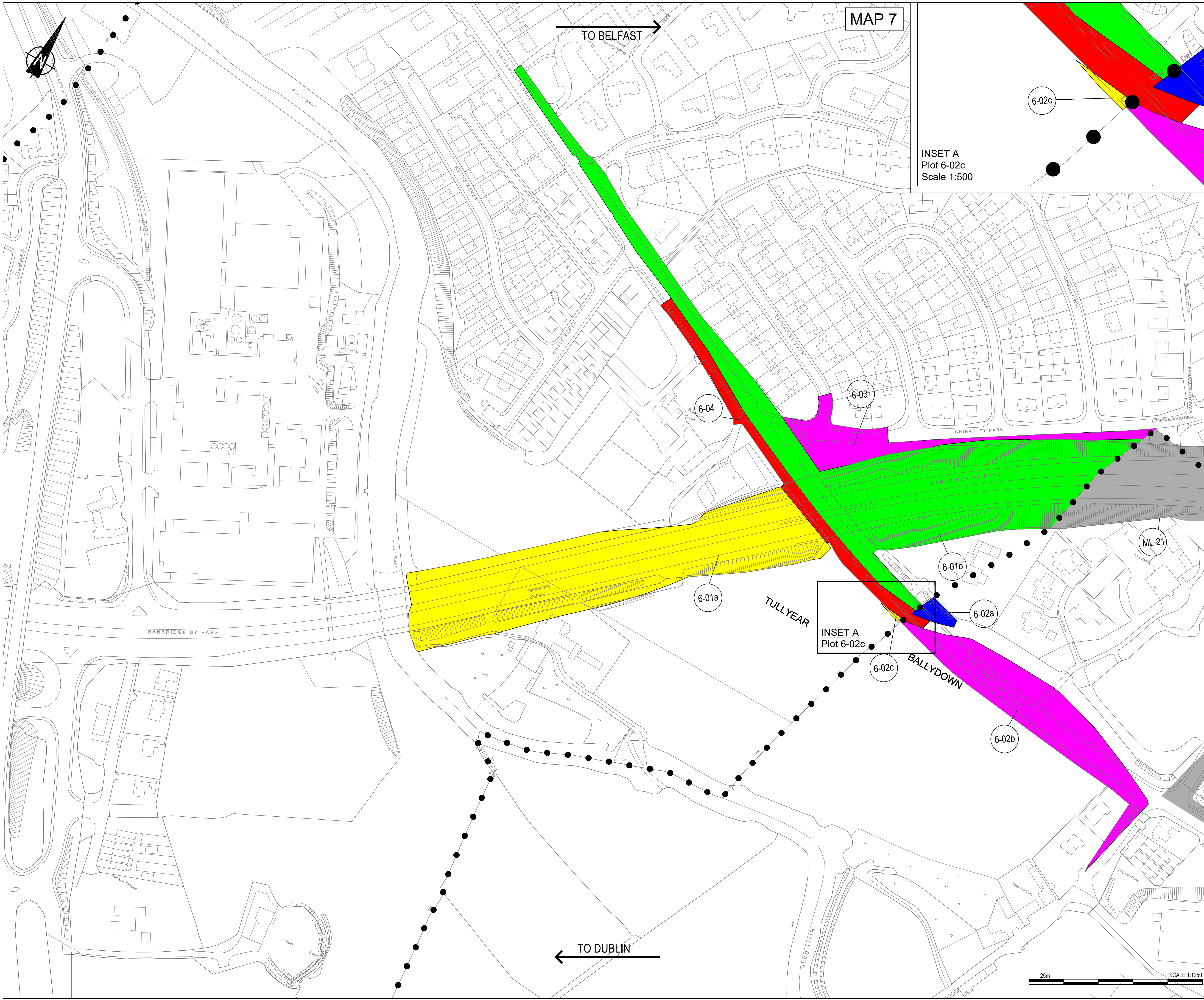

MAP 7

INSET A
Plot 6-02c
Scale 1:500

- NOTES**
1. Verifying Dimensions.
The contractor shall verify dimensions against such other drawings or site conditions as pertain to this part of the work.
 2. Existing Services.
Any information concerning the location of existing services indicated on this drawing is intended for general guidance only. It shall be the responsibility of the contractor to determine and verify the exact horizontal and vertical alignment of all cables, pipes, etc. (both underground and overhead) before work commences.
 3. Issue of Drawings.
Hard copies, dwf and pdf will form a controlled issue of the drawing. All other formats (dwg, dxf etc.) are deemed to be an uncontrolled issue and any work carried out based on these files is at the recipient's own risk. RPS will not accept any responsibility for any errors arising from the use of these files, either by human error by the recipient, listing of un-dimensioned measurements, compatibility issues with the recipient's software, and any errors arising when these files are used to aid the recipient's drawing production, or setting out on site.
 4. OS Sheets:
165-13, 165-14, 183-08, 183-12, 183-16, 184-01, 184-02, 184-05, 184-06, 184-09, 184-13, 202-03, 202-04, 202-07, 202-08, 202-10, 202-11, 202-13, 202-14, 202-15, 203-01, 220-08, 220-11, 220-12, 220-15, 220-16, 221-01, 221-02, 221-05, 221-09, 237-03, 237-04
 5. This is based upon Crown Copyright and is reproduced with the permission of Land & Property Services under delegated authority from the Controller of Her Majesty's Stationery Office. © Crown copyright and database right [2018] EMOU [206.2]
 6. DATUM: IRISH GRID

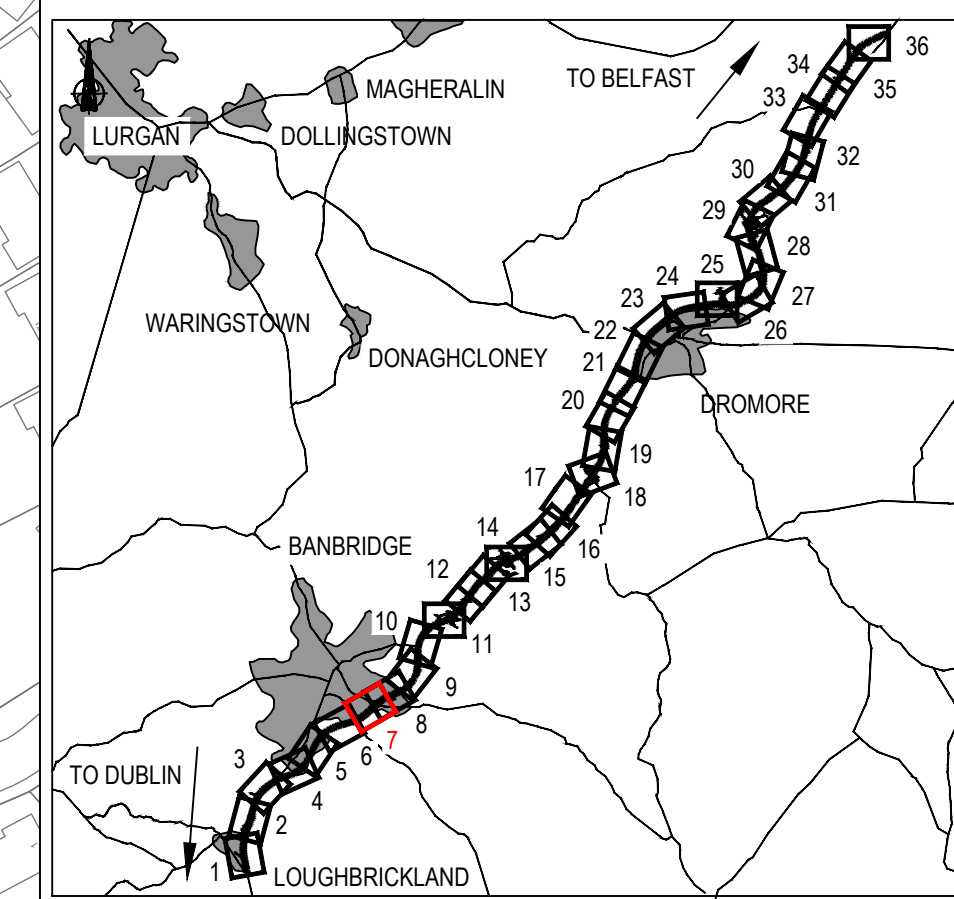

KEY

- Existing OS/ Survey Mapping
- Townland Boundary
- RSC Folio Reference No

Proposed Land Areas Required

- Red, Green, Blue, Yellow
- Magenta, Brown, Purple

Proposed Land Areas Required - Leasehold

- Diagonal hatching

Easements being affected

- Grid hatching
- Dashed lines

P2	Cut lines removed	JF	PN	CD	11-Feb-2019
REV	COMMENT	DRAWN	CH	AP	DATE

RPS **SWECO**

Elmwood House T +44 (0) 28 90 687914
74 Boucher Road F +44 (0) 28 90 688286
Belfast W www.rpsgroup.com/ireland
BT12 6RZ E ireland@rpsgroup.com

Client: **Department for Infrastructure**
An Roinn **Bonneagair**
www.infrastructure-ri.gov.uk

Project: **A1 Junctions Phase 2**

Title: **Notice of Intention to Make a Vesting Order (NIMVO) Plan - MAP 7**

Drawing Status	Suitability	Project Ref No.			
S2	For Information	IBH0488			
Scale	Designed	Drawn By	Checked	Authorised	
1:1250	JF	JF	PN	CD	
Original Size	Date	Date	Date	Date	
A1	07-06-18	07-06-18	23-08-18	23-08-18	
Drawing Number	Rev				P2.0
TNI Ref Originator Volume Location Type Discipline Classification Number					
168014-RPSB-LOV-XX-DR-HE-2600-00007					



- NOTES**
1. Verifying Dimensions.
The contractor shall verify dimensions against such other drawings or site conditions as pertain to this part of the work.
 2. Existing Services.
Any information concerning the location of existing services indicated on this drawing is intended for general guidance only. It shall be the responsibility of the contractor to determine and verify the exact horizontal and vertical alignment of all cables, pipes, etc. (both underground and overhead) before work commences.
 3. Issue of Drawings.
Hard copies, dwf and pdf will form a controlled issue of the drawing. All other formats (dwg, dxf etc.) are deemed to be an uncontrolled issue and any work carried out based on these files is at the recipient's own risk. RPS will not accept any responsibility for any errors arising from the use of these files, either by human error by the recipient, listing of un-dimensioned measurements, compatibility issues with the recipient's software, and any errors arising when these files are used to aid the recipient's drawing production, or setting out on site.
 4. OS Sheets:
165-13, 165-14, 183-08, 183-12, 183-16, 184-01, 184-02, 184-05, 184-06, 184-09, 184-13, 202-03, 202-04, 202-07, 202-08, 202-10, 202-11, 202-13, 202-14, 202-15, 203-01, 220-08, 220-11, 220-12, 220-15, 220-16, 221-01, 221-02, 221-05, 221-09, 237-03, 237-04
 5. This is based upon Crown Copyright and is reproduced with the permission of Land & Property Services under delegated authority from the Controller of Her Majesty's Stationery Office. © Crown copyright and database right [2018] EMOU [206.2]
 6. DATUM: IRISH GRID

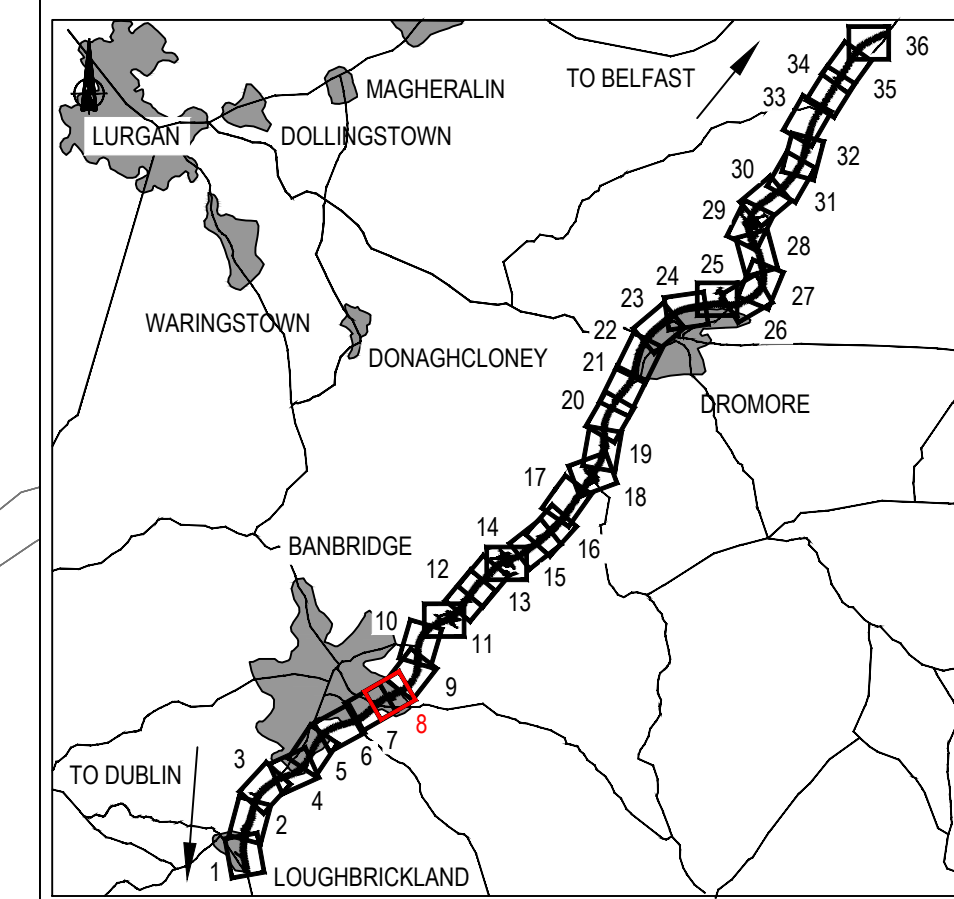

KEY

- Existing OS / Survey Mapping
- Townland Boundary
- RSC Folio Reference No

Proposed Land Areas Required

- Red, Green, Blue, Yellow, Purple, Brown, Orange

Proposed Land Areas Required - Leasehold

- Diagonal hatching patterns

Easements being affected

- Grid patterns and dashed lines

P2	Cut lines removed	JF	PN	CD	11-Feb-2019
REV	COMMENT	DRAWN	CH	AP	DATE

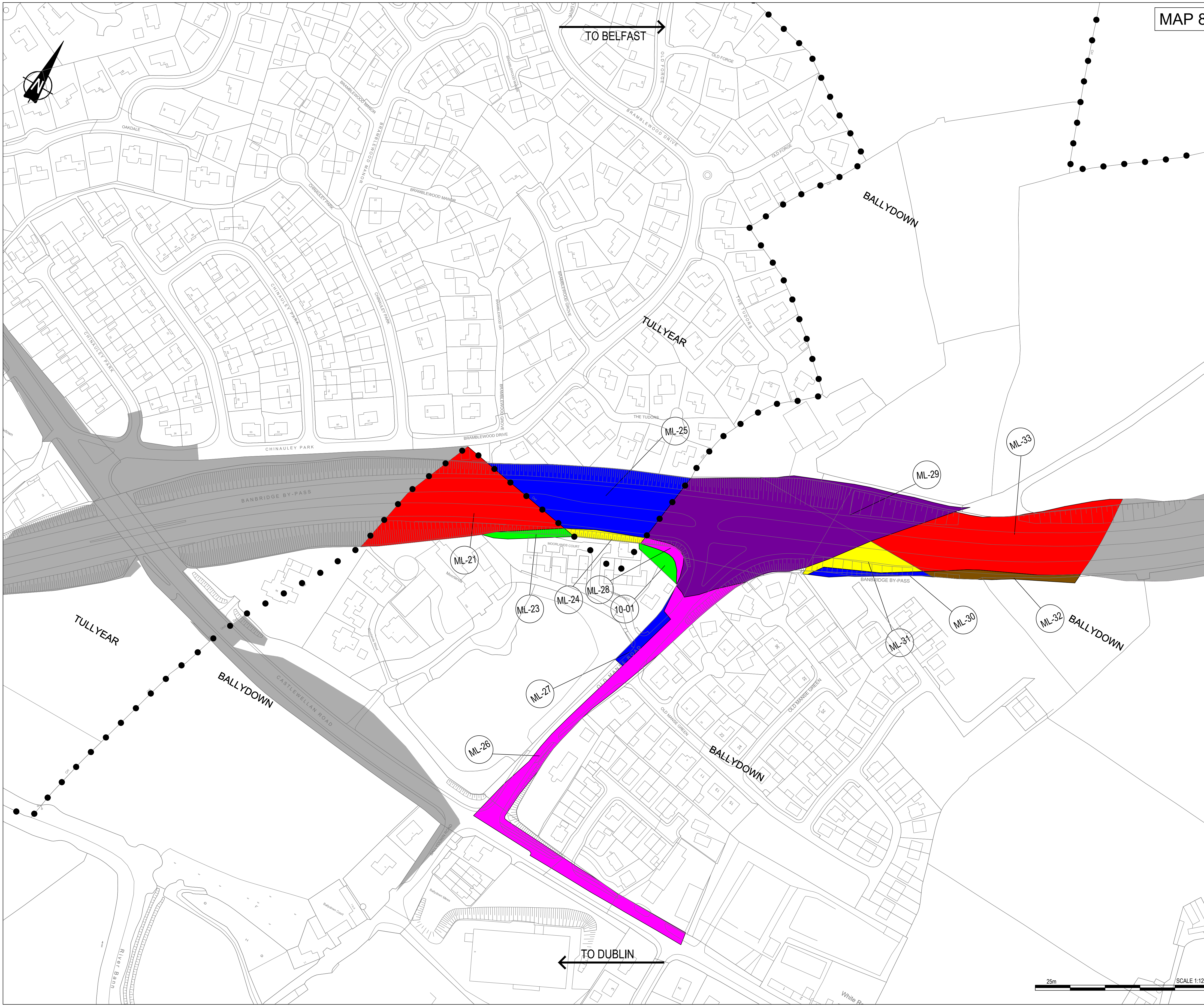

RPS **SWECO**

Elmwood House T +44 (0) 28 90 667914
 74 Boucher Road F +44 (0) 28 90 668286
 Belfast W www.rpsgroup.com/ireland
 BT12 6RZ E ireland@rpsgroup.com

Client: **Department for Infrastructure**
An Roinn
Bonneagair
 www.infrastructure-ni.gov.uk

Project: **A1 Junctions Phase 2**

Title: **Notice of Intention to Make a Vesting Order (NIMVO) Plan - MAP 8**

Drawing Status	Suitability	Project Ref No.			
S2	For Information	IBH0488			
Scale	Designed	Drawn By	Checked	Authorised	
1:1250	JF	JF	PN	CD	
Original Size	Date	Date	Date	Date	
A1	07-06-18	07-06-18	23-08-18	23-08-18	
Drawing Number	Rev				P2.0
TNI Ref Originator Volume Location Type Discipline Classification Number					
168014-RPSB-LOV-XX-DR-HE-2600-00008					

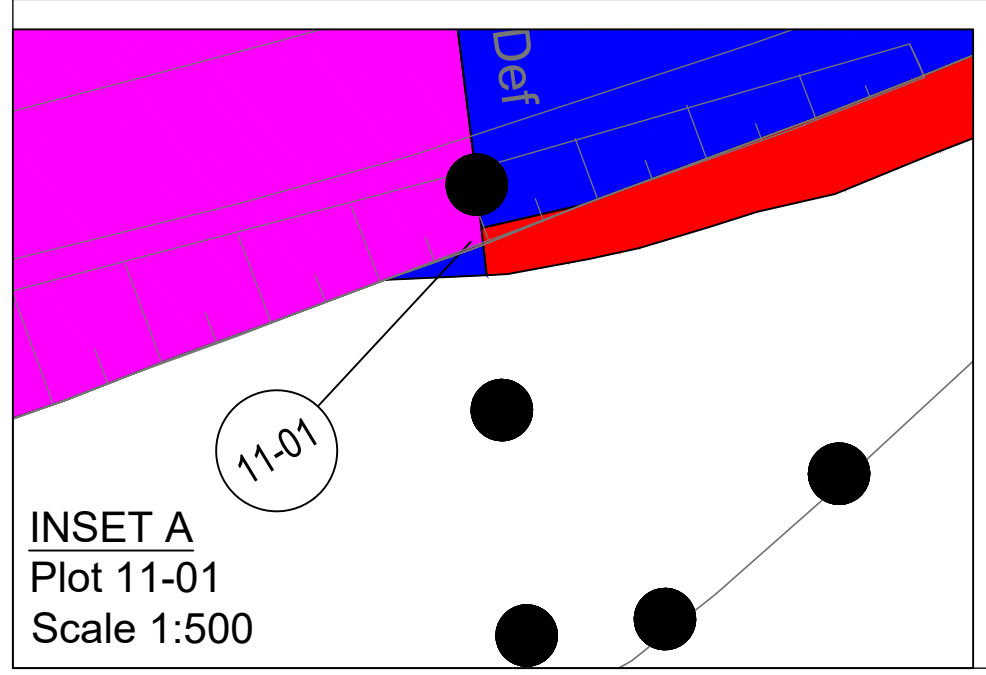
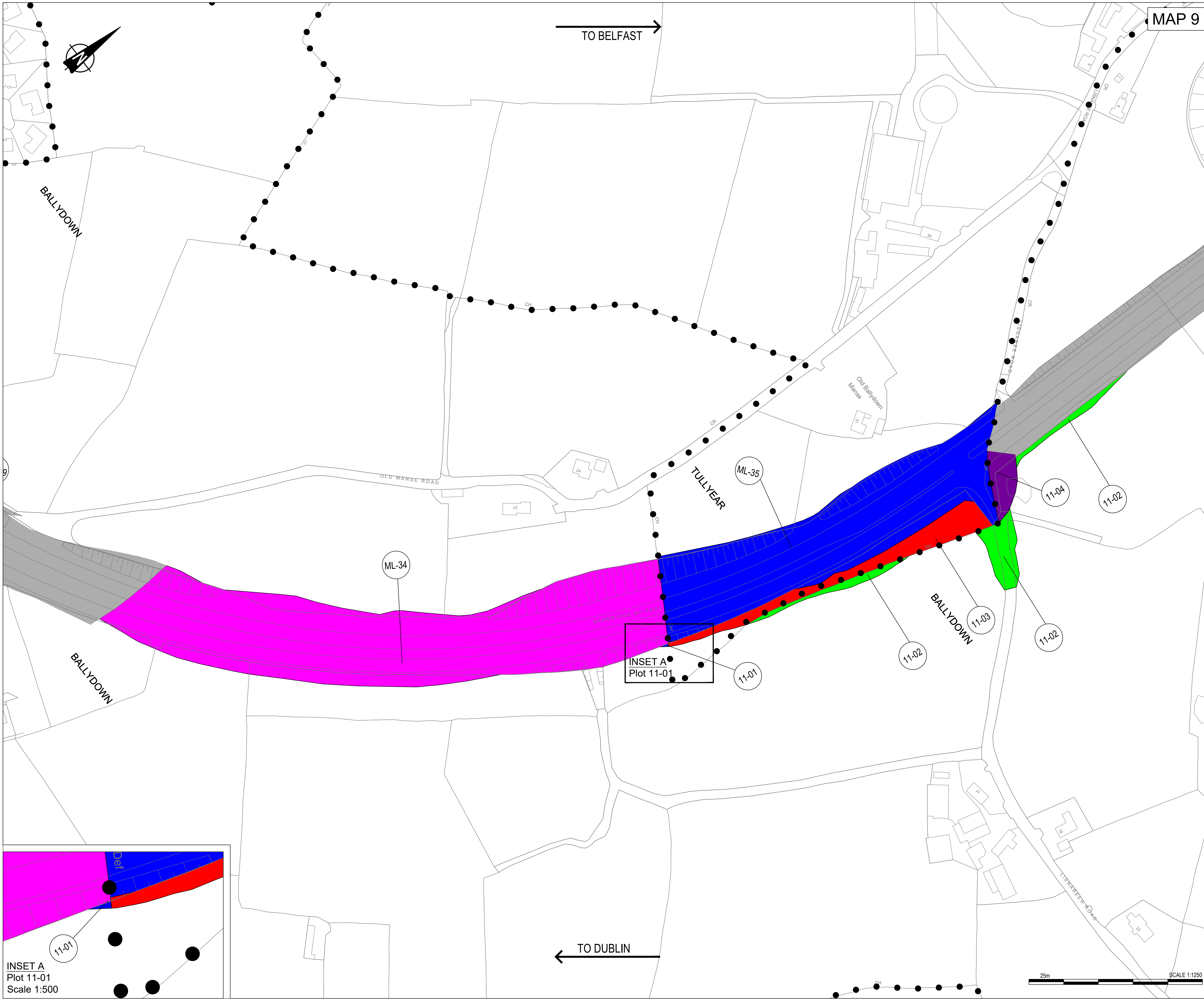

MAP 9

- NOTES**
1. Verifying Dimensions.
The contractor shall verify dimensions against such other drawings or site conditions as pertain to this part of the work.
 2. Existing Services.
Any information concerning the location of existing services indicated on this drawing is intended for general guidance only. It shall be the responsibility of the contractor to determine and verify the exact horizontal and vertical alignment of all cables, pipes, etc. (both underground and overhead) before work commences.
 3. Issue of Drawings.
Hard copies, dwf and pdf will form a controlled issue of the drawing. All other formats (dwg, dxf etc.) are deemed to be an uncontrolled issue and any work carried out based on these files is at the recipient's own risk. RPS will not accept any responsibility for any errors arising from the use of these files, either by human error by the recipient, listing of un-dimensioned measurements, compatibility issues with the recipient's software, and any errors arising when these files are used to aid the recipient's drawing production, or setting out on site.
 4. OS Sheets:
165-13, 165-14, 183-08, 183-12, 183-16, 184-01, 184-02, 184-05, 184-06, 184-09, 184-13, 202-03, 202-04, 202-07, 202-08, 202-10, 202-11, 202-13, 202-14, 202-15, 203-01, 220-08, 220-11, 220-12, 220-15, 220-16, 221-01, 221-02, 221-05, 221-09, 237-03, 237-04
 5. This is based upon Crown Copyright and is reproduced with the permission of Land & Property Services under delegated authority from the Controller of Her Majesty's Stationary Office, © Crown copyright and database right [2018] EMOU [206.2]
 6. DATUM: IRISH GRID

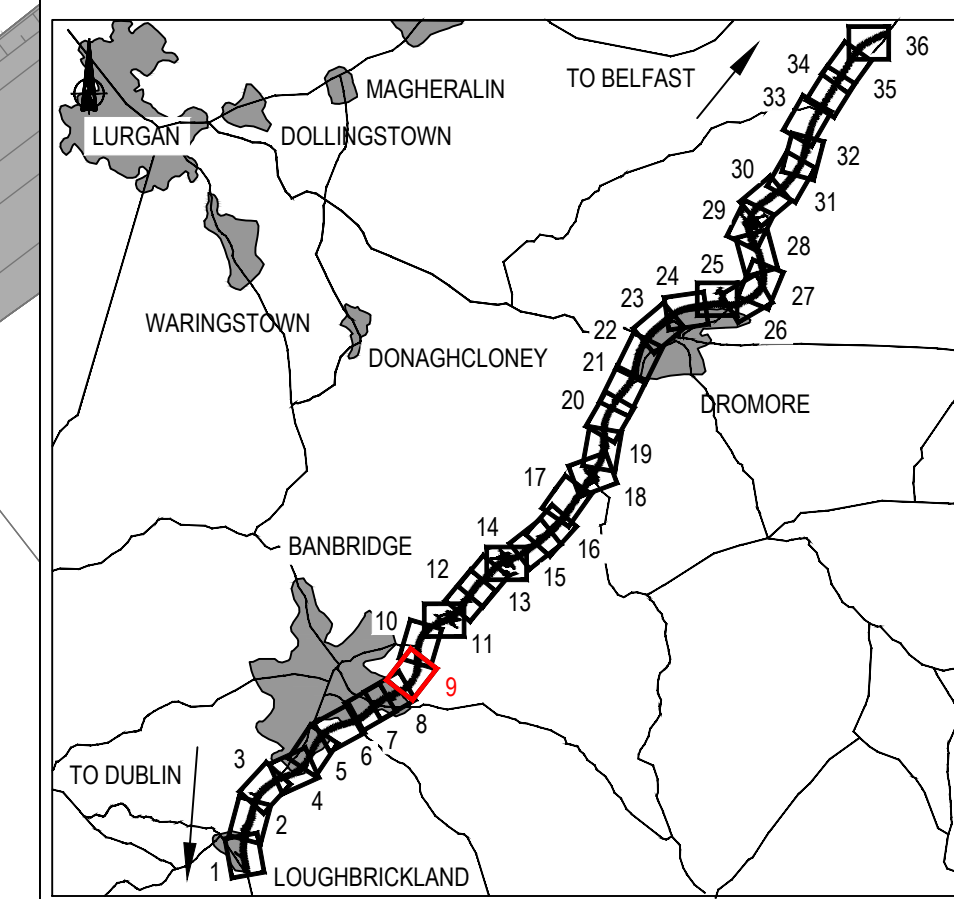

KEY

- Existing OS/ Survey Mapping
- Townland Boundary
- RSC Folio Reference No (X-XX)

Proposed Land Areas Required

- Red, Green, Blue, Yellow, Purple, Brown

Proposed Land Areas Required - Leasehold

- Diagonal hatching patterns

Easements being affected

- Grid patterns

P3	Cut lines removed	JF	DM	PN	CD	11-Feb-2019
P2	Folios updated in relation to Land Registry review	JF	DM	PN	CD	23-Oct-2018
REV	COMMENT	DRAWN	CH	AP	DATE	

RPS **SWECO**

Elmwood House T +44 (0) 28 90 687914
 74 Boucher Road F +44 (0) 28 90 688286
 Belfast W www.rpsgroup.com/ireland
 BT12 6RZ E ireland@rpsgroup.com

Client: Department for Infrastructure
 An Roinn **Bonneagair**
 www.infrastructure-ni.gov.uk

Project: **A1 Junctions Phase 2**

Title: Notice of Intention to Make a Vesting Order (NIMVO) Plan - MAP 9

Drawing Status	Suitability	Project Ref No.		
S2	For Information	IBH0488		
Scale	Designed	Drawn By	Checked	Authorised
1:1250	JF	JF	PN	CD
Original Size	Date	Date	Date	Date
A1	07-06-18	07-06-18	23-08-18	23-08-18
Drawing Number	Rev P3.0			
TNI Ref Originator Volume Location Type Discipline Classification Number				
168014-RPSB-LOV-XX-DR-HE-2600-00009				

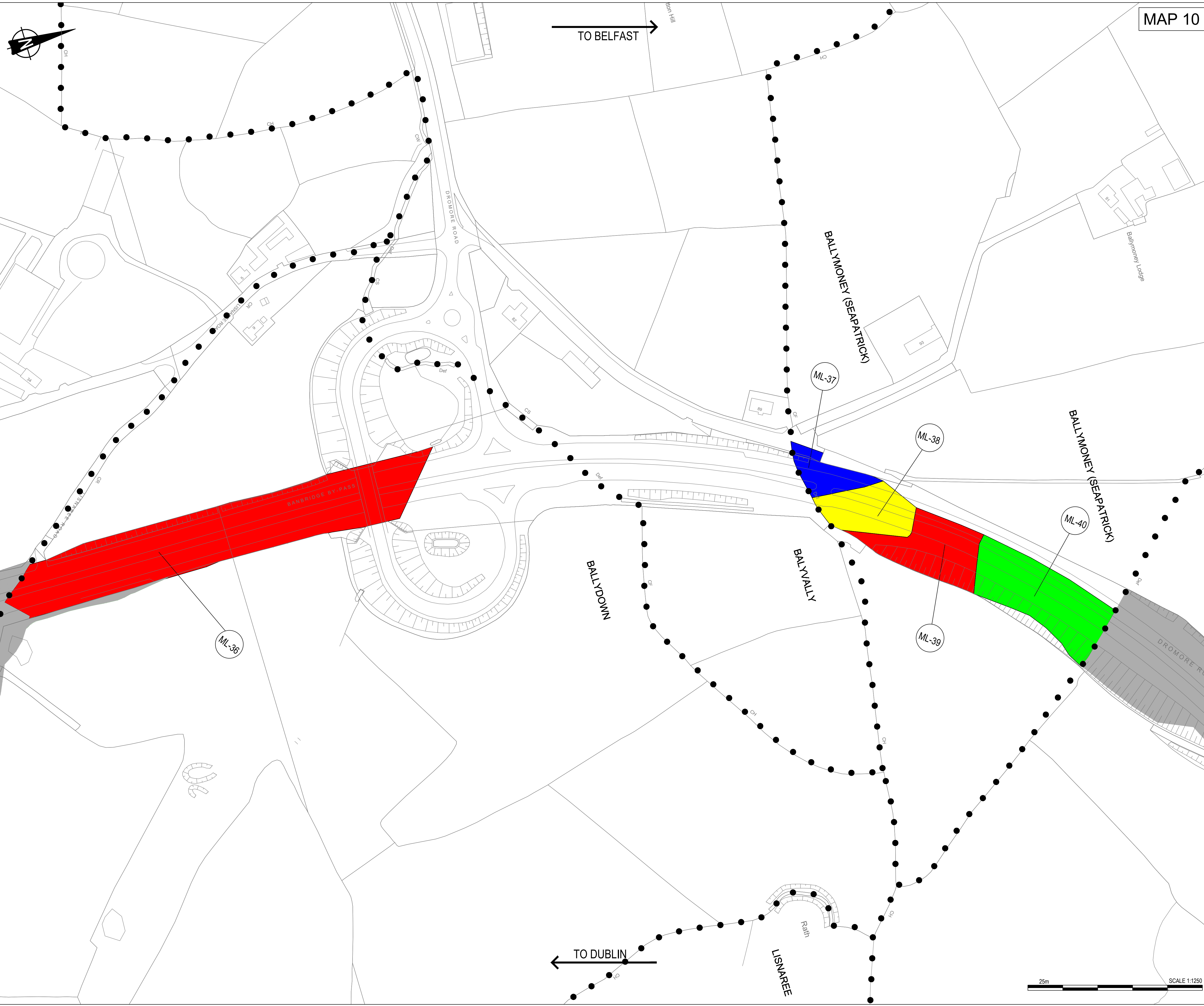

MAP 10

- NOTES**
1. Verifying Dimensions.
The contractor shall verify dimensions against such other drawings or site conditions as pertain to this part of the work.
 2. Existing Services.
Any information concerning the location of existing services indicated on this drawing is intended for general guidance only. It shall be the responsibility of the contractor to determine and verify the exact horizontal and vertical alignment of all cables, pipes, etc. (both underground and overhead) before work commences.
 3. Issue of Drawings.
Hard copies, dwf and pdf will form a controlled issue of the drawing. All other formats (dwg, dxf etc.) are deemed to be an uncontrolled issue and any work carried out based on these files is at the recipient's own risk. RPS will not accept any responsibility for any errors arising from the use of these files, either by human error by the recipient, listing of un-dimensioned measurements, compatibility issues with the recipient's software, and any errors arising when these files are used to aid the recipient's drawing production, or setting out on site.
 4. OS Sheets:
165-13, 165-14, 183-08, 183-12, 183-16, 184-01, 184-02, 184-05, 184-06, 184-09, 184-13, 202-03, 202-04, 202-07, 202-08, 202-10, 202-11, 202-13, 202-14, 202-15, 203-01, 220-08, 220-11, 220-12, 220-15, 220-16, 221-01, 221-02, 221-05, 221-09, 237-03, 237-04
 5. This is based upon Crown Copyright and is reproduced with the permission of Land & Property Services under delegated authority from the Controller of Her Majesty's Stationery Office. © Crown copyright and database right [2018] EMOU [206 2]

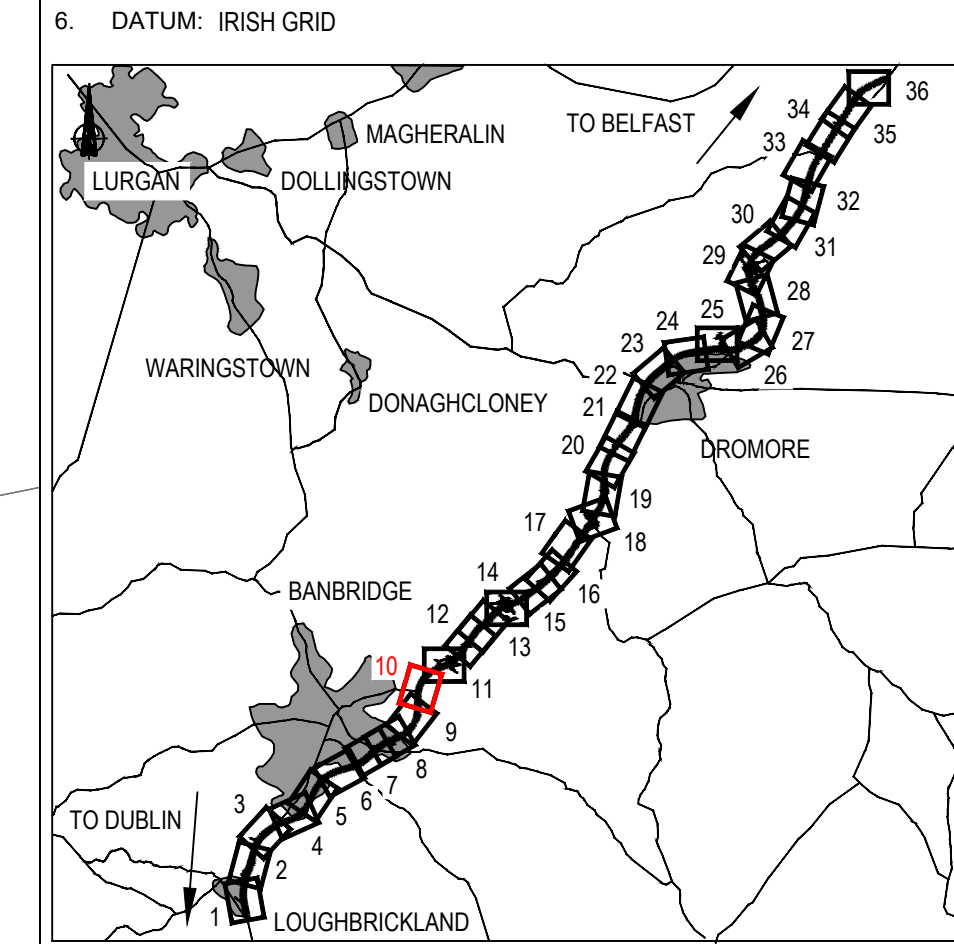

KEY

- Existing OS/ Survey Mapping
- Townland Boundary
- RSC Folio Reference No (X-XX)

Proposed Land Areas Required

- Red, Green, Blue, Yellow

Proposed Land Areas Required - Leasehold

- Diagonal hatching patterns

Easements being affected

- Grid patterns

P3	Cut lines removed	JF	DM	PN	CD	CD	11-Feb-2019
P2	Folios updated in relation to Land Registry review	JF	DM	PN	CD	CD	19-Oct-2018
REV	COMMENT	DRAWN	CH	AP	DATE		

RPS **SWECO**

Elmwood House T +44 (0) 28 90 687914
 74 Boucher Road F +44 (0) 28 90 688286
 Belfast W www.rpsgroup.com/ireland
 BT12 6RZ E ireland@rpsgroup.com

Client: **Department for Infrastructure**
An Roinn
Bonneagair
 www.infrastructure-ni.gov.uk

Project: **A1 Junctions Phase 2**

Title: **Notice of Intention to Make a Vesting Order (NIMVO) Plan - MAP 10**

Drawing Status	Suitability	Project Ref No.		
S2	For Information	IBH0488		
Scale	Designed	Drawn By	Checked	Authorised
1:1250	JF	JF	PN	CD
Original Size	Date	Date	Date	Date
A1	07-06-18	07-06-18	23-08-18	23-08-18
Drawing Number	Rev P3.0			
TNI Ref Originator Volume Location Type Discipline Classification Number				
168014-RPSB-LOV-XX-DR-HE-2600-00010				



- NOTES**
1. Verifying Dimensions.
The contractor shall verify dimensions against such other drawings or site conditions as pertain to this part of the work.
 2. Existing Services.
Any information concerning the location of existing services indicated on this drawing is intended for general guidance only. It shall be the responsibility of the contractor to determine and verify the exact horizontal and vertical alignment of all cables, pipes, etc. (both underground and overhead) before work commences.
 3. Issue of Drawings.
Hard copies, dwf and pdf will form a controlled issue of the drawing. All other formats (dwg, dxf etc.) are deemed to be an uncontrolled issue and any work carried out based on these files is at the recipient's own risk. RPS will not accept any responsibility for any errors arising from the use of these files, either by human error by the recipient, listing of un-dimensioned measurements, compatibility issues with the recipient's software, and any errors arising when these files are used to aid the recipient's drawing production, or setting out on site.
 4. OS Sheets:
165-13, 165-14, 183-08, 183-12, 183-16, 184-01, 184-02, 184-05, 184-06, 184-09, 184-13, 202-03, 202-04, 202-07, 202-08, 202-10, 202-11, 202-13, 202-14, 202-15, 203-01, 220-08, 220-11, 220-12, 220-15, 220-16, 221-01, 221-02, 221-05, 221-09, 237-03, 237-04
 5. This is based upon Crown Copyright and is reproduced with the permission of Land & Property Services under delegated authority from the Controller of Her Majesty's Stationery Office, © Crown copyright and database right [2018] EMOU [206.2]
 6. DATUM: IRISH GRID

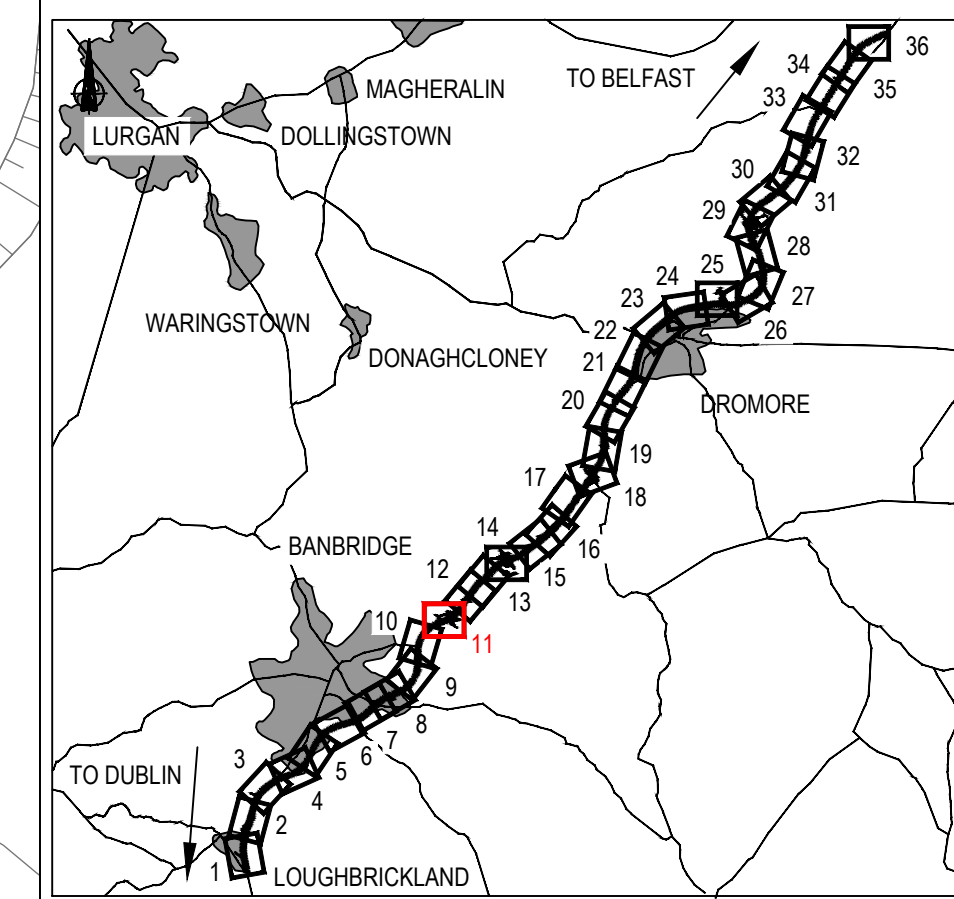

KEY

- Existing OS / Survey Mapping
- Townland Boundary
- RSC Folio Reference No (X-XX)

Proposed Land Areas Required

- Red: Proposed Land Areas Required
- Green: Proposed Land Areas Required
- Blue: Proposed Land Areas Required
- Yellow: Proposed Land Areas Required
- Magenta: Proposed Land Areas Required - Leasehold
- Brown: Proposed Land Areas Required - Leasehold
- Purple: Proposed Land Areas Required - Leasehold

Proposed Land Areas Required - Leasehold

- Diagonal lines: Proposed Land Areas Required - Leasehold
- Horizontal lines: Proposed Land Areas Required - Leasehold
- Vertical lines: Proposed Land Areas Required - Leasehold

Easements being affected

- Grid pattern: Easements being affected
- Dashed line: Easements being affected

P3	Cut lines removed	JF	PN	CD	11-Feb-2019
P2	Folios updated in relation to Land Registry review	DMI	PN	CD	23-Oct-2018
REV	COMMENT	DRAWN	CH	AP	DATE

RPS **SWECO**

Elmwood House T +44 (0) 28 90 667914
 74 Boucher Road F +44 (0) 28 90 668286
 Belfast W www.rpsgroup.com/ireland
 BT12 6RZ E ireland@rpsgroup.com

Client: **Department for Infrastructure**
Bonneagair
 www.infrastructure-ri.gov.uk

Project: **A1 Junctions Phase 2**

Title: **Notice of Intention to Make a Vesting Order (NIMVO) Plan - MAP 11**

Drawing Status	Suitability	Project Ref No.		
S2	For Information	IBH0488		
Scale	Designed	Drawn By	Checked	Authorised
1:1250	JF	JF	PN	CD
Original Size	Date	Date	Date	Date
A1	07-06-18	07-06-18	23-08-18	23-08-18
Drawing Number	Rev P3.0			
TNI Ref Originator Volume Location Type Discipline Classification Number				
168014-RPSB-LOV-XX-DR-HE-2600-00011				

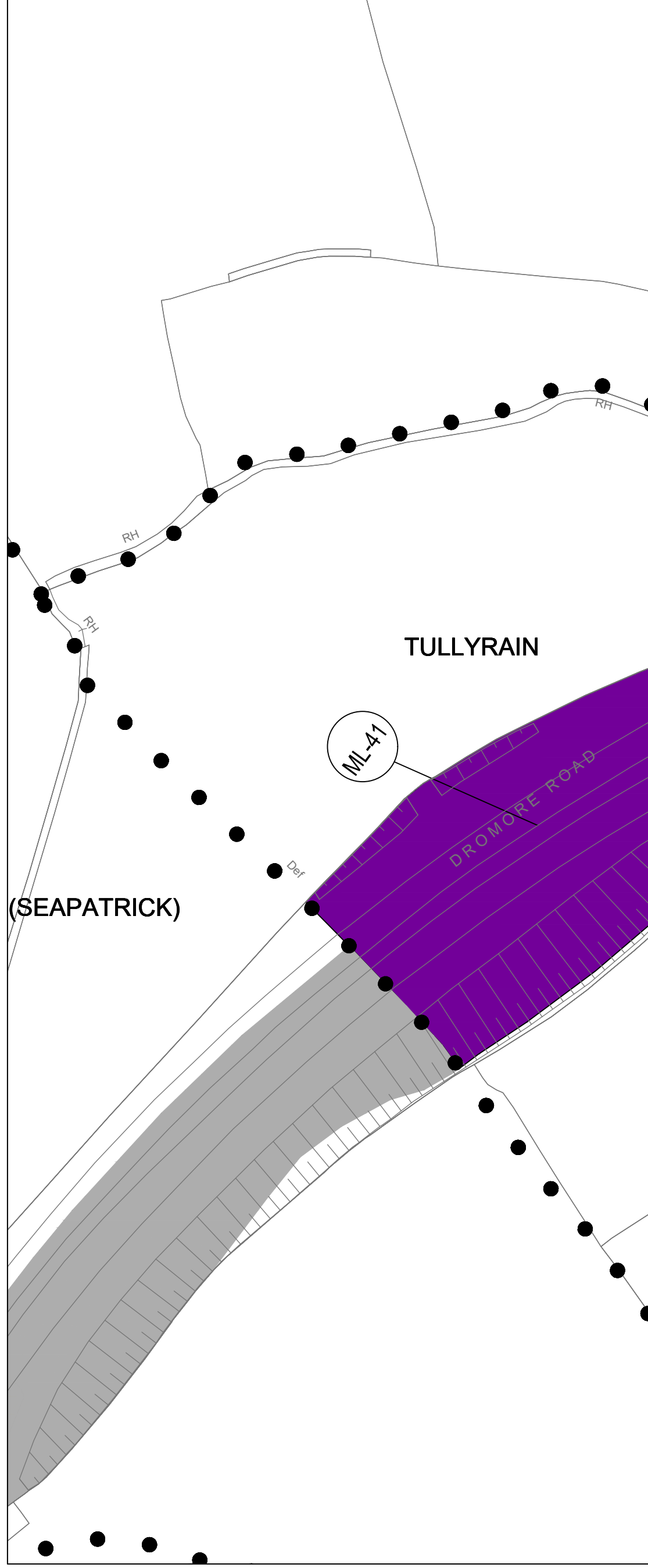
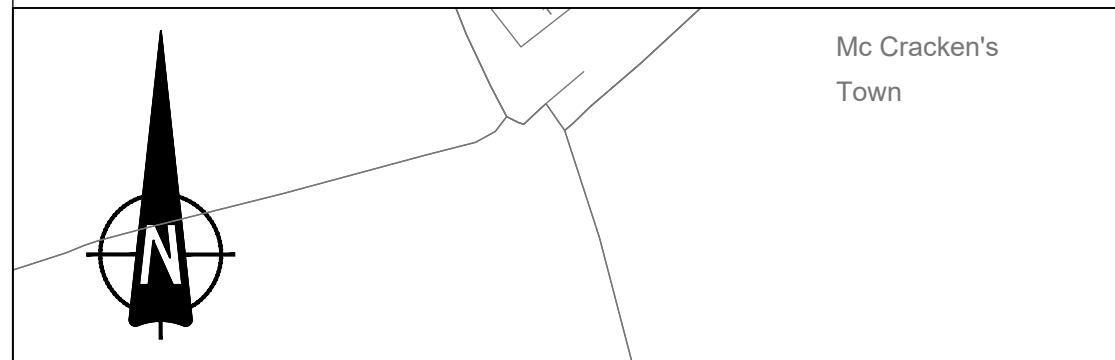
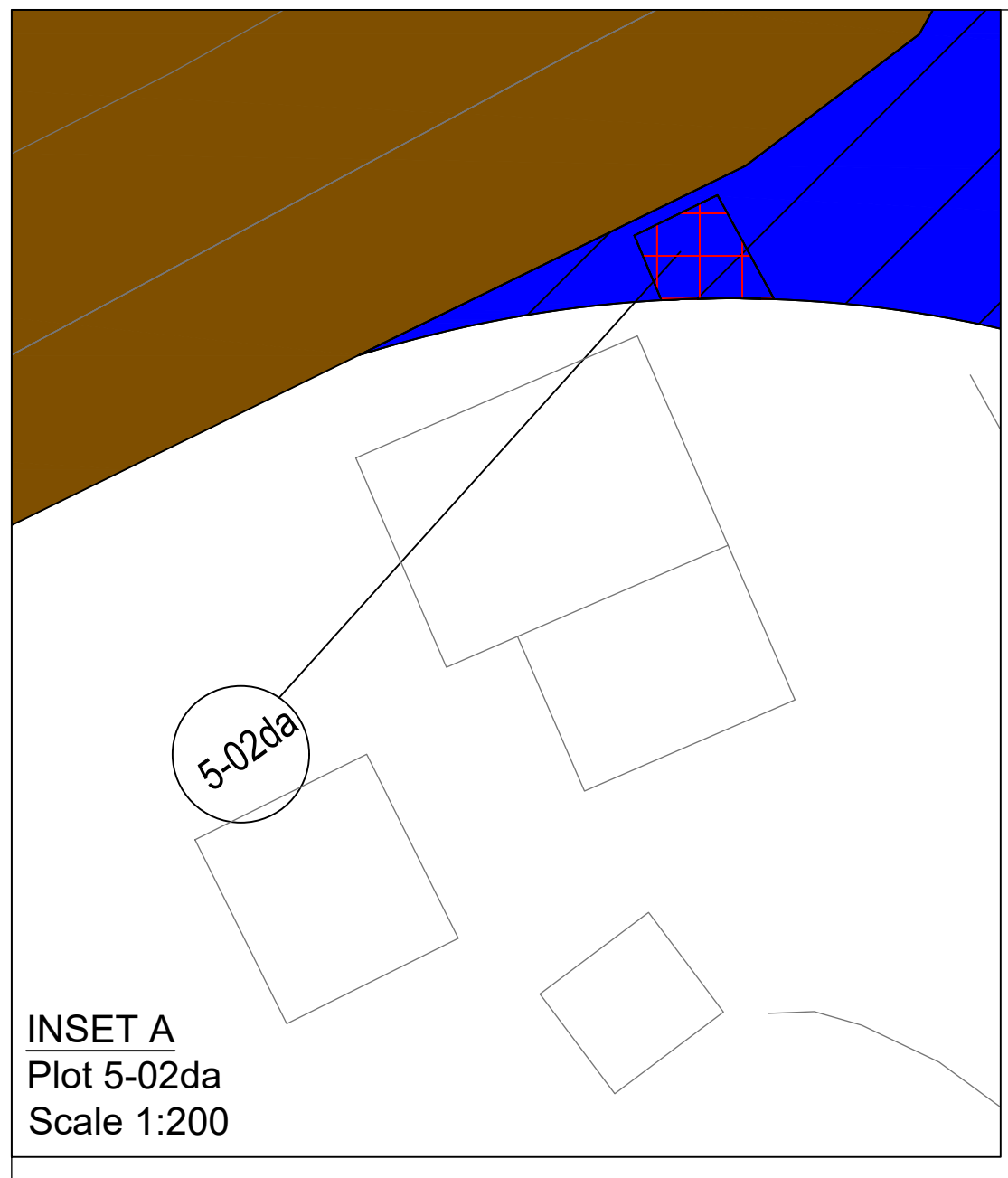
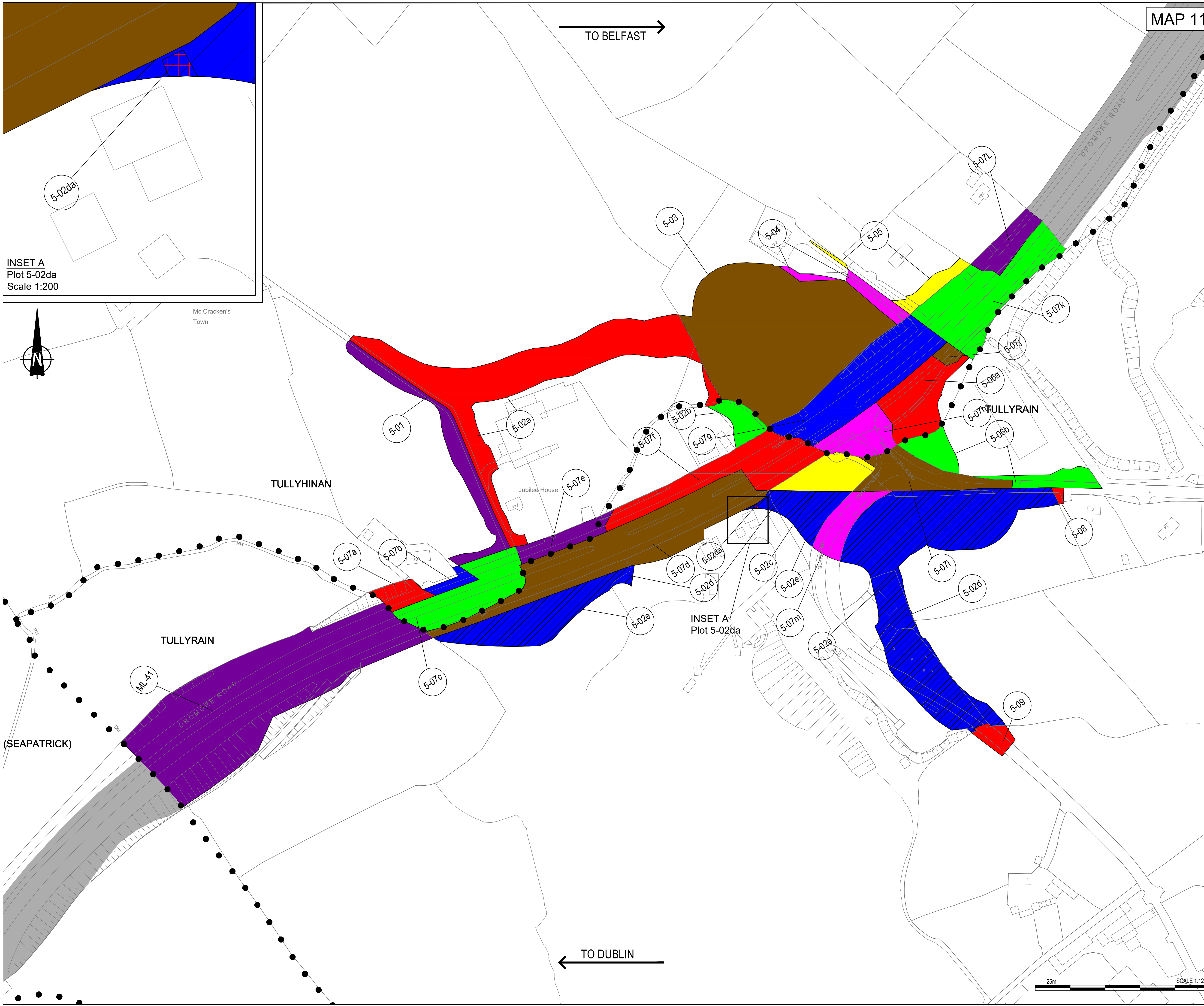

- NOTES**
1. Verifying Dimensions.
The contractor shall verify dimensions against such other drawings or site conditions as pertain to this part of the work.
 2. Existing Services.
Any information concerning the location of existing services indicated on this drawing is intended for general guidance only. It shall be the responsibility of the contractor to determine and verify the exact horizontal and vertical alignment of all cables, pipes, etc. (both underground and overhead) before work commences.
 3. Issue of Drawings.
Hard copies, dwf and pdf will form a controlled issue of the drawing. All other formats (dwg, dxf etc.) are deemed to be an uncontrolled issue and any work carried out based on these files is at the recipient's own risk. RPS will not accept any responsibility for any errors arising from the use of these files, either by human error by the recipient, listing of un-dimensioned measurements, compatibility issues with the recipient's software, and any errors arising when these files are used to aid the recipient's drawing production, or setting out on site.
 4. OS Sheets:
165-13, 165-14, 183-08, 183-12, 183-16, 184-01, 184-02, 184-05, 184-06, 184-09, 184-13, 202-03, 202-04, 202-07, 202-08, 202-10, 202-11, 202-13, 202-14, 202-15, 203-01, 220-08, 220-11, 220-12, 220-15, 220-16, 221-01, 221-02, 221-05, 221-09, 237-03, 237-04
 5. This is based upon Crown Copyright and is reproduced with the permission of Land & Property Services under delegated authority from the Controller of Her Majesty's Stationery Office, © Crown copyright and database right [2018] EMOU [206 2]
 6. DATUM: IRISH GRID

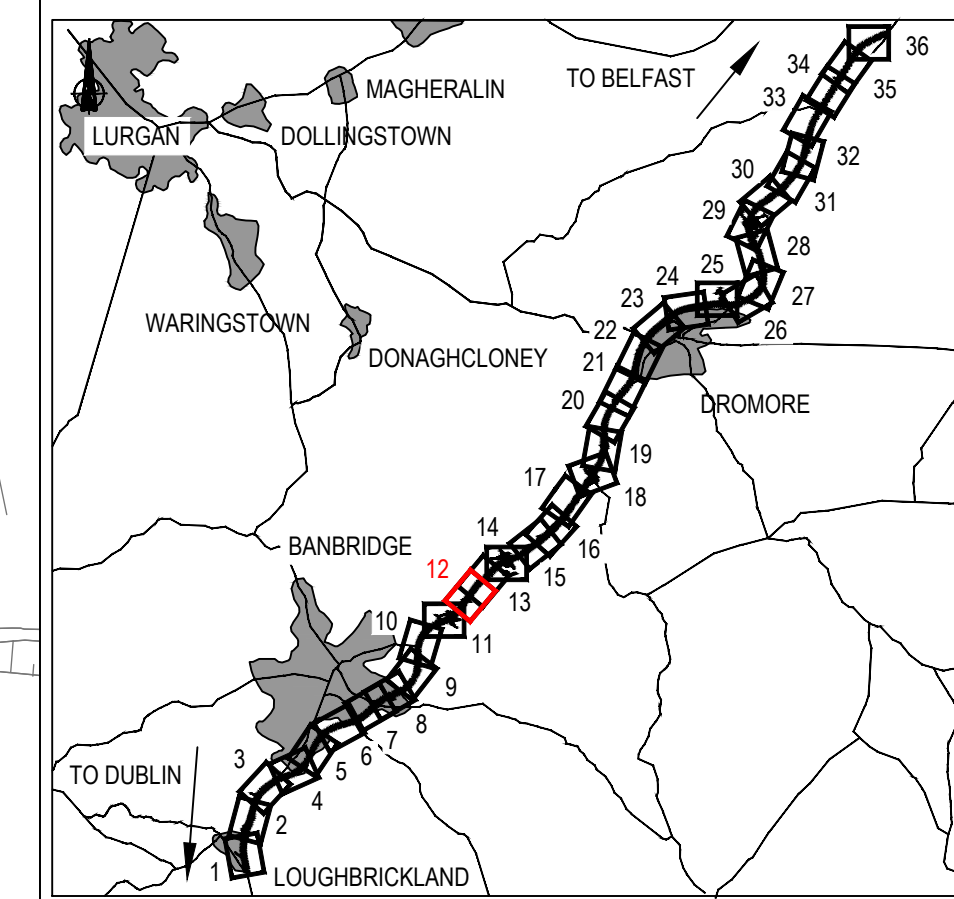

KEY

- Existing OS/ Survey Mapping
- Townland Boundary
- RSC Folio Reference No (X-XX)

Proposed Land Areas Required

- Red: Proposed Land Areas Required - Leasehold
- Green: Proposed Land Areas Required
- Blue: Proposed Land Areas Required
- Magenta: Proposed Land Areas Required
- Brown: Proposed Land Areas Required
- Purple: Proposed Land Areas Required

Easements being affected

- Red hatched: Easements being affected
- Blue hatched: Easements being affected
- Green dashed: Easements being affected

P4	Cut lines removed	JF	PN	CD	11-Feb-2019
P3	Folios updated in relation to Land Registry review	JF	PN	CD	09-Nov-2018
P2	Folios updated in relation to Land Registry review	DM	PN	CD	19-Oct-2018

REV	COMMENT	DRAWN	CH	AP	DATE

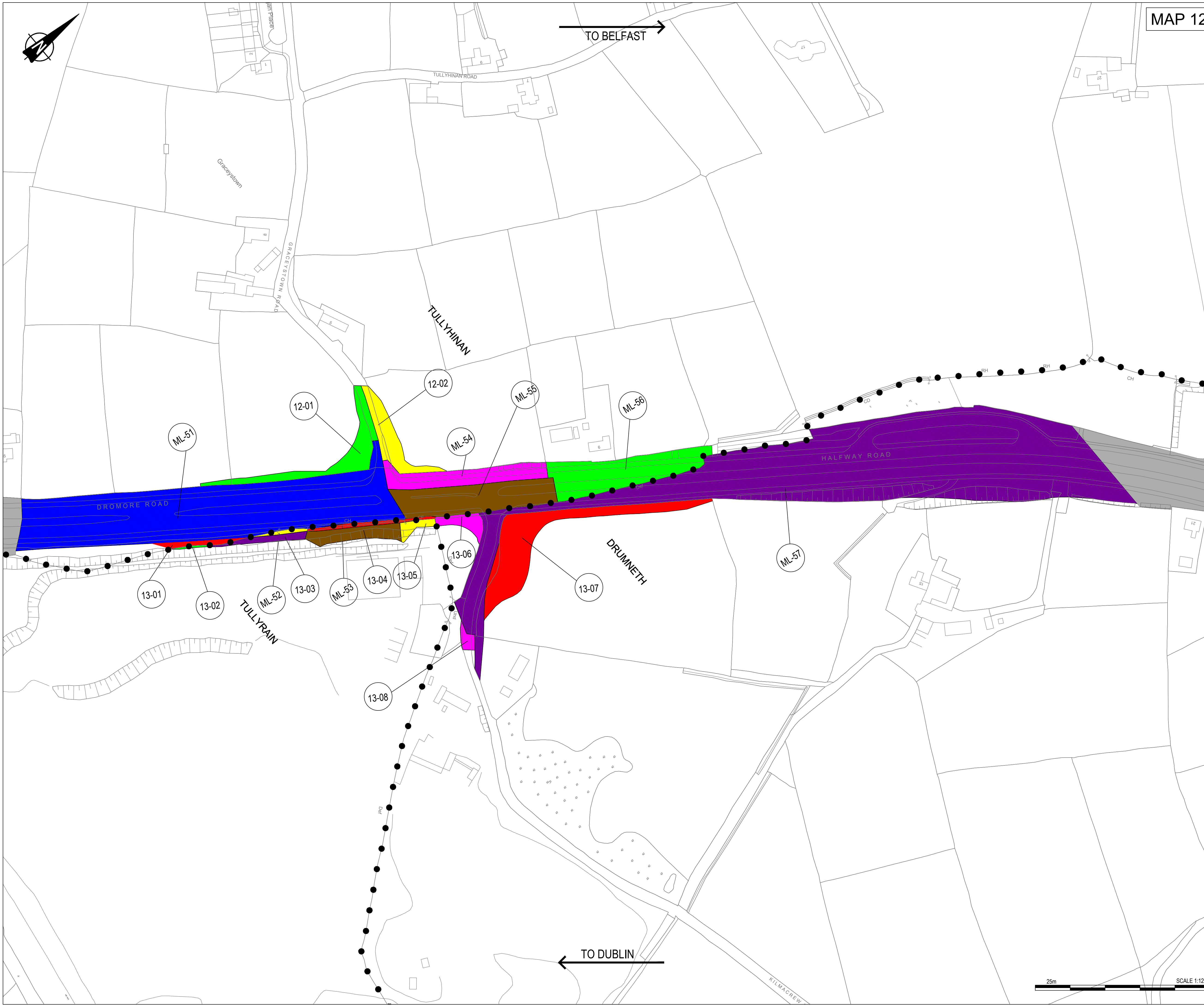

RPS **SWECO**

Elmwood House T +44 (0) 28 90 667914
 74 Boucher Road F +44 (0) 28 90 668286
 Belfast W www.rpsgroup.com/ireland
 BT12 6RZ E ireland@rpsgroup.com

Client

Department for Infrastructure
 An Roinn
Bonneagair
 www.infrastructure-ri.gov.uk

Project

A1 Junctions Phase 2

Title

Notice of Intention to Make a Vesting Order (NIMVO) Plan - MAP 12

Drawing Status	Suitability	Project Ref No.		
S2	For Information	IBH0488		
Scale	Designed	Drawn By	Checked	Authorised
1:1250	JF	JF	PN	CD
Original Size	Date	Date	Date	Date
A1	07-06-18	07-06-18	23-08-18	23-08-18
Drawing Number	Rev P4.0			
TNI Ref Originator Volume Location Type Discipline Classification Number				
168014-RPSB-LOV-XX-DR-HE-2600-00012				