

NIMVO Maps 13 to 24
Please click on map windows to
view plans

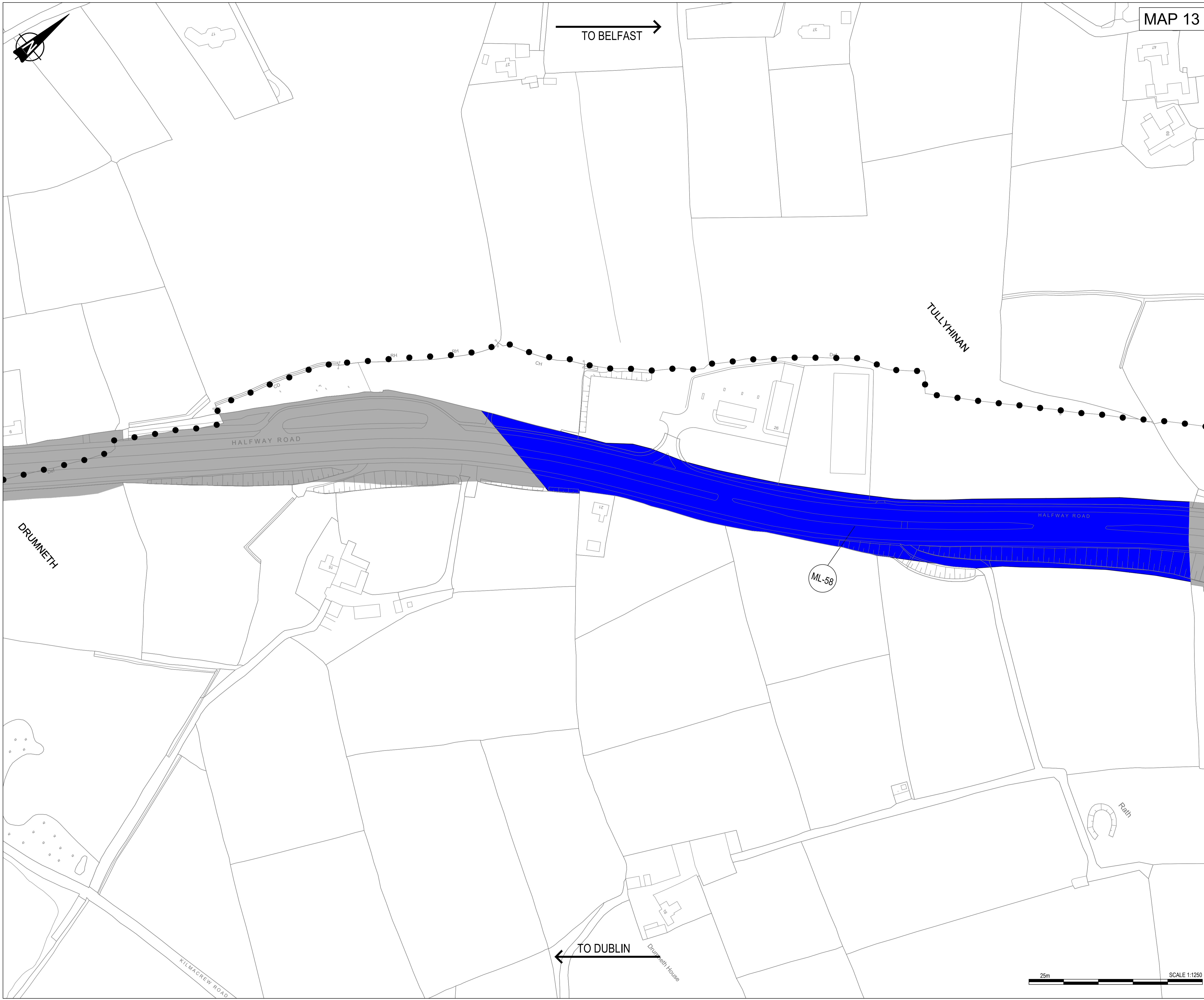

A1 Junctions
Phase 2



MAP 13

- NOTES**
1. Verifying Dimensions.
The contractor shall verify dimensions against such other drawings or site conditions as pertain to this part of the work.
 2. Existing Services.
Any information concerning the location of existing services indicated on this drawing is intended for general guidance only. It shall be the responsibility of the contractor to determine and verify the exact horizontal and vertical alignment of all cables, pipes, etc. (both underground and overhead) before work commences.
 3. Issue of Drawings.
Hard copies, dwf and pdf will form a controlled issue of the drawing. All other formats (dwg, dxf etc.) are deemed to be an uncontrolled issue and any work carried out based on these files is at the recipient's own risk. RPS will not accept any responsibility for any errors arising from the use of these files, either by human error or the recipient, listing of un-dimensioned measurements, compatibility issues with the recipient's software, and any errors arising when these files are used to aid the recipient's drawing production, or setting out on site.
 4. OS Sheets:
165-13, 165-14, 183-08, 183-12, 183-16, 184-01, 184-02, 184-05, 184-06, 184-09, 184-13, 202-03, 202-04, 202-07, 202-08, 202-10, 202-11, 202-13, 202-14, 202-15, 203-01, 220-08, 220-11, 220-12, 220-15, 220-16, 221-01, 221-02, 221-05, 221-09, 237-03, 237-04
 5. This is based upon Crown Copyright and is reproduced with the permission of Land & Property Services under delegated authority from the Controller of Her Majesty's Stationery Office, © Crown copyright and database right [2018] EMOU [206.2]

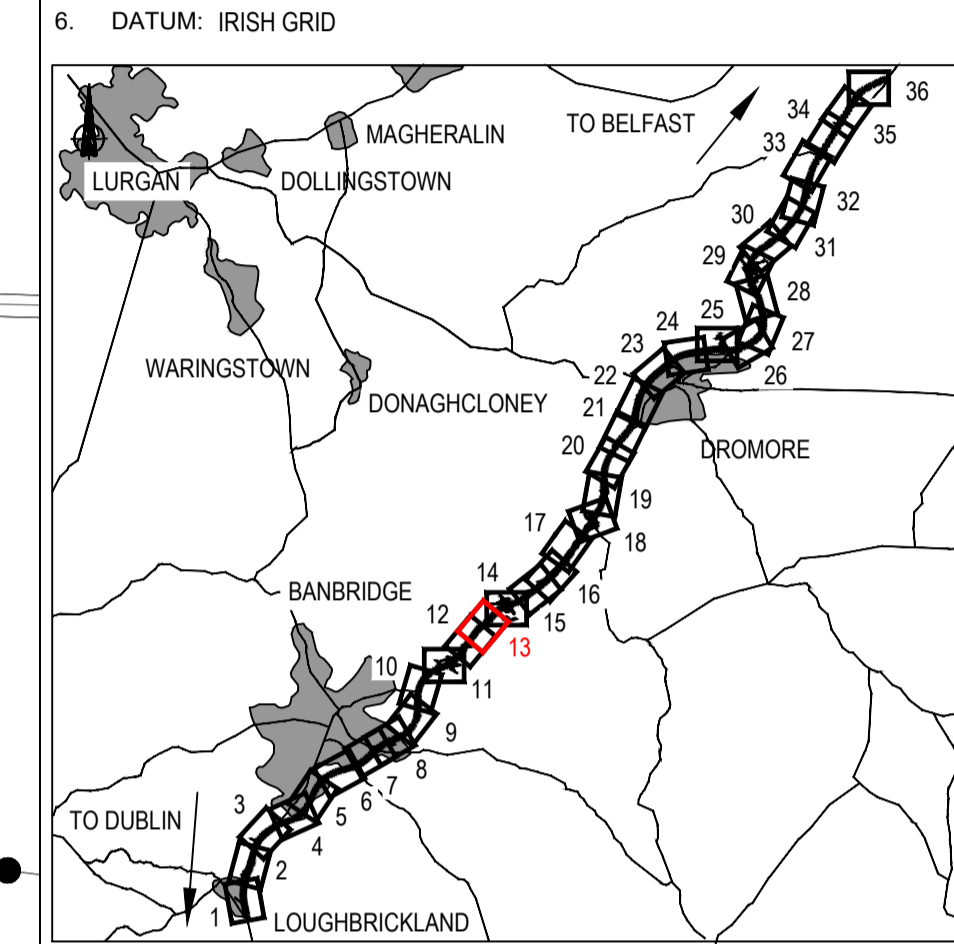

KEY

- Existing OS/ Survey Mapping
- Townland Boundary
- RSC Folio Reference No (X-XX)

Proposed Land Areas Required

- Red, Green, Blue, Yellow, Purple, Brown, Pink

Proposed Land Areas Required - Leasehold

- Hatched patterns

Easements being affected

- Blue grid, Green dashed line

P3	Cut lines removed	JF	PN	CD	11-Feb-2019
P2	Folios updated in relation to Land Registry review	DM	PN	CD	19-Oct-2018
REV	COMMENT	DRAWN	CH	AP	DATE

RPS **SWECO**

Elmwood House T +44 (0) 28 90 687914
 74 Boucher Road F +44 (0) 28 90 688286
 Belfast W www.rpsgroup.com/ireland
 BT12 6RZ E ireland@rpsgroup.com

Client
 Department for Infrastructure
 An Roinn
Bonneagair
 www.infrastructure-ni.gov.uk

Project
A1 Junctions Phase 2

Title
 Notice of Intention to Make a Vesting Order (NIMVO) Plan - MAP 13

Drawing Status	Suitability	Project Ref No.			
S2	For Information	IBH0488			
Scale	Designed	Drawn By	Checked	Authorised	
1:1250	JF	JF	PN	CD	
Original Size	Date	Date	Date	Date	
A1	07-06-18	07-06-18	23-08-18	23-08-18	
Drawing Number	Rev				
	P3.0				
TNI Ref Originator Volume Location Type Discipline Classification Number					
168014-RPSB-LOV-XX-DR-HE-2600-00013					

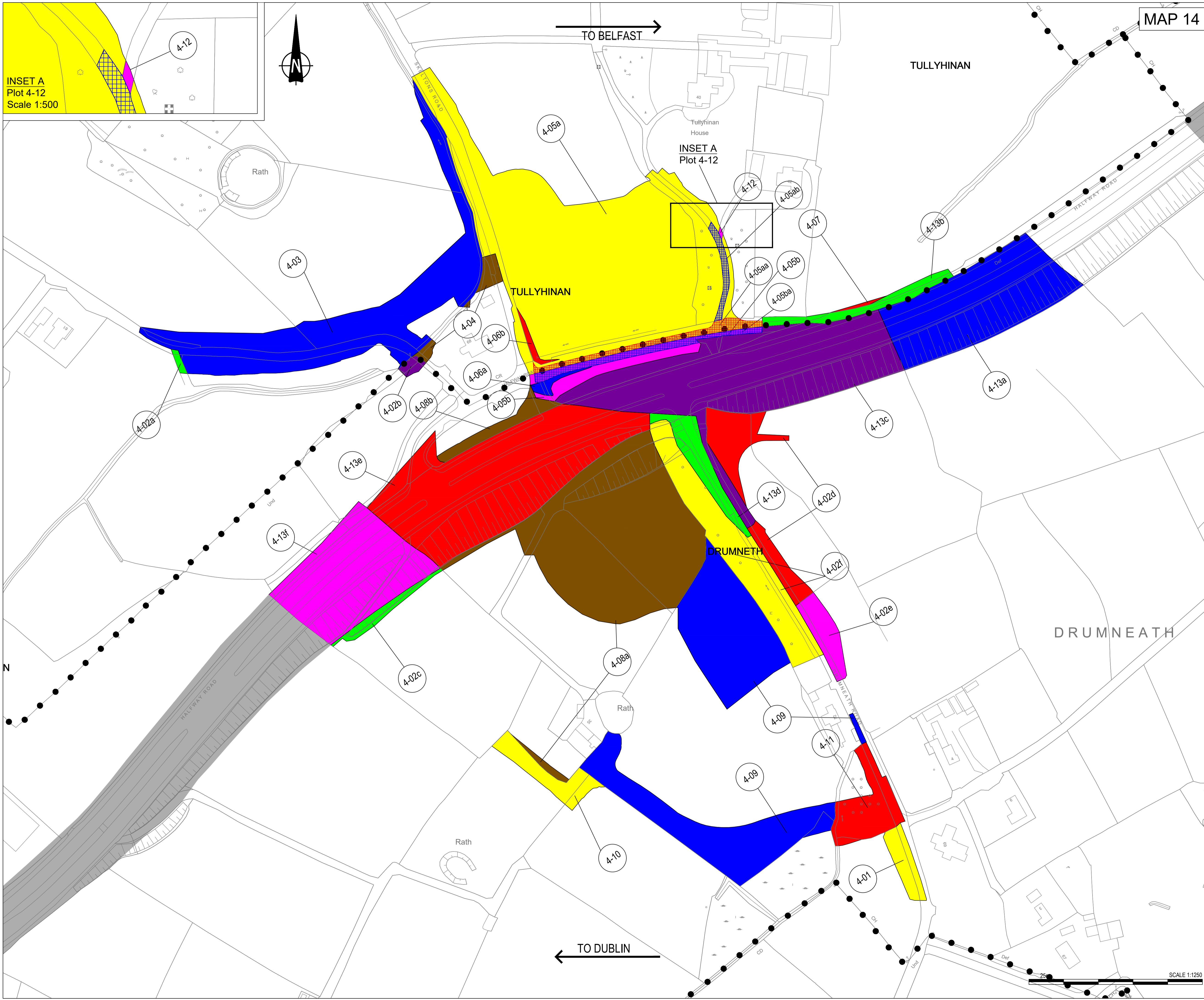

INSET A
Plot 4-12
Scale 1:500

INSET A
Plot 4-12

MAP 14

- NOTES**
1. Verifying Dimensions.
The contractor shall verify dimensions against such other drawings or site conditions as pertain to this part of the work.
 2. Existing Services.
Any information concerning the location of existing services indicated on this drawing is intended for general guidance only. It shall be the responsibility of the contractor to determine and verify the exact horizontal and vertical alignment of all cables, pipes, etc. (both underground and overhead) before work commences.
 3. Issue of Drawings.
Hard copies, dwf and pdf will form a controlled issue of the drawing. All other formats (dwg, dxf etc.) are deemed to be an uncontrolled issue and any work carried out based on these files is at the recipient's own risk. RPS will not accept any responsibility for any errors arising from the use of these files, either by human error by the recipient, listing of un-dimensioned measurements, compatibility issues with the recipient's software, and any errors arising when these files are used to aid the recipient's drawing production, or setting out on site.
 4. OS Sheets:
165-13, 165-14, 183-08, 183-12, 183-16, 184-01, 184-02, 184-05, 184-06, 184-09, 184-13, 202-03, 202-04, 202-07, 202-08, 202-10, 202-11, 202-13, 202-14, 202-15, 203-01, 220-08, 220-11, 220-12, 220-15, 220-16, 221-01, 221-02, 221-05, 221-09, 237-03, 237-04
 5. This is based upon Crown Copyright and is reproduced with the permission of Land & Property Services under delegated authority from the Controller of Her Majesty's Stationery Office. © Crown copyright and database right [2018] EMOU [206.2]
 6. DATUM: IRISH GRID

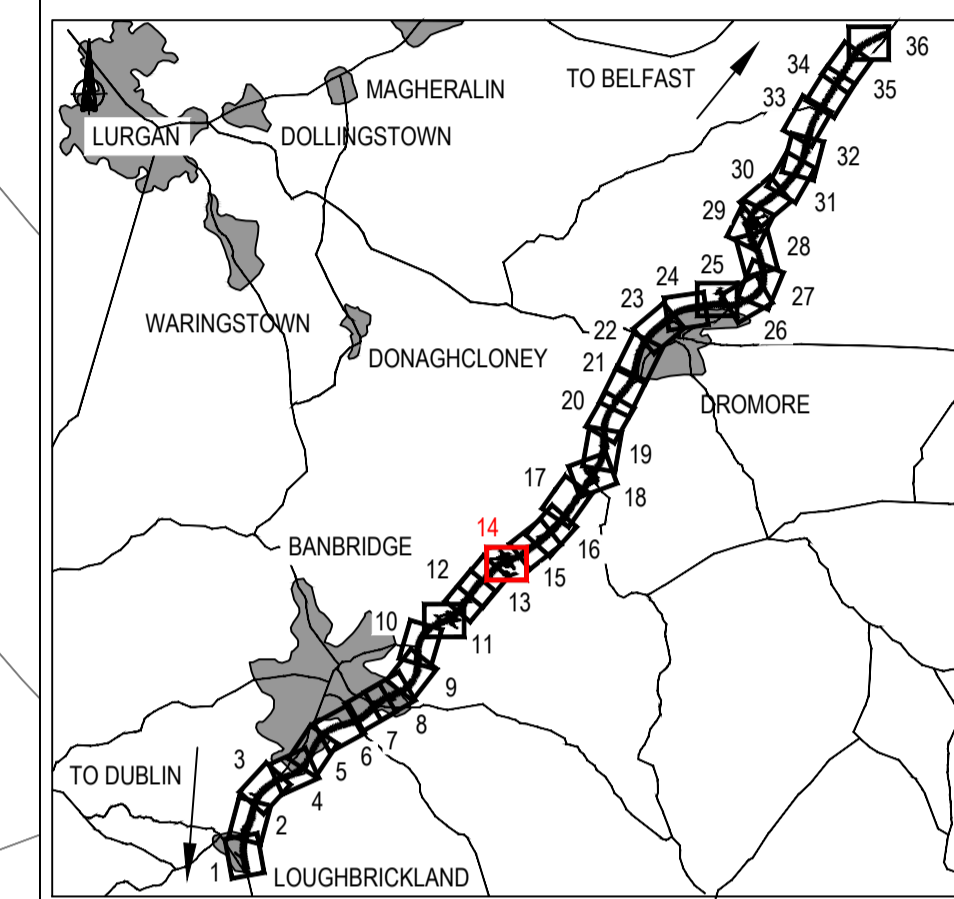

KEY

- Existing OS/ Survey Mapping
- Townland Boundary
- RSC Folio Reference No (X-XX)

Proposed Land Areas Required

- Red, Green, Blue, Yellow, Purple, Brown, Pink

Proposed Land Areas Required - Leasehold

- Diagonal hatching patterns

Easements being affected

- Blue dashed lines, Green dashed lines

P3	Cut lines removed	JF	PN	CD	11-Feb-2019
P2	Folio updated in relation to Land Registry review	JF	PN	CD	02-Nov-2018
REV	COMMENT	DRAWN	CH	AP	DATE

RPS **SWECO**

Elmwood House T +44 (0) 28 90 667914
74 Boucher Road F +44 (0) 28 90 668286
Belfast W www.rpsgroup.com/ireland
BT12 6RZ E ireland@rpsgroup.com

Client: Department for Infrastructure
Bonneagair
www.infrastructure-ri.gov.uk

Project: **A1 Junctions Phase 2**

Title: Notice of Intention to Make a Vesting Order (NIMVO) Plan - MAP 14

Drawing Status	Suitability	Project Ref No.		
S2	For Information	IBH0488		
Scale	Designed	Drawn By	Checked	Authorised
1:1250	JF	JF	PN	CD
Original Size	Date	Date	Date	Date
A1	07-06-18	07-06-18	23-08-18	23-08-18
Drawing Number	Rev P3.0			
TNI Ref Originator Volume Location Type Discipline Classification Number				
168014-RPSB-LOV-XX-DR-HE-2600-00014				

- NOTES**
1. Verifying Dimensions.
The contractor shall verify dimensions against such other drawings or site conditions as pertain to this part of the work.
 2. Existing Services.
Any information concerning the location of existing services indicated on this drawing is intended for general guidance only. It shall be the responsibility of the contractor to determine and verify the exact horizontal and vertical alignment of all cables, pipes, etc. (both underground and overhead) before work commences.
 3. Issue of Drawings.
Hard copies, dwf and pdf will form a controlled issue of the drawing. All other formats (dwg, dxf etc.) are deemed to be an uncontrolled issue and any work carried out based on these files is at the recipient's own risk. RPS will not accept any responsibility for any errors arising from the use of these files, either by human error by the recipient, listing of un-dimensioned measurements, compatibility issues with the recipient's software, and any errors arising when these files are used to aid the recipient's drawing production, or setting out on site.
 4. OS Sheets:
165-13, 165-14, 183-08, 183-12, 183-16, 184-01, 184-02, 184-05, 184-06, 184-09, 184-13, 202-03, 202-04, 202-07, 202-08, 202-10, 202-11, 202-13, 202-14, 202-15, 203-01, 220-08, 220-11, 220-12, 220-15, 220-16, 221-01, 221-02, 221-05, 221-09, 237-03, 237-04
 5. This is based upon Crown Copyright and is reproduced with the permission of Land & Property Services under delegated authority from the Controller of Her Majesty's Stationery Office, © Crown copyright and database right [2018] EMOU [206.2]
 6. DATUM: IRISH GRID

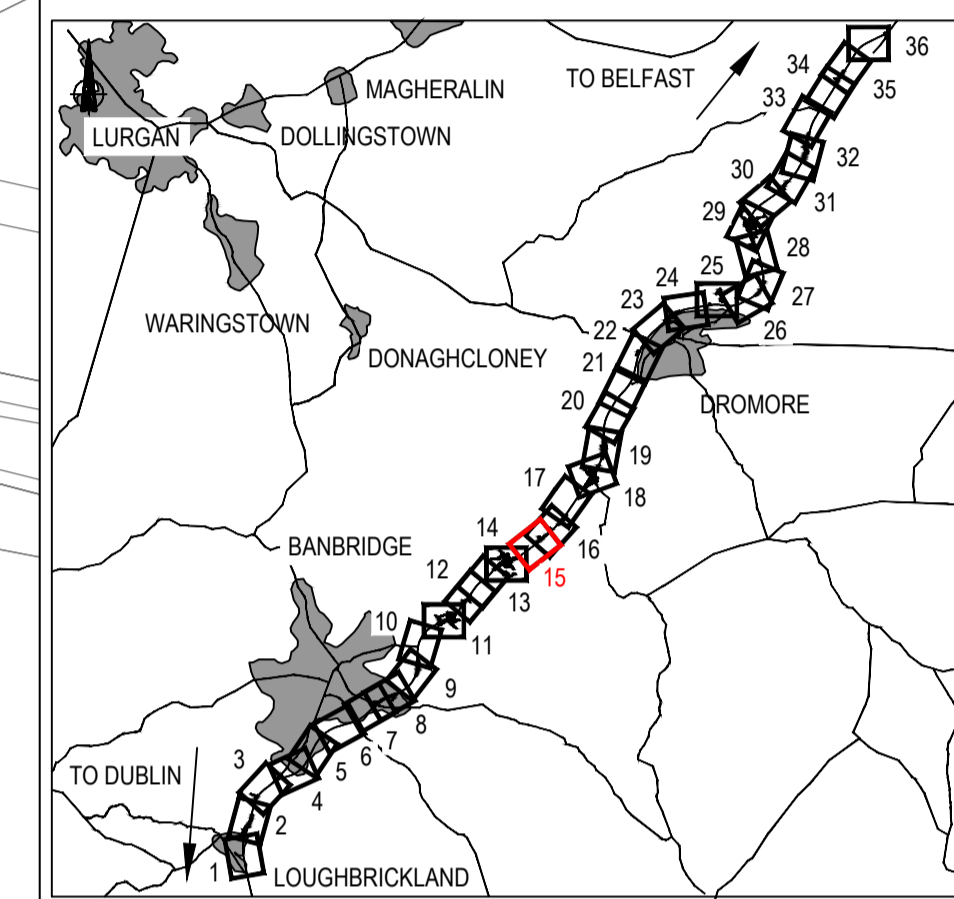

KEY

- Existing OS / Survey Mapping
- Townland Boundary
- X-XX RSC Folio Reference No

Proposed Land Areas Required

- Red, Green, Blue, Yellow
- Magenta, Brown, Purple

Proposed Land Areas Required - Leasehold

- Diagonal hatching patterns

Easements being affected

- Grid hatching patterns

P3	Drawings updated following comments from DfI	JF	PN	CD	07-Feb-2019
P2	Folios updated in relation to Land Registry review	JF	PN	CD	02-Nov-2018
REV	COMMENT	DRAWN	CH	AP	DATE

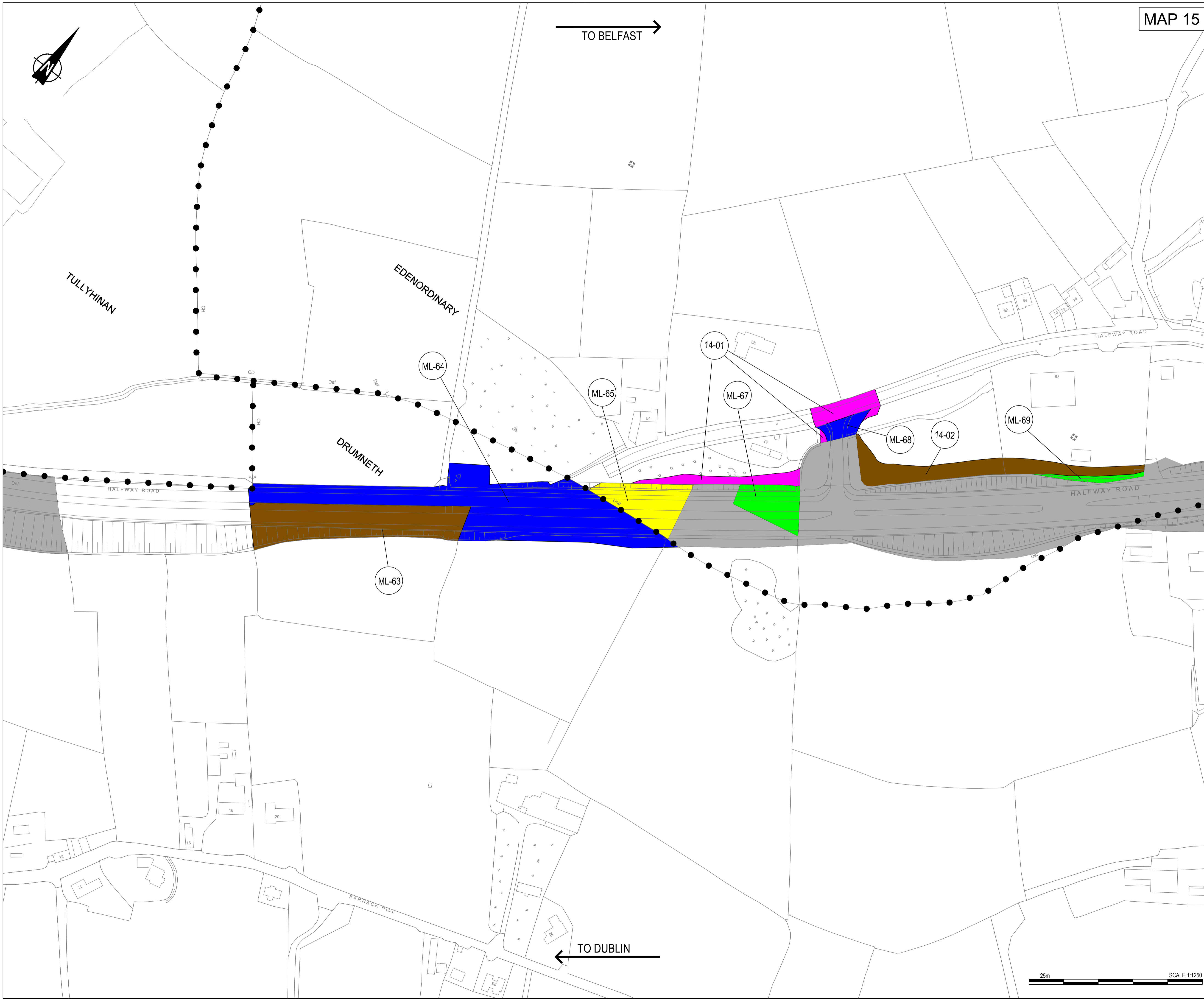

RPS **SWECO**

Elmwood House T +44 (0) 28 90 667914
 74 Boucher Road F +44 (0) 28 90 668286
 Belfast W www.rpsgroup.com/ireland
 BT12 6RZ E ireland@rpsgroup.com

Client

 Department for Infrastructure
 An Roinn
 Bonneagair
 www.infrastructure.ie.gov.uk

Project

 A1 Junctions
 Phase 2

Title
 Notice of Intention to Make a Vesting Order (NIMVO) Plan - MAP 15

Drawing Status	Suitability	Project Ref No.		
S2	For Information	IBH0488		
Scale	Designed	Drawn By	Checked	Authorised
1:1250	JF	JF	PN	CD
Original Size	Date	Date	Date	Date
A1	07-06-18	07-06-18	23-08-18	23-08-18
Drawing Number	Rev P3.0			
TNI Ref Originator Volume Location Type Discipline Classification Number				
168014-RPSB-LOV-XX-DR-HE-2600-00015				

- NOTES**
1. Verifying Dimensions.
The contractor shall verify dimensions against such other drawings or site conditions as pertain to this part of the work.
 2. Existing Services.
Any information concerning the location of existing services indicated on this drawing is intended for general guidance only. It shall be the responsibility of the contractor to determine and verify the exact horizontal and vertical alignment of all cables, pipes, etc. (both underground and overhead) before work commences.
 3. Issue of Drawings.
Hard copies, dwf and pdf will form a controlled issue of the drawing. All other formats (dwg, dxf etc.) are deemed to be an uncontrolled issue and any work carried out based on these files is at the recipient's own risk. RPS will not accept any responsibility for any errors arising from the use of these files, either by human error by the recipient, listing of un-dimensioned measurements, compatibility issues with the recipient's software, and any errors arising when these files are used to aid the recipient's drawing production, or setting out on site.
 4. OS Sheets:
165-13, 165-14, 183-08, 183-12, 183-16, 184-01, 184-02, 184-05, 184-06, 184-09, 184-13, 202-03, 202-04, 202-07, 202-08, 202-10, 202-11, 202-13, 202-14, 202-15, 203-01, 220-08, 220-11, 220-12, 220-15, 220-16, 221-01, 221-02, 221-05, 221-09, 237-03, 237-04
 5. This is based upon Crown Copyright and is reproduced with the permission of Land & Property Services under delegated authority from the Controller of Her Majesty's Stationery Office, © Crown copyright and database right [2018] EMOU [206.2]
 6. DATUM: IRISH GRID

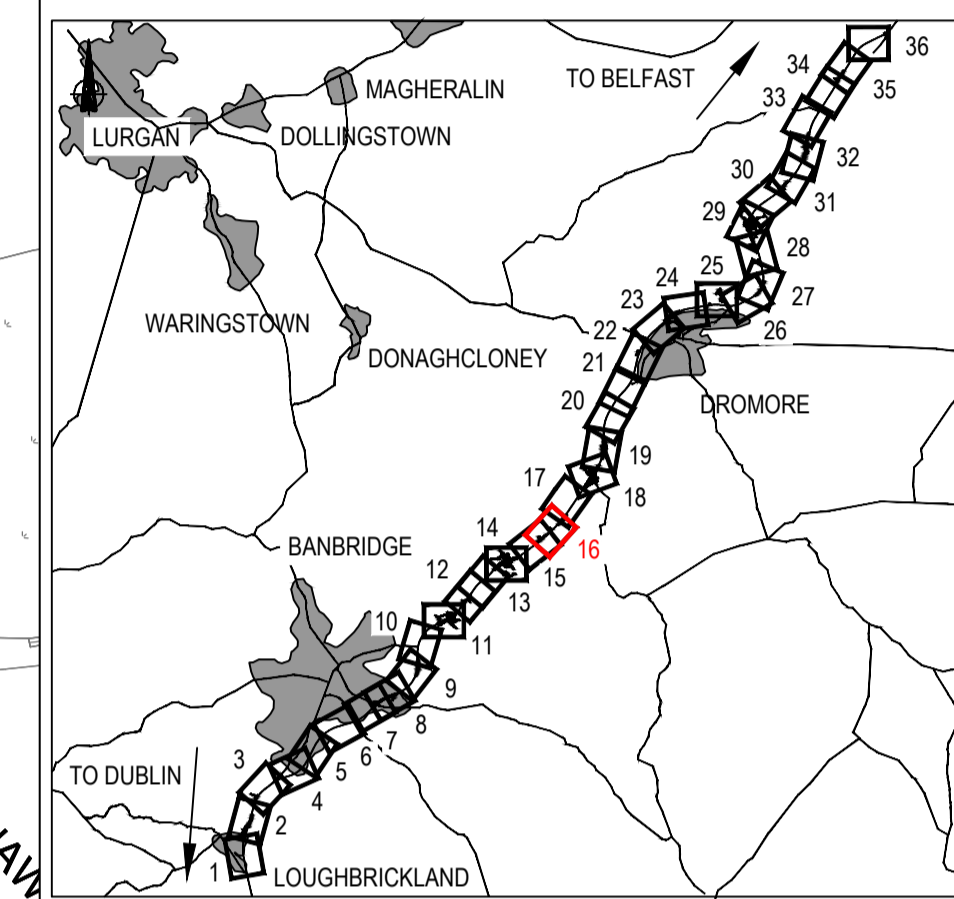

KEY

- Existing OS / Survey Mapping
- Townland Boundary
- RSC Folio Reference No (X-XX)

Proposed Land Areas Required

- Red: Proposed Land Areas Required
- Green: Proposed Land Areas Required
- Blue: Proposed Land Areas Required
- Magenta: Proposed Land Areas Required
- Brown: Proposed Land Areas Required
- Purple: Proposed Land Areas Required

Proposed Land Areas Required - Leasehold

- Red with diagonal lines: Proposed Land Areas Required - Leasehold
- Magenta with diagonal lines: Proposed Land Areas Required - Leasehold

Easements being affected

- Red with grid pattern: Easements being affected
- Blue with grid pattern: Easements being affected
- Green with grid pattern: Easements being affected
- Purple with grid pattern: Easements being affected

P4	Drawing updated following comments from DfI	JF	PN	CD	21-Feb-2019
P3	Drawings updated following comments from DfI	JF	PN	CD	07-Feb-2019
P2	Folio updated in relation to Land Registry review	JF	PN	CD	02-Nov-2018
REV	COMMENT	DRAWN	CH	AP	DATE

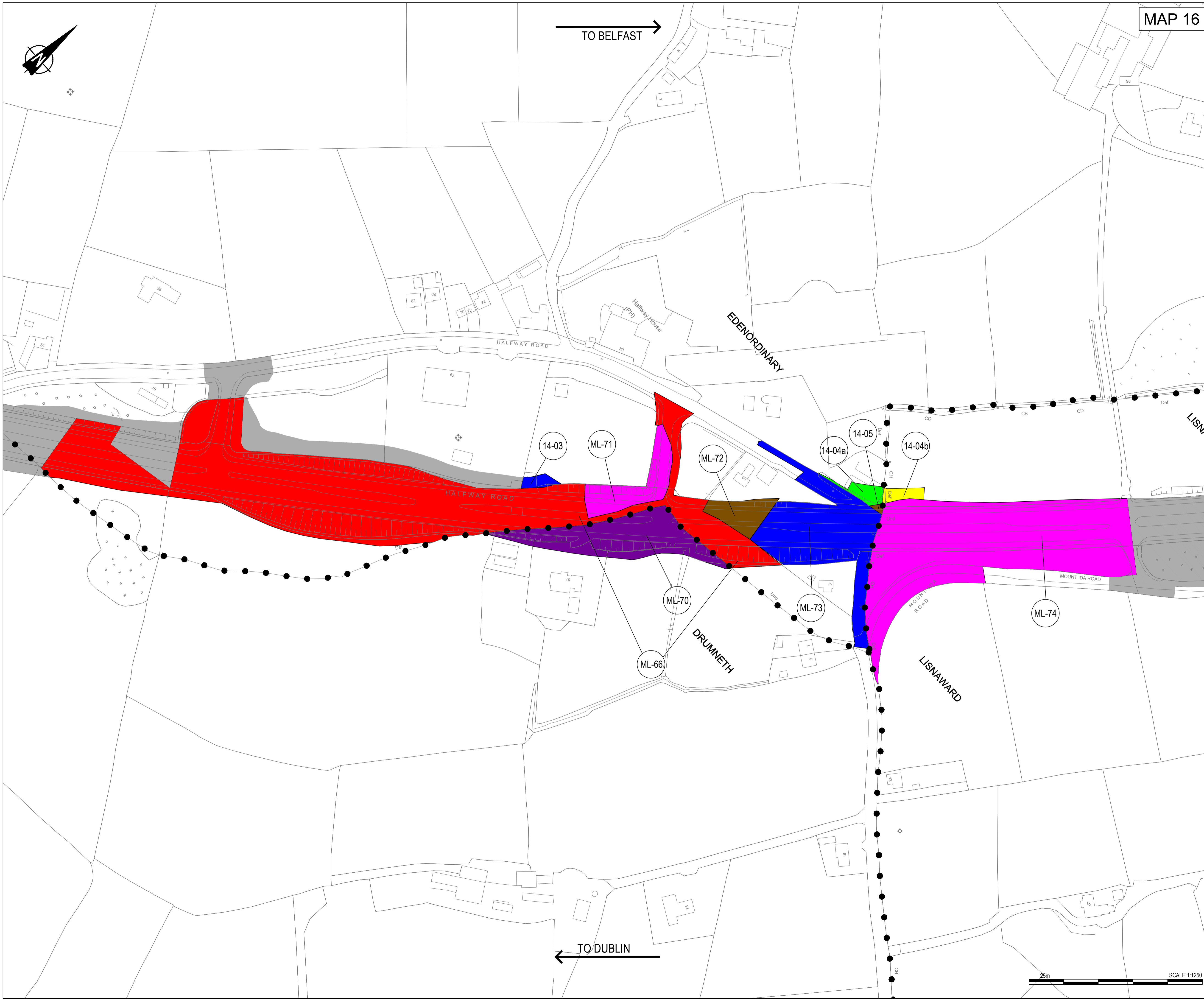

RPS **SWECO**

Elmwood House T +44 (0) 28 90 667914
74 Boucher Road F +44 (0) 28 90 668286
Belfast W www.rpsgroup.com/ireland
BT12 6RZ E ireland@rpsgroup.com

Client
Department for Infrastructure
An Roinn
Bonneagair
www.infrastructure.ni.gov.uk

Project
A1 Junctions Phase 2

Title
Notice of Intention to Make a Vesting Order (NIMVO) Plan - MAP 16

Drawing Status	Suitability	Project Ref No.
S2	For Information	IBH0488

Scale	Designed	Drawn By	Checked	Authorised
1:1250	JF	JF	PN	CD

Original Size	Date	Date	Date	Date
A1	07-06-18	07-06-18	23-08-18	23-08-18

Drawing Number Rev P4.0

TNI Ref | Originator | Volume | Location | Type | Discipline | Classification | Number
168014-RPSB-LOV-XX-DR-HE-2600-00016

NOTES

1. Verifying Dimensions.
The contractor shall verify dimensions against such other drawings or site conditions as pertain to this part of the work.
2. Existing Services.
Any information concerning the location of existing services indicated on this drawing is intended for general guidance only. It shall be the responsibility of the contractor to determine and verify the exact horizontal and vertical alignment of all cables, pipes, etc. (both underground and overhead) before work commences.
3. Issue of Drawings.
Hard copies, dwf and pdf will form a controlled issue of the drawing. All other formats (dwg, dxf etc.) are deemed to be an uncontrolled issue and any work carried out based on these files is at the recipient's own risk. RPS will not accept any responsibility for any errors arising from the use of these files, either by human error by the recipient, listing of un-dimensioned measurements, compatibility issues with the recipient's software, and any errors arising when these files are used to aid the recipient's drawing production, or setting out on site.
4. OS Sheets:
165-13, 165-14, 183-08, 183-12, 183-16, 184-01, 184-02, 184-05, 184-06, 184-09, 184-13, 202-03, 202-04, 202-07, 202-08, 202-10, 202-11, 202-13, 202-14, 202-15, 203-01, 220-08, 220-11, 220-12, 220-15, 220-16, 221-01, 221-02, 221-05, 221-09, 237-03, 237-04
5. This is based upon Crown Copyright and is reproduced with the permission of Land & Property Services under delegated authority from the Controller of Her Majesty's Stationery Office, © Crown copyright and database right [2018] EMOU [206.2]
6. DATUM: IRISH GRID

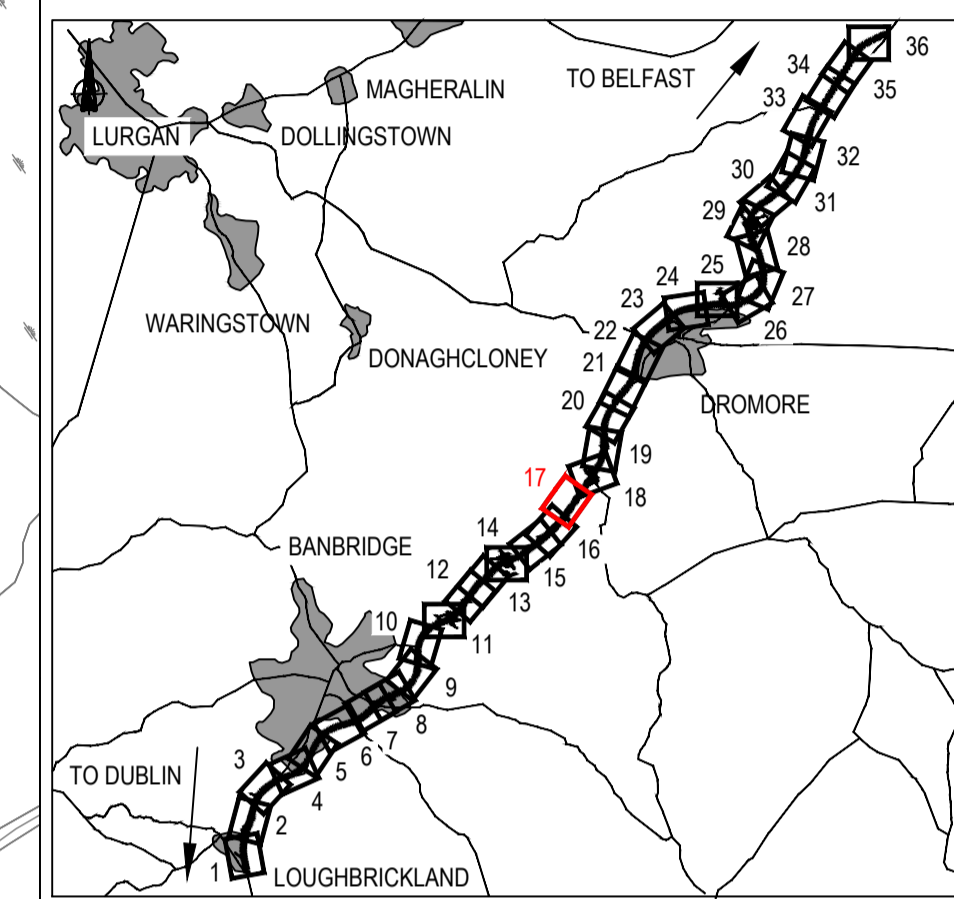

KEY

- Existing OS/ Survey Mapping
- Townland Boundary
- X-XX RSC Folio Reference No

Proposed Land Areas Required

- Red, Green, Blue, Yellow

Proposed Land Areas Required - Leasehold

- Diagonal hatching patterns

Easements being affected

- Grid patterns

P3	Cut lines removed	JF	PN	CD	11-Feb-2019
P2	Folios updated in relation to Land Registry review	JF	PN	CD	02-Nov-2018
REV	COMMENT	DRAWN	CH	AP	DATE

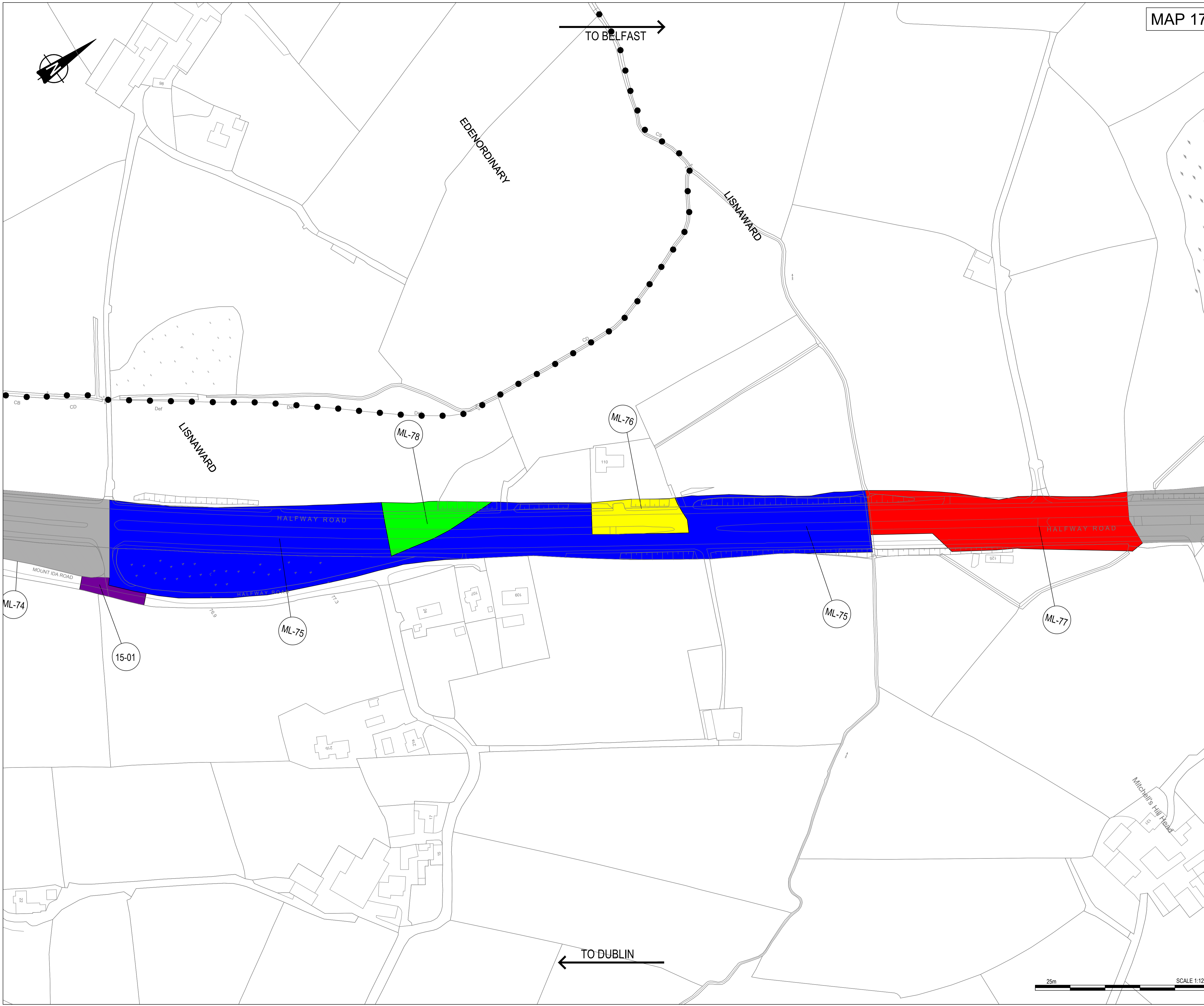

RPS **SWECO**

Elmwood House T +44 (0) 28 90 687914
 74 Boucher Road F +44 (0) 28 90 688286
 Belfast W www.rpsgroup.com/ireland
 BT12 6RZ E ireland@rpsgroup.com

Client: **Department for Infrastructure**
 An Roinn **Bonneagair**
 www.infrastructure-ni.gov.uk

Project: **A1 Junctions Phase 2**

Title: **Notice of Intention to Make a Vesting Order (NIMVO) Plan - MAP 17**

Drawing Status	Suitability	Project Ref No.		
S2	For Information	IBH0488		
Scale	Designed	Drawn By	Checked	Authorised
1:1250	JF	JF	PN	CD
Original Size	Date	Date	Date	Date
A1	07-06-18	07-06-18	23-08-18	23-08-18
Drawing Number	Rev P3.0			
TNI Ref Originator Volume Location Type Discipline Classification Number				
168014-RPSB-LOV-XX-DR-HE-2600-00017				



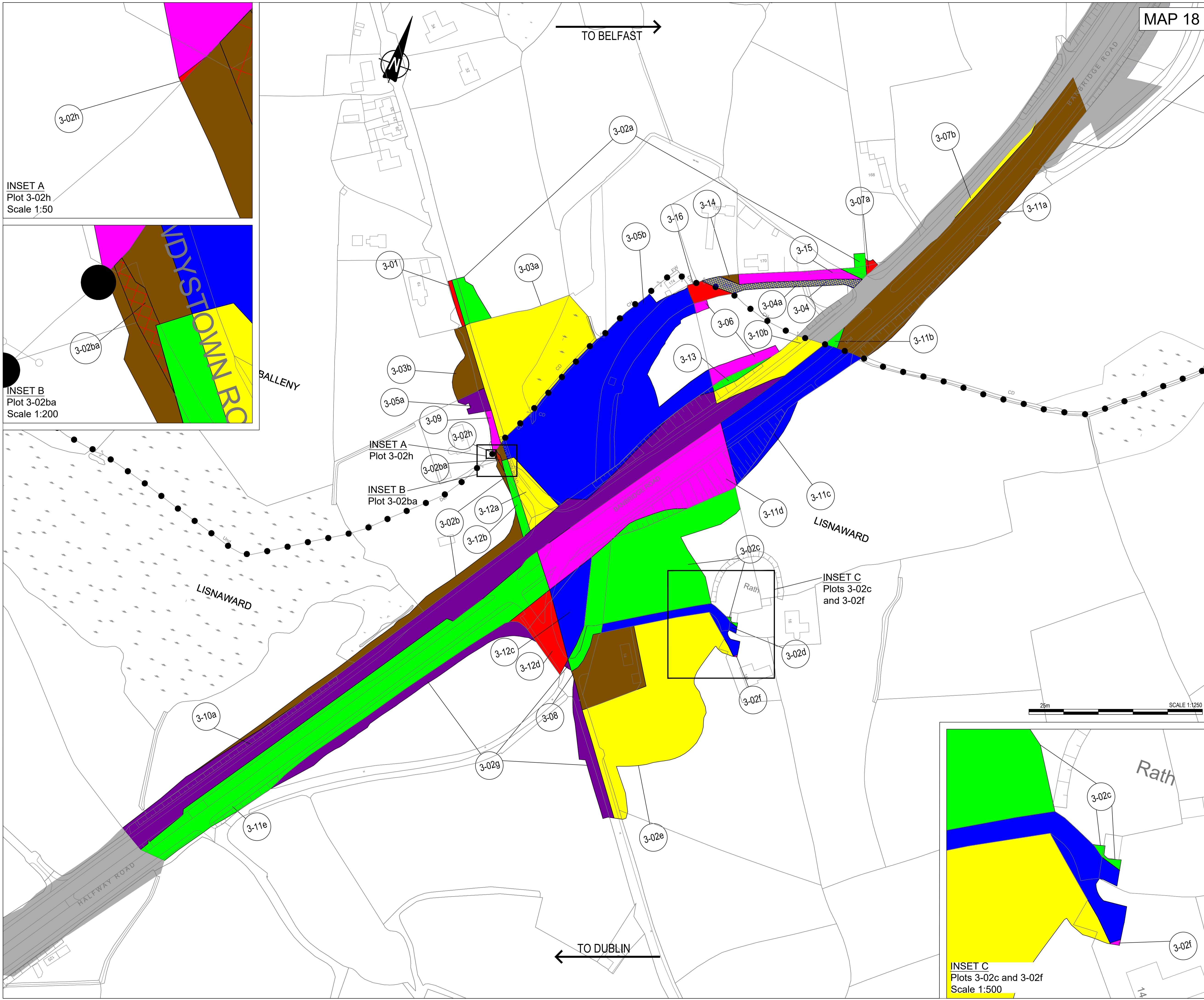

INSET A
Plot 3-02h
Scale 1:50

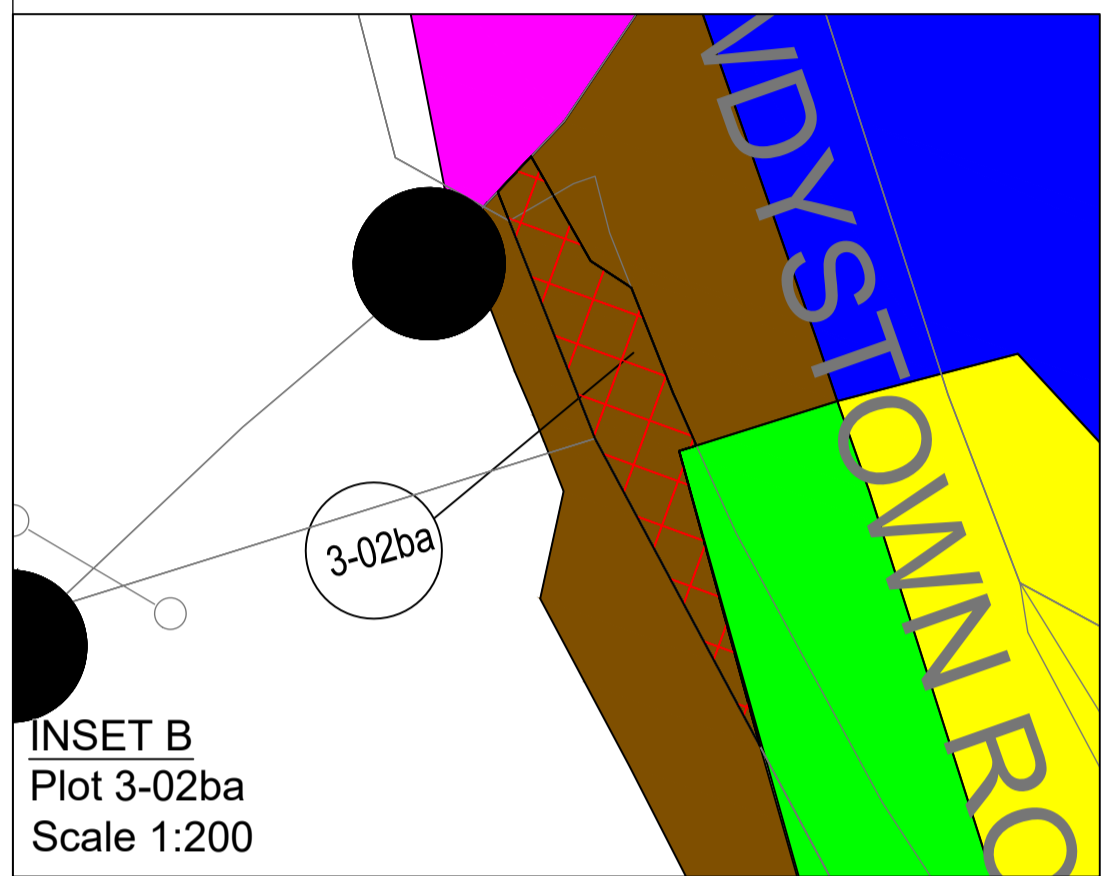

INSET B
Plot 3-02ba
Scale 1:200

INSET A
Plot 3-02h

INSET B
Plot 3-02ba

INSET C
Plots 3-02c and 3-02f

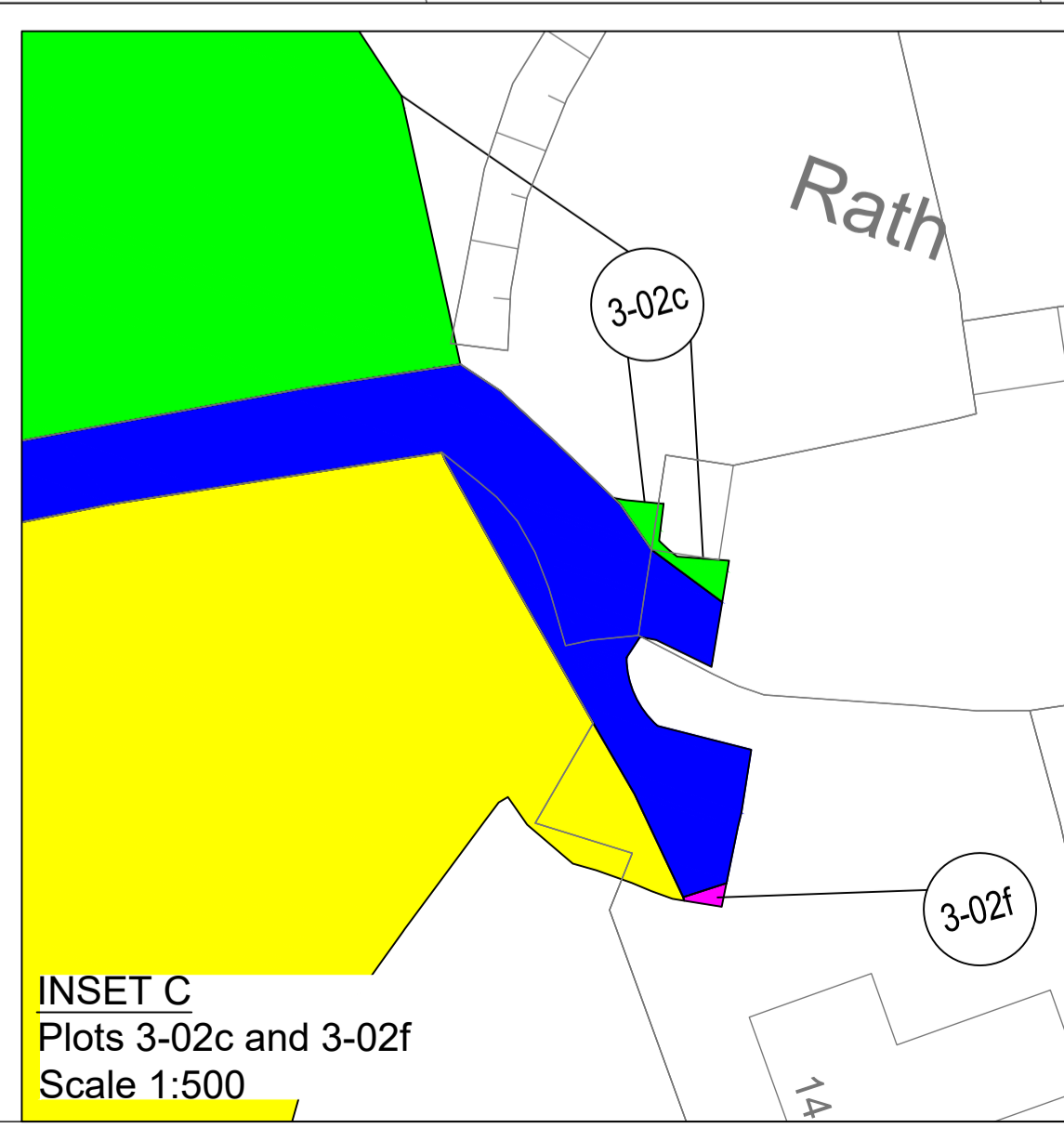

INSET C
Plots 3-02c and 3-02f
Scale 1:500

MAP 18

- NOTES**
1. Verifying Dimensions.
The contractor shall verify dimensions against such other drawings or site conditions as pertain to this part of the work.
 2. Existing Services.
Any information concerning the location of existing services indicated on this drawing is intended for general guidance only. It shall be the responsibility of the contractor to determine and verify the exact horizontal and vertical alignment of all cables, pipes, etc. (both underground and overhead) before work commences.
 3. Issue of Drawings.
Hard copies, dwf and pdf will form a controlled issue of the drawing. All other formats (dwg, dxf etc.) are deemed to be an uncontrolled issue and any work carried out based on these files is at the recipient's own risk. RPS will not accept any responsibility for any errors arising from the use of these files, either by human error by the recipient, listing of un-dimensioned measurements, compatibility issues with the recipient's software, and any errors arising when these files are used to aid the recipient's drawing production, or setting out on site.
 4. OS Sheets:
165-13, 165-14, 183-08, 183-12, 183-16, 184-01, 184-02, 184-05, 184-06, 184-09, 184-13, 202-03, 202-04, 202-07, 202-08, 202-10, 202-11, 202-13, 202-14, 202-15, 203-01, 220-08, 220-11, 220-12, 220-15, 220-16, 221-01, 221-02, 221-05, 221-09, 237-03, 237-04
 5. This is based upon Crown Copyright and is reproduced with the permission of Land & Property Services under delegated authority from the Controller of Her Majesty's Stationery Office. © Crown copyright and database right [2018] EMOU [206.2]

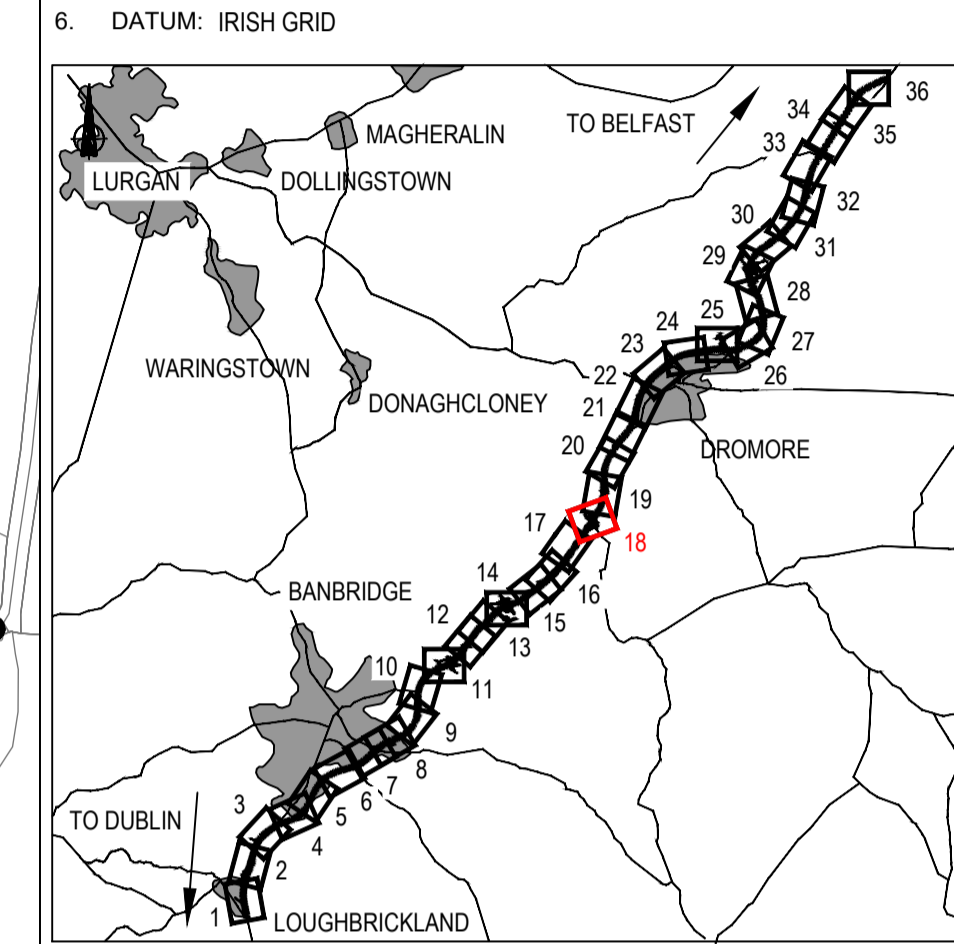

KEY

- Existing OS/ Survey Mapping
- Townland Boundary
- RSC Folio Reference No (X-XX)

Proposed Land Areas Required

- Red, Green, Blue, Yellow, Purple, Brown, Magenta

Proposed Land Areas Required - Leasehold

- Diagonal hatching patterns

Easements being affected

- Grid patterns

P3	Drawings updated following comments from DfI	JF	PN	CD	11-Feb-2019
P2	Folios updated in relation to Land Registry review	JF	PN	CD	02-Nov-2018
REV	COMMENT	DRAWN	CH	AP	DATE

RPS **SWECO**

Elmwood House T +44 (0) 28 90 667914
74 Boucher Road F +44 (0) 28 90 668286
Belfast W www.rpsgroup.com/ireland
BT12 6RZ E ireland@rpsgroup.com

Client: Department for Infrastructure
An Roinn
Bonneagair
www.infrastructure-ni.gov.uk

Project: **A1 Junctions Phase 2**

Title: Notice of Intention to Make a Vesting Order (NIMVO) Plan - MAP 18

Drawing Status	Suitability	Project Ref No.			
S2	For Information	IBH0488			
Scale	Designed	Drawn By	Checked	Authorised	
1:1250	JF	JF	PN	CD	
Original Size	Date	Date	Date	Date	
A1	07-06-18	07-06-18	23-08-18	23-08-18	
Drawing Number	Rev				
TNI Ref Originator Volume Location Type Discipline Classification Number	P3.0				
168014-RPSB-LOV-XX-DR-HE-2600-00018					

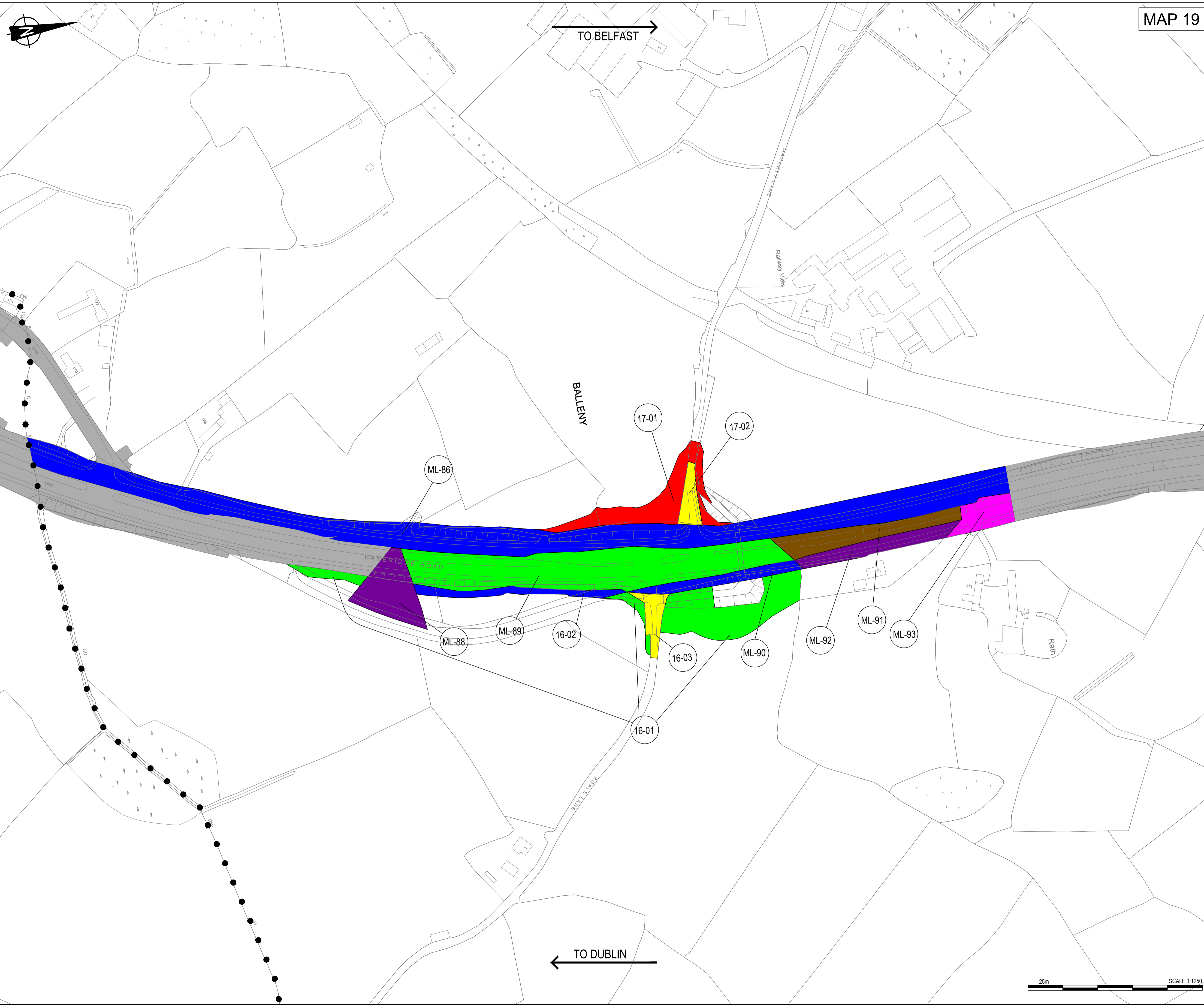

MAP 19

- NOTES**
1. Verifying Dimensions.
The contractor shall verify dimensions against such other drawings or site conditions as pertain to this part of the work.
 2. Existing Services.
Any information concerning the location of existing services indicated on this drawing is intended for general guidance only. It shall be the responsibility of the contractor to determine and verify the exact horizontal and vertical alignment of all cables, pipes, etc. (both underground and overhead) before work commences.
 3. Issue of Drawings.
Hard copies, dwf and pdf will form a controlled issue of the drawing. All other formats (dwg, dxf etc.) are deemed to be an uncontrolled issue and any work carried out based on these files is at the recipient's own risk. RPS will not accept any responsibility for any errors arising from the use of these files, either by human error by the recipient, listing of un-dimensioned measurements, compatibility issues with the recipient's software, and any errors arising when these files are used to aid the recipient's drawing production, or setting out on site.
 4. OS Sheets:
165-13, 165-14, 183-08, 183-12, 183-16, 184-01, 184-02, 184-05, 184-06, 184-09, 184-13, 202-03, 202-04, 202-07, 202-08, 202-10, 202-11, 202-13, 202-14, 202-15, 203-01, 220-08, 220-11, 220-12, 220-15, 220-16, 221-01, 221-02, 221-05, 221-09, 237-03, 237-04
 5. This is based upon Crown Copyright and is reproduced with the permission of Land & Property Services under delegated authority from the Controller of Her Majesty's Stationery Office, © Crown copyright and database right [2018] EMOU [206.2]
 6. DATUM: IRISH GRID

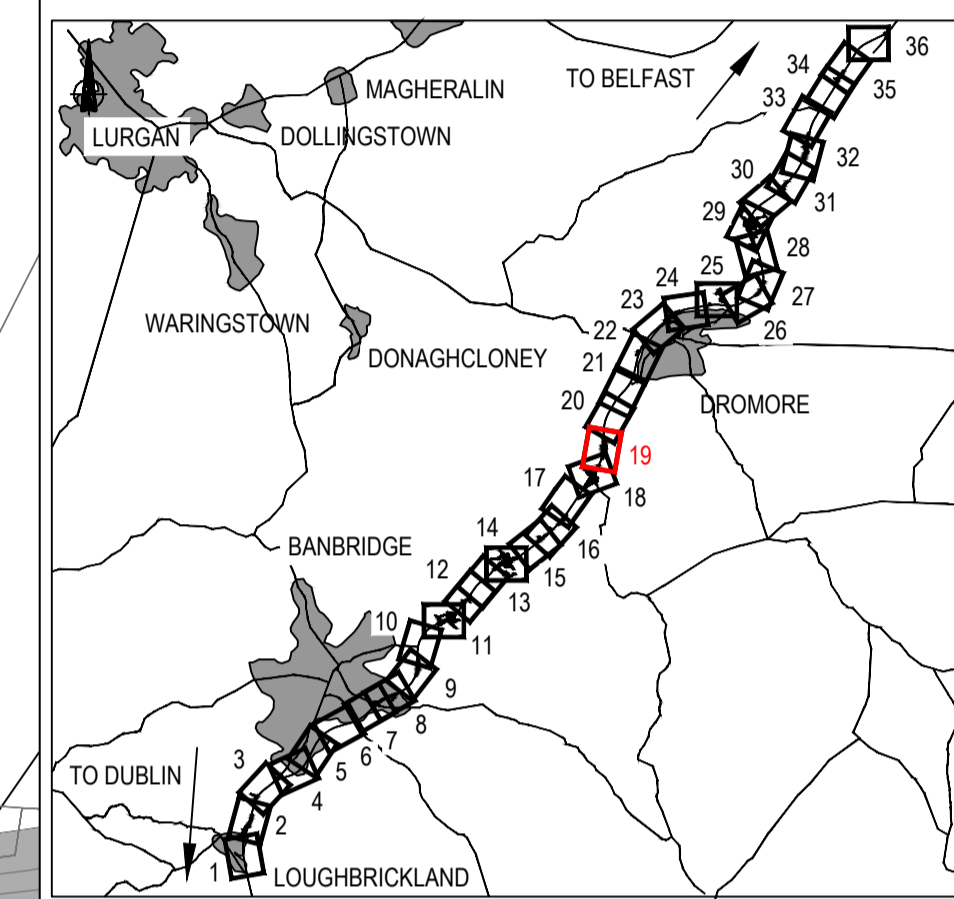

KEY

- Existing OS/ Survey Mapping
- Townland Boundary
- X-XX RSC Folio Reference No

Proposed Land Areas Required

- Red, Green, Blue, Yellow

Proposed Land Areas Required - Leasehold

- Diagonal hatching patterns

Easements being affected

- Grid hatching patterns

P3	Drawings updated following comments from DfI	JF	PN	CD	07-Feb-2019
P2	Folios updated in relation to Land Registry review	JF	PN	CD	02-Nov-2018
REV	COMMENT	DRAWN	CH	AP	DATE

RPS **SWECO**

Elmwood House T +44 (0) 28 90 667914
 74 Boucher Road F +44 (0) 28 90 668286
 Belfast W www.rpsgroup.com/ireland
 BT12 6RZ E ireland@rpsgroup.com

Client

Department for Infrastructure
 An Roinn
Bonneagair
 www.infrastructure.ie.gov.uk

Project

A1 Junctions Phase 2

Title

Notice of Intention to Make a Vesting Order (NIMVO) Plan - MAP 19

Drawing Status	Suitability	Project Ref No.		
S2	For Information	IBH0488		
Scale	Designed	Drawn By	Checked	Authorised
1:1250	JF	JF	PN	CD
Original Size	Date	Date	Date	Date
A1	07-06-18	07-06-18	23-08-18	23-08-18
Drawing Number	Rev P3.0			
TNI Ref Originator Volume Location Type Discipline Classification Number				
168014-RPSB-LOV-XX-DR-HE-2600-00019				



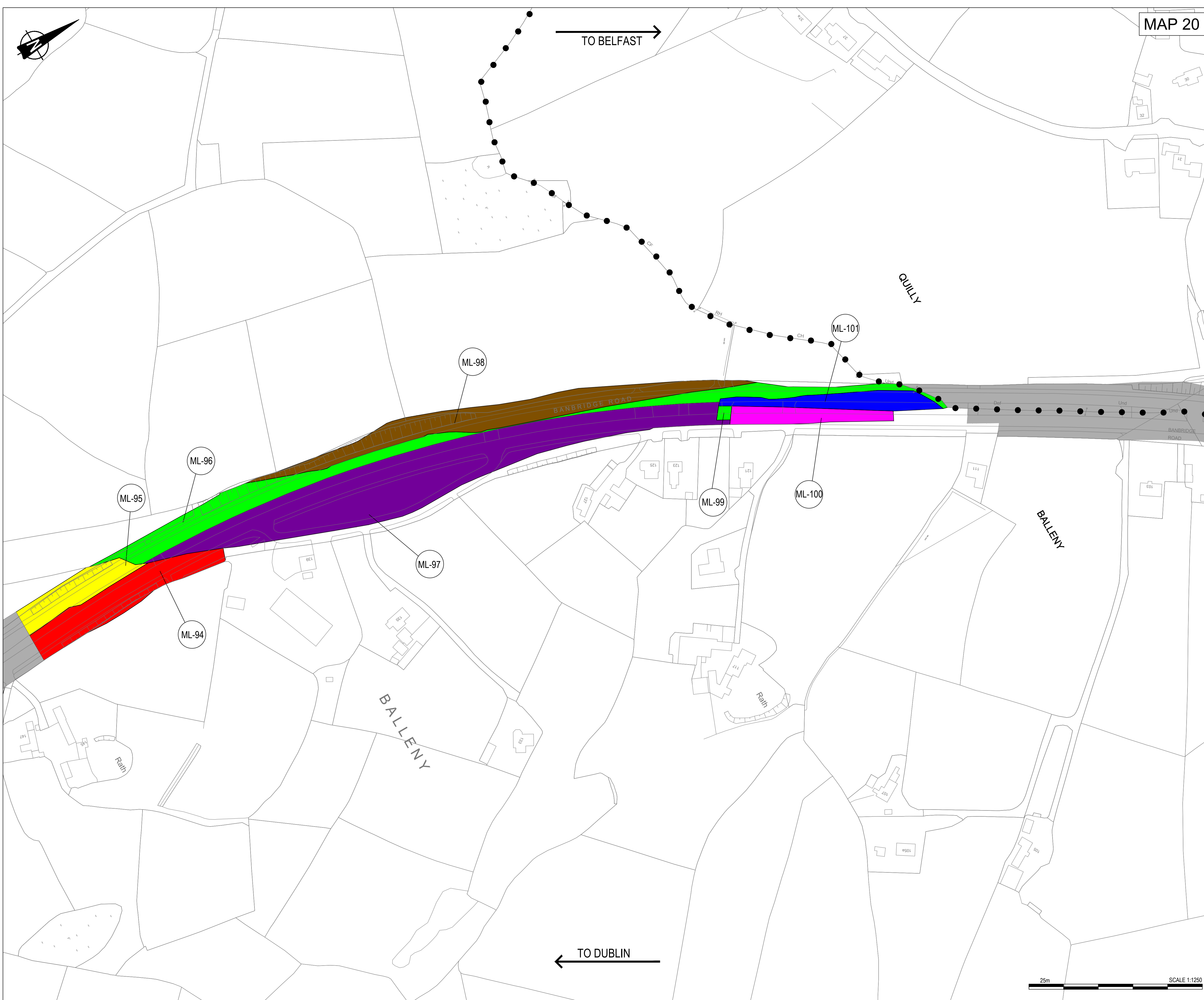

MAP 20

- NOTES**
1. Verifying Dimensions.
The contractor shall verify dimensions against such other drawings or site conditions as pertain to this part of the work.
 2. Existing Services.
Any information concerning the location of existing services indicated on this drawing is intended for general guidance only. It shall be the responsibility of the contractor to determine and verify the exact horizontal and vertical alignment of all cables, pipes, etc. (both underground and overhead) before work commences.
 3. Issue of Drawings.
Hard copies, dwf and pdf will form a controlled issue of the drawing. All other formats (dwg, dxf etc.) are deemed to be uncontrolled issue and any work carried out based on these files is at the recipient's own risk. RPS will not accept any responsibility for any errors arising from the use of these files, either by human error by the recipient, listing of un-dimensioned measurements, compatibility issues with the recipient's software, and any errors arising when these files are used to aid the recipient's drawing production, or setting out on site.
 4. OS Sheets:
165-13, 165-14, 183-08, 183-12, 183-16, 184-01, 184-02, 184-05, 184-06, 184-09, 184-13, 202-03, 202-04, 202-07, 202-08, 202-10, 202-11, 202-13, 202-14, 202-15, 203-01, 220-08, 220-11, 220-12, 220-15, 220-16, 221-01, 221-02, 221-05, 221-09, 237-03, 237-04
 5. This is based upon Crown Copyright and is reproduced with the permission of Land & Property Services under delegated authority from the Controller of Her Majesty's Stationery Office, © Crown copyright and database right [2018] EMOU [206.2]
 6. DATUM: IRISH GRID

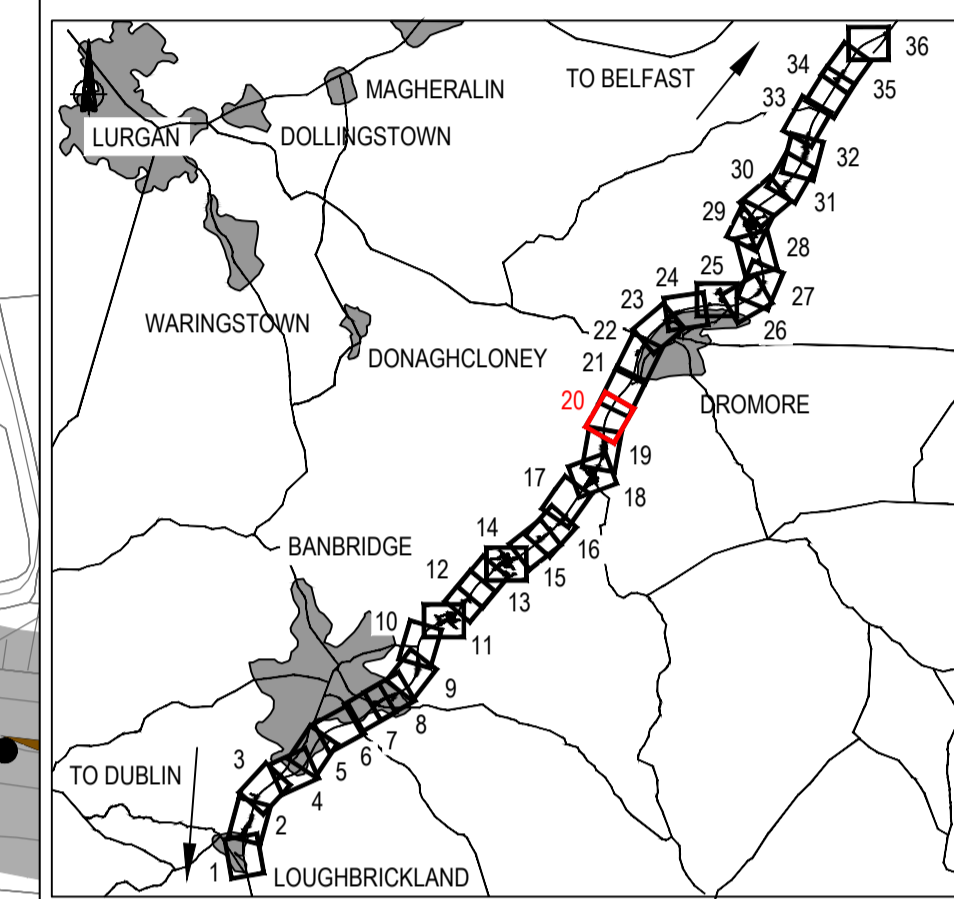

KEY

- Existing OS/ Survey Mapping
- Townland Boundary
- RSC Folio Reference No (X-XX)

Proposed Land Areas Required

- Red, Green, Blue, Yellow
- Magenta, Brown, Purple

Proposed Land Areas Required - Leasehold

- Diagonal hatching

Easements being affected

- Grid hatching, Dashed lines

P3	Drawings updated following comments from DfI	JF	PN	CD	07-Feb-2019
P2	Folios updated in relation to Land Registry review	JF	PN	CD	02-Nov-2018
REV	COMMENT	DRAWN	CH	AP	DATE

RPS **SWECO**

Elmwood House T +44 (0) 28 90 667914
 74 Boucher Road F +44 (0) 28 90 668286
 Belfast W www.rpsgroup.com/ireland
 BT12 6RZ E ireland@rpsgroup.com

Client: **Department for Infrastructure**
 An Roinn **Bonneagair**
 www.infrastructure.ie.gov.uk

Project: **A1 Junctions Phase 2**

Title: **Notice of Intention to Make a Vesting Order (NIMVO) Plan - MAP 20**

Drawing Status	Suitability	Project Ref No.		
S2	For Information	IBH0488		
Scale	Designed	Drawn By	Checked	Authorised
1:1250	JF	JF	PN	CD
Original Size	Date	Date	Date	Date
A1	07-06-18	07-06-18	23-08-18	23-08-18
Drawing Number	Rev P3.0			
TNI Ref Originator Volume Location Type Discipline Classification Number				
168014-RPSB-LOV-XX-DR-HE-2600-00020				



- NOTES**
1. Verifying Dimensions.
The contractor shall verify dimensions against such other drawings or site conditions as pertain to this part of the work.
 2. Existing Services.
Any information concerning the location of existing services indicated on this drawing is intended for general guidance only. It shall be the responsibility of the contractor to determine and verify the exact horizontal and vertical alignment of all cables, pipes, etc. (both underground and overhead) before work commences.
 3. Issue of Drawings.
Hard copies, dwf and pdf will form a controlled issue of the drawing. All other formats (dwg, dxf etc.) are deemed to be an uncontrolled issue and any work carried out based on these files is at the recipient's own risk. RPS will not accept any responsibility for any errors arising from the use of these files, either by human error by the recipient, listing of un-dimensioned measurements, compatibility issues with the recipient's software, and any errors arising when these files are used to aid the recipient's drawing production, or setting out on site.
 4. OS Sheets:
165-13, 165-14, 183-08, 183-12, 183-16, 184-01, 184-02, 184-05, 184-06, 184-09, 184-13, 202-03, 202-04, 202-07, 202-08, 202-10, 202-11, 202-13, 202-14, 202-15, 203-01, 220-08, 220-11, 220-12, 220-15, 220-16, 221-01, 221-02, 221-05, 221-09, 237-03, 237-04
 5. This is based upon Crown Copyright and is reproduced with the permission of Land & Property Services under delegated authority from the Controller of Her Majesty's Stationery Office, © Crown copyright and database right [2018] EMOU [206 2]
 6. DATUM: IRISH GRID

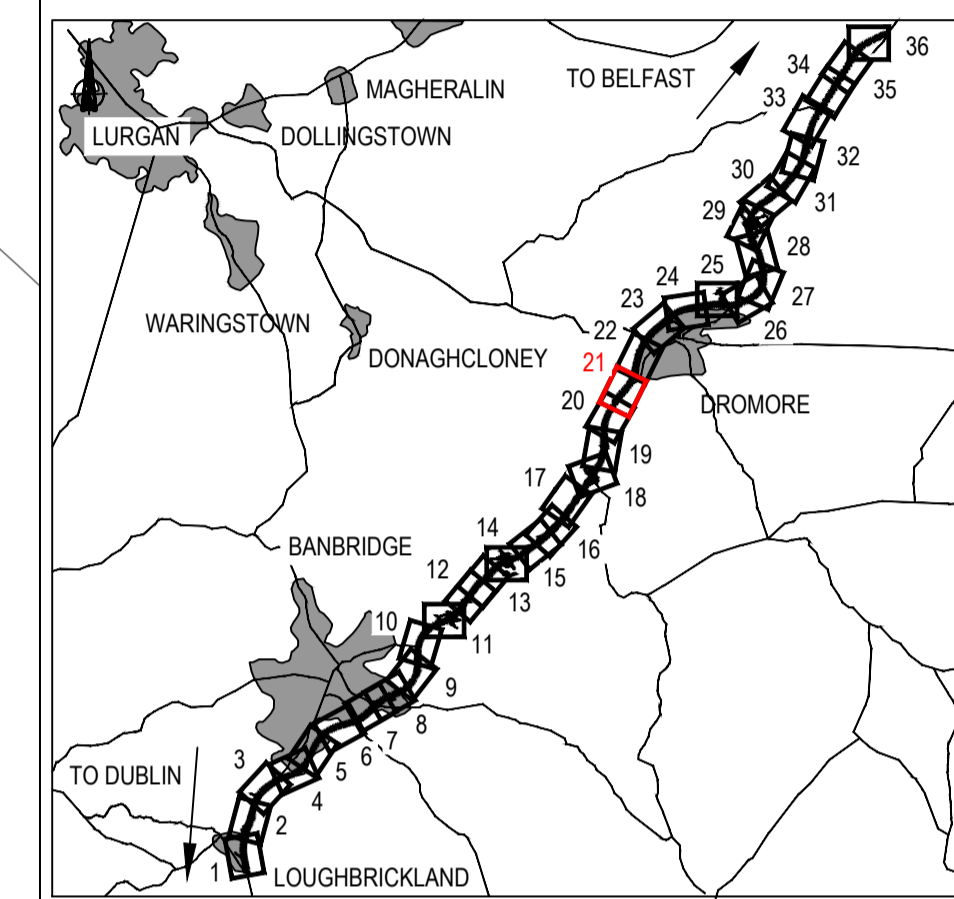

KEY

- Existing OS / Survey Mapping
- Townland Boundary
- RSC Folio Reference No (X-XX)

Proposed Land Areas Required

- Red, Green, Blue, Yellow, Purple, Brown

Proposed Land Areas Required - Leasehold

- Diagonal hatching patterns

Easements being affected

- Grid patterns

P3	Drawings updated following comments from DfI	JF	PN	CD	11-Feb-2019
P2	Folios updated in relation to Land Registry review	JF	PN	CD	02-Nov-2018
REV	COMMENT	DRWN	CH	AP	DATE

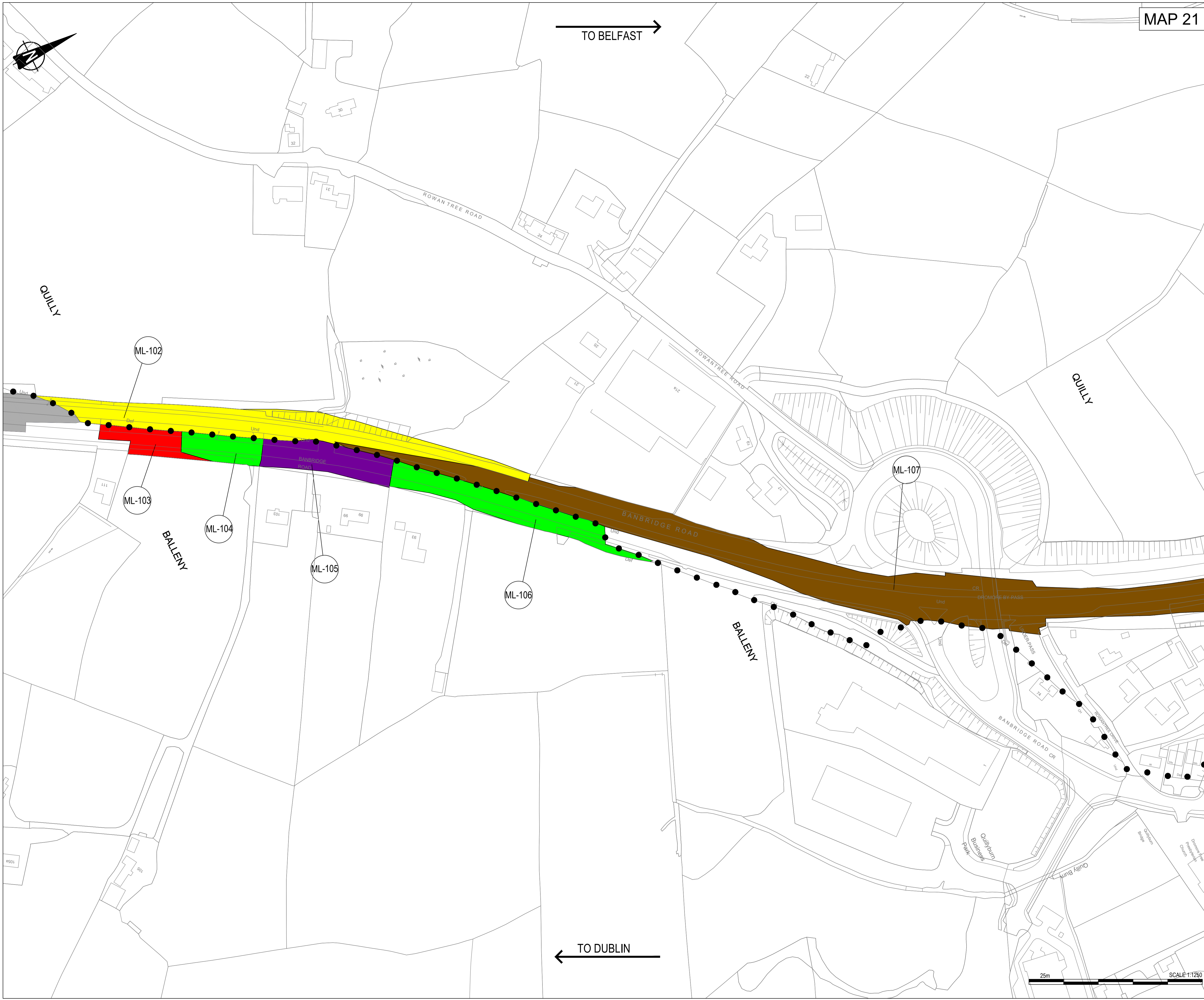

RPS **SWECO**

Elmwood House T +44 (0) 28 90 667914
74 Boucher Road F +44 (0) 28 90 668286
Belfast W www.rpsgroup.com/ireland
BT12 6RZ E ireland@rpsgroup.com

Client
Department for Infrastructure
An Roinn
Bonneagair
www.infrastructure-ni.gov.uk

Project
A1 Junctions Phase 2

Title
Notice of Intention to Make a Vesting Order (NIMVO) Plan - MAP 21

Drawing Status	Suitability	Project Ref No.
S2	For Information	IBH0488

Scale	Designed	Drawn By	Checked	Authorised
1:1250	JF	JF	PN	CD

Original Size	Date	Date	Date	Date
A1	07-06-18	07-06-18	23-08-18	23-08-18

Drawing Number Rev P3.0

TNI Ref | Originator | Volume | Location | Type | Discipline | Classification | Number
168014-RPSB-LOV-XX-DR-HE-2600-00021

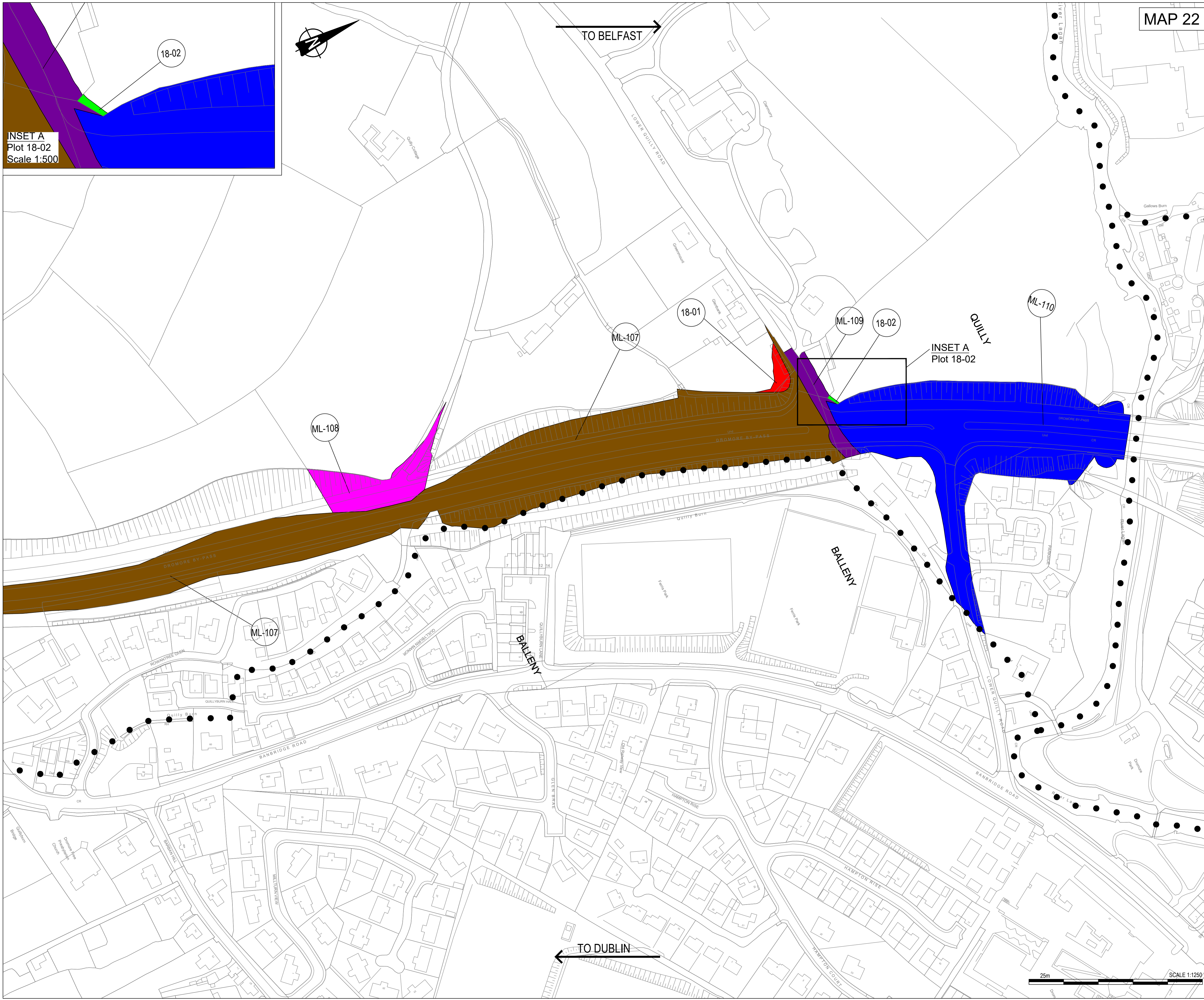

INSET A
Plot 18-02
Scale 1:500

MAP 22

- NOTES**
1. Verifying Dimensions.
The contractor shall verify dimensions against such other drawings or site conditions as pertain to this part of the work.
 2. Existing Services.
Any information concerning the location of existing services indicated on this drawing is intended for general guidance only. It shall be the responsibility of the contractor to determine and verify the exact horizontal and vertical alignment of all cables, pipes, etc. (both underground and overhead) before work commences.
 3. Issue of Drawings.
Hard copies, dwf and pdf will form a controlled issue of the drawing. All other formats (dwg, dxf etc.) are deemed to be an uncontrolled issue and any work carried out based on these files is at the recipient's own risk. RPS will not accept any responsibility for any errors arising from the use of these files, either by human error by the recipient, listing of un-dimensioned measurements, compatibility issues with the recipient's software, and any errors arising when these files are used to aid the recipient's drawing production, or setting out on site.
 4. OS Sheets:
165-13, 165-14, 183-08, 183-12, 183-16, 184-01, 184-02, 184-05, 184-06, 184-09, 184-13, 202-03, 202-04, 202-07, 202-08, 202-10, 202-11, 202-13, 202-14, 202-15, 203-01, 220-08, 220-11, 220-12, 220-15, 220-16, 221-01, 221-02, 221-05, 221-09, 237-03, 237-04
 5. This is based upon Crown Copyright and is reproduced with the permission of Land & Property Services under delegated authority from the Controller of Her Majesty's Stationery Office, © Crown copyright and database right [2018] EMOU [206.2]
 6. DATUM: IRISH GRID

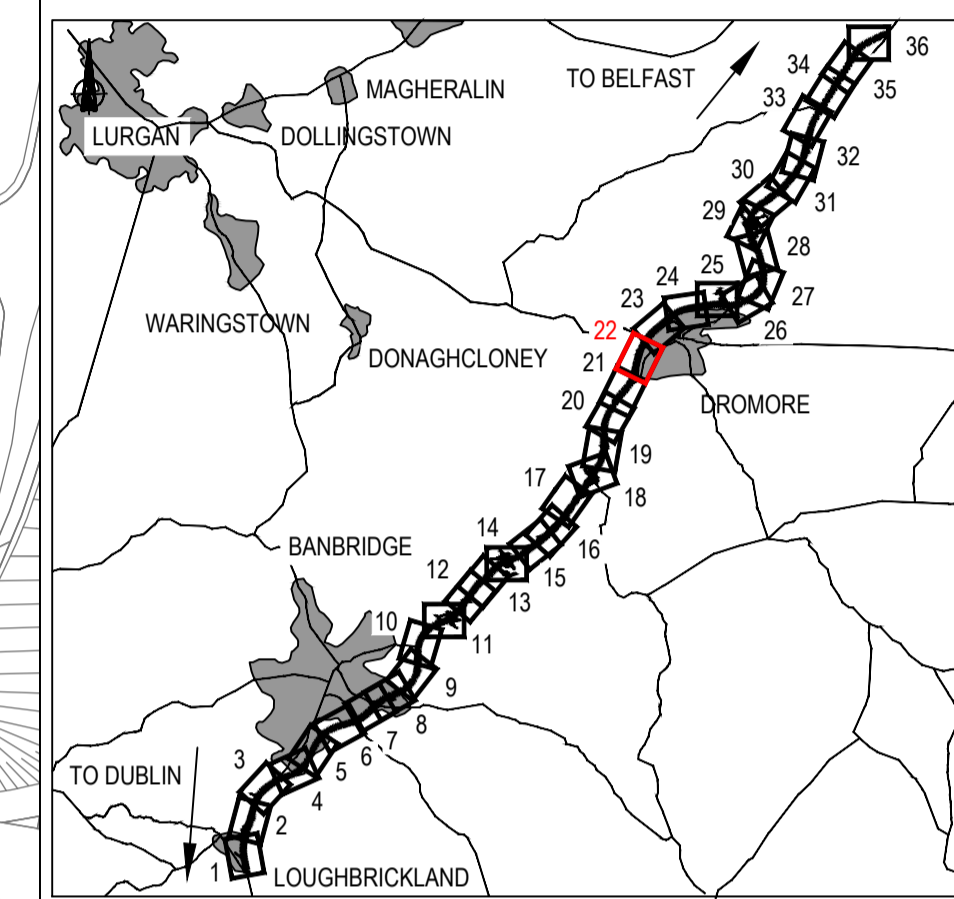

KEY

- Existing OS/ Survey Mapping
- Townland Boundary
- RSC Folio Reference No

Proposed Land Areas Required

- Red, Green, Blue, Yellow
- Magenta, Brown, Purple

Proposed Land Areas Required - Leasehold

- Diagonal hatching patterns

Easements being affected

- Blue dashed lines

P3	Cut lines removed	JF	PN	CD	11-Feb-2019
P2	Folios updated in relation to Land Registry review	JF	PN	CD	02-Nov-2018
REV	COMMENT	DRAWN	CH	AP	DATE

RPS **SWECO**

Elmwood House
74 Boucher Road
Belfast
BT12 6RZ

T +44 (0) 28 90 667914
F +44 (0) 28 90 668286
W www.rpsgroup.com/ireland
E ireland@rpsgroup.com

Client: Department for Infrastructure
Bonneagair
www.infrastructure-ni.gov.uk

Project: **A1 Junctions Phase 2**

Title: Notice of Intention to Make a Vesting Order (NIMVO) Plan - MAP 22

Drawing Status	Suitability	Project Ref No.		
S2	For Information	IBH0488		
Scale	Designed	Drawn By	Checked	Authorised
1:1250	JF	JF	PN	CD
Original Size	Date	Date	Date	Date
A1	07-06-18	07-06-18	23-08-18	23-08-18
Drawing Number	Rev P3.0			
TNI Ref Originator Volume Location Type Discipline Classification Number				
168014-RPSB-LOV-XX-DR-HE-2600-00022				

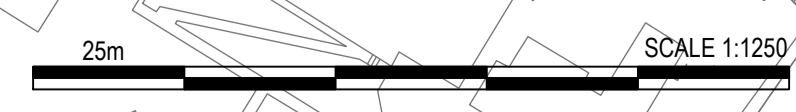

- NOTES**
1. Verifying Dimensions.
The contractor shall verify dimensions against such other drawings or site conditions as pertain to this part of the work.
 2. Existing Services.
Any information concerning the location of existing services indicated on this drawing is intended for general guidance only. It shall be the responsibility of the contractor to determine and verify the exact horizontal and vertical alignment of all cables, pipes, etc. (both underground and overhead) before work commences.
 3. Issue of Drawings.
Hard copies, dwf and pdf will form a controlled issue of the drawing. All other formats (dwg, dxf etc.) are deemed to be an uncontrolled issue and any work carried out based on these files is at the recipient's own risk. RPS will not accept any responsibility for any errors arising from the use of these files, either by human error by the recipient, listing of un-dimensioned measurements, compatibility issues with the recipient's software, and any errors arising when these files are used to aid the recipient's drawing production, or setting out on site.
 4. OS Sheets:
165-13, 165-14, 183-08, 183-12, 183-16, 184-01, 184-02, 184-05, 184-06, 184-09, 184-13, 202-03, 202-04, 202-07, 202-08, 202-10, 202-11, 202-13, 202-14, 202-15, 203-01, 220-08, 220-11, 220-12, 220-15, 220-16, 221-01, 221-02, 221-05, 221-09, 237-03, 237-04
 5. This is based upon Crown Copyright and is reproduced with the permission of Land & Property Services under delegated authority from the Controller of Her Majesty's Stationery Office, © Crown copyright and database right [2018] EMOU [206.2]
 6. DATUM: IRISH GRID

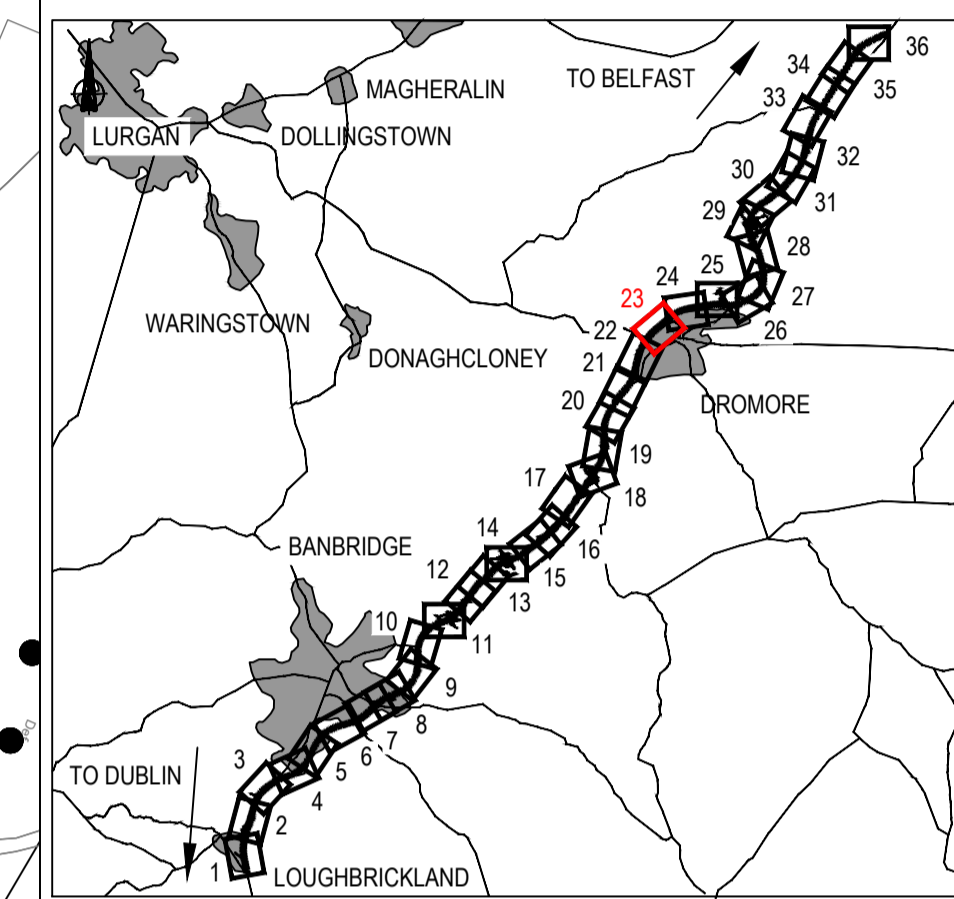

KEY

- Existing OS / Survey Mapping
- Townland Boundary
- X-XX RSC Folio Reference No

Proposed Land Areas Required

- Red
- Green
- Blue
- Yellow
- Magenta
- Brown
- Purple

Proposed Land Areas Required - Leasehold

- Diagonal lines (top-left to bottom-right)
- Diagonal lines (top-right to bottom-left)

Easements being affected

- Red grid pattern
- Blue grid pattern
- Green dashed line

P3	Cut lines removed	JF	JF	PN	PN	CD	CD	11-Feb-2019
P2	Folios updated in relation to Land Registry review	JF	JF	PN	PN	CD	CD	02-Nov-2018
REV	COMMENT	DRAWN	CH	AP	DATE			

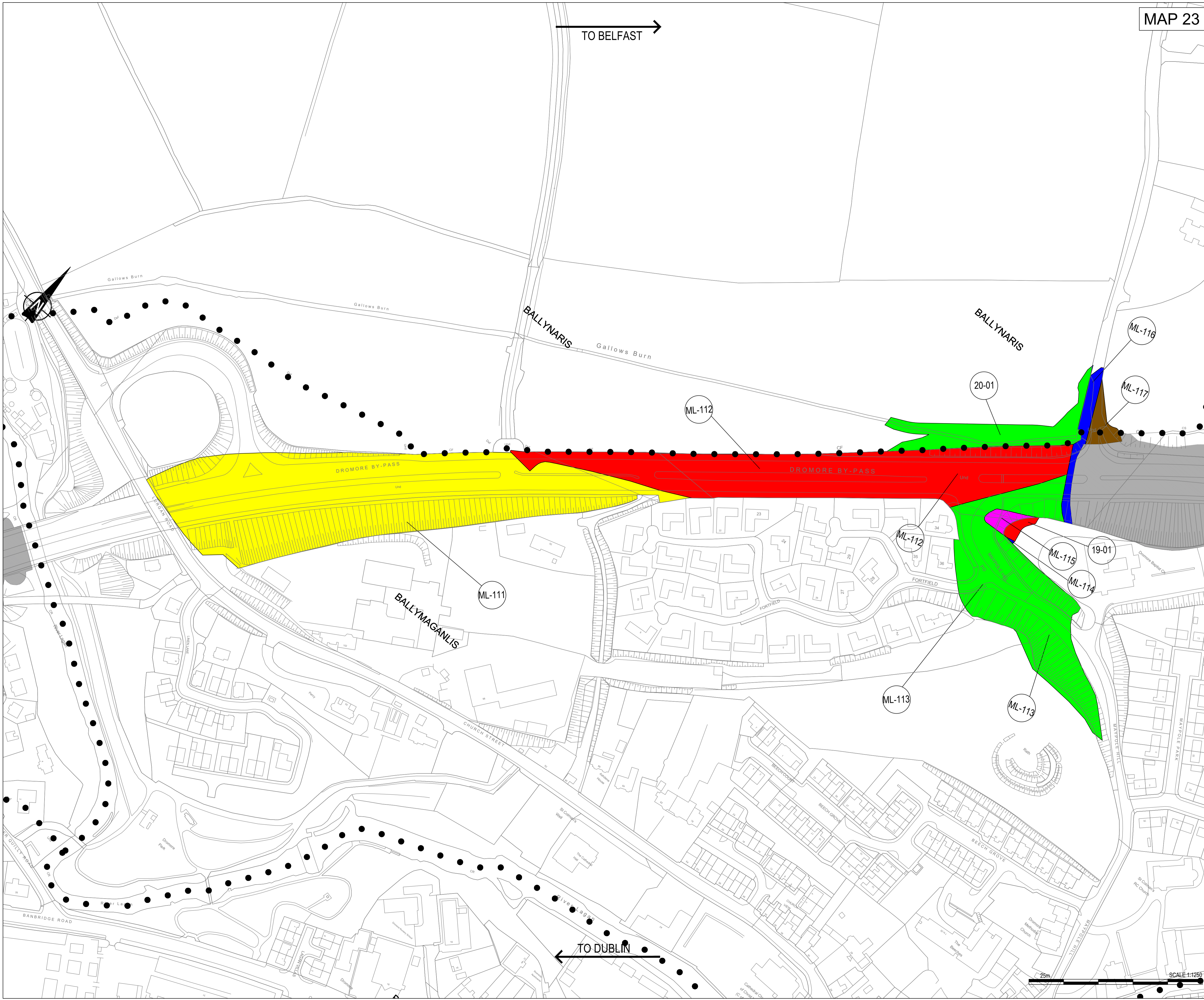

RPS **SWECO**

Elmwood House
74 Boucher Road
Belfast
BT12 6RZ

T +44 (0) 28 90 667914
F +44 (0) 28 90 668286
W www.rpsgroup.com/ireland
E ireland@rpsgroup.com

Client

Department for Infrastructure
An Roinn
Bonneagair
www.infrastructure-ni.gov.uk

Project

A1 Junctions Phase 2

Title

Notice of Intention to Make a Vesting Order (NIMVO) Plan - MAP 23

Drawing Status	Suitability	Project Ref No.		
S2	For Information	IBH0488		
Scale	Designed	Drawn By	Checked	Authorised
1:1250	JF	JF	PN	CD
Original Size	Date	Date	Date	Date
A1	07-06-18	07-06-18	23-08-18	23-08-18
Drawing Number	Rev P3.0			

- NOTES**
1. Verifying Dimensions.
The contractor shall verify dimensions against such other drawings or site conditions as pertain to this part of the work.
 2. Existing Services.
Any information concerning the location of existing services indicated on this drawing is intended for general guidance only. It shall be the responsibility of the contractor to determine and verify the exact horizontal and vertical alignment of all cables, pipes, etc. (both underground and overhead) before work commences.
 3. Issue of Drawings.
Hard copies, dwf and pdf will form a controlled issue of the drawing. All other formats (dwg, dxf etc.) are deemed to be an uncontrolled issue and any work carried out based on these files is at the recipient's own risk. RPS will not accept any responsibility for any errors arising from the use of these files, either by human error by the recipient, listing of un-dimensioned measurements, compatibility issues with the recipient's software, and any errors arising when these files are used to aid the recipient's drawing production, or setting out on site.
 4. OS Sheets:
165-13, 165-14, 183-08, 183-12, 183-16, 184-01, 184-02, 184-05, 184-06, 184-09, 184-13, 202-03, 202-04, 202-07, 202-08, 202-10, 202-11, 202-13, 202-14, 202-15, 203-01, 220-08, 220-11, 220-12, 220-15, 220-16, 221-01, 221-02, 221-05, 221-09, 237-03, 237-04
 5. This is based upon Crown Copyright and is reproduced with the permission of Land & Property Services under delegated authority from the Controller of Her Majesty's Stationery Office. © Crown copyright and database right [2018] EMOU [206.2]
 6. DATUM: IRISH GRID

INSET A
Plot 20-03
Scale 1:500

MAYPOLE ROAD

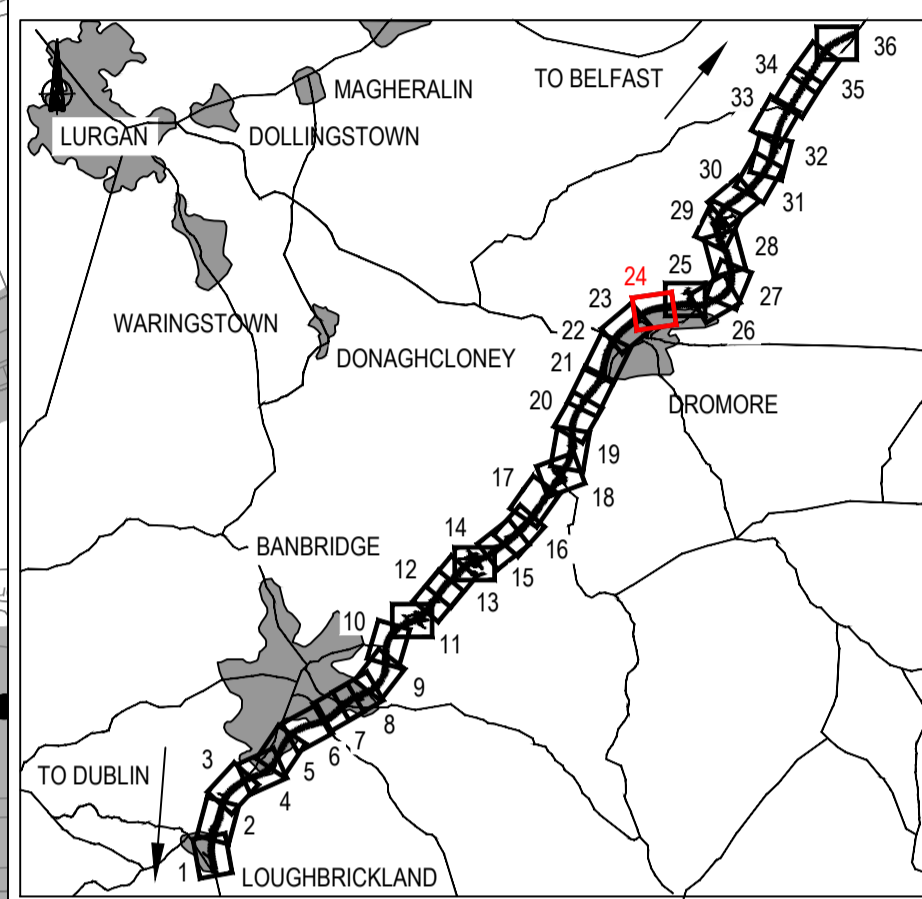
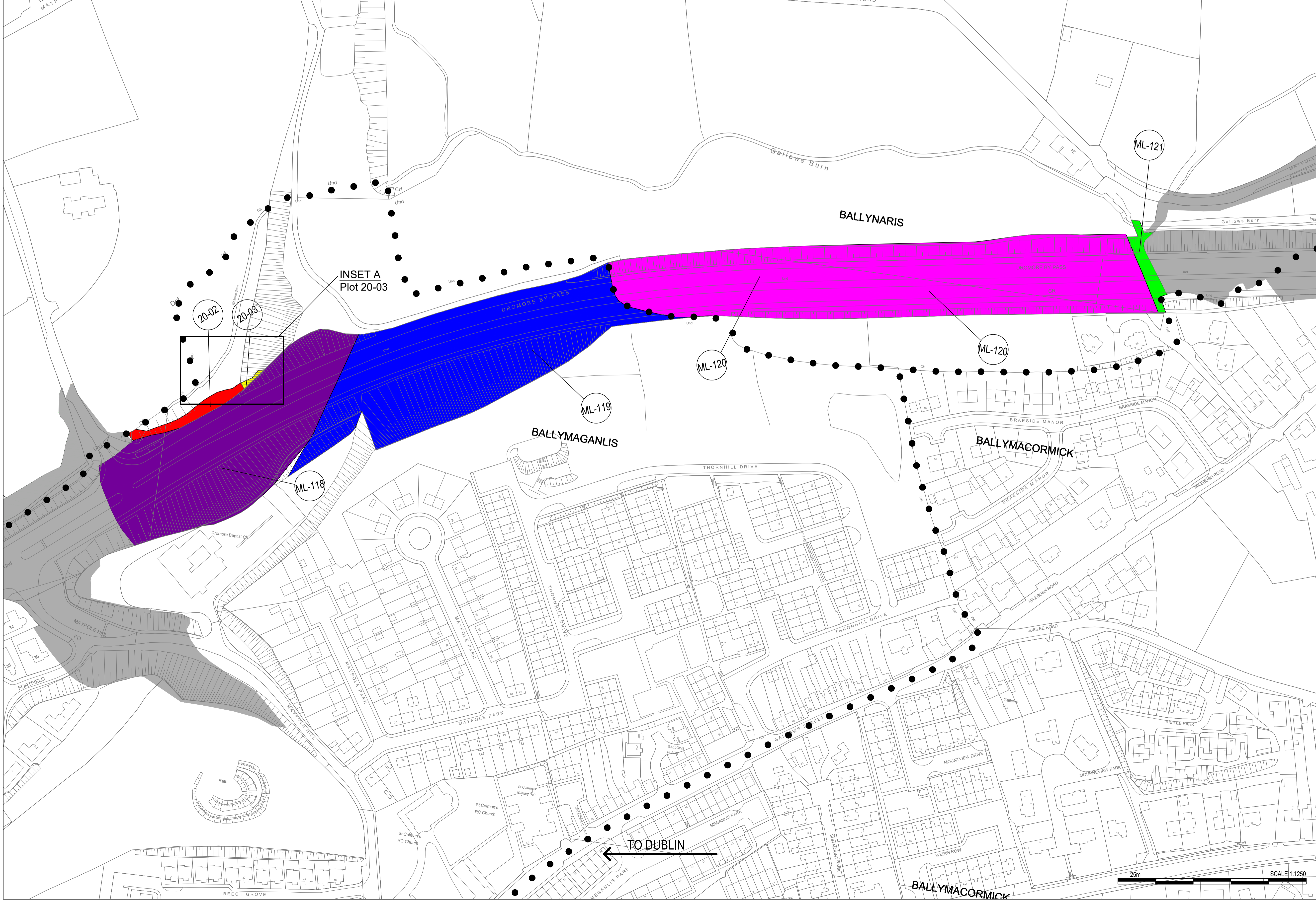

KEY

- Existing OS / Survey Mapping
- Townland Boundary
- RSC Folio Reference No

Proposed Land Areas Required

- Red: Proposed Land Areas Required - Leasehold
- Green: Proposed Land Areas Required
- Blue: Proposed Land Areas Required
- Purple: Proposed Land Areas Required
- Pink: Proposed Land Areas Required

Easements being affected

- Red grid: Easements being affected
- Blue grid: Easements being affected
- Green dashed: Easements being affected

P2	Cut lines removed	JF	PN	CD	11-Feb-2019
REV	COMMENT	DRAWN	CH	AP	DATE

RPS **SWECO**

Elmwood House
74 Boucher Road
Belfast
BT12 6RZ

T +44 (0) 28 90 667914
F +44 (0) 28 90 668286
W www.rpsgroup.com/ireland
E ireland@rpsgroup.com

Client

Department for Infrastructure
An Roinn
Bonneagair
www.infrastructure-ni.gov.uk

Project

A1 Junctions Phase 2

Title

Notice of Intention to Make a Vesting Order (NIMVO) Plan - MAP 24

Drawing Status	Suitability	Project Ref No.			
S2	For Information	IBH0488			
Scale	Designed	Drawn By	Checked	Authorised	
1:1250	JF	JF	PN	CD	
Original Size	Date	Date	Date	Date	
A1	07-06-18	07-06-18	23-08-18	23-08-18	
Drawing Number	Rev				
TNI Ref Originator Volume Location Type Discipline Classification Number	P2.0				
168014-RPSB-LOV-XX-DR-HE-2600-00024					