

APPENDIX G

Drainage Outfalls

Northbound drainage areas		
	Area = m ²	Area = hectares
Northbound side - Proposed hard standing area (Roads and footways)	4682m ²	0.4682
Northbound side - Proposed soft standing area (Grassed verge and embankments)	8659m ²	0.8659
Total	13341m ²	1.3341
Northbound side - Existing mainline hard standing area (Carriageway and hard shoulder)	1870m ²	0.187
Northbound side - Existing and proposed mainline soft standing area (Verge and central reserve)	2641m ²	0.2641
Total	4511m ²	0.4511

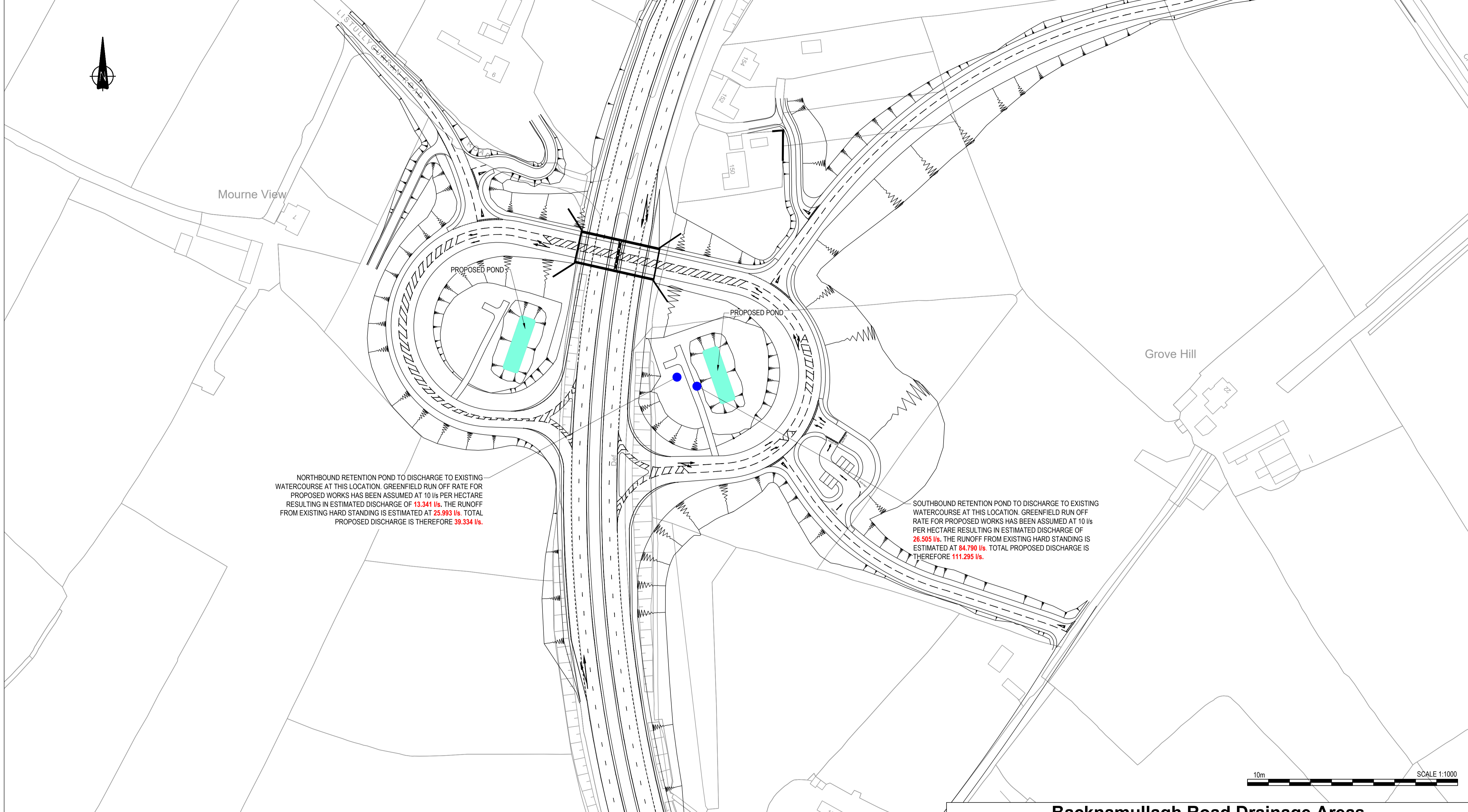

NORTHBOUND RETENTION POND TO DISCHARGE TO EXISTING WATERCOURSE AT THIS LOCATION. GREENFIELD RUN OFF RATE FOR PROPOSED WORKS HAS BEEN ASSUMED AT 10 l/s PER HECTARE RESULTING IN ESTIMATED DISCHARGE OF 13.341 l/s. THE RUNOFF FROM EXISTING HARD STANDING IS ESTIMATED AT 25.993 l/s. TOTAL PROPOSED DISCHARGE IS THEREFORE 39.334 l/s.

SOUTHBOUND RETENTION POND TO DISCHARGE TO EXISTING WATERCOURSE AT THIS LOCATION. GREENFIELD RUN OFF RATE FOR PROPOSED WORKS HAS BEEN ASSUMED AT 10 l/s PER HECTARE RESULTING IN ESTIMATED DISCHARGE OF 26.505 l/s. THE RUNOFF FROM EXISTING HARD STANDING IS ESTIMATED AT 84.790 l/s. TOTAL PROPOSED DISCHARGE IS THEREFORE 111.295 l/s.

Southbound drainage areas		
	Area = m ²	Area = hectares
Southbound side - Proposed hard standing area (Roads and footways)	7120m ²	0.712
Southbound side - Proposed soft standing area (Grassed verge and embankments)	19385m ²	1.9385
Total	26505m ²	2.6505
Southbound side - Existing mainline hard standing area (Carriageway and hard shoulder)	6100m ²	0.6100
Southbound side - Existing and proposed mainline soft standing area (Verge and central reserve)	4795m ²	0.4795
Total	10895m ²	1.0895

Backnamullagh Road Drainage Areas		
	Area = m ²	Area = hectares
Northbound side - Proposed hard standing area (Roads and footways)	1390m ²	0.139
Northbound side - Proposed soft standing area (Grassed verge and embankments)	3425m ²	0.3425
Total	4815m ²	0.4815
Northbound side - Existing mainline hard standing area (Carriageway and hard shoulder)	0m ²	0
Northbound side - Existing and proposed mainline soft standing area (Verge and central reserve)	0m ²	0
Total	0m ²	0

- NOTES**
- Verifying Dimensions. The contractor shall verify dimensions against such other drawings or site conditions as pertain to this part of the work.
 - Existing Services. Any information concerning the location of existing services indicated on this drawing is intended for general guidance only. It shall be the responsibility of the contractor to determine and verify the exact horizontal and vertical alignment of all cables, pipes, etc. (both underground and overhead) before work commences.
 - Issue of Drawings. Hard copies, dwf and pdf will form a controlled issue of the drawing. All other formats (dwg, dxf etc.) are deemed to be an uncontrolled issue and any work carried out based on these files is at the recipient's own risk. RPS will not accept any responsibility for any errors arising from the use of these files, either by human error by the recipient, listing of un-dimensioned measurements, compatibility issues with the recipient's software, and any errors arising when these files are used to aid the recipient's drawing production, or setting out on site.
 - This is based upon Crown Copyright and is reproduced with the permission of Land & Property Services under delegated authority from the Controller of Her Majesty's Stationery Office, © Crown copyright and database right [2018] EMOU [206.2]
 - DATUM: Irish Grid
 - Key:
 - Existing Survey / OS Mapping
 - Proposed Layout
 - Top of slope
 - Earthworks
 - Bottom of slope
 - Drainage Outfall
 - Proposed Pond

P2.0 Updated for inclusion in Stage 3 Scheme Assessment Report PN JB CD 18/02/19

REV	COMMENT	DRAWN	CH	AP	DATE

RPS **SWECO**

Elmwood House
74 Boucher Road
Belfast
BT12 6RZ

T +44 (0) 28 90 667914
F +44 (0) 28 90 668286
W www.rpsgroup.com/ireland
E ireland@rpsgroup.com

Client

Department for Infrastructure
An Roinn
Bonneagair
www.infrastructure-ri.gov.uk

Project

A1 Junctions Phase 2

Title

J1 Listullycurran - Proposed Drainage Outfalls

Drawing Status	Suitability	Project Ref No.
S2	For Information	IBH0488

Scale	Designed	Drawn By	Checked	Authorised
1:1000	PN	PN	JB	CD

Original Size	Date	Date	Date	Date
A1	09/02/18	09/02/18	15/01/19	15/02/19

Drawing Number Rev P2.0

TNI Ref Originator Volume Location Type Discipline Classification Number
168014-RPSB-HDG-J1-DR-D-500-00003



Milebush Road Drainage Areas		
	Area = m ²	Area = hectares
Proposed hard standing area (Roads and footways)	160m ²	0.016
Proposed soft standing area (Grassed verge and embankments)	1340m ²	0.134
Total	1500m ²	0.15
Existing hard standing area (Carriageway)	1430m ²	0.143
Existing and proposed mainline soft standing area (Verge)	0m ²	0
Total	1430m ²	0.143

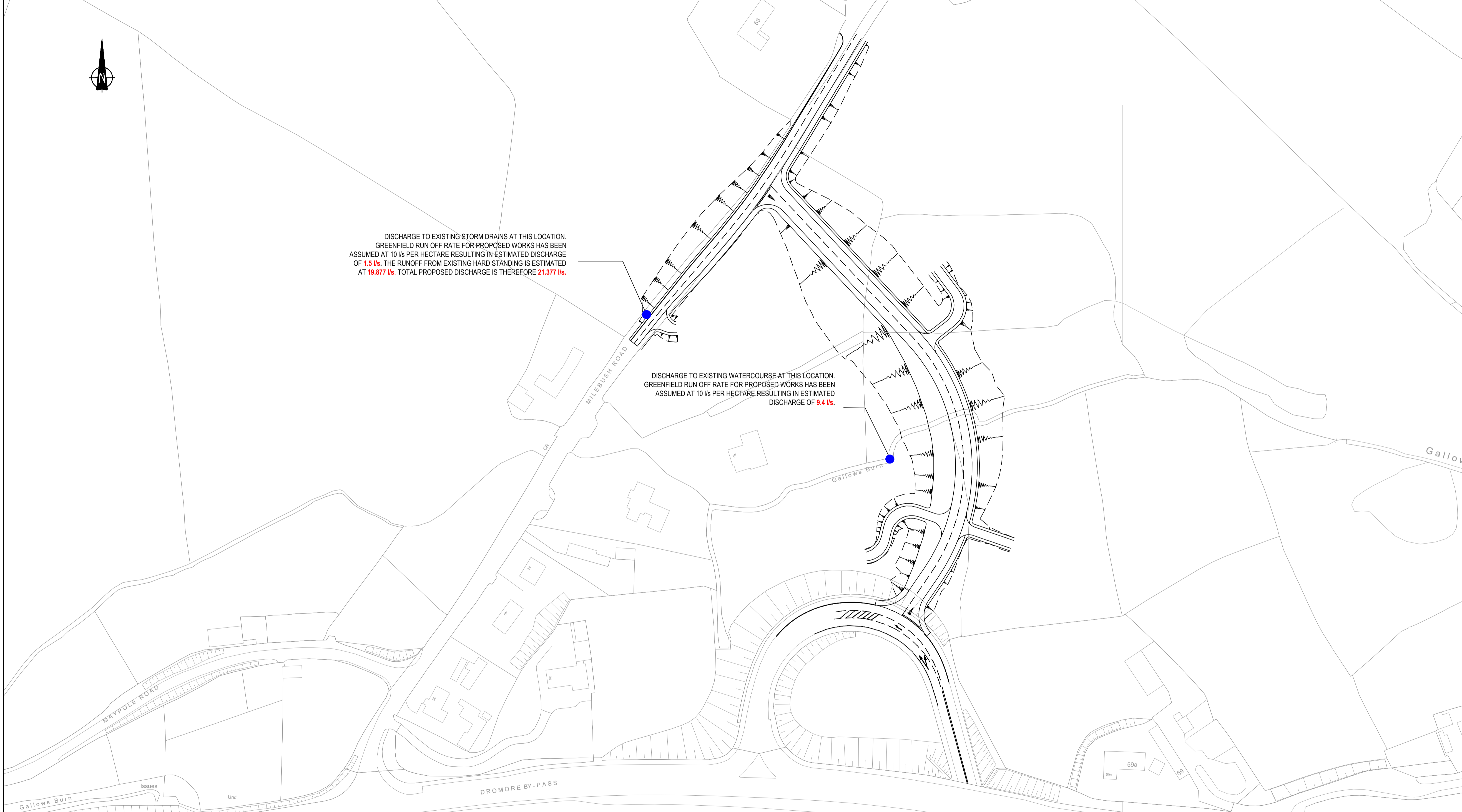

Milebush Link Road Drainage Areas		
	Area = m ²	Area = hectares
Proposed hard standing area (Roads and footways)	2723m ²	0.272
Proposed soft standing area (Grassed verge and embankments)	6705m ²	0.671
Total	9428m ²	0.943
Existing hard standing area (Carriageway)	0m ²	0
Existing and proposed mainline soft standing area (Verge)	0m ²	0
Total	0m ²	0

- NOTES**
- Verifying Dimensions. The contractor shall verify dimensions against such other drawings or site conditions as pertain to this part of the work.
 - Existing Services. Any information concerning the location of existing services indicated on this drawing is intended for general guidance only. It shall be the responsibility of the contractor to determine and verify the exact horizontal and vertical alignment of all cables, pipes, etc. (both underground and overhead) before work commences.
 - Issue of Drawings. Hard copies, dwf and pdf will form a controlled issue of the drawing. All other formats (dwg, dxf etc.) are deemed to be an uncontrolled issue and any work carried out based on these files is at the recipient's own risk. RPS will not accept any responsibility for any errors arising from the use of these files, either by human error by the recipient, listing of un-dimensioned measurements, compatibility issues with the recipient's software, and any errors arising when these files are used to aid the recipient's drawing production, or setting out on site.
 - This is based upon Crown Copyright and is reproduced with the permission of Land & Property Services under delegated authority from the Controller of Her Majesty's Stationery Office, © Crown copyright and database right [2018] EMOU [206.2]

- DATUM: Irish Grid
- KEY
 - Existing Survey / OS Mapping
 - Proposed Layout
 - Top of slope
 - Earthworks
 - Bottom of slope
 - Drainage Outfall

P1.0	UPDATED FOR INCLUSION IN STAGE 3 SCHEME ASSESSMENT REPORT	GMCO	JB	CD	15/02/2019
REV	COMMENT	DRAWN	CH	AP	DATE

RPS **SWECO**

Elmwood House
74 Boucher Road
Belfast
BT12 6RZ

T +44 (0) 28 90 667914
F +44 (0) 28 90 668286
W www.rpsgroup.com/ireland
E ireland@rpsgroup.com

Client

Department for Infrastructure
An Roinn Bonneagair
www.infrastructure.ni.gov.uk

Project

A1 Junctions Phase 2

Title
Junction 2 Milebush - Proposed Drainage Outfalls

Drawing Status	Suitability	Project Ref No.		
S2	FOR INFORMATION	IBH0488		
Scale	Designed	Drawn By	Checked	Authorised
1:1000	PA	PA	JB	CD
Original Size	Date	Date	Date	Date
A1	14/02/18	14/02/18	14/02/18	14/02/18
Drawing Number	Rev P1.0			
TNI Ref Originator Volume Location Type Discipline Classification Number				
168014-RPSB-HDG-J2-DR-D-500-00003				

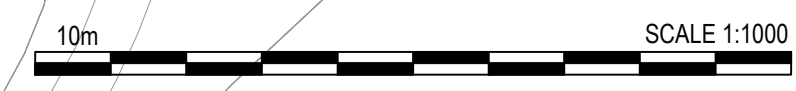

Northbound Attenuation Drainage Areas		
	Area = m ²	Area = hectares
Northbound side - Proposed hard standing area (Roads and footways)	4298m ²	0.4298ha
Northbound side - Proposed soft standing area (Grassed verge and embankments)	10022m ²	1.0022ha
Total	14320m ²	1.4320ha
Northbound side - Existing mainline hard standing area (Carriageway and hard shoulder)	8762m ²	0.8762ha
Northbound side - Existing and proposed mainline soft standing area (Verge and central reserve)	2453m ²	0.2453ha
Total	11215m ²	1.1215ha

Gowdstown Road North Drainage Areas		
	Area = m ²	Area = hectares
Gowdstown Road North - Proposed hard standing area (Roads and footways)	919m ²	0.0919ha
Gowdstown Road North - Proposed soft standing area (Grassed verge and embankments)	720m ²	0.0720ha
Total	1639m ²	0.1639ha
Gowdstown Road North - Existing mainline hard standing area (Carriageway and hard shoulder)	498m ²	0.0498ha
Gowdstown Road North - Existing and proposed mainline soft standing area (Verge and central reserve)	207m ²	0.0207ha
Total	705m ²	0.0705ha

Southbound Merge Drainage Areas		
	Area = m ²	Area = hectares
Southbound Merge - Proposed hard standing area (Roads and footways)	295m ²	0.0295ha
Southbound Merge - Proposed soft standing area (Grassed verge and embankments)	225m ²	0.0225ha
Total	520m ²	0.0520ha
Southbound Merge - Existing mainline hard standing area (Carriageway and hard shoulder)	1753m ²	0.1753ha
Southbound Merge - Existing and proposed mainline soft standing area (Verge and central reserve)	1157m ²	0.1157ha
Total	2910m ²	0.2910ha

Access Road on Northbound Side Drainage Areas		
	Area = m ²	Area = hectares
Access Road on Northbound Side - Proposed hard standing area (Roads and footways)	765m ²	0.0765ha
Access Road on Northbound Side - Proposed soft standing area (Grassed verge and embankments)	1194m ²	0.1194ha
Total	1959m ²	0.1959ha
Access Road on Northbound Side - Existing mainline hard standing area (Carriageway and hard shoulder)	670m ²	0.0670ha
Access Road on Northbound Side - Existing and proposed mainline soft standing area (Verge and central reserve)	440m ²	0.0440ha
Total	1110m ²	0.1110ha

Southbound Attenuation Drainage Areas		
	Area = m ²	Area = hectares
Southbound side - Proposed hard standing area (Roads and footways)	7529m ²	0.7529ha
Southbound side - Proposed soft standing area (Grassed verge and embankments)	12422m ²	1.2422ha
Total	19951m ²	1.9951ha
Southbound side - Existing mainline hard standing area (Carriageway and hard shoulder)	4215m ²	0.4215ha
Southbound side - Existing and proposed mainline soft standing area (Verge and central reserve)	2803m ²	0.2803ha
Total	7018m ²	0.7018ha

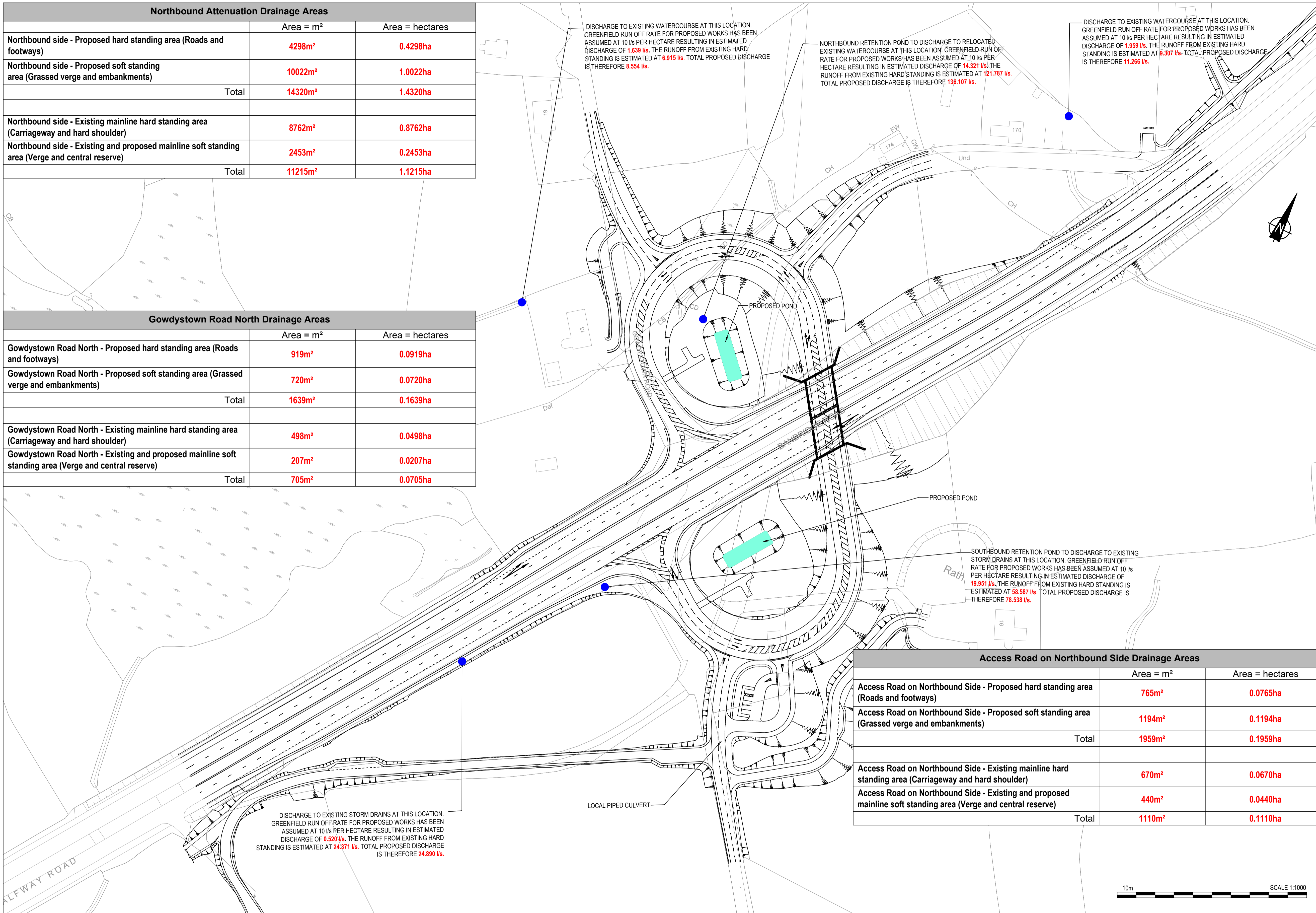

- NOTES**
- Verifying Dimensions. The contractor shall verify dimensions against such other drawings or site conditions as pertain to this part of the work.
 - Existing Services. Any information concerning the location of existing services indicated on this drawing is intended for general guidance only. It shall be the responsibility of the contractor to determine and verify the exact horizontal and vertical alignment of all cables, pipes, etc. (both underground and overhead) before work commences.
 - Issue of Drawings. Hard copies, dwf and pdf will form a controlled issue of the drawing. All other formats (dwg, dxf etc.) are deemed to be uncontrolled issues and any work carried out based on these files is at the recipient's own risk. RPS will not accept any responsibility for any errors arising from the use of these files, either by human error by the recipient, listing of un-dimensioned measurements, compatibility issues with the recipient's software, and any errors arising when these files are used to aid the recipient's drawing production, or setting out on site.
 - This is based upon Crown Copyright and is reproduced with the permission of Land & Property Services under delegated authority from the Controller of Her Majesty's Stationery Office, © Crown copyright and database right [2018] EMOU [206.2]
 - DATUM: Irish Grid

KEY

	Existing Survey / OS Mapping
	Proposed Layout
	Top of slope
	Earthworks
	Bottom of slope
	Drainage Outfall
	Proposed Pond

P1.0	UPDATED FOR INCLUSION IN STAGE 3 SCHEME ASSESSMENT REPORT	GMCQ	JB	CD	15/02/2019
P0.2	DISCHARGE NOTE AMENDED	GMCQ	JB	CD	31/01/2019
REV	COMMENT	DRAWN	CH	AP	DATE

RPS **SWECO**

Elmwood House
74 Boucher Road
Belfast
BT12 6RZ

T +44 (0) 28 90 667914
F +44 (0) 28 90 668286
W www.rpsgroup.com/ireland
E ireland@rpsgroup.com

Client

Department for Infrastructure
Bonneagair
An Roinn
www.infrastructure.ie.gov.uk

Project

A1 Junctions Phase 2

Title: J3 Gowdstown - Proposed Drainage Outfalls

Drawing Status	Suitability	Project Ref No.		
S2	FOR INFORMATION	IBH0488		
Scale	Designed	Drawn By	Checked	Authorised
1:1000	GMCQ	GMCQ	JB	CD
Original Size	Date	Date	Date	Date
A1	09/02/2018	09/02/2018	15/02/2019	15/02/2019
Drawing Number	Rev P1.0			
TNI Ref	Originator	Volume	Location	Type Discipline Classification Number
168014-RPSB-HDG-J3-DR-D-500-00003				



Northbound drainage areas		
	Area = m ²	Area = hectares
Northbound side - Proposed hard standing area (Roads and footways)	10634m ²	1.0634
Northbound side - Proposed soft standing area (Grassed verge and embankments)	11570m ²	1.157
Total	22204m ²	2.2204
Northbound side - Existing mainline hard standing area (Carriageway and hard shoulder)	5046m ²	0.5046
Northbound side - Existing and proposed mainline soft standing area (Verge and central reserve)	1671.9m ²	0.16719
Total	6717.9m ²	0.67179

Skeltons Road drainage areas		
	Area = m ²	Area = hectares
Skeltons Road - Proposed hard standing area (Roads and footways)	3777.91m ²	0.377791
Skeltons Road - Proposed soft standing area (Grassed verge and embankments)	1128.02m ²	0.112802
Total	4905.93m ²	0.490593
Skeltons Road - Existing hard standing area (Carriageway)	2007.99m ²	0.200799
Skeltons Road - Existing and proposed mainline soft standing area (Verge)	260.24m ²	0.26024
Total	2268.23m ²	0.226823

- NOTES**
- Verifying Dimensions. The contractor shall verify dimensions against such other drawings or site conditions as pertain to this part of the work.
 - Existing Services. Any information concerning the location of existing services indicated on this drawing is intended for general guidance only. It shall be the responsibility of the contractor to determine and verify the exact horizontal and vertical alignment of all cables, pipes, etc. (both underground and overhead) before work commences.
 - Issue of Drawings. Hard copies, dwf and pdf will form a controlled issue of the drawing. All other formats (dwg, dxf etc.) are deemed to be an uncontrolled issue and any work carried out based on these files is at the recipients own risk. RPS will not accept any responsibility for any errors arising from the use of these files, either by human error by the recipient, listing of un-dimensioned measurements, compatibility issues with the recipient's software, and any errors arising when these files are used to aid the recipients drawing production, or setting out on site.
 - This is based upon Crown Copyright and is reproduced with the permission of Land & Property Services under delegated authority from the Controller of Her Majesty's Stationery Office, © Crown copyright and database right [2018] EMOU [206.2]
 - DATUM: Irish Grid
 - KEY
 - Existing Survey / OS Mapping
 - Proposed Layout
 - Top of slope
 - Earthworks
 - Bottom of slope
 - Drainage Outfall
 - Proposed Pond

Tullyhenan Road drainage areas		
	Area = m ²	Area = hectares
Tullyhenan Road - Proposed hard standing area (Roads and footways)	2232.33m ²	0.223233
Tullyhenan Road - Proposed soft standing area (Grassed verge and embankments)	1952.69m ²	0.195269
Total	4185.02m ²	0.418502
Tullyhenan Road - Existing hard standing area (Carriageway)	650.8m ²	0.06508
Tullyhenan Road - Existing and proposed mainline soft standing area (Verge)	500.3m ²	0.05003
Total	1151.1m ²	0.11511

Drumneath Road drainage areas		
	Area = m ²	Area = hectares
Drumneath Road - Proposed hard standing area (Roads and footways)	1382.92m ²	0.138292
Drumneath Road - Proposed soft standing area (Grassed verge and embankments)	1216.541m ²	0.1216541
Total	2599.461m ²	0.2599461
Drumneath Road - Existing hard standing area (Carriageway)	1190.49m ²	0.119049
Drumneath Road - Existing and proposed mainline soft standing area (Verge)	221.02m ²	0.022102
Total	1411.51m ²	0.141151

Southbound drainage areas		
	Area = m ²	Area = hectares
Southbound side - Proposed hard standing area (Roads and footways)	5987.2m ²	0.59872
Southbound side - Proposed soft standing area (Grassed verge and embankments)	17069.7m ²	1.70697
Total	23056.9m ²	2.30569
Southbound side - Existing mainline hard standing area (Carriageway and hard shoulder)	3699.5m ²	0.36995
Southbound side - Existing and proposed mainline soft standing area (Verge and central reserve)	1636.3m ²	0.16363
Total	5335.8m ²	0.53358

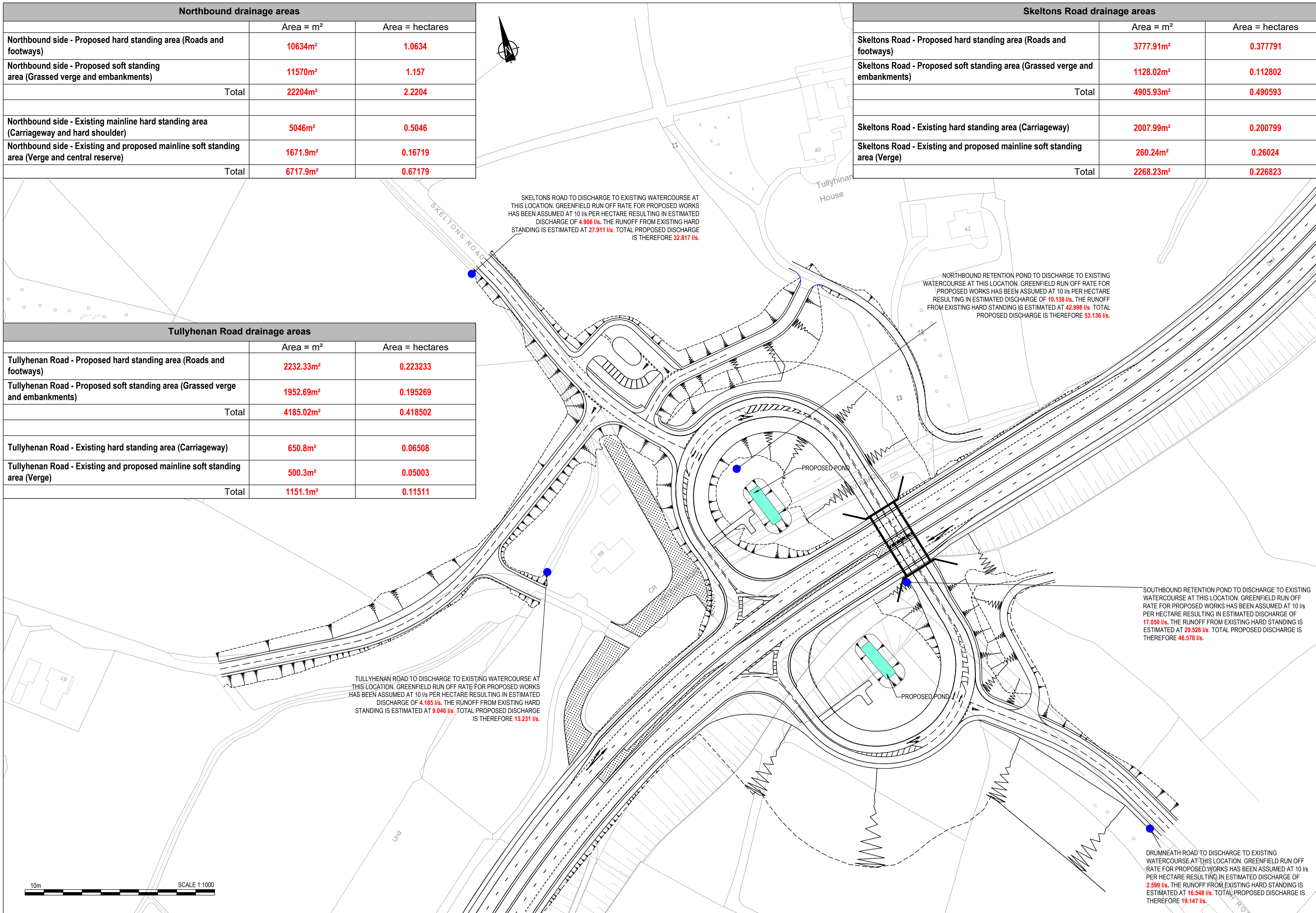

10m SCALE 1:1000

P1.0	UPDATED FOR INCLUSION IN STAGE 3 SCHEME ASSESSMENT REPORT	GMCO	JB	CD	15/02/2019
REV	COMMENT	DRAWN	CH	AP	DATE

RPS **SWECO**

Elmwood House
74 Boucher Road
Belfast
BT12 6RZ

T +44 (0) 28 90 667914
F +44 (0) 28 90 668286
W www.rpsgroup.com/ireland
E ireland@rpsgroup.com

Client

Department for Infrastructure
An Roinn Bonneagair
www.infrastructure.ie.gov.uk

Project

A1 Junctions Phase 2

Title

Junction 4 Skeltons/Drumneath - Proposed Drainage Outfalls

Drawing Status	Suitability	Project Ref No.		
S2	FOR INFORMATION	IBH0488		
Scale	Designed	Drawn By	Checked	Authorised
1:1000	PA	PA	JB	CD
Original Size	Date	Date	Date	Date
A1	15/02/18	15/02/18	15/02/18	15/02/18
Drawing Number	Rev P1.0			
TNI Ref	Originator	Volume	Location	Type Discipline Classification Number
168014-RPSB-HDG-J4-DR-D-500-00003				

Northbound drainage areas		
	Area = m ²	Area = hectares
Northbound side - Proposed hard standing area (Roads and footways)	8756m ²	0.8756
Northbound side - Proposed soft standing area (Grassed verge and embankments)	14714m ²	1.4714
Total	23470m ²	2.3470
Northbound side - Existing mainline hard standing area (Carriageway and hard shoulder)	4997m ²	0.4997
Northbound side - Existing and proposed mainline soft standing area (Verge and central reserve)	1336m ²	0.1336
Total	6333m ²	0.6333

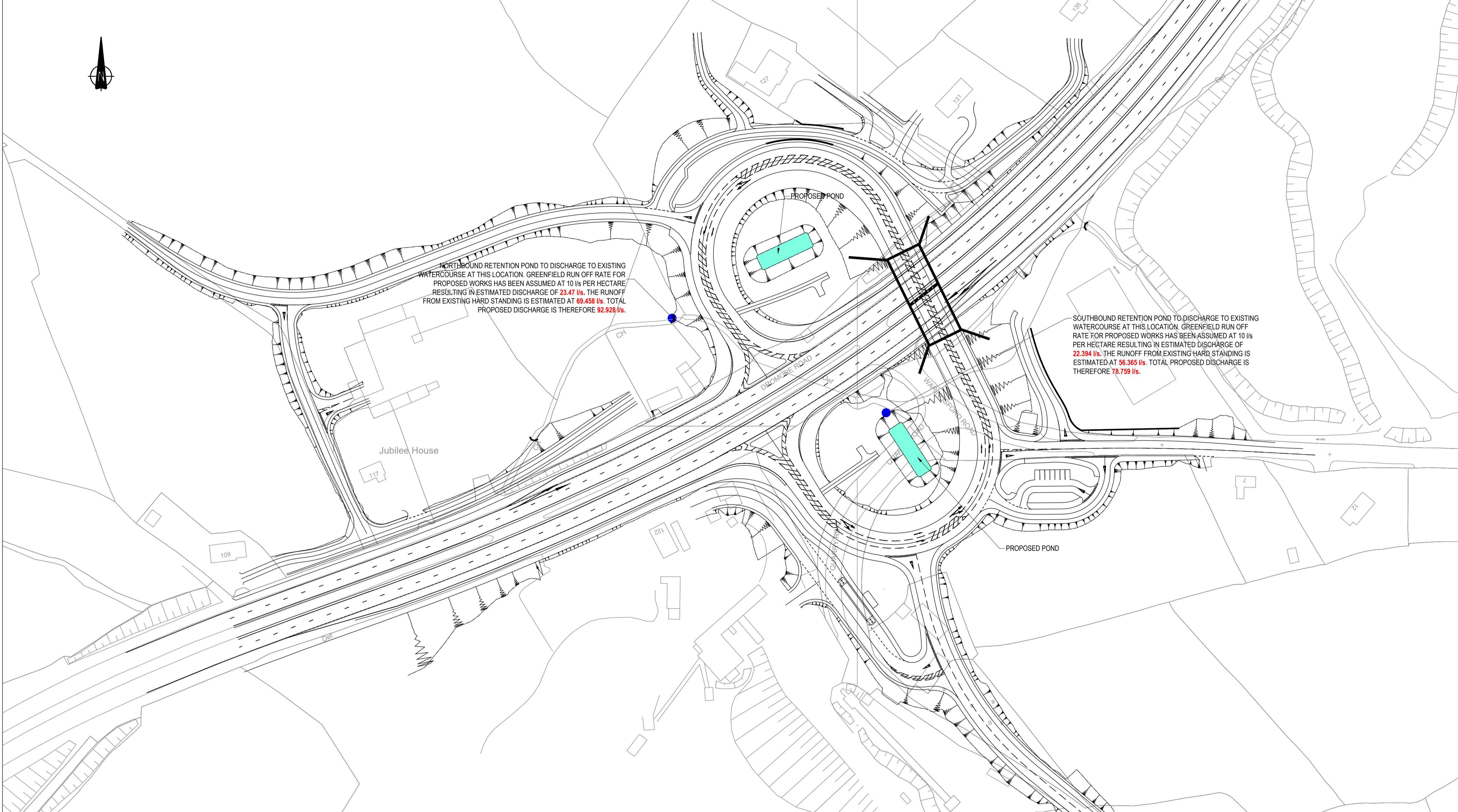

Southbound drainage areas		
	Area = m ²	Area = hectares
Southbound side - Proposed hard standing area (Roads and footways)	10105m ²	1.0105
Southbound side - Proposed soft standing area (Grassed verge and embankments)	12289m ²	1.2289
Total	22394m ²	2.2394
Southbound side - Existing mainline hard standing area (Carriageway and hard shoulder)	4055m ²	0.4055
Southbound side - Existing and proposed mainline soft standing area (Verge and central reserve)	1254m ²	0.1254
Total	5309m ²	0.5309

- NOTES**
- Verifying Dimensions. The contractor shall verify dimensions against such other drawings or site conditions as pertain to this part of the work.
 - Existing Services. Any information concerning the location of existing services indicated on this drawing is intended for general guidance only. It shall be the responsibility of the contractor to determine and verify the exact horizontal and vertical alignment of all cables, pipes, etc. (both underground and overhead) before work commences.
 - Issue of Drawings. Hard copies, dwf and pdf will form a controlled issue of the drawing. All other formats (dwg, dxf etc.) are deemed to be an uncontrolled issue and any work carried out based on these files is at the recipient's own risk. RPS will not accept any responsibility for any errors arising from the use of these files, either by human error by the recipient, listing of un-dimensioned measurements, compatibility issues with the recipient's software, and any errors arising when these files are used to aid the recipient's drawing production, or setting out on site.
 - This is based upon Crown Copyright and is reproduced with the permission of Land & Property Services under delegated authority from the Controller of Her Majesty's Stationery Office, © Crown copyright and database right [2018] EMOU [206 Z]
 - DATUM: Irish Grid

Legend:

- Existing Survey / OS Mapping
- Proposed Layout
- Top of slope
- Earthworks
- Bottom of slope
- Drainage Outfall
- Proposed Pond

REV	COMMENT	DRAWN	CH	AP	DATE

RPS **SWECO**

Elmwood House
74 Boucher Road
Belfast
BT12 6RZ

T +44 (0) 28 90 667914
F +44 (0) 28 90 668286
W www.rpsgroup.com/ireland
E ireland@rpsgroup.com

Client

Department for Infrastructure
An Roinn Bonneagair
www.infrastructure-ri.gov.uk

Project

A1 Junctions Phase 2

Title

J5 Waringsford - Proposed Drainage Outfalls

Drawing Status	Suitability	Project Ref No.		
S2	For Information	IBH0488		
Scale	Designed	Drawn By	Checked	Authorised
1:1000	DMI	DMI	JB	CD
Original Size	Date	Date	Date	Date
A1	09/02/18	09/02/18	15/02/19	15/02/19
Drawing Number	Rev P1.0			
TNI Ref	Originator	Volume	Location	Type Discipline Classification Number
168014-RPSB-HDG-J5-DR-D-500-00003				

